







Mecca Shower Mixer Diverter System Separate Back Plate

Finish & SKU

 Chrome NR221912fCH	 Brushed Nickel NR221912fBN
 Matte Black NR221912fMB	 Brushed Gold NR221912fBG
 Brushed Bronze NR221912fBZ	 Gun Metal NR221912fGM
 Matte White NR221912fMW	

Specifications

Watermark License

WM-060073

Temperature Rating

Min 1°C-Max 75°C

Pressure Rating

Min 150kpa-Max 500kpa

Warranty



Features

- Single function metal hand piece
- 2 way Diverter switch between hand piece and a second connected outlet
- 35mm ceramic disc cartridge
- Packed Separately (Body and Trim Kits)

Maintenance And Care

- Regularly check the mixer and connections for signs of wear or leaks.
- Clean the tap with mild soapy water to maintain its appearance, avoiding harsh chemicals and abrasive materials that may damage the finish.



Lead Free

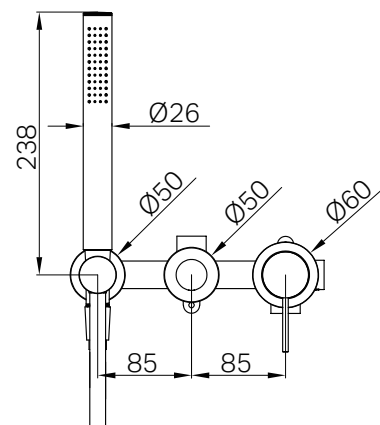
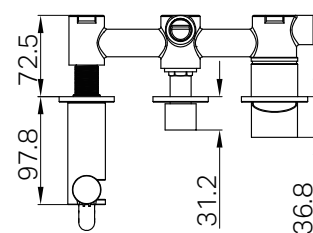

- Dimensions are nominal measurements only.