

# 4Patriots®

## PATRIOT POWER GENERATOR 2200X USER MANUAL



*Scan  
Me!*



Join our 4Patriots Text Club for...

- ✓ Early Access to Events
- ✓ Exclusive Deals & Discounts
- ✓ PLUS a FREE Mystery Gift!

## TRADEMARKS

4Patriots product names are a trademark of 4Patriots. Other trademarks, registered trademarks and product names are the property of their respective owners and are used herein for identification purposes only.

## NOTICE OF COPYRIGHT

Patriot Power Generator 2200X User Manual. Copyright © 2025 4Patriots, LLC. All Rights Reserved.

## EXCLUSIONS FOR DOCUMENTATION

Unless specifically agreed to in writing, 4Patriots and the Patriot Power Generator:

- A.** Make no warranty as to the accuracy, sufficiency or suitability of any technical or other information provided in its manuals or other documentation.
- B.** Assume no responsibility or liability for losses, damages, costs or expenses, whether special, direct, indirect, consequential or coincidental, which might arise out of the use of such information. The use of any such information will be entirely at the user's risk.

## DATE AND EDITION

May 7, 2025, 1st Ed.

## CONTACT INFORMATION

### **Billing & General Customer Support:**

2420 Berry Hill Dr., Suite 300  
Nashville, TN 37204 USA

1-800-304-4202  
help@4patriots.com

# 4Patriots®



Please read ALL instructions and information  
in this user manual before using this unit.



# TABLE OF CONTENTS

ABOUT THE PATRIOT POWER GENERATOR 2200X.....6

SYMBOLS & TERMS.....7

IMPORTANT SAFETY INSTRUCTIONS.....8

GROUNDING INSTRUCTIONS.....9

GETTING STARTED.....10

UNIT OVERVIEW.....10

PATRIOT POWER GENERATOR 2200X INTERFACE.....11

INTERFACE KEY.....12

UNDERSTANDING YOUR LCD SCREEN.....13

CHARGING & OUTLET USAGE.....14

USER MAINTENANCE INSTRUCTIONS.....17

MOVING & STORAGE INSTRUCTIONS.....17

TROUBLESHOOTING & FAQs.....18

TECHNICAL SPECIFICATIONS.....26

WARRANTY INFORMATION.....28

ADDITIONAL TERMS.....29

# ABOUT THE PATRIOT POWER GENERATOR 2200X

The Patriot Power Generator 2200X is the latest generation of powerful and portable solar generators from 4Patriots. It's silent, fume-free and safe to use indoors. Use your Patriot Power Generator 2200X to protect your family from power outages, or to take with you on your outdoor adventures. With advanced engineering and a robust 4,000+ lifecycles, the Patriot Power Generator 2200X can provide the backup power protection you need for years to come. Here are qualities that set the Patriot Power Generator 2200X apart from the rest:

## SAFETY

No emissions — none. Unlike fossil fuel-powered generators and lead acid batteries, the Patriot Power Generator has no carbon footprint, emits no greenhouse gases and causes no damage to the environment. It's even safe to use indoors.

## QUIET

The protected lithium core produces wattage without the loud, continuous sound made by other gas or diesel generator engines.

## RENEWABLE

Powered and replenished by natural resources such as the sun, wind and water, as well as mechanical devices. The unit retains charge for one year, but you should charge your unit every 3-6 months for optimal long term care.

## PORTABLE

The Patriot Power Generator 2200X is a relatively small device, measuring just over a cubic foot and weighing only 57.5 pounds. That's small enough to carry or store most places. Most generators surpass this weight and offer less power.

## AFFORDABLE

No other generator offers the same quiet power output and device versatility at this price point.

# SYMBOLS & TERMS

## IMPORTANT SYMBOLS

The following symbols are used in this guide:

 **WARNING** Warnings are conditions and practices that could result in personal injury.

 **CAUTION** Cautions are conditions and practices that could result in damage to the unit or other equipment.

## IMPORTANT TERMS

The following terms are helpful for you to know and are used in this guide:

Term	Definition
A	Ampere or Amp
Ah	Amp-hour
AC	Alternating Current
DC	Direct Current
Hz	Hertz
kW	Kilowatt; 1,000 Watts
kWh	Kilowatt-hour
LED	Light Emitting Diode
LCD	Liquid-crystal display
mA	Milliampere; 1/1000th of an ampere
PV	Photovoltaic
VAC	Volts AC
VDC	Volts DC
W	Watts
Wh	Watt-hour

# IMPORTANT SAFETY INSTRUCTIONS

*Pertaining to risk of fire, electric shock, or injury to persons.*

**PLEASE READ THIS ENTIRE MANUAL BEFORE  
ATTEMPTING TO USE THIS PRODUCT.**

## **WARNING:**

1. Avoid dangerous environments. Do not charge this item in rain, snow or other damp environments. Do not use this item or charger in the presence of explosive atmospheres (gaseous fumes, dust or flammable materials) because sparks may be generated when charging or discharging this item, possibly causing a fire.
2. To reduce the risk of injury, close supervision is necessary when the product is used near children.
3. Do not put fingers or hands into the product.
4. Use of an attachment not recommended or sold by 4Patriots may result in a risk of fire, electric shock, or injury to persons.
5. To reduce risk of damage to the electric plug and cord, pull the plug rather than the cord when disconnecting the power pack.
6. Do not use a battery pack or appliance that is damaged or modified. Damaged or modified batteries may exhibit unpredictable behavior resulting in fire, explosion or risk of injury.
7. Charge the battery only in a well-ventilated area and ensure the ventilation on the product is not restricted in any way. Allow at least 6 inches of clear space around the vents. Do not allow smoking or open flames near a charging battery. Use caution when charging outdoors; the surface of the generator may get very hot. Handle with care.
8. Do not expose this item to excessive temperatures. Do not burn or incinerate this item. Exposure to fire or temperatures above 266°F (130°C) may cause this item to explode, causing personal injury or damage. Toxic fumes and materials are created when batteries are burned.
9. Do not crush, drop or damage this item. Do not use this item if it has received a sharp blow or has been dropped, run over or damaged in any way (e.g., pierced with a nail, hit with a car, etc.).
10. Inspect all power cords and connections before attempting to connect them to your generator. Do not operate a power product or appliance with a damaged cord or plug, or a damaged output cable.
11. To reduce the risk of electric shock, unplug this item from the outlet and wait 2 minutes before attempting any instructed cleaning.



12. Do not disassemble. There are no serviceable parts. Repairs can only be performed by a 4Patriots technician. Disassembly will void the warranty and increase the risk of electric shock, fire and exposure to battery chemicals that may cause personal injury or damage.
13. Battery chemicals are dangerous. Never tamper with, puncture, heat, ignite or short-circuit the battery cells. If the battery cells are damaged, they may vent significant amounts of smoke. Do not inhale vented smoke. Please contact 4Patriots immediately for instructions on returning or disposing of a damaged unit.
14. Do not short-circuit. This item will short-circuit if a metal object makes connection to the AC or DC output ports. Do not place this item near anything that may cause a short circuit, such as coins, keys or nails. A short-circuited battery may cause fire and personal injury.
15. Never charge or jump-start a frozen battery.
16. Store this item in a cool, dry place. Do not store this unit for more than 10 days in an environment where temperatures may exceed 120 °F (49 °C), such as direct sunlight, a vehicle or metal building during the summer. Doing so may cause damage to the unit.
17. This product is not intended for commercial applications.
18. This product is capable of powering all the AC, DC, and USB outlets simultaneously, within the maximum power limits listed on page 26.
19. Connect the unit directly to the wall outlet with the provided cable to charge. Do not use an extension cord or power strip to charge the unit.

***SAVE THESE INSTRUCTIONS FOR FUTURE REFERENCE.***

## **GROUNDING INSTRUCTIONS**

This product must be grounded when charging. If it should malfunction or break down, grounding provides the path of least resistance for the electric current to reduce the risk of electric shock. This product is equipped with a cord that has an equipment grounding conductor and a grounding plug. The plug must be plugged into an outlet that is properly installed and grounded in accordance with all local codes and ordinances.

### **WARNING:**

Improper connection of the equipment grounding conductor could result in a risk of electric shock. Check with a qualified electrician if you are in doubt as to whether the product is properly grounded. Do not modify the plug provided with the product – if it will not fit the outlet, have a proper outlet installed by a qualified electrician.

## GETTING STARTED

Thank you for your purchase of the Patriot Power Generator 2200X. The 2200-watt pure sine wave AC inverter output in this unit makes it compatible for use with many of today's high-tech electronic devices. It also allows appliance motors to operate more efficiently and at cooler temperatures.

Be sure to carefully read this user manual. Even though your Patriot Power Generator 2200X has many advanced built-in safety features, it is still important to take some time to become familiar with the Safety Instructions on page 9 of this guide before operation.

If you still have any questions, please contact our Customer Support team. See Contact Information on page 2

## UNIT OVERVIEW

You should have received the following items with your Patriot Power Generator 2200X:

- Patriot Power Generator 2200X Unit
- AC wall-outlet charging cord
- User manual

## ON/OFF PROCEDURES

- Tap the "Display" button on the left of the screen to turn on the LCD display.

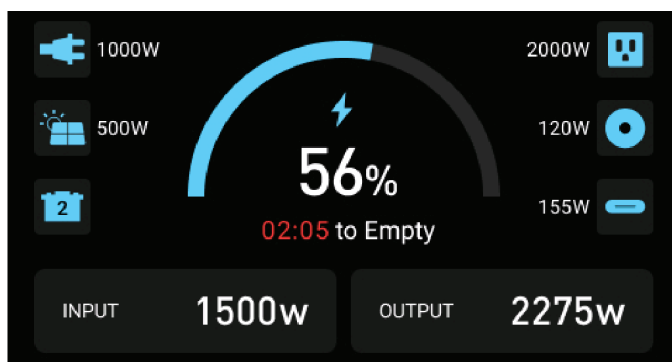

- Tapping any button will turn the unit on. If all ports and display are turned off, the unit will automatically shut itself off.
- The unit will shut itself off if the ports are on but no load is detected.
- You should always be close enough to your unit to monitor its function. Stay close whether you are discharging or charging the unit after use.
- Store unit fully charged.

# PATRIOT POWER GENERATOR 2200X INTERFACE

FRONT

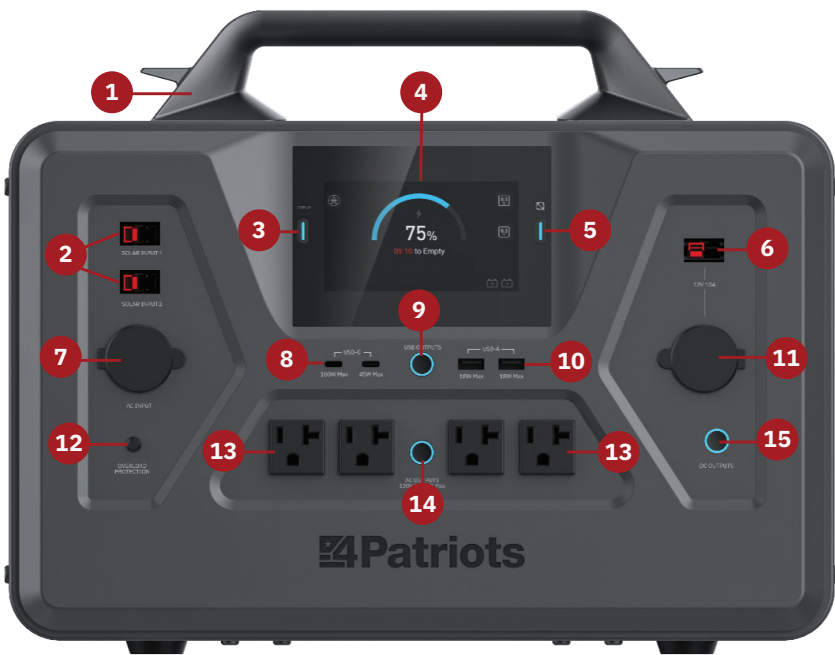

SIDE



BACK



# **INTERFACE KEY**

- 1. CORD STORAGE**
- 2. 12V-59V DC & SOLAR CHARGING INPUTS**
- 3. SCREEN ON/OFF BUTTON**
- 4. LCD HOME SCREEN DISPLAY**
- 5. SCREEN TOGGLE BUTTON (SWITCH SCREENS)**
- 6. 12V DC OUTLET (10A)**
- 7. 120V AC CHARGING INPUT**
- 8. USB-C OUTLETS**
- 9. USB & USB-C POWER BUTTON & LED INDICATOR**
- 10. USB OUTLETS**
- 11. 12V DC CIGARETTE LIGHTER OUTLET (10A)**
- 12. AC INPUT SURGE PROTECTION RESET BUTTON**
- 13. 120V AC OUTLETS**
- 14. AC POWER BUTTON & LED INDICATOR**
- 15 . DC POWER BUTTON & LED INDICATOR**
- 16. SIDE VENTILATION FANS (DO NOT OBSTRUCT)**
- 17. EXPANSION BATTERY PORTS & COVERS (OPTIONAL ACCESSORY)**

# UNDERSTANDING YOUR LCD SCREEN

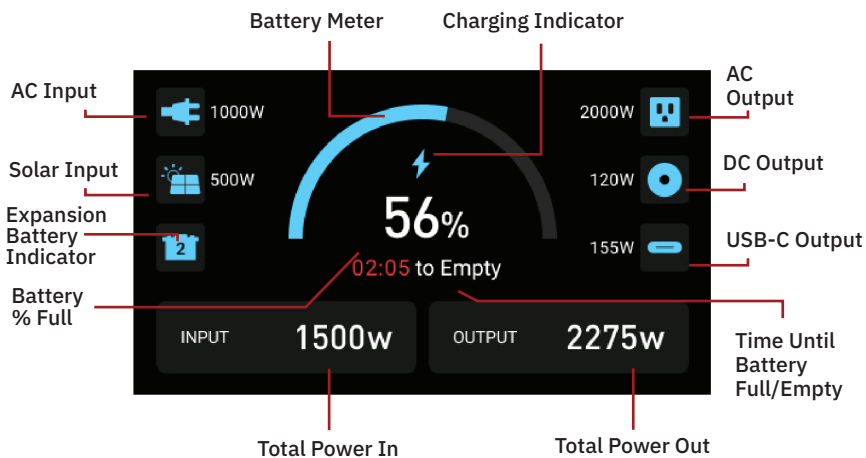

## INFORMATION SCREEN

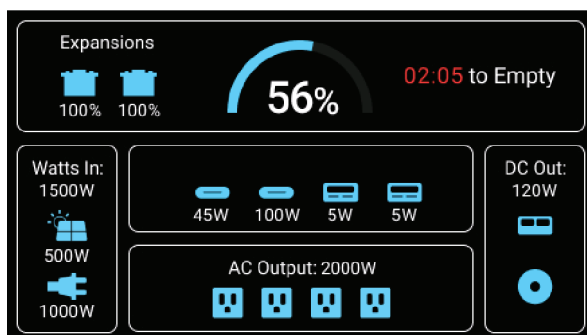

## ERROR SCREENS

**Low Temperature Warning**

Your PPG 2200X is too cold. Move the product to a warmer environment and give it time to warm up. This warning will disappear once the product temperature returns to normal.

If the problem persists, please call 4Patriots support at 1-800-304-4202

**High Temperature Warning**

Your PPG 2200X is too hot. Move the product to a cooler environment, and make sure the vents are clear so the unit can cool itself. This warning will disappear once the product temperature returns to normal.

If the problem persists, please call 4Patriots support at 1-800-304-4202

**Overload Protection**

Your appliances are drawing too much power from the PPG 2200X. Please disconnect some devices to decrease the overall power output. This warning will disappear once the power output returns to an acceptable level.

If the problem persists, please call 4Patriots support at 1-800-304-4202

# CHARGING & OUTLET USAGE

## AC CHARGING

### WARNING

Never use a damaged or frayed AC cord; electrical shock can occur. If cord is damaged, replace with a new cord before proceeding.

#### Charging your unit:

1. Insert the provided AC cord into the AC Input port located on the front of the unit (see image on the right), then plug the other end into a standard AC wall outlet.
2. While the unit is charging, the lightning bolt icon will appear, and the battery indicator will animate on the screen.
3. The lightning bolt icon will remain illuminated as long as the unit is plugged into a charging source.
4. Once your unit is fully charged, unplug the cable from both the wall outlet and the front of the generator. You may now turn off the generator. For convenient storage, wrap the cable around the handle.
  - Never leave your unit unattended while it is charging.
  - Never store your unit in a charging state.
  - If the unit is plugged into an AC outlet at the same time it is being used to power an AC device, the unit will pass wall power through to the AC device rather than using up its own battery energy. Any extra energy that the AC device is not using will go to charging the battery, allowing you to charge your device as quickly as possible while also being able to use it at the same time.
  - You can charge your generator via AC and DC simultaneously, but there is a maximum input of 1500 watts.
  - DO NOT leave your generator unattended while charging through the AC port.



## DC / SOLAR CHARGING

### WARNING

Never use damaged or frayed DC cord; electrical shock can occur. If cord is damaged, replace with a new cord before proceeding.

## Charging your unit:

1. Connect your charging source (e.g., solar panel, hand crank, windmill, etc.) to the front of the unit (see image on the right). You can use the 25-foot Solar Extension Cable to reach solar panels that are placed outdoors in direct sunlight.
2. While the unit is charging, the lightning bolt icon will appear and the battery indicator will animate. The solar panel icon will also illuminate.
3. When the unit is fully charged, the screen will display 100%. The lightning bolt icon will remain illuminated while the unit is charging and will turn off once charging is complete.
4. When your unit is fully charged, disconnect the charging cables.

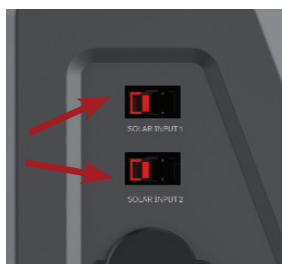

*Note: The acceptable DC charging voltage range is 12-59 VDC. If any other VDC is used, the unit could be damaged.*

## AC USAGE OUTLETS

### WARNING

Never use damaged or frayed AC cord; electrical shock can occur. If cord is damaged, replace with a new cord before proceeding.

### To use your AC Outlets:

1. Plug the device(s) you want to run into the AC plugs.
2. Press the AC OUTPUTS power button (see image on right). Once on, the outlets will work like normal AC wall outlets in your home.

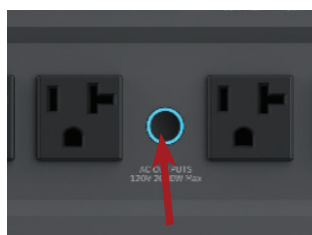

- In order to protect the inverter and battery, any sustained discharge over 2200 W will cause the unit to shut down. Decrease the overall load before turning the ports back on.
- The watt meter, found on the LCD display, shows the amount of power being used by the generator. Please note this power output is an estimation, and actual output may vary from displayed values.

## DC USAGE OUTLETS

### WARNING

Never use a damaged or frayed DC cord; electrical shock can occur. If cord is damaged, replace with a new cord before proceeding.

### To use the DC Auxiliary Outlet & DC Port:

1. Plug the extension cord into any 12V device that is rated for a max of 10 amps.
3. Plug the other end of the extension cord into the Auxiliary DC Outlet on the front your unit (see image on right). For the DC port, plug black into black and red into red.
4. Press the DC OUTPUTS power button to turn on outlets. A blue LED indicator light will turn on to confirm the outlets are on.

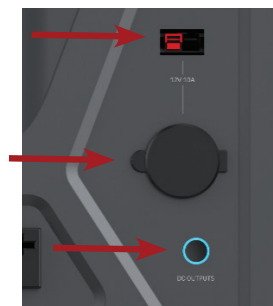

Please check with 4Patriots Customer Support for proper power requirements and compatibility (see page 24).

## DC USB & USB-C OUTLETS

### To use your USB-C and USB Outlets:

1. Plug the device you want to use into one of the available outlets.
2. Press the "USB OUTPUTS" button. (See image on right).
3. Your output wattage will show in the lower right corner of the LED screen.



The Patriot Power Generator 2200X will turn off automatically after 12 hours of no draw from the USB outlets.

## LCD SCREEN

- To toggle between screens, press the button on the right side of the LCD screen.
- Error codes will clear automatically once the issue is resolved..

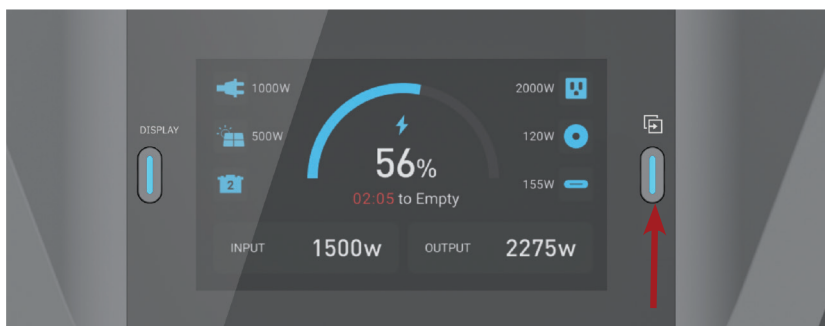



## PASS-THROUGH

This product is equipped with pass-through technology. Connect the product to a wall outlet using the included AC charging cable, connect your appliance to an AC output port on the product and press the AC power button. You will see a blue light around the button. Your appliance will run using grid power from your wall while the battery in this unit is kept at 100%. This will not harm the battery in any way. If power from the grid fails or the circuit breaker is tripped, the generator will automatically begin powering your appliance until grid power is restored. During pass-through use, ensure this item is stored according to the below *Moving & Storage Instructions* section of this manual.

## USER MAINTENANCE INSTRUCTIONS

To keep this item in good condition, it should be cycled at least once every 6 months. Connect an appliance and drain the battery to 0% before recharging back to full charge. This helps to keep the battery charged and in good working order for when you need it.

Keep this item away from water. If you fear the unit has been exposed to water, unplug any charging cables and turn off all outputs and the LCD screen immediately. Place the unit somewhere protected and dry and allow the unit to air dry completely before attempting to use the product. NEVER submerge the unit in water.

Keep this item clean of dust and debris. To clean the unit, FIRST disconnect all cables, power down the outputs and LCD screen and wait 2 minutes before cleaning. Wipe the unit free of dust using a dry cloth. Avoid using water to clean, especially near the vents or any electrical ports. Never put fingers or hands into the product.

## MOVING & STORAGE INSTRUCTIONS

Keep this item away from water. Ensure it is stored in a cool, dry place. Never store the unit on the ground if there is any danger of flooding. See *Technical Specifications* on pages 26-27 for acceptable storage temperatures.

Disconnect all cables and deactivate the outputs & LCD screen if intending to store the product for extended periods. This will help to keep the battery full.

This product is equipped with pass-through technology. Connect the product to a wall outlet using the included AC charging cable, connect your appliance to an AC output port on the product and press the AC power button. You will see a blue light around the button. Your appliance will run using grid power from your wall while the battery in this unit is kept at 100%. This will not harm the battery in any way. If power from the grid fails or the circuit breaker is tripped, the generator will automatically begin powering your appliance until grid power is restored. During pass-through use, ensure this item is stored according to the instructions above.

This product weighs 57.5 lbs. Be sure you are capable of safely lifting this weight before attempting to carry this product. Use proper lifting techniques to protect yourself from injury. Never attempt to move this product with the expansion batteries. Disconnect the expansion batteries and move each item separately. If moving this using a furniture dolly, cart or other equipment, ensure your equipment is capable of handling the weight of the product, and always follow the manufacturer instructions for your equipment.

## **TROUBLESHOOTING/FAQ**

### **1. My Patriot Power Generator won't turn on.**

- Please make sure the master power button is turned on.
- Make sure the AC power button, in the center of the AC outlets on the front of the unit, has been pressed ON. When the blue LED is lit, your Patriot Power Generator AC outlets are on and ready for use.
- When the battery in the Patriot Power Generator is empty and the unit shuts down automatically, you will need to plug the unit into an AC outlet to reset the unit. Once the unit is reset it will turn back on and should work as normal.
- For the Patriot Power Generator to function at its highest ability, it must be charged after being used and must not be abused, misused or damaged. Please ensure all of these conditions are met.
- Should you encounter further trouble, please contact our Customer Support team (see Contact Information on page 24).

### **2. I used the Patriot Power Generator once, and now it won't charge when I plug it into the wall.**

- The Patriot Power Generator is designed to work for over 4,000 full discharge and charge cycles. If it will not charge, follow these steps:
  - Please make sure the "Activate Screen" button is turned on.
  - Disconnect the power cable from the unit and wall outlet.
  - Inspect the cable for damage to both ends and the cable itself.
  - Inspect the Patriot Power Generator and the wall outlet for damaged sockets or disfigurement.
  - After ensuring all connections are clean and free of any debris that may prevent a solid connection, reconnect the Patriot Power Generator and check the LCD display for a charging status.
  - If the Patriot Power Generator does not function after following these steps, contact Customer Support (see Contact Information on page 2).

### 3. My Patriot Power Generator won't hold a charge.

- The Patriot Power Generator retains approximately 50%–80% of its 2,240 watt-hour capacity after one year of storage. To prolong battery life, it's important to fully charge the unit every 3–6 months during periods of non-use. If your generator has been stored for an extended time, it will likely need to be recharged before it can be used again. You can recharge the unit using either an AC or DC power source, connected to their respective input ports.
- While the Patriot Power Generator has a very large energy capacity, it is not limitless and after being used will need to be recharged. Think of the Patriot Power Generator as a glass and energy as water: When you drink water from a glass, it does not refill itself. You have to refill it if you want it to be full of water again.
- If the Patriot Power Generator will not function after you have followed these steps, contact Customer Support (see Contact Information on page 2).

### 4. How do I know when my Patriot Power Generator is fully charged?

- To calculate approximately how long it will take to fully charge the Patriot Power Generator from empty, use this formula:  $2240 \text{ Wh} / \text{Output power of your charging source (e.g. solar panel, hand crank, windmill, etc.)} = \text{Hours needed to fully charge.}$
- To ensure the Patriot Power Generator is fully charged while using the AC 120V charger:
  - Turn all power buttons OFF.
  - Plug the provided three-pronged AC cable into the unit, then insert the other end into an AC wall outlet.
  - The LCD display should show a lightning bolt symbol on the screen to indicate charging.
  - Continue charging the Patriot Power Generator for 1.5 hours.
  - After that point, the Patriot Power Generator will be finished charging. The LCD should show a 100% charge.

*Note: The lightning bolt only indicates that the generator is plugged into a power source. It does not mean the unit is still charging. The unit is finished charging when the screen shows 100%.*

- To ensure the Patriot Power Generator is optimally charged when using a DC 12-59V power source:
  - Ensure all power buttons are in the OFF position.

- Connect the DC power source to one of the DC charging inputs on the front of the generator (plug black to black and red to red).
- 4Patriots Solar Panels have plugs that are specifically designed so that only the proper cable will match the input on your Patriot Power Generator. When using any 3rd-party DC power source, Ensure the voltage falls within the 12-59V limits of the Generator. You may also need to adjust the red and black connectors from your source to match the solar input of the generator. To do this, push the rubber cover up the cable, away from the red and black connectors. Detach the connectors by pushing on the open face on one connector while pulling from the back (cable side) of the other (one has been slid into a groove on the side of the other connector). Arrange the connectors in the proper configuration (check by aligning them with your generator) and reconnect them. You may now replace the rubber cover.

**⚠ Disclaimer - After Market Device Use**

*This product is designed for use with approved accessories only. Using aftermarket or non-approved devices may cause damage or safety risks. By doing so, you assume all responsibility for any issues that arise. The manufacturer is not liable for damage or malfunctions caused by non-approved components.*

- Let the Patriot Power Generator charge for the estimated time displayed on the screen. When the lightning symbol disappears and the screen shows 100% full charge, you can disconnect the power cable from the front of the unit. The Patriot Power Generator has a cutoff built into it that will stop current from flowing to it after the Patriot Power Generator is fully charged. Even with this safety feature, do not leave a generator to charge unattended. Keep the unit in a place you can monitor as you charge the unit to ensure proper charging.
- Some energy sources are more reliable than others. Know the type of electricity and the current you are putting into your Patriot Power Generator. For instance, if you have a Patriot Power Generator and two DC 12V 100-watt solar panels, you know that when connected to the Patriot Power Generator and in direct sunlight, the panels will give 200 Watts of DC at 12V energy to the battery. The battery has a capacity of 2240 watt-hours, so it will take roughly 12-14 hours of direct sunlight to charge the Patriot Power Generator.

## **5. How do I know when my Patriot Power Generator is fully discharged?**

- The Patriot Power Generator has an LCD display that will show the wattage being used and the battery status bar. These will let you know the status of your battery while charging or discharging. Do not attempt to discharge the Patriot Power Generator once the battery status bar shows there is no power left. Doing so will cause damage to the unit and will void your warranty.

*Efficiency Statement: If you have a device (such as a laptop computer with AC 120V power cable) connected to the Patriot Power Generator and are using the device as it charges, the generator battery will drain more quickly. To prolong the usable life of your devices on the battery, turn them off while they charge and disconnect them from the generator when you are ready to use them. You should fully drain the battery of each device and turn it off again before connecting it to the Patriot Power Generator to recharge.*

## **6. I can't connect my solar panel to my Patriot Power Generator.**

- If a Patriot Power Generator solar panel was included in your order, your solar panel will come with DC port connectors, which the Patriot Power Generator is specifically designed to connect with. There are two sets of these connectors to use with any DC 12V input. These connectors are small and rectangular with one side that is red and another side that is black. Always connect black to black and red to red.
- While the ends of the connectors may appear flat and not able to connect to a similar connector, they are specially made to slide together. Match up the colors on the input side and push them together gently to form a solid connection.
- The solar panel connectors that fit your Patriot Power Generator are engineered specifically for Patriot Power Generator products. They look very similar and fit together easily.

## **7. My Patriot Power Generator won't charge when I connect my solar panels to it.**

- Solar panels work best when pointed without obstruction directly at the sun. The solar panel will not produce an adequate charge if it is:
  - Not pointed toward the sun
  - Placed behind a window (30-70% less efficient depending on window type)
  - Used indoors
  - Positioned in shade
  - Not connected to the Patriot Power Generator, either directly or by using an approved extension cable
  - Used with an unapproved or excessively long extension cable
- For optimal performance, position the solar panel at a slight angle facing south (if you are in the Northern Hemisphere), and place it in an open area at noon. Power output will be reduced in the hours before and after noon, and when the panel is not aligned with the sun's path.
- Solar panels will produce little to no power if they are placed in a shaded area, behind a window, or next to a sun-obstructing object. Remember, shadows move, so an object that is next to the solar panel may not create a

shadow during one time of the day, but may produce a shadow for some or all of the rest of the day.

- Solar panels will produce little to no power if placed vertically or facing down.

## **8. I can't connect all three of my solar panels to my Patriot Power Generator at the same time.**

- The Patriot Power Generator is designed with two DC input ports. To attach more than one solar panel to your generator, the panels need to be daisy-chained with the supplied wires on the panels themselves. If you have questions about daisy chaining, or if your DC port connector will not insert into your Patriot Power Generator, please contact Customer Support for help (see Contact Information on page 2).

## **9. I left my solar panel connected to a battery (not a 4Patriots Panel) attached to my generator and now it has less charge than the evening before.**

- Batteries will not gain any power from a solar panel at night. It may even deplete the battery if connected poorly (e.g., without a solar charge controller or to the wrong connections). Electricity is a two-way street and will flow to and from the source and to and from the destination depending on the current, charge, power draw, as well as a few other factors. Unless electricity is governed and controlled with technology such as a solar charge controller, you cannot be assured of the results when charging with solar panels, batteries or other electronic components.
- The other peril of ungoverned solar charging batteries is that you may overcharge and damage the battery. This is unsafe and will not give you more energy. In fact, it will most likely reduce the charge because of the damage caused to the battery. The battery may swell and become warm. Do not use a swollen battery. Instead, carefully dispose of it in a legal and safe manner.
- Disconnect your Patriot Power Generator from any charging source when it is not charging. Unlike lead-based batteries, the lithium-based Patriot Power Generator does not need to be kept on a trickle charger or have the charger plugged in constantly to retain a charge.

## **10. I turned off the power switches on my Patriot Power Generator, but the unit's fan is still on. Should I be worried?**

- No need to worry. The fan in your Patriot Power Generator is designed to operate independently to cool internal components, even when the main power switches are turned off. This is especially common during or after charging, as the system manages heat to protect the battery and electronics. It's completely normal for the fan to run intermittently—even with the main switch in the off position.

### **11. The Patriot Power Generator emits a burning odor while operating.**

- The Patriot Power Generator should not have any odor while functioning or being stored. Dust, dirt, or debris should not be allowed to enter the Patriot Power Generator, but if it does, it may emit a very light odor similar to a clothes dryer when the generator is powered on. Use electronics-safe compressed canned air to clear the vents of your unit (only while the unit is turned off). If you notice a strong, smoky, or persistent odor, stop use immediately. Do not attempt to remove anything from the interior of the Patriot Power Generator. Do not use the Patriot Power Generator again, and contact Customer Support for repair or replacement (see Contact Information on page 2).

### **12. The Patriot Power Generator will not run my microwave after I used it to watch TV.**

- The Patriot Power Generator 2200X has a total battery capacity of 2,240 watt-hours. If you've already consumed 2,000 watt-hours (e.g., watching TV or running other devices), only 240 watt-hours remain, which may not be sufficient to power higher-demand appliances like a microwave.
- To avoid this, monitor the power consumption of your devices and plan your usage accordingly. The LCD display on your generator shows real-time wattage draw, which can help you manage and ration usage effectively.
- After each use, fully recharge the generator and turn it off to ensure the battery is ready for the next time you need it.
- For extended battery life and usage, consider connecting the generator to solar panels during operation to replenish power while in use.

### **13. The AC 120V outlet turns off when I use two electronic devices at the same time.**

- The Patriot Power Generator includes built-in safety features to protect both the user and the unit. One such feature is an automatic shutdown of the AC 120V output ports when connected devices exceed a combined continuous load of 2,200 watts (20 amps).
  - If this threshold is surpassed, power to the AC outlets will be cut off. To reset the outlets, turn off the switch located next to the AC ports, wait 5 seconds, then turn the switch back on. After resetting, continue using the generator with devices that draw a lower combined wattage.
- Example: Most hair dryers use 1500 watts on the high setting. If you are using multiple hair dryers, use a lower setting. The same lower setting suggestion applies to toasters, microwaves and electric power tools.*

**14. My Patriot Power Generator stops working when I turn up the power on my space heater while using it to power my TV.**

- The Patriot Power Generator will accommodate all power draws going out of the AC 120V output up to 2200 watts. Many space heaters draw more than 2500 watts at the higher settings. Experiment to find the optimal balance between energy conservation and heat output while enjoying your entertainment.

**15. My Patriot Power Generator got wet and now will not turn on.**

- The Patriot Power Generator can be damaged when it is used improperly or in harsh conditions. If your Patriot Power Generator is submerged in water, do not turn it on or touch it. The Patriot Power Generator contains a powerful battery, and when it comes into contact with water or any other conducting equivalent, it will create an unsafe environment, void the warranty and may cause serious injury or death.
- Additionally, the Patriot Power Generator should not be dropped from any height.

**16. Can I daisy chain my Patriot Power Generator in a series with or parallel to other Patriot Power Generator units or batteries?**

- The Patriot Power Generator 2200X is designed to be used as a standalone power source. If you would like to increase your power storage capabilities, we recommend using the Expansion Pack for Patriot Power Generator 2200X. Your generator can attach up to 2 of these batteries with each adding an additional 2240 watt hours each. You could even have additional Expandable Batteries charged and on reserve for days of power at the ready.

**17. My LCD screen turns off and I'm not sure how to turn it back on.**

- The LCD screen will turn off after 6 minutes of inactivity. Press the LCD screen button to turn it back on. The AC outlets will also automatically turn off after 12 hours of disuse.

**18. If my Patriot Power Generator battery gives out and stops working completely, can the expandable battery replace it and keep it going?**

- If one battery stops working, the unit will shut down. The main unit is programmed to distribute the power load between its internal battery and any connected Expansion Batteries. For optimal performance, it's recommended to have both the main unit and the Expansion Batteries fully charged or at the same state of charge (SOC) before use.



## **19. The percentage charge on the screen of my Patriot Power Generator seems to be incorrect. How do I fix this?**

- Plug the unit into the wall and charge it until full. Once the unit is charged all the way, the power percentage should show a correct reading.
- You can also drain the unit completely and then charge the unit until full. This will also ensure the percentage on the screen is correct.

# TECHNICAL SPECIFICATIONS

Module		Spec	Value
Battery		Battery Capacity (Th)	2240 Wh
		Battery Chemistry	Lithium Iron Phosphate
		Nominal Voltage	44.8V
		Life Cycles (down to 80% DOD)	>4000
		Charge Retention (months)	12 Months
		Expandable	6720 Wh (3x2240 Wh)
OUTPUT	Inverter	Inverter Continuous (W)	2200 W
		Inverter Peak (W)	4400 W (0.5s)
		AC Ports	4
		Inverter Type	Pure Sine Wave
		Pass-through	Yes
	Auxiliary Outlet	Number	1
		Voltage/Current	12V/10A
	DC Port	Number	1
		Power	12V/10A
	USB-A	Number	2
		Voltage/Current	QC3.0 18w
	USB-C	Number	2
		Power	1: Out PD 100W, 2: Out PD 45W

Module		Spec	Value
INPUT	Charger	Solar Input	600W x 2
		DC-Charge Rate	600W x 2
		Solar/DC Input Port	Anderson Compatible
		DC Charge Time	2 Hours
		Solar Charge with one 100-Watt Panel	28-30 Hours
		AC Charge Rate	12.5A (1500W MAX)
		AC Charge Time (Approx. Hours)	1.5 Hours
		AC Input Port	Standard Computer Power Port (C13)
		Combined Watts in (Solar & AC)	Yes
Physical Attributes		Screen	TFT, 4.3"
		Weight (LB)	57.5 LBS
		Size (Inches)	16.0" x 12.4" x 11.8"
		Operating & Charging Temperature	32-104°F (0-40°C)
		Storage Temperature	14-104°F (-10-40°C)
		Accessories	<ul style="list-style-type: none"><li>• Power Cable (Wall to C13)</li><li>• User's Manual</li></ul>

# WARRANTY INFORMATION

This Patriot Power Generator is backed by our 4Patriots 1-year manufacturer warranty. For questions about our warranty, please call Customer Support at 1-800-304-4202 or email at [help@4patriots.com](mailto:help@4patriots.com).

## 0 TO 365 DAYS FROM THE DATE OF DELIVERY:

### WHAT IS COVERED?

- Defects in materials or workmanship.
- Non-cosmetic normal wear and tear-related damages.
- To obtain return authorization, please contact our Customer Support team (see Contact Information on page 2). A Returned Merchandise Authorization (RMA) number will be issued, and a pickup will be scheduled. **Do not return any unit without prior authorization.** Returns that have been properly authorized will not be subject to a restocking fee.
- Warranty restarts with replacement unit.

### WHAT IS NOT COVERED?

- Damage or defect caused willfully or through negligence.
- Damage caused through excessive wear and tear.
- Cosmetic blemishes, scratches, or dents caused through the course of regular use.
- Damage caused by use of the unit with unsafe, unregulated, or inappropriate products, devices, power sources, or power consumption.
- Damage resulting from use of the product for anything other than what it is intended for. This warranty does not cover damage caused when the unit is used as a footstool, wheel chock, door jam, or flotation device (It does not float, is not waterproof, and may cause bodily injury or death if used as a flotation device).
- A return not previously authorized by our team. Unauthorized return shipments will be rejected or restocked without notification to the sending party.
- Upgrade to a newer model. All damaged units will be replaced with a unit of the same model that was originally purchased.

## ADDITIONAL TERMS:

1. Damage caused by willful actions or negligence will void the warranty at any time during the 365-day period. Determination of willful or negligent damage will be made upon receipt and inspection of the unit. Refunds and returns will only be processed after this inspection.
2. Any unit that has been altered or repaired by an unauthorized service is voided of any warranty.
3. All products must be returned with all included attachments and accessories, unless otherwise instructed when obtaining a return authorization number. The customer will be charged for any missing items.
4. Proof of purchase is required for warranty service. If a purchase order, receipt, or other record of purchase is not provided upon request, warranty service cannot be offered.
5. Any returned unit must be packaged safely and labeled clearly. Any damage caused by poor packaging when returning the unit is the responsibility of the customer and may void the warranty.
6. Customers should retain the serial number of any unit sent in for replacement. To assist with processing, clearly write the serial number on the outside of the shipment box. The serial number is located on the back of the unit.
7. Products that are not authorized for return as per the return instructions will not be accepted.
8. At our discretion, units will be either repaired or replaced.
9. If a unit is returned for replacement and found to be free of defects or damage, the customer will be responsible for a service fee up to \$150, as well as actual handling, shipping, and any other applicable processing costs.

[illegible]

[illegible]



Manufactured for: 4Patriots, LLC  
2420 Berry Hill Dr., Suite 300  
Nashville, TN 37204  
(800) 304-4202 | 4Patriots.com  
Made in China V1.1