

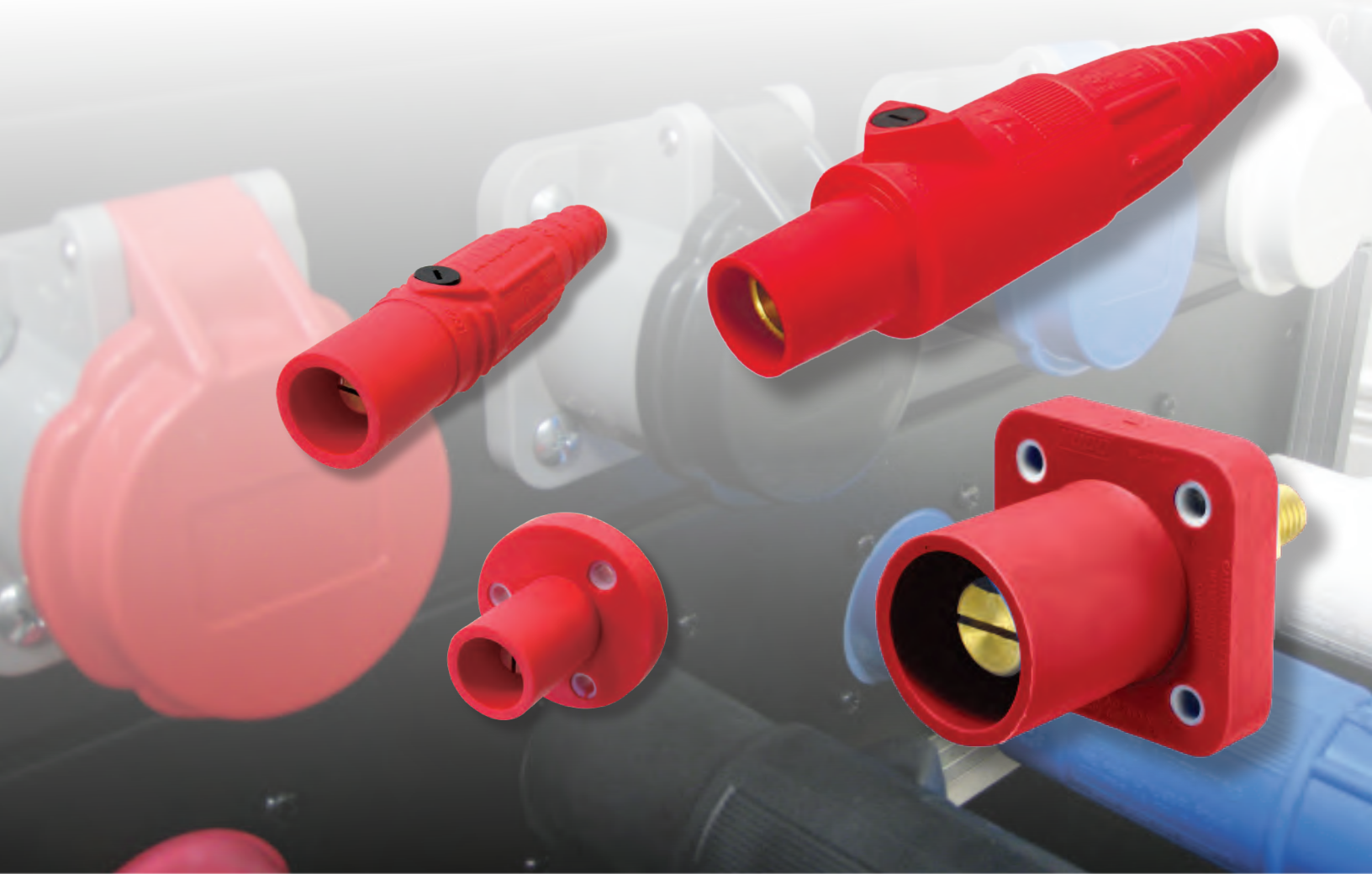

# ***SINGLE POLE CONNECTORS***

## ***150A AND 400A***



**EASTERN CANADA**  
2810 Coventry Road  
Oakville, ON  
L6H 6R1

**T:** 905.820.6150  
**F:** 905.820.6142  
**E:** [sales@techspan.ca](mailto:sales@techspan.ca)

**WESTERN CANADA**  
8176 Winston Street  
Burnaby, BC  
V5A 2H5

**T:** 604.420.0425  
**F:** 604.420.3149  
**E:** [westsales@techspan.ca](mailto:westsales@techspan.ca)

*Customer Service: 1.800.363.1588*

***TECHSPAN.CA***

# 150A K-LOK Mini-Cam Single Pole Connector



## Part Numbers:

LINE MALE



KL-150LM\*

LINE FEMALE



KL-150LF\*

RECEPTACLE MALE



KL-150SM\*

RECEPTACLE FEMALE



KL-150SF\*

DUST COVER



KL-DC\*2

RETAINING PIN



KL-150-BS

## Colour Codes:

REPLACE \* IN PART NUMBER ABOVE WITH COLOUR CODE BELOW:



BK

BLACK



R

RED



B

BLUE



W

WHITE



G

GREEN



BN

BROWN



GY

GREY

## TECHNICAL INFORMATION

Voltage Rating	600V Maximum	Contact Material	Brass
Amperage Rating	150A Maximum	Terminal Accommodation	#8, #6, #4, #2
Base Compound	Santoprene 105°C rated	Retaining Pin Material	POM

Non-conductive retaining pin for upmost safety and insulation.

Outstanding arrow point provides visible mark for mating the connectors.

The tension hole at rear side of split contact retains the contact from over pressed, so as to prevent the loose mating after several time of uses.

POM sleeve, 2x longer than others, fully encompassing the contact to make greater insulation.

Largely-ribbed housing for comfort and secure grip.

Wider range of cable accommodation from #8 AWG to #2 AWG

Double set screws for cable firmly sit in the position; additional longer set screws are supplied for mating smaller cable.

Boot made of UV-resistant Santoprene, providing excellent protection. Safer and durable.

Cable cut-off identification clearly engraved on the boot.

# 400A K-LOK Heavy Duty Single Pole Connector



## Part Numbers:

LINE MALE



KL-400LM\*

LINE FEMALE



KL-400LF\*

RECEPTACLE MALE



KL-400SM\*

RECEPTACLE FEMALE



KL-400SF\*

DUST COVER



KL-DC\*

RETAINING PIN



KL-400-BS

## Colour Codes:

REPLACE \* IN PART NUMBER ABOVE WITH COLOUR CODE BELOW:



## TECHNICAL INFORMATION

Voltage Rating	600V Maximum	Contact Material	Brass
Amperage Rating	400A Maximum	Terminal Accommodation	2/0, 4/0 POM
Base Compound	Santoprene 105°C rated	Retaining Pin Material	POM

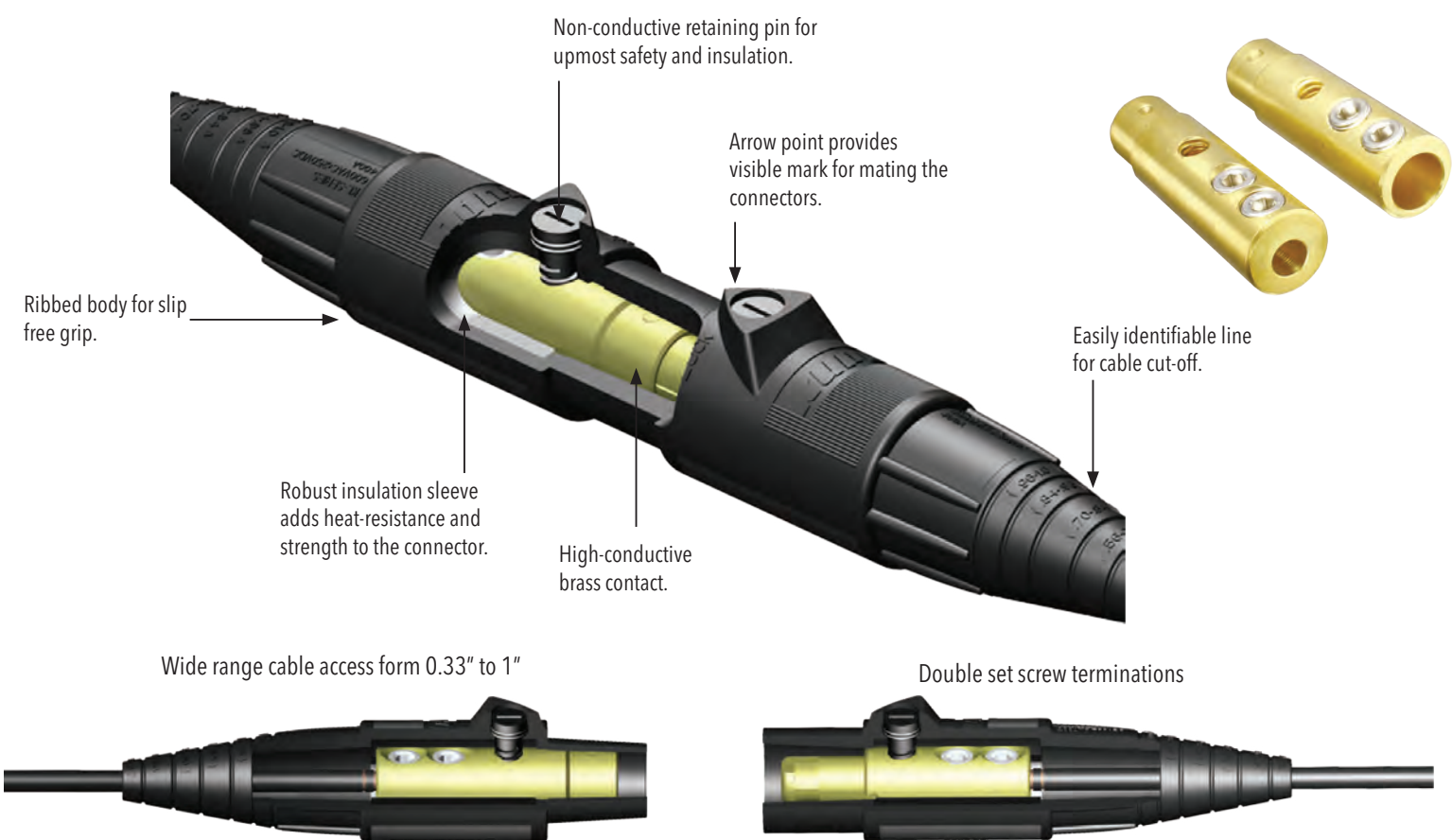

# Technical Drawings

## 150A

**+ LM**

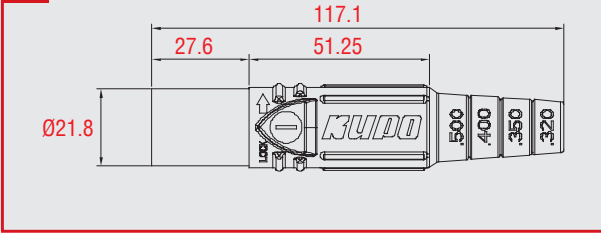

**+ SM**

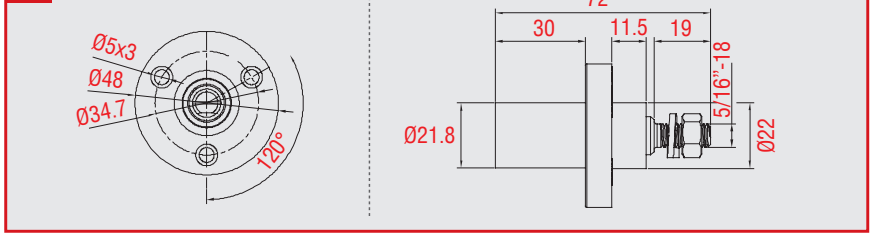

**+ LF**

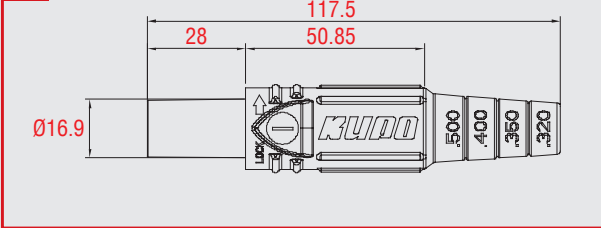

**+ SF**

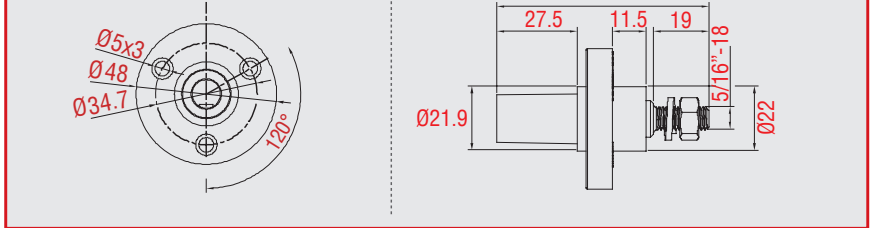

## 400A

**+ LM**

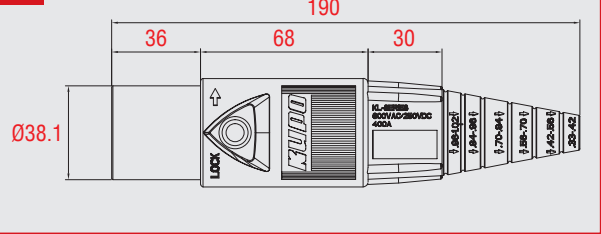

**+ SM**

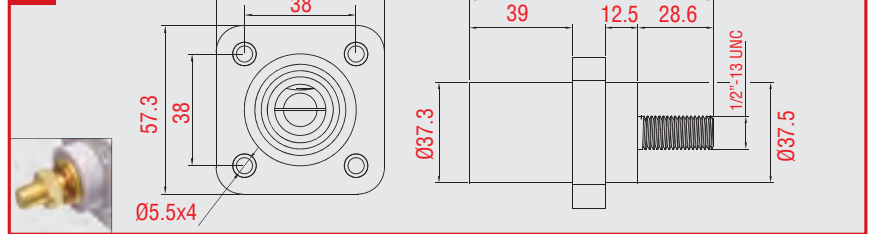

**+ LF**

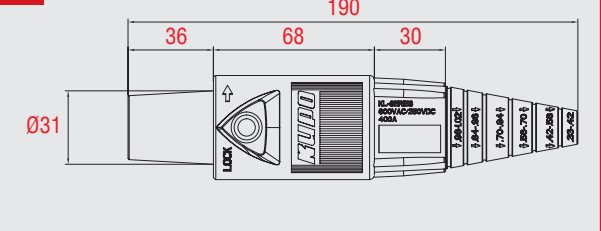

**+ SF**

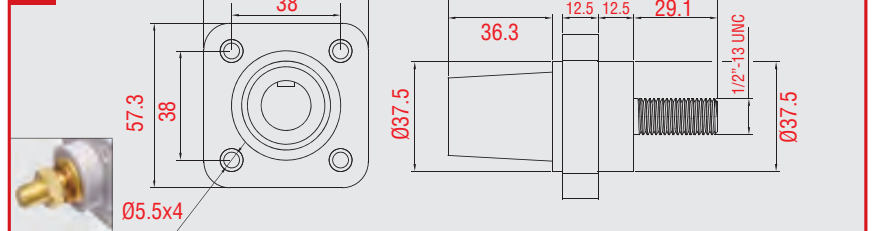

**EASTERN CANADA**  
2810 Coventry Road  
Oakville, ON  
L6H 6R1

T: 905.820.6150  
F: 905.820.6142  
E: sales@techspan.ca

**WESTERN CANADA**  
8176 Winston Street  
Burnaby, BC  
V5A 2H5

T: 604.420.0425  
F: 604.420.3149  
E: westsales@techspan.ca

Customer Service: 1.800.363.1588