

VOICE/DATA & LOW VOLTAGE

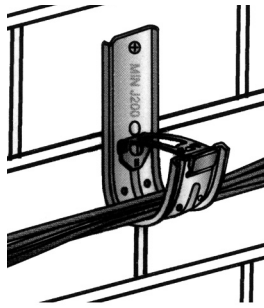

CABLE SUPPORT J-HOOKS

- Cost effective alternative to expensive cable tray.
- Accommodates Category 5, fiber-optic, and interduct.
- Provides support without stress to sensitive voice/data cables.
- Continuous wide-base radius supports natural curve of cable eliminating kinking, bending, and crimping.
- Cable wire retainer is supplied with every part.



J200

Part #	Description	Std. Pkg.
J200	2" J-Hook	50

Another solution for today's challenging installations!

The new 2" J-Hook cable support system, designed to be versatile, can be attached to a wide variety of structures using beam clamps, clips, and many other support components available from Techspan. The wide-base support eliminates the undesirable impact of point-loads that can cause band-width deterioration and damage to category 5, fiber-optic, and other sensitive cables. This unique system is labour and time saving – another efficient method of installation!

BEAM CLAMPS

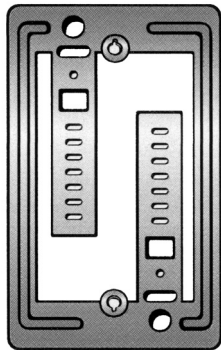

LOW VOLTAGE MOUNTING BRACKET

ZINC PLATED STEEL
HIGH CARBON STEEL

- Provides base for securing communications lines without use of electrical box. Mounts standard plate.

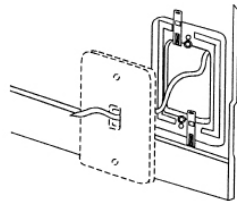

Part #	Description	Std. Pkg.
WBF-1	Mounts standard low voltage plates	100

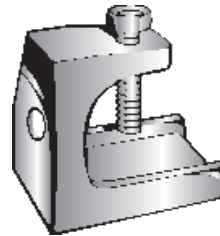

MALLEABLE BEAM CLAMP

ZINC PLATED STEEL
AFTER FABRICATION

- Used with Hangers, Bridle Rings and Drop Rods, 3/8" to 1/2". Tapped for rods bottom and back on all sizes.
- Case hardened steel set screw tapped at an angle locks on beam.

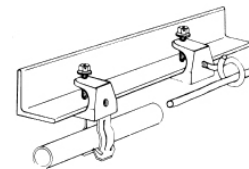

Part #	Fits Flange	Tapping	Drop Rod	Std. Pkg.
700	Up to 7/8" thick	1/4-20	1/4"	50