

## TYPE 9 HIGH TEMPERATURE TERMINALS

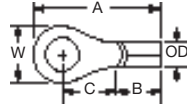

One piece, steel construction, nickel plated for protection. Capable of providing reliable circuitry in temperature ranges up to 900 degrees Fahrenheit. Structural features of all Type 9 terminals are identical to the Type 1, which proves that they will provide the highest quality connection.

### RING TERMINALS

#### BUTTED SEAM

Rated at 600V

Part #	Copper Cond. Range	Stud Size	Stock Size (in)	Approx. Dimen. in Inches				
				A	W	C	B	OD
R9A6S	22-18	6	0.028	0.66	0.290	0.260	0.25	0.133
R9A8	22-18	8	0.028	0.66	0.324	0.250	0.25	0.133
R9A10	22-18	10	0.028	0.66	0.324	0.250	0.25	0.133
R9A14S	22-18	1/4	0.028	0.89	0.470	0.405	0.25	0.133
R9B6S	16-14	6	0.030	0.66	0.295	0.260	0.25	0.152
R9B8	16-14	8	0.030	0.71	0.324	0.295	0.25	0.152
R9B10	16-14	10	0.030	0.71	0.340	0.295	0.25	0.152
R9B14S	16-14	1/4	0.030	0.89	0.470	0.405	0.25	0.152
R9C6S	12-10	6	0.038	0.72	0.342	0.297	0.25	0.217
R9C8	12-10	8	0.038	0.72	0.342	0.297	0.25	0.217
R9C10	12-10	10	0.038	0.72	0.342	0.297	0.25	0.217
R9C14S	12-10	1/4	0.038	0.99	0.558	0.469	0.25	0.217
R9C56	12-10	5/16	0.038	0.99	0.558	0.469	0.25	0.217
R9C38	12-10	3/8	0.038	0.99	0.558	0.469	0.25	0.217

For use with Copper Solid and Stranded Wire Only

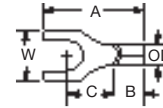

### SPADE TERMINALS

#### BUTTED SEAM

Rated at 600V

S9A10	22-18	10	0.028	0.73	0.312	0.321	0.25	0.07
S9B10	16-14	10	0.030	0.73	0.344	0.303	0.25	0.09
S9C10	12-10	10	0.038	0.72	0.35	0.294	0.25	0.13

For use with Copper Solid and Stranded Wire Only

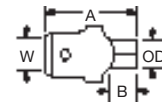
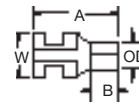

### MALE AND FEMALE DISCONNECTS

#### BUTTED SEAM

Rated at 600V

Part #	Copper Cond. Range	Stock Size (in)	A	W	B	OD
FR9B250	16-14	.032 x .250	0.650	0.30	0.25	0.133
MT9B250	16-14	.032 x .250	0.690	0.25	0.25	0.152
FR9C250	12-10	.032 x .250	0.660	0.30	0.25	0.175
MT9C250	12-10	.032 x .250	0.705	0.25	0.25	0.217

For use with Copper Stranded Wire Only

### BUTT CONNECTORS

#### BUTTED SEAM

Rated at 600V

Part #	Copper Cond. Range	A	OD
B9A	22-18	0.560	0.133
B9B	16-14	0.560	0.152
B9C	12-10	0.625	0.212

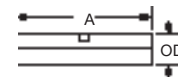

For use with Copper Solid and Stranded Wire Only

Add Suffix "M" for 1000 pack  
Standard Pack - 100 pack

Installing Tools (22-10AWG): RAT-NINS, HTS1000, 453, RHT-1992

B