

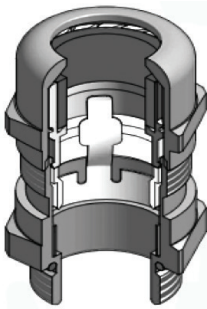

SPECIFICATIONS

Materials	Brass, Nickel-Plated
Clamping Insert	Polyamide 6 V2
Contact Spring	Special Copper Alloy
Protection Class	IP68 - 5 Bar
Seal	Chloroprene
O-Ring	NBR
Attachment Thread	EN60423

DOME CAP STANDARD EMC CABLE GLANDS WITH METRIC OR NPT THREADS



Dome Cable Glands	Locknuts	Thread Type & Size	Clearance Hole (inches)	Thread Length (inches)	Across Flats (inches)	Cable Range Ø (inches/min-max)	Shield Diameter Ø (inches/min)
EMC/METRIC THREADS							
BRM4E12	RLEM12	M12X1.5	0.47	0.24	0.55	.118 - .256	.078 - .197
BRM4E16	RLEM16	M16X1.5	0.63	0.24	0.79	.197 - .394	.138 - .314
BRM4E20-2S	RLEM20	M20X1.5	0.79	0.24	0.87	.236 - .472	.177 - .394
BRM4E20	RLEM20	M20X1.5	0.79	0.31	1.00	.295 - .551	.216 - .453
BRM4E25	RLEM25	M25X1.5	1.00	0.31	1.18	.394 - .709	.275 - .551
BRM4E32	RLEM32	M32X1.5	1.26	0.35	1.57	.630 - .984	.472 - .787
BRM4E40	RLEM40	M40X1.5	1.57	0.35	1.97	.866 - 1.260	.709 - 1.063
BRM4E50	RLEM50	M50X1.5	1.97	0.35	1.97	1.181 - 1.496	1.024 - 1.339
BRM4E60	RLEM60	M63X1.5	2.48	0.55	2.52	1.339 - 1.732	1.181 - 1.575
BRM4E63	RLEM63	M63X1.5	2.48	0.39	2.95	1.457 - 2.087	1.300 - 1.929

Part No.	Size	Cable Range Ømin-max mm	Shield Dia. Ømin-max mm	Thread Length	Across Flats
EMC/NPT THREADS					
BRN4E13	NPT 1/2"	.236 - .472	.177 - .394	0.314	0.866
BRN4E13S	NPT 1/2"	.295 - .551	.216 - .453	0.314	0.944
BRN4E21	NPT 3/4"	.394 - .709	.275 - .551	0.314	1.181
BRN4E29	NPT 1"	.630 - .984	.472 - .787	0.354	1.574
BRN4E36	NPT 1 1/4"	.866 - 1.260	.709 - 1.063	0.354	1.968
BRN4E42	NPT 1 1/2"	1.180 - 1.496	1.024 - 1.338	0.551	2.362
BRN4E48	NPT 2"	1.338 - 1.732	1.181 - 1.575	0.551	2.677

Hub Size	Steel	Brass
OPTIONAL LOCKNUT PART NUMBERS		
NPT 1/2"	LN-50	NN-13-BR
NPT 3/4"	LN-75	NN-21-BR
NPT 1"	LN-100	NN-29-BR
NPT 1 1/4"	LN-125	N/A
NPT 1 1/2"	LN-150	N/A
NPT 2"	LN-200	N/A

G