

**ATTENTION TO INSTALLERS:**

This DC ceiling fan requires complete assembly and installation BEFORE testing for correct operation. The fan motor will not continue to operate without the fan blades attached.

**Miami Ceiling Fan**

48": 207963xx

52": 207964xx

60": 207965xx

**Miami Ceiling Fan with LED Light**

48": 207966xx

52": 207967xx

60": 207968xx

# TABLE OF CONTENTS

## FOR YOUR SAFETY:

SAFETY WARNINGS .....	3
-----------------------	---

## BEFORE INSTALLATION:

WHAT COMES IN THE BOX .....	4
ACCESSORIES .....	4
SPECIFICATIONS .....	4

## INSTALLATION:

SELECTING A LOCATION .....	5
INSTALLING THE MOUNTING BRACKET .....	5
INSTALLING THE FAN .....	6
RF WALL CONTROL INSTALLATION .....	8
WIRING DIAGRAM .....	9

## RF CONTROLS PAIRING:

DUAL RF PAIRING .....	10
HANDHELD RF REMOTE PAIRING .....	10
REMOVE PAIRED RF HANDHELD REMOTE CONTROL FROM FAN .....	10
ENABLE SMART CONTROL .....	10
RF WALL CONTROL PAIRING .....	11
REMOVE PAIRED RF WALL CONTROL FROM FAN .....	11

## FUNCTIONS & OPERATION:

FUNCTIONS .....	12
OPERATING YOUR RF HANDHELD REMOTE CONTROL .....	12

## RF WALL CONTROL - FUNCTIONS & OPERATION:

OPERATING YOUR RF WALL CONTROL .....	13
FAN ON / OFF & SPEED SELECTION .....	13
LIGHT OPERATION (WITH LIGHT MODELS ONLY) .....	13
NATURAL BREEZE .....	14
TEMPERATURE-BASED AUTOMATION .....	14
TEMPERATURE SETTINGS .....	14
TIMER .....	15
REVERSE FUNCTION .....	15

## CLEANING & MAINTENANCE:

MAINTENANCE .....	16
CLEANING .....	16

## TROUBLESHOOTING:

TROUBLESHOOTING & CHECKLIST .....	16
-----------------------------------	----

## WARRANTY:

1. AUSTRALIAN CONSUMER LAW .....	17
2. LIMITED REPAIR / REPLACEMENT WARRANTY .....	17
3. IN-HOME WARRANTY .....	17
4. WARRANTY TRANSFER .....	18
5. COMMERCIAL USE .....	18
6. WARRANTY CONDITIONS .....	18
7. WHAT IS NOT COVERED .....	19
8. HOW TO MAKE A WARRANTY CLAIM .....	19

## FOR YOUR SAFETY:



### Safety Warnings

1. Please read this manual carefully before attempting the assembly or installation of your new ceiling fan.
2. ALL electrical work should only be carried out by a suitably qualified and licenced electrical contractor. This ceiling fan **MUST** be installed **ONLY** by a suitably qualified and licenced electrical contractor.
3. This appliance is not intended for use by persons (including children) with reduced physical, sensory or mental capabilities, or lack of experience and knowledge, unless they have been given supervision or instruction concerning the safe use of the appliance, by a person responsible for their safety.
4. Do **NOT** allow children to play with this appliance and supervise children around electrical devices at all times.
5. Before commencing any electrical work, ensure the power is disconnected and/or the mains switched off at the circuit box and ensure all pole isolation of the power supply.
6. The fixing point for your ceiling fan must be of sound construction, undamaged, and capable of supporting a load of 26Kg, or 4 times the weight of the fan plus the method of attachment, whichever is greater. Verifying the stability of the mounting structure is the sole responsibility of the consumer and qualified installer.
7. Care needs to be taken to ensure the installation location does not allow the fan blades to come into contact with any object or surface. There must be a minimum of 30cm clearance between the blade tip (end) and the nearest wall or object. Reduced clearances to walls or ceilings can also reduce the amount of air your fan can move.
8. The installation must also allow for a minimum clearance of 2.1m between the floor and the bottom of the blades. The installation must allow for a minimum of 3.0m between ceiling fans.
9. Do not install or use your fan if any part/s are damaged or missing. Use only EGLO replacement parts.
10. Both the ceiling fan and the hanging bracket must be earthed.
11. The fan must be connected to a mains supply only. Fans connected to alternate power systems such as Solar, Wind, Battery etc will not be covered under the terms of this warranty.
12. **WARNING:** To reduce the risk of electrical shock and fire, do not use this fan with any solid-state fan speed control device. Install and operate with **ONLY** the EGLO controllers supplied with your fan, or a suitable EGLO controller designed specifically for your fan.
13. **WARNING:** Do not insert foreign objects into or in-between rotating fan blades.
14. **ONLY** change the direction of your fan as instructed to in this manual.
15. Do not use water or detergents when cleaning the fan or fan blades. A dry dust cloth or lightly dampened cloth will be suitable for most cleaning.
16. All EGLO products are warranted to be free from defects in workmanship and materials provided the products are used with a voltage supply within the range the product is designed to operate.
17. This fan is designed for indoors use, and for areas that are suitable covered to ensure that no water or moisture can come into direct contact with the ceiling fan.
18. EGLO lighting will not be liable for any advice given to the consumer from any of our suppliers or third parties, related or otherwise.
19. Proper performance relies on the right fan being correctly installed in the optimum location. Fans that do not perform as expected and which are not faulty cannot be replaced or exchanged under warranty.
20. The important safeguards and instructions in this manual are not designed to cover every possible condition or circumstance. It is understood that common sense, caution and care are factors that cannot be built into the product, those using and maintaining this product must supply these factors.



Do not dispose of electrical appliances as unsorted municipal waste, use separate collection facilities. Contact your local council for more information regarding the collection systems available. If electrical appliances are disposed of in landfills or dumps, hazardous substances can leak into the ground water and get into the food chain, damaging your health and well-being.

EGLO Lighting has a policy of continual product improvement and development, dimensions, hardware and designs may change to reflect this policy. EGLO reserves the right to discontinue or change product specifications & designs at any time without notice and without incurring obligations. The images including all features and specifications in this manual are for illustrative purposes only. Product details, images & line drawings may vary depending on specific product models.

# BEFORE INSTALLATION

## What Comes In Your Box:

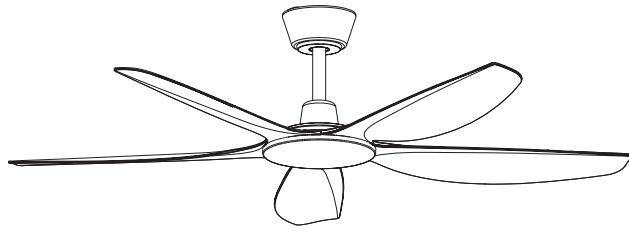

No Light model

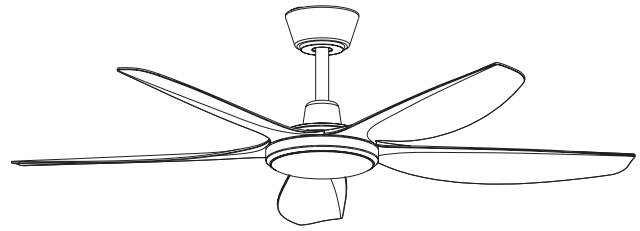

With LED Light model

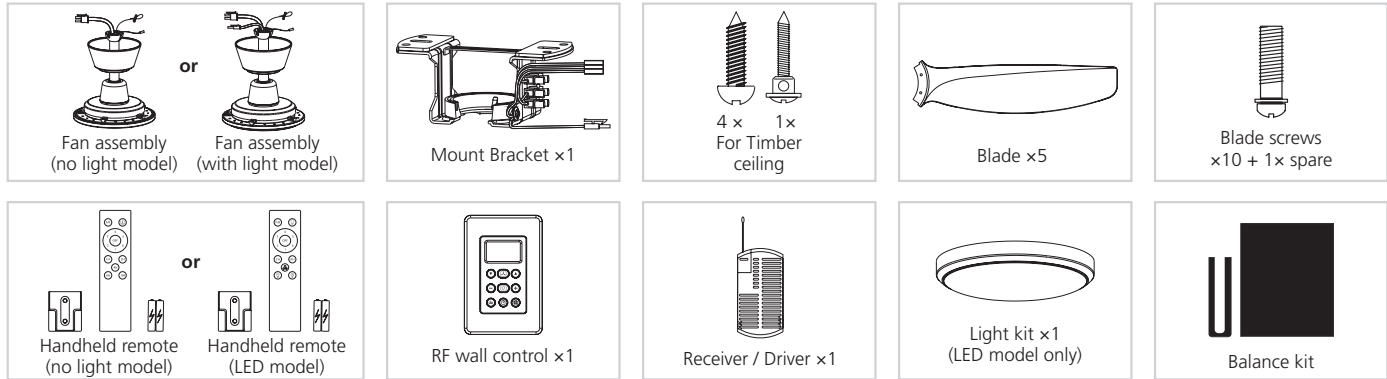

## Accessories (Sold Separately):

**Downrods:** 20800201 (45cm White), 20800202 (45cm Black)  
 20800301 (60cm White), 20800302 (60cm Black)  
 20800401 (90cm White), 20800402 (90cm Black)  
 20800501 (180cm White), 20800502 (180cm Black)

**Angle Canopy:** 20557501 (White), 20557502 (Black) for ceilings with up to 38-deg pitch.

For more information on available accessories visit: [www.eglo.com/au/ceiling-fans/ceiling-fan-accessories](http://www.eglo.com/au/ceiling-fans/ceiling-fan-accessories).



Accessories

## Specifications:

**Input:** AC 220-240 V, 50/60 Hz  
**Wattage:** 40 W (48"), 45 W (52"), 50 W (60")  
**Weight:** No Light models: 5.6 kg (48"), 5.7 kg (52"), 6.2 kg (60")  
 With Light models: 5.9 kg (48"), 6.0 kg (52"), 6.5 kg (60")  
**Controller:** RF handheld remote + RF wall control with 'Active Dual Pairing'.  
 Two RF wall / handheld remotes can be connected to the fan at the same time.  
**Frequency:** 2.4GHz wireless network & Bluetooth for smart device connection.  
 433.92MHz for RF handheld remote & RF Wall control

ACTIVE  
DUAL  
PAIRING

SMART  
my  
control  
ENABLED

### Dimensions:

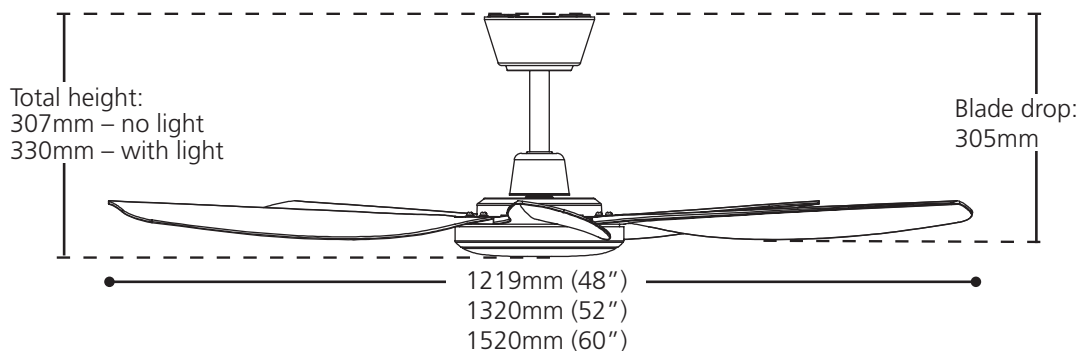

# INSTALLATION

## Selecting A Location

- The ceiling fan must be installed in a location so that the blades are a minimum 30cm spacing from the tip of the blade, to the nearest objects or walls. **(Fig. 1.)**
- The ceiling fan must be installed in a location so that the blades are a minimum 2.1m above the floor.
- The fixing point for your ceiling fan must be of sound construction, undamaged, and capable of supporting a load of 26Kg, or 4 times the weight of the fan plus the method of attachment, whichever is greater. If the location does not have a solid mounting point, you will need to install a timber support between two ceiling joists. **(Fig. 2.)**
- Many EGLO fans are designed for indoor use, though they can also be installed in appropriately covered outdoor locations where the fan is fully undercover with a minimum of 2 walls. This fan is not waterproof. When installed in outdoor areas, the ceiling fan must be installed in a location protected from water, wind, dust, and salt. Exposure to these elements will void the warranty. In some more tropical areas of Australia, it is suggested you increase the distance from the fan to the edge of the roof.

Fig. 1.

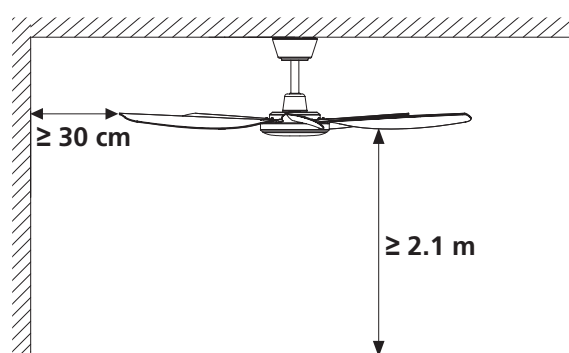
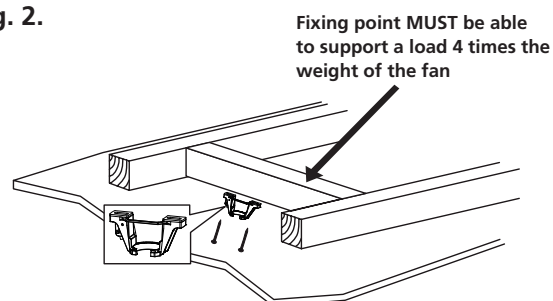

Fig. 2.



**Note:** Image is for representation only, and does not represent the actual bracket.

## Installing The Mounting Bracket

**IMPORTANT: CHECK THAT THE POWER IS DISCONNECTED AND/OR THE MAINS SWITCHED OFF AT THE CIRCUIT BOX TO ENSURE ALL POLE ISOLATION OF THE POWER SUPPLY.**

### Installing onto Joist or Timber Support:

1. Install the mounting bracket to the ceiling joist or timber support with the long installation screws provided. Pass the screws through the round holes in the mounting bracket and secure to the ceiling. **(Fig. 3.)**
2. Install the safety cable screw through one of the slotted holes in the mounting bracket.
3. Ensure that at least 30mm of the screw is threaded into the ceiling joist or timber support.

### Installing onto Concrete Ceiling:

1. Install the mounting bracket to the concrete ceiling with expansion bolts (purchased separately). Pass the bolts through the round holes in the mounting bracket and secure to the ceiling. **(Fig. 4.)**
2. Install an expansion bolt with hook through a slotted hole and secure tightly. This is for securing the safety cable to.

Fig. 3.

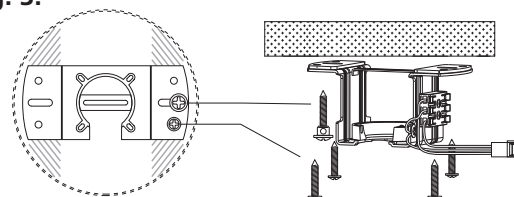

**Note:** Ensure that the cable entry is positioned only in the shaded sections, or it will obstruct the remote receiver.

Fig. 4.

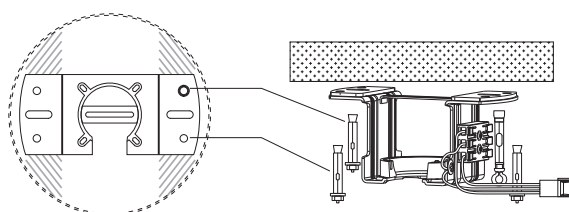

**Note:** Ensure that the cable entry is positioned only in the shaded sections, or it will obstruct the remote receiver.

# INSTALLATION

## Installing the fan

1. Stand the motor on a soft surface, slide blade into blade retaining slots on housing, and fix with 2x provided blade screws each time. **(Fig. 5)**

Fig. 5.

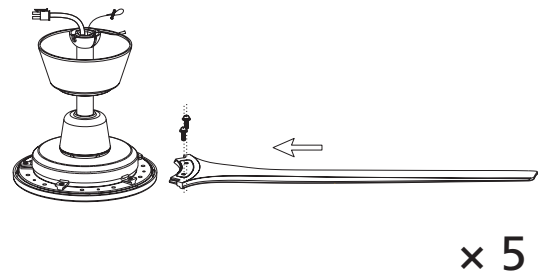

2. **No Light models:** with all 5 blades installed, go to step 5. **(Fig. 6)**

Fig. 6.

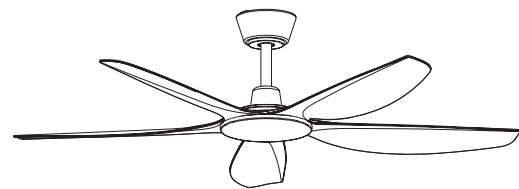

**No Light models:**  
Assembly complete, go to step 5

3. **With Light models:** Fix light kit to bottom of fan with screws provided. **(Fig. 7)**

Fig. 7.

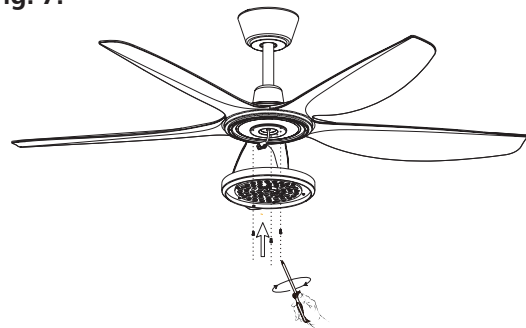

4. **With Light models:** Connect the plug connector from fan to terminal located on the LED board and twist light shade to lock. **(Fig. 8)**

Fig. 8.

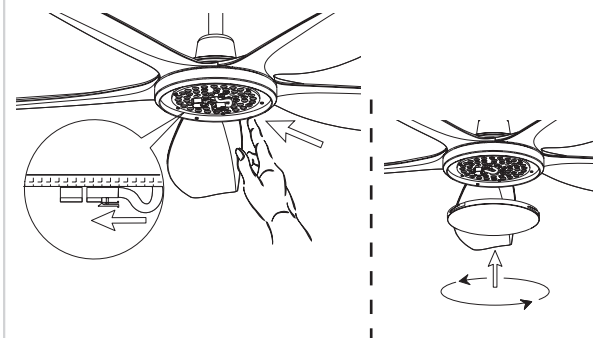

# INSTALLATION

## Installing the fan

- Carefully lift fan assembly to mounting bracket and seat downrod hanger ball to the stopper of bracket. **(Fig. 9)**

Fig. 9.

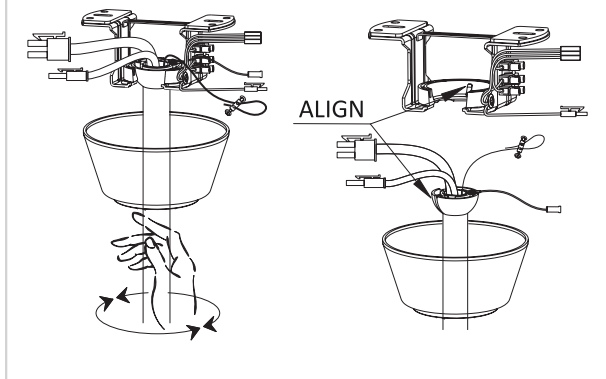

- Pass safety cable through hole of screw, adjust the cable to the minimum length, and lock by tightening both screws. **(Fig.10)**

Fig. 10.

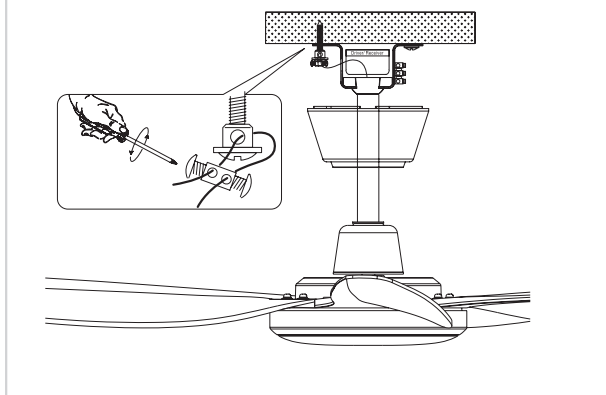

- Position the Receiver/Driver near the mounting bracket, ensuring the antenna is closest to the mounting bracket and that the flat side of the Receiver/Driver is facing towards the ceiling. Push the Receiver/Driver into the mounting bracket. **(Fig. 11)**

Fig. 11.

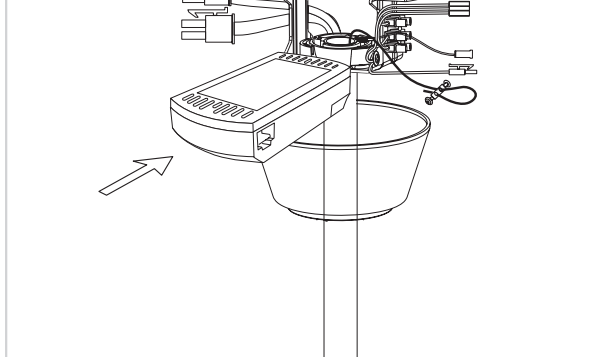

- Connect all plug connectors, with reference to the Wiring Diagram on page 10.

- Raise the canopy up to the hanger bracket, carefully tucking cables inside the canopy ensuring that no wires are damaged during this step. **(Fig. 12)**

Fig. 12.

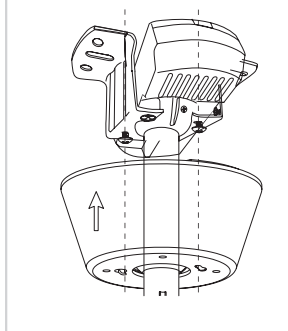

- Align the screw holes in the canopy with the screws on the underside of the mounting bracket, and twist the canopy clockwise, then secure by tightening the screws on the underside of the mounting bracket, then raise the canopy ring up to the canopy, align the canopy ring lugs with the corresponding holes in the canopy and press firmly to attach. **(Fig. 13)**

Fig. 13.

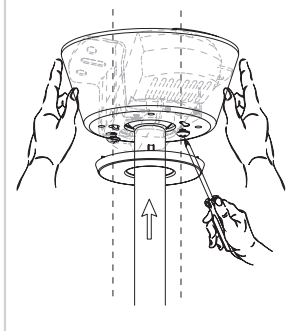

# INSTALLATION

## RF Wall Control Installation

**Note:** This RF wall control should be installed in the same room/area as your ceiling fan.

**Note:** This RF wall control does not act as isolation switch.

11. The RF radio frequency is designed for normal transmission distance of approximately 8-10m, however this range can be reduced depending on the building materials used in construction. For best results, position the RF Wall Control no more than 8m from the ceiling fan it is to operate.

12. IMPORTANT: Recheck that the power is disconnected and/or the mains switched off at the circuit box to ensure all pole isolation of the power supply.

(Fig. 14.)

13. Strip the end of the main household supply wires to expose max. 6mm of bare copper. The wall controls allows for 0.75 – 4.0mm<sup>2</sup> of either rigid or stranded cable. (Fig. 15.)

14. Connect supply LIVE wire to either L1 or L2 terminal on rear of wall control. (Fig. 16.)

15. Connect supply NEUTRAL wire to either N1 or N2 terminal on rear of wall control. (Fig. 16.)

16. Attach the RF wall control to the household wall plate (not incl.) or surface mounted wall plate (not incl.) using the screws provided. (Fig. 17.)

17. Attach the wall control face plate by aligning over the wall control and pushing ON until it snaps into position. (Fig. 17)

18. Turn the power supply back on.

Fig. 14.

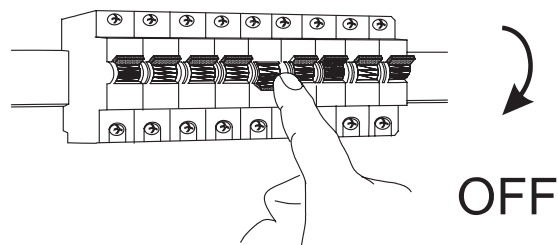

Fig. 15.

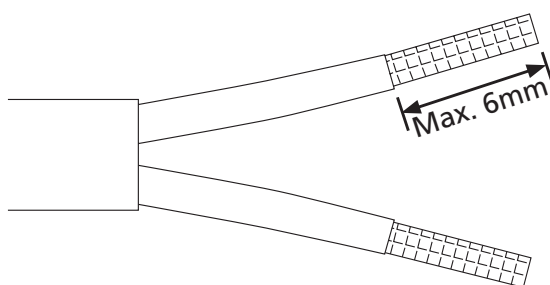

Fig. 16.

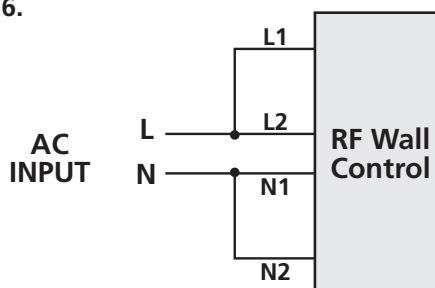
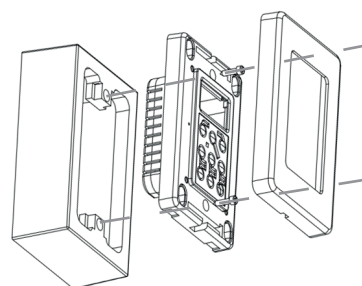

Fig. 17.



# INSTALLATION

## Wiring Diagram

- **FOR YOUR SAFETY, ALL ELECTRICAL CONNECTIONS MUST ONLY BE UNDERTAKEN BY A QUALIFIED AND LICENCED ELECTRICIAN!**
- For safe use of ceiling fans, an all-pole disconnection **MUST** be incorporated into the fixed wiring in accordance with the wiring rules, as outlined in clause 7.12.2 of AS/NZS 60335-1 for meeting the minimum electrical safety of this standard.
- A single pole isolation switch must be also placed in the same room as the fan as per local wiring regulations AS/NZS 3000, in accordance with clause 2.3.2.2.1& 4.13.1.3 of AS/NZS 3000.
- If there are two or more ceiling fans installed in the one location/room, an isolation switch is required for **EACH** ceiling fan. This is required when programming any remote-control transmitter & receiver to pair together, and for fan servicing.

Fig. 18.

No Light models

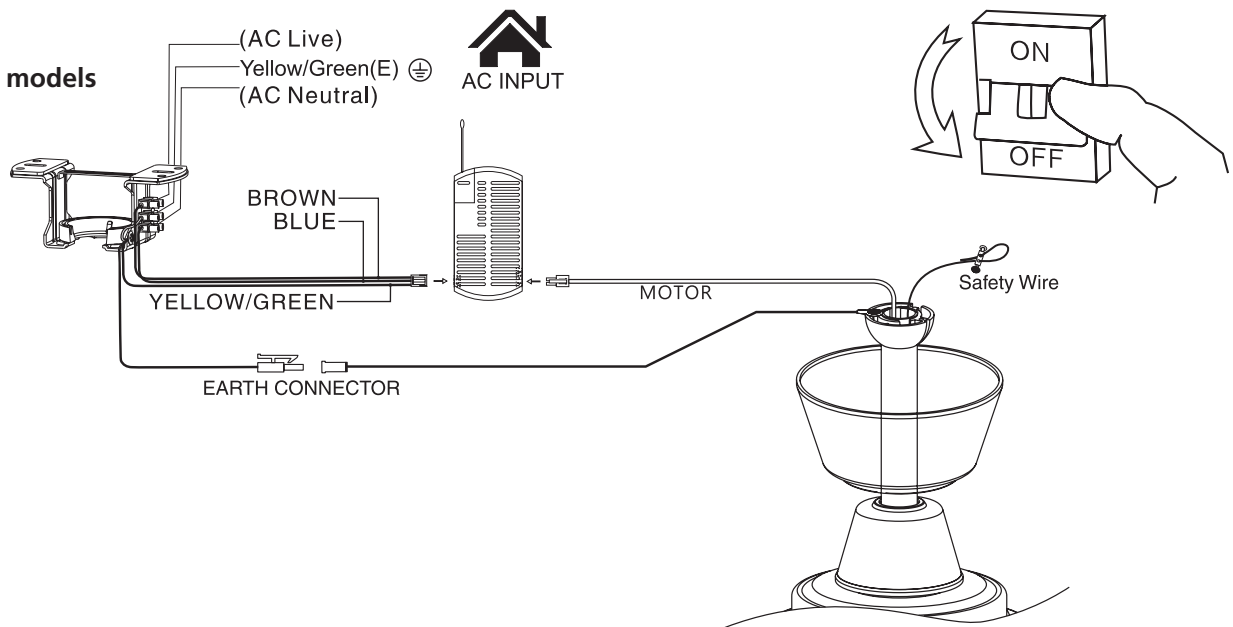
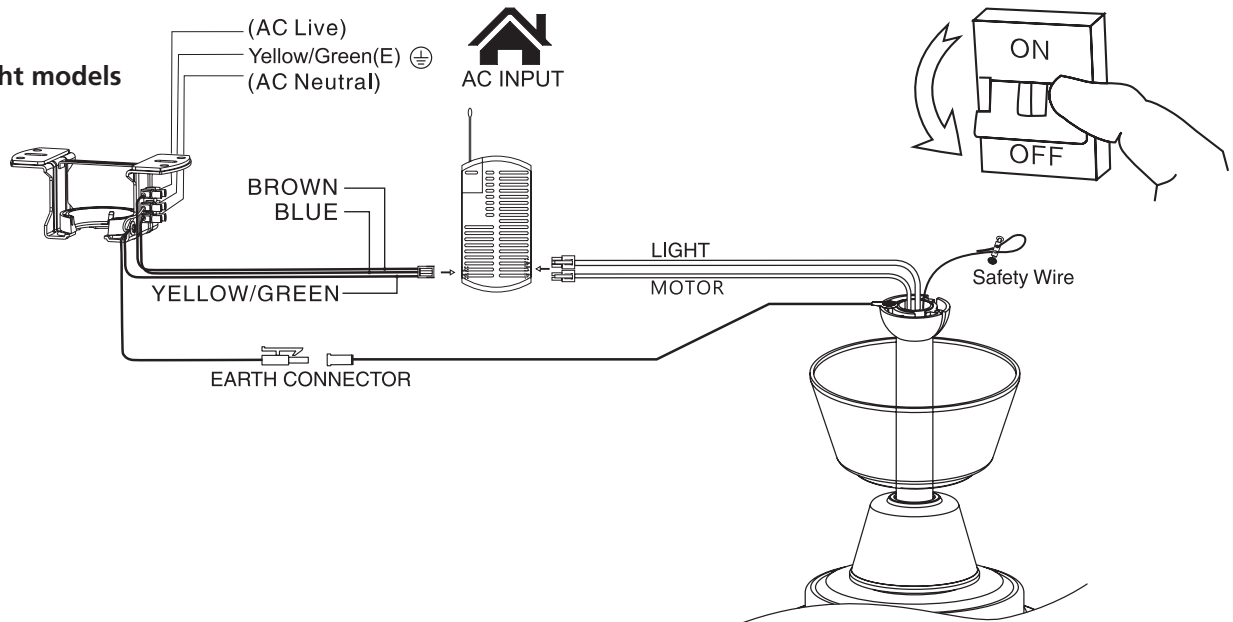

Fig. 19.

With Light models



## RF CONTROLS PAIRING

### Dual RF Pairing

EGLO Miami ceiling fans are developed with the ability to accept dual (2) RF pairings for your convenience, meaning you can use any of the below combinations of controller/s:

- |   |  |  |
|---|--|--|
| <input checked="" type="checkbox"/> RF Wall Control     | <input checked="" type="checkbox"/> Handheld RF Remote     | <input checked="" type="checkbox"/> RF Wall + Handheld RF Remote |
| <input checked="" type="checkbox"/> 2 x RF Wall Control | <input checked="" type="checkbox"/> 2 x Handheld RF Remote |  |

### Handheld RF Remote Pairing

#### SINGLE FAN INSTALLATION:

1. Connect wiring and switch the power supply ON.
2. Within 10 seconds of the Driver being powered on (connected) aim the transmitter towards the receiver and hold "FAN OFF" until a beep sound is heard meaning pairing/syncing has been successful.

#### PAIR ONE REMOTE TO MULTIPLE FANS:

The pairing/syncing of each fan and remote MUST be done with all other fans disconnected from the power supply.

1. Fan #1 - Connect wiring and switch the power supply ON.
2. Within 10 seconds of the Driver being powered on (connected) aim the transmitter towards the receiver and hold "FAN OFF" button until a beep sound is heard meaning pairing/syncing has been successful.
3. Disconnect fan #1 from the power supply.
4. Repeat steps 1-3 for each subsequent fan, ensuring that each additional fan is disconnected from the power supply before moving on to syncing the next fan.
5. Only once all fans have been paired/synced and successfully tested on separate remote-control transmitters, can all fans then be reconnected to power, and assembly of canopy completed.

#### PAIRING TWO REMOTES TO ONE FAN:

To connect two RF controls to the SAME Fan, follow these steps:

1. Complete First transmitter pairing per "SINGLE FAN INSTALLATION"
2. Power OFF Fan for more than 10 seconds, then repeat "SINGLE FAN INSTALLATION" to pair second remote to same fan.

### Remove Paired RF Handheld Remote Control From Fan

1. Power OFF the fan for more than 10 seconds
2. Power UP the fan again and within 5 seconds hold "speed 2" for 6 seconds; the fan will emit a beep for 1.5 seconds to confirm de-pairing is done

**Note:** This operation will wipe out ALL RF pairings from the fan, you will need to follow the initial setup and pairing instructions to re-pair again.

### Enable Smart Control



In addition to control your fan with included RF handheld remote, your Miami ceiling fan is supplied 'Smart Enabled', meaning if you choose, you can easily download the EGLO 'My Control' app to start controlling your fan from your smart device. EGLO 'My Control' also allows a degree of automation through tasks you can preset in the "my control" APP.

To enable smart control, please refer to, and follow the instructions in the 'Smart Enabled Ceiling Fan Guide' which was included with your fan.

# RF CONTROLS PAIRING

## RF Wall Control Pairing

The RF wall control has been pre-paired with the fan for your convenience, however, should you ever need to replace the wall control or re-paired / re-synced if multiple fans are located within an area, follow these simple steps:

1. Press and hold the **“Forward/Reverse”** Button and **“Multi-function”** Button at the same time for 3 seconds to enter the Ceiling Fan Type Setting Mode.
2. Press the **“Light Brightness UP”** or **“Light Brightness DOWN”** button to select either **05** for No Light models or **06** for with Light models. Screen will change every 0.3 seconds displaying:

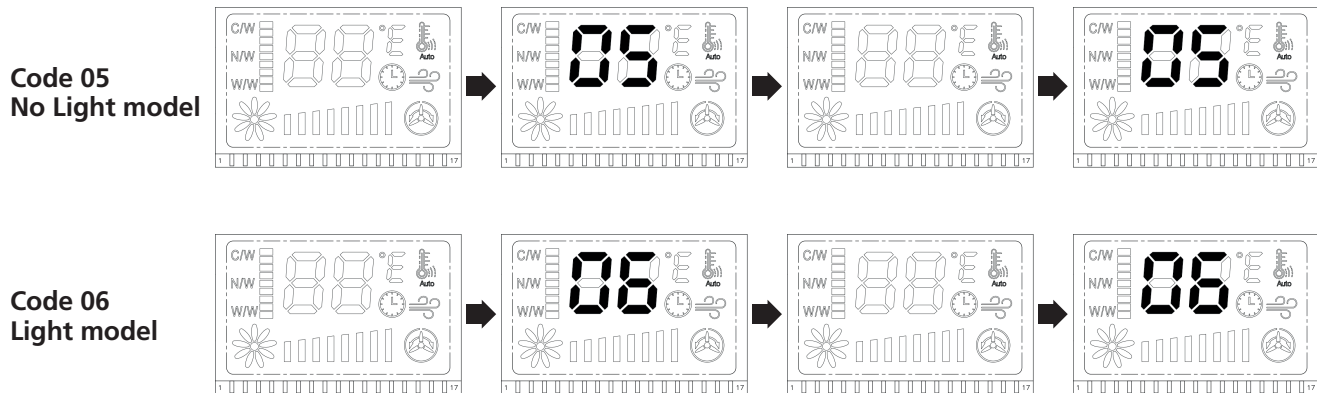

To exit Ceiling Fan Type Setting Mode:

- Press & hold the **“Forward and Reverse Button”** and **“Multi-function Button”** again at the same time for 3 seconds, **or**
  - Simply do not touch any button for 5 or more seconds.
3. Disconnect Fan from power supply for more than 10 seconds
  4. Power UP again to Fan, **while screen displays temperature only**, hold **“Fan On/Off”** button for a few seconds until you hear a beep to confirm pairing is done, screen display will also change per below.

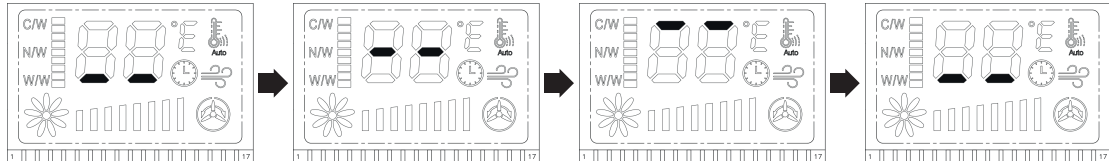

**Note:** Repeat above steps to control more fans under same code in same area from this RF wall control.

## Remove Paired RF Wall Control From Fan

Should you wish to de-pair this RF wall control from your fan, follow these steps:

1. Power OFF Fan for more than 10 seconds.
2. Power UP again and within 5 seconds, Hold **“Light Brightness Down”** & **“Light Brightness UP”** for 6 seconds, screen display will change per below and fan will emit a beep for 1.5 second to confirm de-pairing is done.

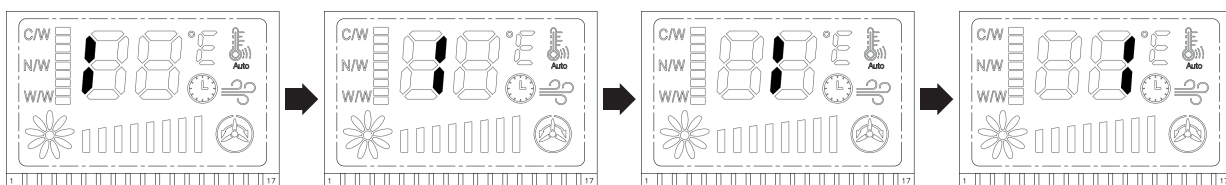

**Note:** These operations will wipe out ALL RF pairings from the fan, you will need to follow the initial setup and pairing instructions to re-pair again.

# FUNCTIONS & OPERATION

## Functions

	Remote (No-Light)	Remote (LED)	Wall Control
ON / OFF & Speed control	✓	✓	✓
Forward & Reverse (Summer/Winter mode)	✓	✓	✓
Temperature based auto operation			✓
Natural Breeze			✓
Timer	✓	✓	✓
Light ON / OFF		✓	✓
Light Colour Changing		✓	✓
Light Dimming		✓	✓

## Operating Your Handheld Remote Control

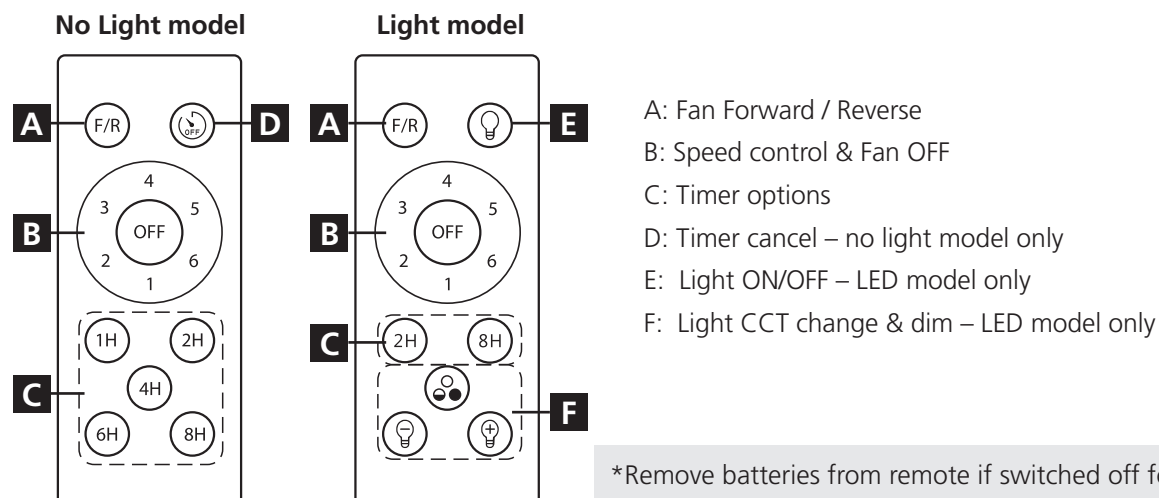

\*Remove batteries from remote if switched off for long periods.

	Remote Control
<b>Turn the fan ON:</b>	Press any speed button
<b>Turn the fan OFF:</b>	Press "OFF" button in centre of speed buttons
<b>Increase fan speed:</b>	Press higher speed button
<b>Decrease fan speed:</b>	Press lower speed button
<b>Turn light ON:</b>	Press  button
<b>Turn light OFF:</b>	Press  button
<b>Change light colour:</b>	Short press to change between Warm White / Neutral White / Cool White, hold button to do stepless change
<b>Increase light brightness:</b>	Press  button
<b>Decrease light brightness:</b>	Press  button
<b>Change fan direction:</b>	Press  button, fan will slow to a stop, then change direction
<b>Set timer:</b>	Press timer button for desired length of time before automatic switch off
<b>Cancel Timer:</b>	Press  button (no light model only)

# RF WALL CONTROL - FUNCTIONS & OPERATION

## Operating Your RF Wall Control



Fan: Speed down, ON/OFF, Speed up

Light: Brightness down, ON/OFF & CCT, Brightness up (LED model only)

Fan direction, Timer (0-9hr), Multi function button

## Fan ON / OFF & Speed Selection

### To turn the Fan ON:

- A short press of the "Fan On/Off" button (< 1 sec), the fan will turn on and fan will operate on MEDIUM speed, or subsequently at the last operated speed.

### To turn the Fan OFF:

- While the fan is on, a short press of the "Fan On/Off" button (< 1 sec), the fan will turn off.

### To increase Fan speed:

- Press "Fan Speed Up" button to increase speed by 1.  
**Note:** When the fan is at speed 6, press "Fan Speed Up" button, fan will stay at speed 6.

### To decrease Fan speed:

- Press "Fan Speed Down" button to decrease speed by 1.  
**Note:** When the fan is in speed 1, press "Fan Speed Down" button, fan will stay at speed 1.

## Light Operation (with Light models only)

### To turn light ON:

- A short press of the "Light On/Off" button (< 1 sec), the light will turn on.

### To turn light OFF:

- A short press of the "Light On/Off" button (< 1 sec), the light will turn off.

### To select or change light colour: (Fig.18)

- A short press of the "Light On/Off" button (< 1 sec), the light will turn on.
- Hold "Light On/Off" button, Light colour indication bar will flash
- A short press again to select desired light colour.
- No operation for 5 seconds, will exit the colour changing function.

Fig. 18.

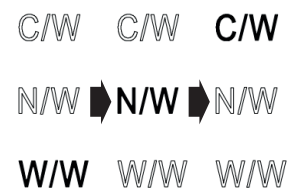

### To increase light brightness: (Fig. 19)

- A short press of the "Light On/Off" button (< 1 sec), the Light will turn on.
- A short press on "Light Brightness UP" button, light brightness go up 1 step.
- Max. brightness is step 6, when at max., indication bar won't go higher.

Fig. 19.

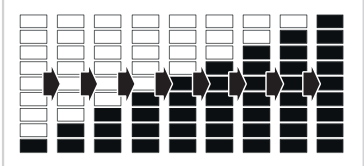

### To decrease light brightness: (Fig. 20)

- A short press of the "Light On/Off" button (< 1 sec), the Light will turn on.
- A short press on "Light Brightness DOWN" button, light brightness down 1 step.
- Min. brightness is step 1, when at min., indication bar won't go lower.

Fig. 20.

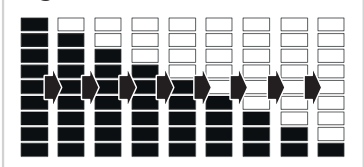

# RF WALL CONTROL - FUNCTIONS & OPERATION



## Natural Breeze

The DC RF wall control works with your fan to control the Natural Breeze function. Natural Breeze is a setting where your fan automatically varies the fan speed to mimic nature's natural wind patterns.

### Turn On Natural Breeze:

- Press  Multi-Function button <1 second to turn Natural Breeze ON.

### Turn off Natural Breeze:

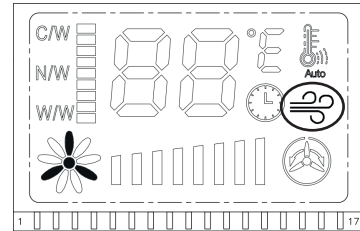

- Press  Fan ON/OFF button <1 second to turn Natural Breeze OFF. **or**
- Press  Fan Speed UP button <1 second to turn Natural Breeze OFF. **or**
- Press  Fan Speed DOWN button <1 second to turn Natural Breeze OFF.





## Temperature-based Automation

The standard included DC RF wall control is fitted with temperature-based automation which will automatically set the fan speed based on the ambient temperature within the room.

### Turn On Temperature-Based Automation:

- Press and hold  "Multi-Function" button.
-  "Auto" will be highlighted on the screen.
- Fan will now operate per below settings.

### Turn Off/Exit Temperature-Based Automation:

- Press  "Fan OFF" button or,
- Press  "Fan Speed Up" button or,
- Press  "Fan Speed Down" button.

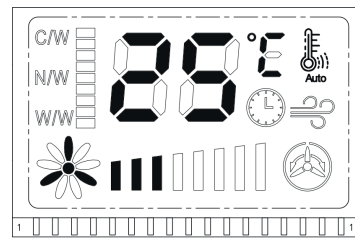

## Temperature Settings

Temperature (°C)	Fan Setting
< 18°C	<b>Fan OFF</b>
18°C	Fan remains at last active speed
19°C	Fan remains at last active speed
20°C	Fan remains at last active speed
<b>20°C - 23°C</b>	<b>speed 1</b>
24°C	Fan remains at last active speed
<b>25°C - 28°C</b>	<b>Medium / middle speed</b>
29°C	Fan remains at last active speed
>29°C	<b>Highest speed</b>

**Note:** Due to electronic tolerances and ambient circumstances, actual operation of this function might be slightly different to the settings, e.g.: fan runs at medium speed while screen displays 29°C.

**Note:** NOT every temperature sensor is identical, and they are often positioned at different heights, meaning differing temperatures can be displayed. If a temperature sensor on a different device is displaying a differing ambient temperature, this does not indicate a fault/failure with the sensor of the DC RF wall control.

# RF WALL CONTROL - FUNCTIONS & OPERATION

## Timer

This RF wall control provide up to 9 timer options suits your mostly needs.

If you need more flexibility, we suggest you enable "Smart Control" and set from "MyControl" APP.

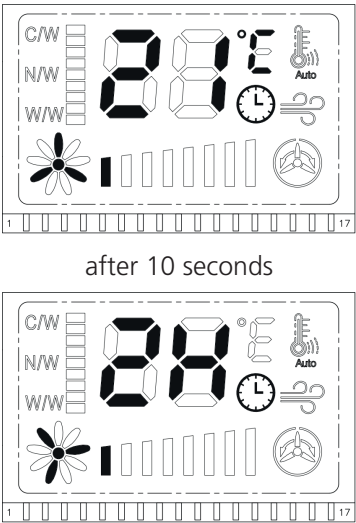
Operation	Display Screen
<p><b>Turn Timer Function ON:</b></p> <ul style="list-style-type: none"> <li>Turn on Fan &amp;/or Light, then</li> <li>Press Timer button &lt;1 second to turn Timer ON.</li> </ul> <p><b>Select Timer Duration:</b></p> <ul style="list-style-type: none"> <li>Press Timer button &lt;1 second to select 1 Hour Timer.</li> <li>Press Timer button &lt;1 second to select 2 Hour Timer.</li> <li>Press Timer button &lt;1 second to select 3 Hour Timer.</li> <li>Press Timer button &lt;1 second to select 4 Hour Timer.</li> <li>Press Timer button &lt;1 second to select 5 Hour Timer.</li> <li>Press Timer button &lt;1 second to select 6 Hour Timer.</li> <li>Press Timer button &lt;1 second to select 7 Hour Timer.</li> <li>Press Timer button &lt;1 second to select 8 Hour Timer.</li> <li>Press Timer button &lt;1 second to select 9 Hour Timer.</li> </ul> <p><b>Turn Timer OFF:</b></p> <ul style="list-style-type: none"> <li>Press Timer button &lt;1 second to select 0 Hour Timer. <b>or</b></li> <li>Hold Timer button for &gt;3 seconds and screen will display 0H <b>or</b></li> <li>If Fan &amp; light are working, turn off Fan &amp; Light <b>or</b></li> <li>If only Fan Is working, turn off fan <b>or</b></li> <li>If only light is working, turn off Light</li> </ul>	<p><b>Example:</b></p> <ul style="list-style-type: none"> <li>Ambient Temperature 21°C,</li> <li>Timer set at 2H,</li> </ul> <p><b>Screen changes every 10 seconds</b></p> 

**Note:** When the Timer function is ON, the remaining time will be updated on the screen every hour.

## Reverse Function



### SUMMER (Forward)

For a cooling effect during summer, your fan should run in a counter-clockwise direction, forcing the room air down and outwards creating a wind chill effect that makes you feel cooler.



### WINTER (Reverse)

During the winter, your fan should run in a clockwise direction at low speed. This will gently draw the warmer air down from the ceiling, balancing the rooms temperature, and allowing you to lower your heating thermostat.

To change the direction of your ceiling fan:

- Press the  button; fan will slow to a stop, then change direction.

# CLEANING & MAINTENANCE

## Maintenance

Your fans natural movement can cause screws to loosen. Every 6 months, check that ALL screws are securely tightened with a screwdriver. All EGLO ventilation products should also be cleaned regularly to insure against corrosion from salt, dust and moisture.

## Cleaning

All EGLO ventilation products should be cleaned regularly to insure against corrosion from salt, dust and moisture, both externally and internal (where allowed and possible). Cleaning your fan periodically will help maintain its appearance over the years.

Do not use water when cleaning. Water can damage the motor or could cause an electrical hazard. Surface smudges or an accumulation of dirt and dust can easily be removed by using only a slightly dampened cloth. Do NOT use abrasive cleaning agents as they may damage the finish.

# TROUBLE SHOOTING

Please note that all ceiling fans are not the same, even fans of the same model, some may move more or less than others. Movement of a few centimeters is quite acceptable and does not suggest the fan will fall if installed correctly. It is impossible to eliminate wobble altogether and it should not be considered a fault; ceiling fans tend to move during operation because they are not rigidly mounted.

PROBLEM	POSSIBLE CAUSE	POSSIBLE REMEDY
<b>Fan or Light will not start.</b>	Fuse or circuit breaker blown.	<b>Turn power OFF.</b> Check circuit fuses and circuit breakers.
	Loose connections to fan.	<b>Turn power OFF.</b> Check connections at terminal block.
	Controller/switch issues.	Check that fan controller is in the correct position. For remote controls with Code Pairing Synchronization, re-pair remote transmitter to remote receiver.
<b>Fan Wobbles.</b>	Fan hanger ball not seated correctly in ceiling mounting bracket.	Turn power OFF. Support the fan very carefully and rotate the hanger ball to ensure the notch on the hanger ball engages with the ridge on the mounting bracket.
	Loose mounting bracket	Check that all screws which fix the mounting bracket are all tightly secured
	Fan blades not horizontal to the ceiling.	Check by measuring from the tip of the blade to the ceiling and repeat on every blade. If measurements are different check below steps.
	Fan blades out of shape.	Check by removing all blades and stacking on a flat level surface to ensure all blades are a uniform shape.
	Imbalanced weight distribution.	Interchanging blades redistributes weight and can result in smoother operation.
	Blade screws are overly tightened, or loose.	Check that all screws are securely tightened but not overtightened to an extent that parts are distorted.
	Fan requires balancing.	Use a Blade Balancing Kit to balance the fan.
<b>Fan sounds noisy.</b>	Top canopy touching ceiling.	Lower the decorative canopy so that it does not contact the ceiling.
	Loose housing screws.	Make sure all motor housing screws are tight.
	Loose blade screws.	Check that all screws are securely tightened. Do NOT overtighten.
	Mounting bracket not installed correctly.	Turn power OFF. Check and if necessary, re-install the ceiling mounting bracket if not installed correctly.
	Incorrect controller.	Turn power OFF. Change the controller to the supplied controller.
	<b>NOTE:</b> When it is quiet at night, you may hear occasional small noises, THIS IS NORMAL! Allow a 24-hour 'settling-in' period as most noises associated with a new fan disappear during this initial period. All electric motors make noise to some extent.	

# WARRANTY

## 1. Australian Consumer Law

The benefits given to you the consumer in this warranty document are in addition to your other rights and remedies under a law in relation to the products to which this warranty document relates.

“YOUR CONSUMER RIGHTS”: Our goods come with guarantees that cannot be excluded under the Australian Consumer Law. You are entitled to a replacement or refund for a major failure and compensation for any other reasonably foreseeable loss or damage. You are also entitled to have the goods repaired or replaced if the goods fail to be of acceptable quality and the failure does not amount to a major failure.

Subject to “Your Consumer Rights” outlined above, but otherwise to the maximum extent permitted by law, EGLO will not be liable for any consequential or indirect loss or damage suffered or incurred by you in relation to an EGLO product including but not limited to loss of use, loss or damage for business interruption, or profits.

## 2. Limited Repair / Replacement Warranty

EGLO offers the purchaser a repair or replacement of the EGLO product in cases where the product fails due to defective materials or workmanship, when installed and operated under normal domestic conditions, for a period of 6 years from the date of purchase, namely:

- 3 years in-home warranty (parts & labour) on motor, LED board, included remote control & receiver,
- Plus 3 years replacement parts warranty on motor, LED board, included remote control & receiver.

Please also refer to WHAT IS NOT COVERED.

You must provide proof of purchase (such as the original dated purchase receipt/invoice) from an authorised EGLO reseller to make a warranty claim. You must also provide a receipt from installation, including the electrical contractors licence number. This warranty will not apply if the ceiling fan is installed by anyone other than a qualified and licensed electrical contractor.

Resetting/Changing of DIP switches or re-pairing/syncing connected remote controls is not covered by warranty.

Batteries (if supplied), are done so as a complimentary (free) item only and are not covered by warranty.

EGLO products presented for repair may be replaced by refurbished goods of the same type rather than being repaired at the discretion of EGLO. Refurbished parts may be used to repair the goods to proper order.

To the maximum extent permitted by law, any product replaced, repaired or refurbished by EGLO is covered only by the balance of the warranty period remaining from the date of original purchase of the original EGLO product.

EGLO Lighting (EGLO) will not be liable for charges incurred by the consumer for rectification, deinstallation or reinstallation unless approved by EGLO management in writing prior to commencing work.

All claims are to be submitted via the online Warranty Request Form together with a copy of the original purchase receipt, a copy of receipt from installation (incl. electrical contractor licence number), and any supporting images or videos to help expedite your claim. Please refer to the section “How to make a warranty claim”. Please note that incomplete submission will result in delays processing your claim.

## 3. IN-HOME WARRANTY

**PLEASE KEEP THE PRODUCT INSTALLED FOR WARRANTY TROUBLESHOOTING & RECTIFICATION BY EGLO.  
EACH FAN OR FANS MUST HAVE AN INDIVIDUAL ALL POLE DISCONNECTION (ISOLATION SWITCH) PER FAN.**

In addition to the limited warranty terms set out under section (2) above, the in-home warranty applies for the first 3 years from the date of original purchase, to all ceiling fans which are hard wired to the electricity supply at residential premises and are required to be installed by a licensed electrician.

Where a consumer asserts that a product installed in-home is faulty, and an EGLO service agent attends the property, A SERVICE CALL FEE WILL BE CHARGED TO THE CONSUMER IF:

1. The product is deemed to be a non-EGLO product.
2. There is nothing wrong with the EGLO product or to the extent that the failure is not a failure of the product to perform in accordance with its published features and specifications as reasonably determined by EGLO.
3. The fault is deemed to be with a non EGLO branded or supplied control, and not the EGLO ceiling fan.

# WARRANTY

4. The original installation of the EGLO product was not carried out by a qualified and licensed electrician, or where installation is not in accordance with all applicable Australian / New Zealand standards.
5. The defects have been caused by incorrect installation, application, operation, abuse or misuse by the consumer of the EGLO product.
6. In cases of in-home repair/replacements in areas outside the coverage of EGLO service agents, EGLO will reimburse customers a standard fee of \$110.00 (Inc. GST) for using their own electrician. To the maximum extent permitted by law, in cases where the installed product is outside the coverage of EGLO service agents, EGLO reserves the right to request a different electrician attend to the service call, if there is reasonable expectation that the fault may be the result of something other than the EGLO product.
7. BEFORE CALLING YOUR ELECTRICIAN, contact EGLO to make a service request with the EGLO warranty department and obtain an Warranty Claim Number. Reimbursements will not be made for call-out fees or other costs without prior approval in writing of the EGLO warranty department.
8. The cost of repairs and/or service call where the fault is due to the installation and not due to faulty materials or manufacturing workmanship, will be payable by the consumer.
9. In the circumstances where an emergency has arisen out of normal business hours and the EGLO warranty department cannot be contacted to dispatch a service agent to the premises, EGLO will reimburse customers their reasonable costs (as determined by EGLO) for using their own electrician.  
**Note:** An emergency is only considered where the product is presenting an immediate & present danger. Products that have simply stopped working, or a not operating sufficiently, DO NOT constitute an emergency.
10. Failure in part of the consumer to pay for the service call in case of any of the above, will result in the balance of the warranty being void, until all outstanding amount including taxes and costs have been recovered in full.

## 4. WARRANTY TRANSFER

If the ownership changes on the dwelling/premises where the EGLO product is installed, the balance of the warranty period passes to the new owner provided the original proof of purchase (such as the original dated purchase receipt) from an authorised EGLO retailer is retained by the new owner. In addition, proof of installation & licence number of the original installing electrician must be retained.

## 5. COMMERCIAL USE

When installed correctly by a qualified and licenced electrician in a commercial (non-domestic) setting, EGLO grants the buyer a one (1) year 'parts replacement' warranty. The warranty period starts from date of purchase, and a receipt is required to demonstrate proof of purchase.

EGLO assumes no liability beyond this warranty. All liability for damages and consequential costs is excluded. In particular, under this warranty, EGLO shall not be liable for any indirect damages or costs incurred in connection with remedying the defect (e.g. disassembly, reassembly, shipping costs, travel expenses, scaffolding, loss of profit, business interruption etc.). The provision of this warranty services does not trigger an extension of the warranty period or the beginning of a new one.

## 6. WARRANTY CONDITIONS

1. This warranty is for 240V 50Hz products originally purchased in and installed in Australia ONLY.
2. Installation must be performed by a qualified and licensed electrician. The warranty will not apply if the product is installed by anyone other than a qualified and licensed electrician.
3. The cost of repairs and/or service call arising from incorrect installation, not due to faulty material or workmanship in accordance with the EGLO warranty, will be payable by the purchaser.
4. Problems arising from incorrect installation are not covered by warranty.
5. This warranty is only valid for appliances used according to the manufacturer's instructions.
6. The manufacturer does not accept liability for any direct or consequential damage, loss or other expense arising from misuse or incorrect installation and operation of the appliance.
7. Warranty will only be provided where proof of qualified electrical installation is provided. E.g. Electrical Safety Certificate.
8. Warranty will not be provided if installation is without an all-pole disconnection incorporated in the fixed wiring in accordance with the wiring rules.
9. The manufacturer will not accept in home expenses unless authorisation is granted prior to work commencing, and a Warranty Claim Number allocated by EGLO.
10. Where a service call is undertaken and no fault is found with the ceiling fan, or where the fault is not covered under the terms of this warranty, a call-out fee may be charged.

# WARRANTY

## 7. WHAT IS NOT COVERED

Subject to “Your Consumer Rights”, but otherwise to the maximum extent permitted by law, the EGLO warranties provided in this document will not cover the following:

- EGLO products that are not purchased from an authorised reseller in Australia and not installed in Australia.
- Defects and failure caused by fair wear and tear or the product exceeding its rated operational lifetime.
- Where installation was not carried out by a qualified and licensed electrical contractor.
- EGLO products not installed in accordance with the product’s installation instructions or specifications, or where installation is not in accordance with applicable Australian / New Zealand standards.
- Defects and failure which result from repair or modification not carried out by EGLO or an authorized EGLO service agent. This includes products that have been painted or used with non-standard blades, controllers (including capacitors), or mounting systems.
- Changes to the painted or plated finishes of the ceiling fan motor or blades due to climate conditions (moisture, salt, dust, etc), or after 12 months from the date of original purchase.
- Defect, damage or failure to an EGLO product resulting from misuse, accident, neglect, abuse, tampering, modifications or unauthorized repairs of any kind by any person.
- Defects and failure which result from incorrect use or operation (including incorrect installation, incorrect voltage, using non authorised electrical connections or parts, and other use that is not in accordance with directions given by EGLO.
- Defects and failure caused by misuse (including using the products for an unintended application, or purpose for which the product was not designed, an illegal purpose, or a purpose which contravenes an Australian or New Zealand law)
- Damage or failure not caused by a fault in the EGLO product materials or workmanship.
- Defect, damage or failure to an EGLO product resulting from any acts of God, including damages from lightning, power grid fluctuations, or power surges.
- Defect, damage or failure to an EGLO product resulting from theft, vandalism or damage outside normal operation.
- Replacement of light sources (globes) not supplied with the product.
- Replacement of batteries supplied.
- Power supply “noise”, intermittent “humming”, or other influences from mains power delivery infrastructure.
- Water damage of any kind caused by inappropriate placement of ceiling fans not IP rated for that location.
- The cost of renting, obtaining and using special access equipment (i.e. scaffoldings, scissor lifts, etc.) for accessing products installed at a height of greater than 3.0 metres.
- Travel costs incurred by EGLO personnel or service agents travelling greater than 50 Km from an EGLO service agent base. The purchaser must meet these travel costs.
- Transportation and in-transit insurance costs, if the product or parts thereof have to be returned for repair or replacement to the retailer or the authorised service agent.
- Non-structural corrosion damage of components such as surface rust or minor rust.
- Faults deemed caused by a lack of regular maintenance, e.g. screws and nuts becoming loose.

## 8. HOW TO MAKE A WARRANTY CLAIM



To make a warranty claim or seek assistance with this product, scan this QR code, and follow the link to: <https://www.eglo.com/au/warranty-and-product-support>



**EGLO LIGHTING AUSTRALIA**

5/339 Archerfield Road  
Richlands  
Queensland 4077  
[www.eglo.com.au](http://www.eglo.com.au)