

If you have any questions or problems assembling your fixture please call us for assistance. Customer Service:(702)361-4345 or (800)525-2655, customer.services@kalco.com

WARNING:

1. If you are unfamiliar with electrical wiring, call a qualified electrician to install this. More than one person may be necessary to install this fixture, so make sure you have enough qualified help.

2. Turn off the power to the fixture's circuit at the service panel. Use a voltage detector to verify that the power is off.

FIXTURE ASSEMBLY

1. Use two 8-32 screws to fix crossbar on j-box.
2. Connect the main wire with the power supply circuit see wire connection diagram;
3. Adjust the required lamp color temperature.
4. Use grub screw to fix lamp body on crossbar.
5. Install 24V/LED.STRIPS,do not use bulbs that exceeds 9W.

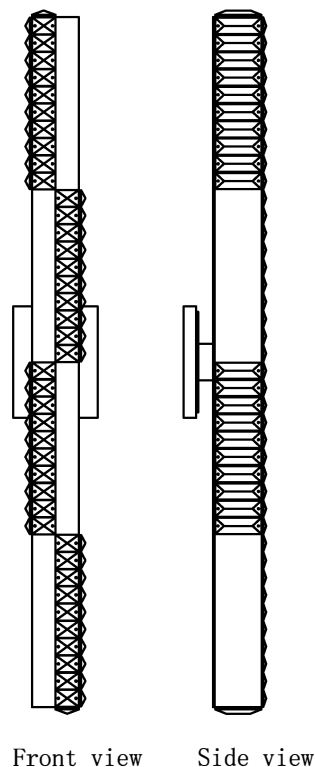
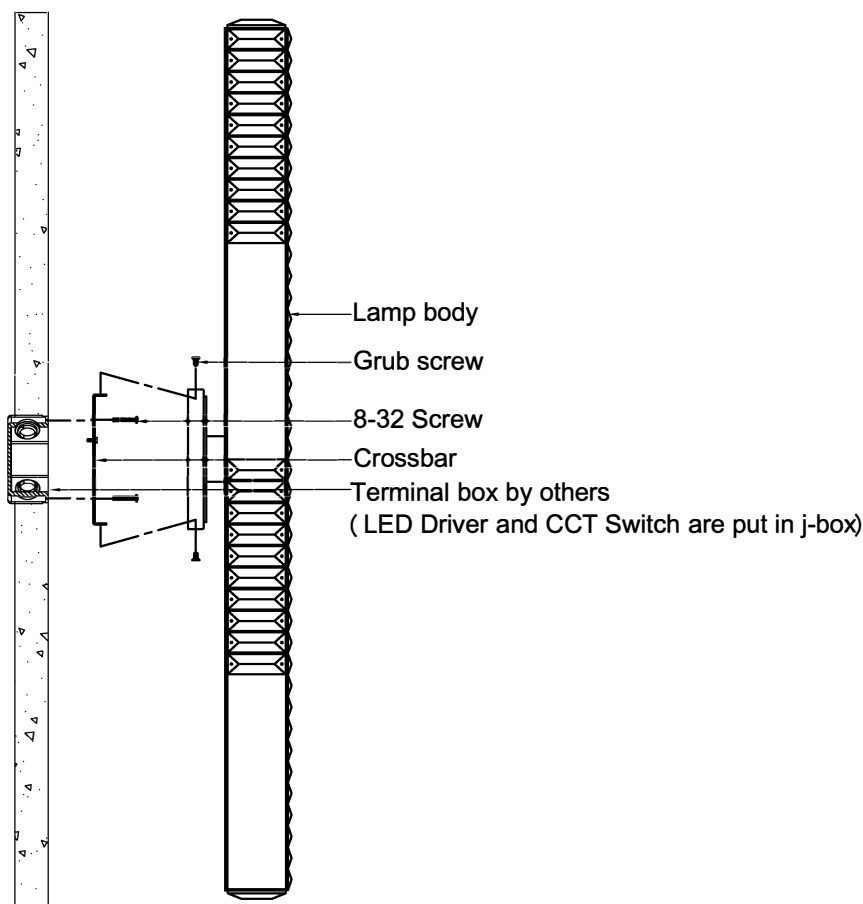

Wiring Diagram

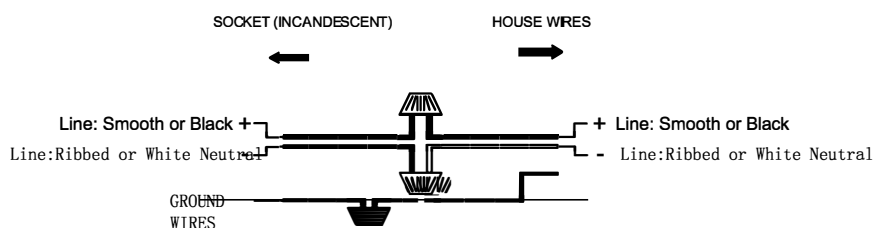

If you have any questions or problems assembling your fixture please call us for assistance. Customer Service:(702)361-4345 or (800)525-2655, customer.services@kalco.com

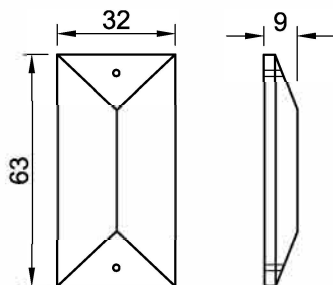
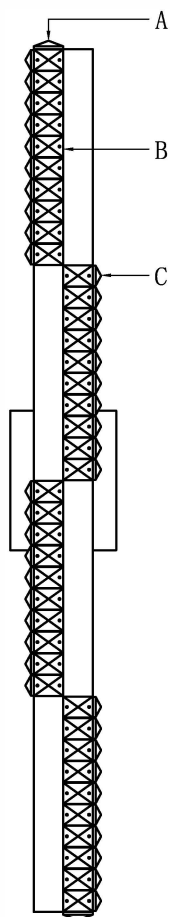

A
Clear K9 crystal strip
W32*L63*T9mm

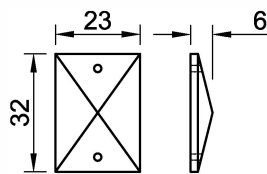

B
R20015-032-00-01
W23*L32*T6mm

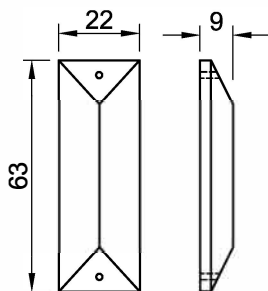

C
R20610-063-00-01
W22*L63mm

Code	Qty
A	2
B	40
C	40

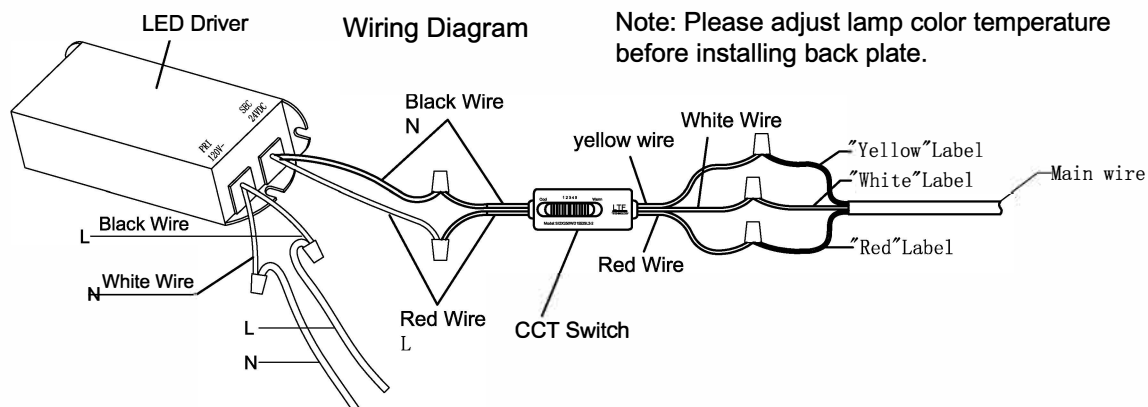

SWITCH POSITIONS				
1	2	3	4	5
RP CCT 1	RP CCT 2	RP CCT 3	RP CCT 4	RP CCT 5
4000K	3500K	3000K	2900K	2700K