

USER MANUAL

The Little Red Barn

Foldable Chick Brooder

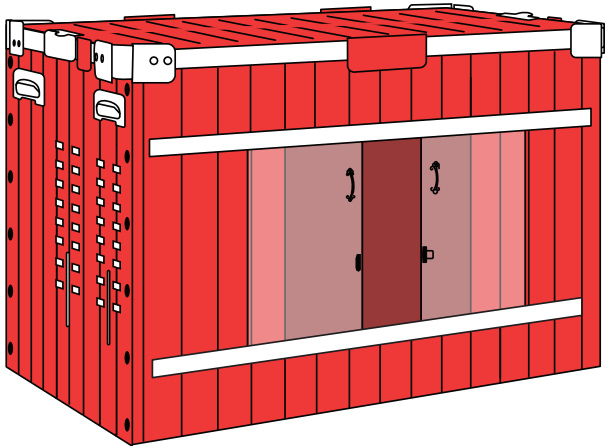
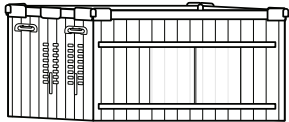

TABLE OF CONTENTS

- 3 Package Contents
- 4 How to Assemble
- 8 Accessories
- 10 Feed-port Position Recommendations

PACKAGE CONTENTS



1x brooder

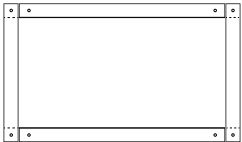

1x tray



4x plastic screws and screw posts

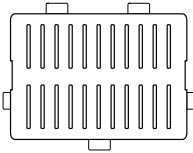

1x lid



4x hatchling liner



1x jute brooder liner

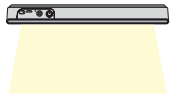

1x LED light



1x pet-proof security latch



1x stickers

HOW TO ASSEMBLE

- 1. Assemble the tray. (a) Lay tray flat. (b) Fold shorter flaps inwards and line up holes. (c) Secure with included plastic screws and posts.

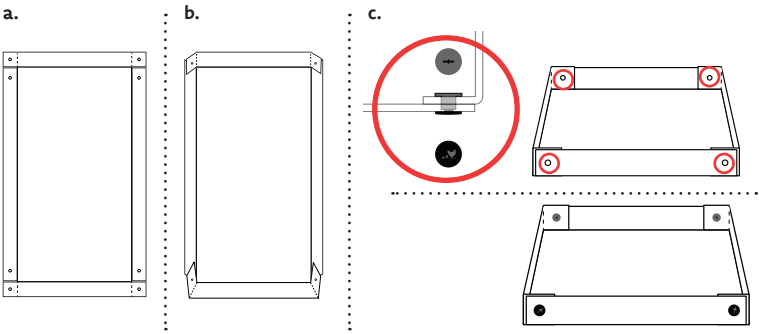

- 2. Gently open the brooder.

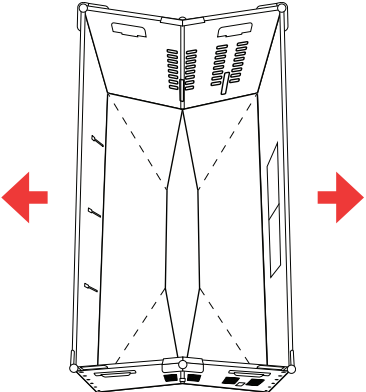

- 3. Push the bottom flap down until it lays flat.

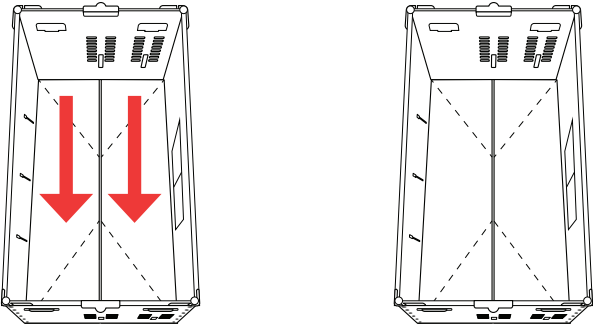

- 4. Lay the assembled tray inside the brooder.

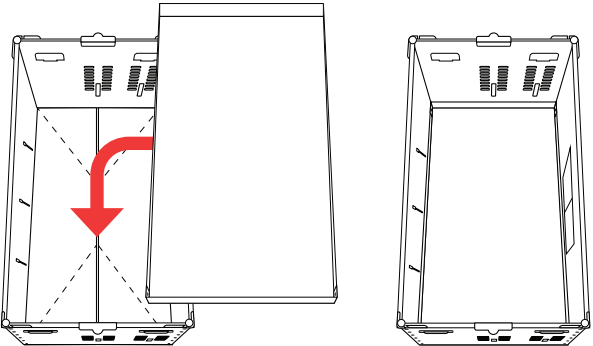

5. Add your liner [see page 8] and/or bedding and accessories. Your chicks will need a heat plate, feeder, and waterer. (Accessories are included in the Little Red Barn Sets and are also sold separately).

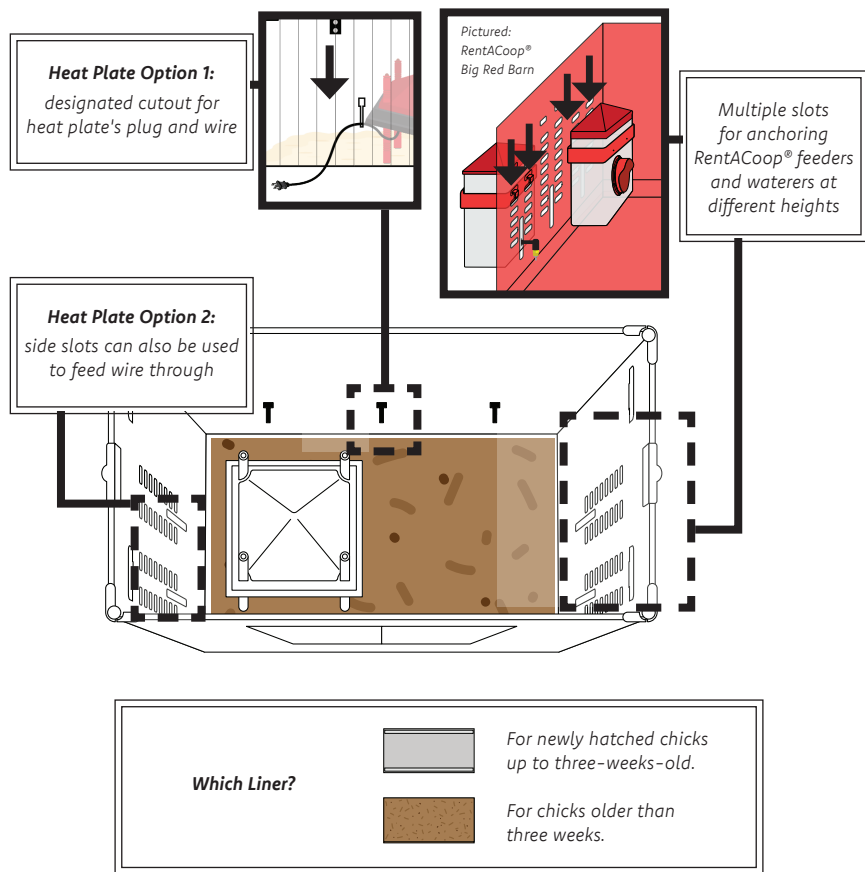

6. Place the lid on making sure to line up the lid's 5 velcro straps with the 5 corresponding velcro panels on the brooder and press to secure.

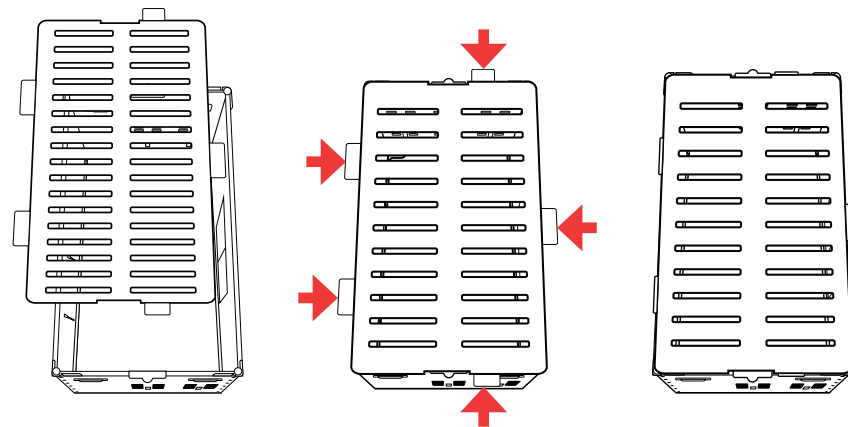

7. Decorate your brooder with the included stickers.

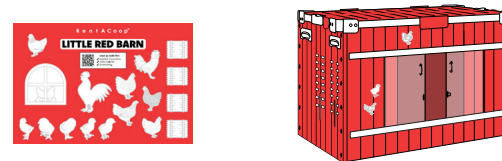

OPTIONAL:

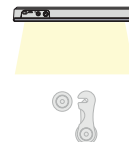

Attach the LED Light to the brooder. To use, follow the directions on the LED Light packaging.

For pet owners with animals who are smart with their paws and/or noses, increase the security of your baby chicks by installing the pet-proof security latch.

ACCESSORIES

These accessories are only included in the Little Red Barn Brooder Set.
These accessories can also be purchased separately.

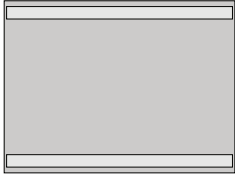

RentACoop® Hatchling Liners

Our Hatchling Liners are appropriate for newly hatched baby chicks. We recommend using the hatchling liners from hatch up to three-weeks-old.

Refills available on Amazon (sold in packs of 12)



RentACoop® Jute Brooder Liners

Our Jute Brooder Liners are made of quality natural jute fiber, which is thick but not rigid. They are environmentally friendly and provide a healthy and comfortable environment for chicks. We recommend using them for chicks older than three weeks.

Refills available on Amazon (sold in packs of 4)

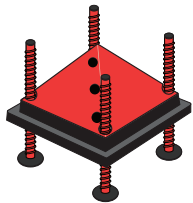

RentACoop® Heating Plate (10x10")

*A resourceful and safer alternative to a heat lamp.
Less of a fire risk!*

Our 10x10" Heating Plate warms up to 15 chicks. Uses only 15 watts/hr versus up to 100 watts used by a heat lamp. Anti-Roost Cone keeps heating plate clean.

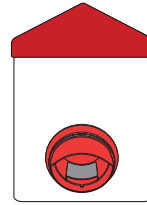

RentACoop® Chick2Chicken 2.5LB Single-Port Feeder

Keep all your crumble, scratch, grain, pellets, and even oyster shell inside this weatherproof feeder while keeping dirt and water out! No more wasted food on the ground with this port design!

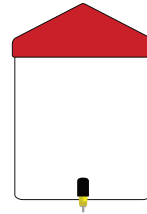

RentACoop® Versatile Drinker (64oz)

Waterer easily attaches to outside of cage. Flip-cap cover on waterer allows for easy refill; just fill from the top! No need to remove waterer from brooder. Water level is viewable from the outside through the plastic.

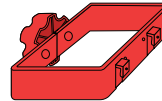

RentACoop® Feeder and Drinker Holder

Attach any of our 64oz drinkers or 2.5lb feeders to the inside or the outside of your brooder using this holder.



RentACoop® Chick Swing

*Provide your chicks with physical and mental stimulation!
The gridded texture of the platform allows chicks to grip and securely stand on the swing while the swing sways back and forth!*

FEED-PORT POSITION RECOMMENDATIONS

The appropriate height for the feeder is when the bottom of the port opening is shoulder-level with your shortest chick[en].

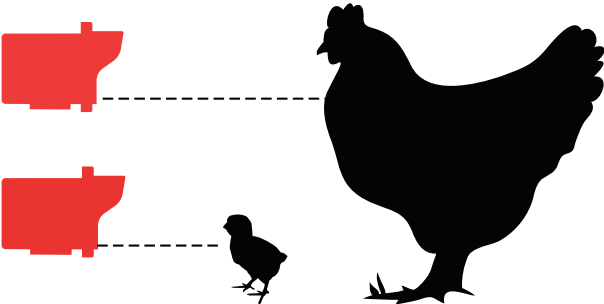

SCAN QR CODE



compatible accessories
detailed instructions
setup ideas

A square box with a black border containing a QR code. Above the QR code is the text "SCAN QR CODE" and below it are three lines of text: "compatible accessories", "detailed instructions", and "setup ideas".



@rentacoop
#rentacoop