

USER MANUAL

Hutch Clip

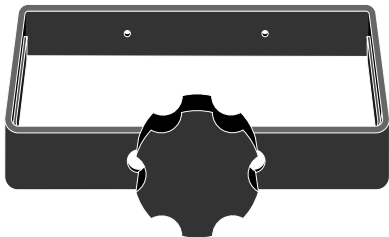

DR-2LTR-MTCP
WR-1LRD-RABT
MF-DVIL-8ZA6

1L-SMDR-BRAS
2L-SMDR-BRAS
DR-1LTR-MTCP

March 2026

TABLE OF CONTENTS

Package Contents	3
Determining Height Placement	4
Placement Options	6
How to Assemble for Hanging	8
How to Assemble for Hardware Cloth	10
How to Mount on a Wall	11
Contact Information	BACK COVER

PACKAGE CONTENTS



Nut

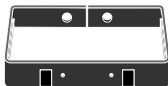

Hutch Clip



Screws
(optional—for mounting)



Hanging Tabs *(optional—for hanging on cages and brooders)*

**DRINKERS NOT INCLUDED.
SOLD SEPARATELY.**

DETERMINING FEEDER AND DRINKER HEIGHT

DETERMINE APPROPRIATE HEIGHT BEFORE PLACEMENT

DRINKERS NOT INCLUDED.
SOLD SEPARATELY.

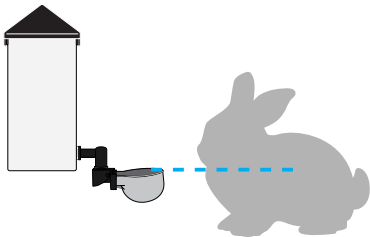

Metal Auto-Fill Cup (sold separately)

If using auto-fill cups, the top of the cups should be **SHOULDER-LEVEL** with your animal.

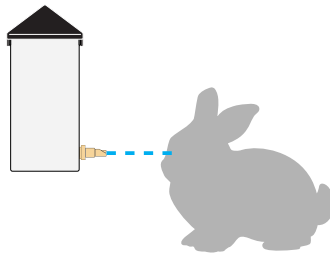

Brass Nozzle (sold separately)

If using brass nozzle, the nozzle should be **EYE-LEVEL** with your animal.

PLACEMENT OPTIONS

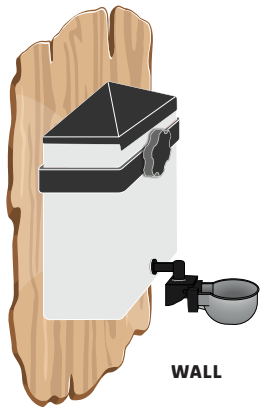

WALL

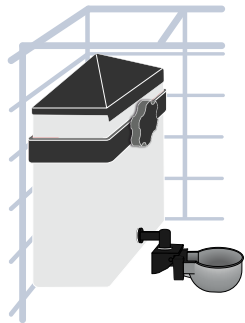

CAGE

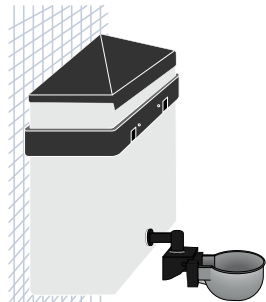
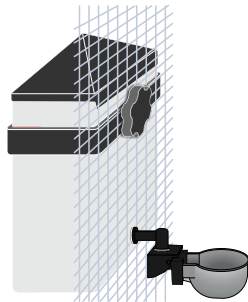

HARDWARE CLOTH

HOW TO ASSEMBLE FOR HANGING

1. Insert hanging bar into hutch clip and push firmly until the bar is fully inserted and secure.



2. Gently open hutch clip and slide drinker through.

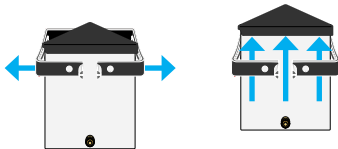

3. Secure with nut turning clockwise until tight.

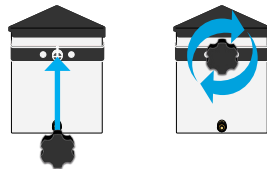

4. It is now ready to hang.

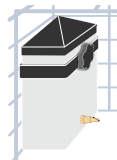

HOW TO ASSEMBLE FOR HARDWARE CLOTH

1. Do not install hanging tabs. Insert drinker into the hutch clip.

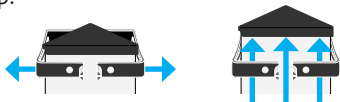

2. Place hutch clip onto cross-section of hardware cloth and screw on nut to secure.

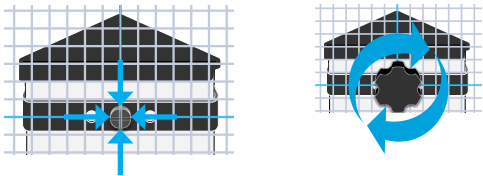

HOW TO MOUNT ON A WALL

1. Do not install hanging tabs. Mount hutch clip onto wall using screws. You will need a drill (not included).

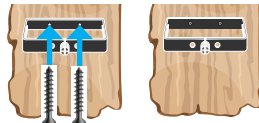

2. Gently open hutch clip and slide drinker through. Secure with nut turning clockwise until tight.

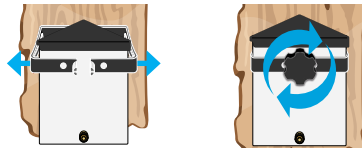



RentACoop®

QUESTIONS?

CONTACT OUR
E G G - S P E R T S

info@rentacoop.com

1 800-642-3571

M-F 9-5 EST



@rentacoop
#rentacoop

v. 202510