

OPERATING CHARACTERISTICS AT T <sub>A</sub> = 25°C					
LED CHARACTERISTICS	MIN.	TYP.	MAX.	UNITS	TEST CONDITIONS
LUMINOUS INTENSITY	2.1			mcd	V <sub>F</sub> = 5 V
PEAK WAVELENGTH		635		nm	
DOMINANT WAVELENGTH		626		nm	
VIEWING ANGLE (2 θ 1/2)		60		DEG	
FORWARD CURRENT		10	15	mA	V <sub>F</sub> = 5 V

ABSOLUTE MAXIMUM RATINGS AT T <sub>A</sub> = 25°C		
PARAMETER	VALUE	UNITS
DC FORWARD VOLTAGE	7.5	V
REVERSE VOLTAGE (I <sub>R</sub> = 100µA)	5	V
DERATING LINEARY FROM 50°C	.071	V/°C
OPERATING TEMPERATURE RANGE	-40 to +85	°C
STORAGE TEMPERATURE RANGE	-55 to +100	°C
SOLDER WAVE TEMPERATURE 3 SEC. MAX	250	°C
MANUAL SOLDER DIPPING 5 SEC.	260	°C

NOTES:

- LEADS: MILD STEEL, LEAD FINISH: TIN OVER SILVER AND COPPER.
- SOLDER ADHERANCE: BOTH LEADS PER MIL. STD. 202E, METHOD 208C, EXCEPT STEAM AGING
- DIE: GaAsP/GaP HER RED.
- LENS: RED TINTED DIFFUSED.(5 VOLTS INTEGRAL RESISTOR LED)
- THIS ASSEMBLY CONTAINS ELECTROSTATIC DISCHARGE SENSITIVE DEVICES (ESDS). MAINTAIN ALL PRECAUTIONARY MEASURES DURING ASSEMBLY, HANDLING AND STORAGE IN ACCORDANCE WITH IPC-A-610.
- DIALIGHT PART NUMBER 521-9183F
- LEAD SPACING MEASURED NEAR EPOXY PACKAGE.

REV	ECN NO	REVISIONS	DRN	CKD	APP	DATE
A	—	—	CE	N.O.	MES	4-9-07
B	—	REMOVED STANDOFFS; REMOVED STANDOFF DIMENSIONS; ".030±.005" WAS ".030 ±.050" IN ERROR; ".230±.010" WAS "R.115"; ".025 SQ. NOM. TYP" WAS ".025"; ".050 NOM" WAS ".050"; ADDED "1.00 MIN"; ADDED EPOXY DIMENSION; ADDED NOTE 7.	KLJ	NO	—	5-2-08
C	—	UPDATED 25 MILLS LEADFRAME THICKNESS TO 18 MILLS. ADDED DERATE LINEARLY IN ABSOLUTE MAXIMUM RATINGS TABLE.	BP	—	SK	3-21-17

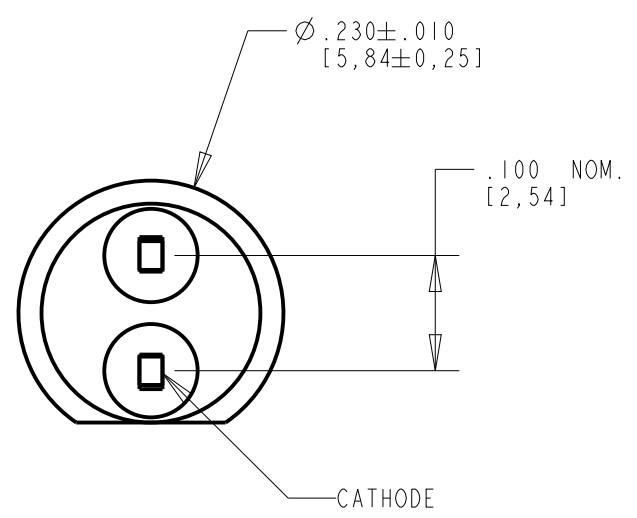
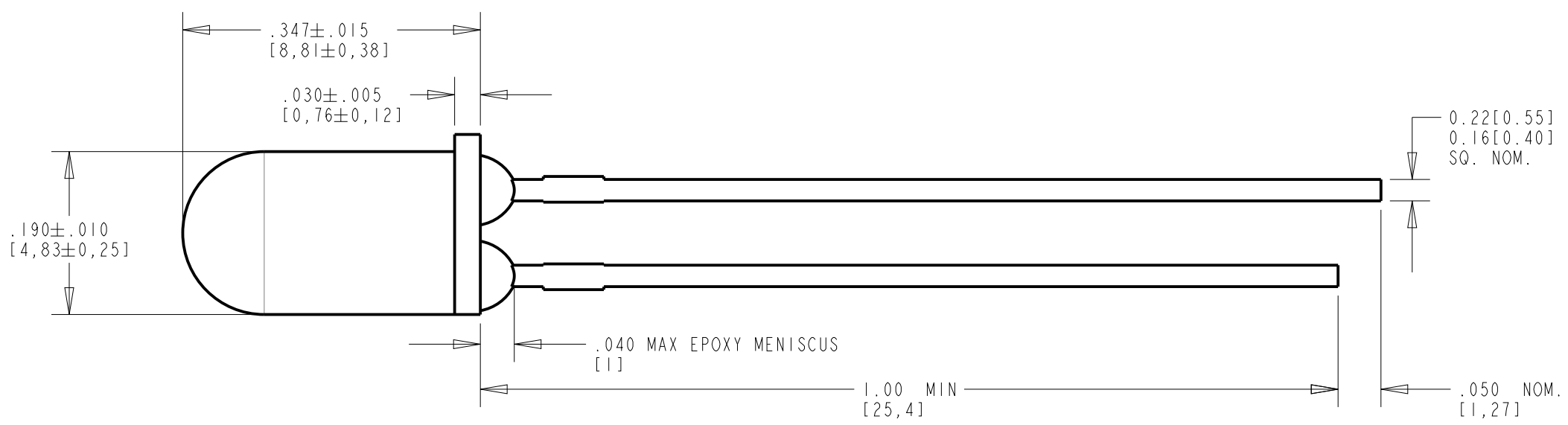

**RoHS Compliant 521-9183F**

Part Numbers with the "F" suffix ending are RoHS Compliant. Packaging is marked with "RoHS Compliant" label or equivalent markings.



**ATTENTION:**  
OBSERVE PRECAUTIONS FOR  
HANDLING ELECTROSTATIC  
SENSITIVE DEVICES

THIS DRAWING AND THE CONTENTS HEREIN ARE CONFIDENTIAL AND THE SOLE PROPERTY OF DIALIGHT CORP. REPRODUCTION OF THIS DRAWING OR CONSTRUCTION OF ANY PARTS WITHIN THIS DRAWING ARE FORBIDDEN WITHOUT THE WRITTEN CONSENT OF DIALIGHT CORP.

SCALE: 6.000	DRAWING NUMBER	REV
ALL DIM'S: INCH (mm)	C-17474	C
TOLERANCES: UNLESS OTHERWISE SPECIFIED	TITLE	
FRACTIONS: ±1/64	LED, 5mm RED, 5 VOLTS	
DECIMALS (.XX): ±.01	INTEGRAL RESISTOR LED RoHS COMPLIANT	
DECIMALS (.XXX): ±.005	MATERIAL	
DECIMALS (.XXXX): ±.0005		
ANGLES: ±1°		
FINISH		
FSCM 83330	<b>Dialight</b>	1501 ROUTE 34 SOUTH FARMINGDALE, NJ 07727 (732) 919-3119 www.dialight.com
	SHEET 1 OF 1	FAMILY TABLE: