

599 SERIES
MicroLED® SMD LED
Single-Color 0603
Low-Profile
1.60 x 0.80 x 0.4mm

MECHANICAL / SPECIFICATIONS

DIMENSIONS:
1.60 x 0.80 x 0.4mm

STANDARD PACKAGING:
4000 pcs on 7in. reel

CERTIFICATIONS & RATINGS
ROHS Compliant

FEATURES & BENEFITS

MOISTURE SENSITIVITY LEVEL: 2
Compatible with Automatic Placement Equipment

COUNTRY OF ORIGIN
Taiwan

DIMENSIONS inches [mm]

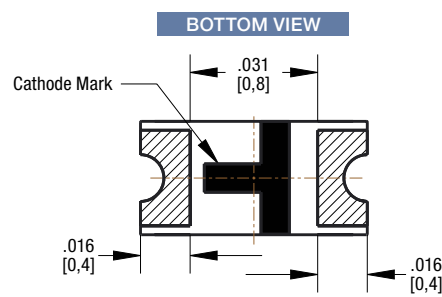
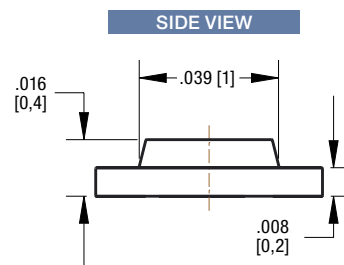
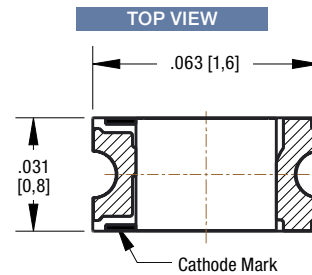

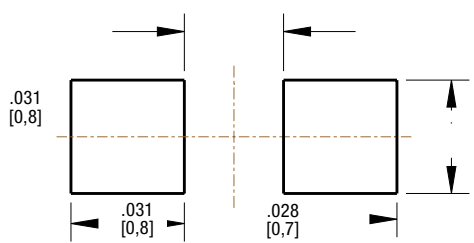

RECOMMENDED PAD LAYOUT



LED SCHEMATIC



ELECTRICAL/OPTICAL CHARACTERISTICS AT 25°C AMBIENT

Part Number	Emitted Color	Material	Lens Color	Luminous Intensity (mcd)			Dominant Wavelength (nm)			Forward Voltage (V)			Viewing Angle (°deg.)	Reverse Current Intensity (µA)
				Min	Typ	Max	Min	Typ	Max	Min	Typ	Max		
				If=20mA										
 599-0010-137F	● Red	AllInGaP	Water Clear	50		200	624	630	636	1.9		2.5	130	10
599-0030-137F	● Orange	AllInGaP		50		320	600	605	615	1.7		2.6		10
599-0040-137F	● Yellow	AllInGaP		50		320	589	595	598	1.7		2.6		10
599-0060-137F	● Yellow-Green	AllInGaP		20		125	568	572	576	1.7		2.6		10
599-0080-137F	● Green	InGaN		200		1250	520	525	534	2.8		3.6		50
599-0090-137F	● Blue	InGaN		50		320	465	470	477	2.8		3.6		10
 599-2000-137F	○ White	InGaN	Yellow Diffused	200		1250	x=0.26 y=0.225	-	x=0.31 y=0.34	2.8		3.6	50	

ABSOLUTE MAXIMUM RATINGS AT 25°C

LED Color	Power Dissipation (mW)	Forward Current (mA)	Reverse Voltage (V)	Peak Forward Current *(mA)	Operating Temperature (°C)	Storage Temperature (°C)
● Red	60	25	5	75	-40°C to +85°C	-40°C to +100°C
● Orange	65	25		60		
● Yellow	65	25		60		
● Yellow-Green	65	25		75		
● Green	72	20		100		
● Blue	72	20		100		
○ White	72	20		100		

TAPE AND REEL SPECIFICATION

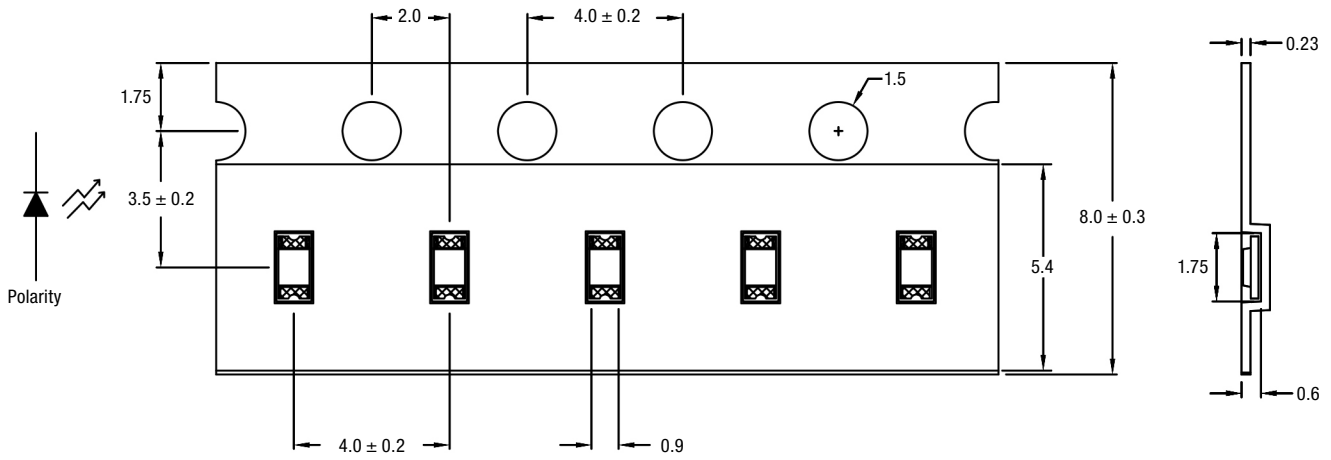

Note: The tolerances unless mentioned is $\pm 0.1\text{mm}$, Angle ± 0.5 . Unit=mm

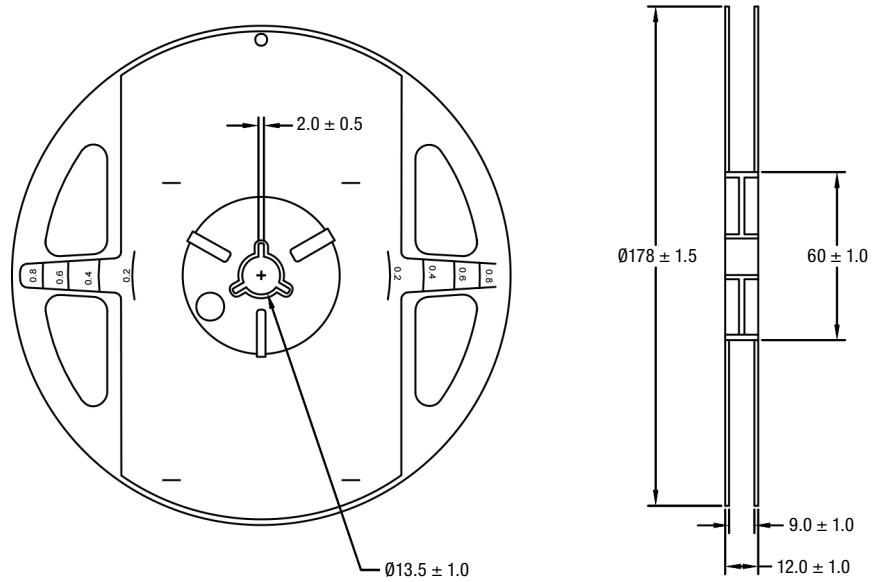

REFLOW SOLDERING

Recommend soldering paste specifications:

1. Operating temp.: Above 220°C ,60 sec. max.
2. Peak temp.:260°C Max.,10sec Max.
3. Reflow soldering should not be done more than two times.

REFLOW SOLDER PROFILE

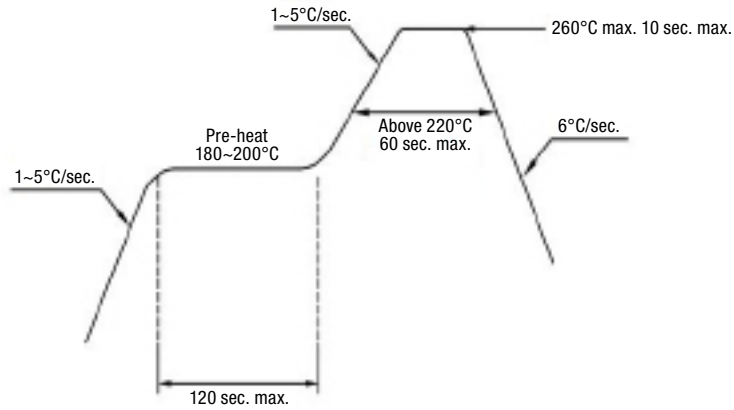

Dialight reserves the right to make changes at any time in order to supply the best product possible. The most current version of this document will always be available at: www.dialightsignalsandcomponents.com

Warranty Statement: Except for the warranty expressly provided for at: www.dialight.com/resources/warranties/, Dialight disclaims any and all other warranties, express or implied, including, without limitation, any warranties of merchantability, fitness for a particular purpose, title, and noninfringement.