

PERMANENT ADJUSTABLE STANDING SEAM ROOF ANCHOR

Part # 53221, 53569

Instruction Manual

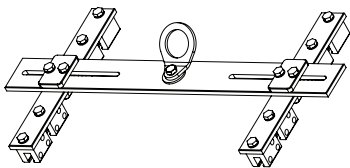

Contents

2	Applicable Safety Standards
2	Worker Classifications
2	Product Specific Applications
2	Product Capacity
3	Limitations
3	Compatibility
3	Maintenance, Cleaning, and Storage
4	Product Specifications and Materials
5	Installation and Use
8	Compatible SSMR List
11	Safety Information
12	Labels
13	Diagrams
13	Inspection
14	Inspection Log
15	Labels

- ✗ Do not throw instructions away.
- ⚠ Read and understand instructions before using this equipment.

Product Specific Applications



Fall Arrest: May be used to support a MAXIMUM 1 Personal Fall Arrest System (PFAS) for use in Fall Arrest applications.

Structure must withstand loads applied in the directions permitted by the system of at least 5,000 lb (22,2 kN) or maintain a 2:1 safety factor. Maximum permitted free fall is 6 ft (1,8 m), or up to 12 ft (3,6 m) if used in combination with equipment explicitly certified for such use.

D-rings: Dorsal.



Travel Restraint: May be used in Restraint applications. Restraint systems prevent workers from reaching the leading edge of a fall hazard. Always account for fully extended length of connecting equipment. Structure must withstand loads applied in the directions permitted by the system of at least 1,000 lb (4,4 kN). No free fall is permitted. Restraint systems may only be used on surfaces with slopes up to 4/12 (vertical/horizontal).

D-rings: Dorsal, Sternal, Frontal, Hips (pairs only).



Work Positioning: May be used in Work Positioning applications. Work Positioning systems allow a worker to be supported while in suspension and work freely with both hands. Structure must withstand loads applied in the directions permitted by the system of at least 3,000 lb (13 kN). Maximum permitted free fall is 2 ft (0,6 m).

D-rings: Hips (pairs only).



RESCUE/CONFINED SPACE:

May be used in **Rescue/Confined Space** applications. Rescue systems function to safely recover a worker from a confined location or after exposed to a fall. There are various configurations of Rescue systems depending on the type of rescue. Structure must withstand loads applied in the directions permitted by the system of at least 3,000 lb (13 kN). No free fall is permitted.

D-rings: Dorsal, Sternal, Shoulder (pairs only).

Product Capacity

- **Maximum user weight (including all clothing, tools, and equipment) is:**

130 - 420 lb (59-190 kg)

Applicable Safety Standards

When used in accordance with these instructions and all local, state, and federal requirements, this product meets or exceeds all applicable requirements of:

- **OSHA 1910.140**
 - **OSHA 1926.502**
-

Worker Classifications

- **Qualified Person:** A person with an accredited degree or certification, and with extensive experience or sufficient professional standing, who is considered proficient in planning/reviewing the conformity of fall protection and rescue systems.
 - **Competent Person:** A highly trained and experienced person who is ASSIGNED BY THE EMPLOYER to be responsible for all elements of a fall safety program, including, but not limited to, its regulation, management, and application. A person who is proficient in identifying existing and predictable fall hazards, and who has the authority to stop work in order to eliminate hazards.
 - **Authorized Person:** A person who is assigned by their employer to work around or be subject to potential existing fall hazards.
-

Compatibility

When making connections, eliminate all possibility of roll-out. Roll-out occurs when interference between a connector and the attachment point causes the connector gate to unintentionally open and release.

All connections must be selected and deemed compatible with the harness by a Competent Person.

All connector gates must be self-closing, self-locking, and withstand a minimum load of 3,600 lb (16 kN).

See Diagram A on page 13.

Limitations

Fall Clearance: There must be sufficient clearance below the work surface to arrest a fall before the user strikes the ground or an obstruction. When calculating fall clearance, account for free fall, maximum arrest distance, harness stretch, a minimum 2 ft (0,6 m) safety factor, swing fall, and all other applicable factors.

See Guardian Fall Clearance Calculator:
<https://guardianfall.com/digital-resources/fall-clearance-calculator>

Swing Falls: Prior to installation or use, make considerations for eliminating or minimising all swing fall hazards. Swing falls occur when the anchor is not directly above the location where a fall occurs. Always work as close to in-line with the anchor point as possible. Swing falls significantly increase the likelihood of serious injury or death in the event of a fall.

Maintenance, Cleaning, and Storage

Cleaning after use is important for maintaining the safety and longevity of the Permanent Adjustable Standing Seam Roof Anchor. Remove all dirt, corrosives, and contaminants from the equipment before and after each use. If Permanent Adjustable Standing Seam Roof Anchor cannot be cleaned with plain water, use mild soap and water, then rinse and wipe dry. NEVER clean Permanent Adjustable Standing Seam Roof Anchor with corrosive substances.

When not in use or during transport, store equipment where it will not be affected by heat, light, excessive moisture, chemicals, or other degrading elements.

Components

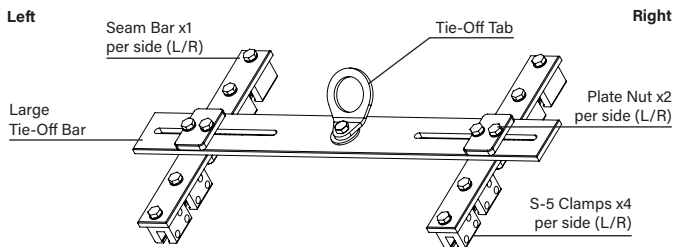

Part # 53221

Specifications

- Some assembly of components is necessary prior to installation and use of Permanent Adjustable Standing Seam Roof Anchor. Always use fasteners, S-5 Clamps, and Set Screws provided by Guardian. Components are manufactured from the following materials:

Large Tie-Off Bar: Aluminum

Seam Bar (2): Aluminum

Tie-Off Tab: Stainless Steel

S-5 Clamp (8): Aluminum

- (2) Set Screws are provided with each S-5 clamp. S-5 Clamps are designed with four Set Screw holes for increased versatility, but require only two Set Screws for use with the Permanent Adjustable Standing Seam Roof Anchor.

Materials

Aluminum and stainless steel.

Product Specifications

Part #	Description
53221	Permanent Adjustable Standing Seam Roof Anchor. Includes (2) Seam Bars, (4) Plate Nuts, (1) Tie-Off Bar, (1) Tie-Off Tab, (8) S-5 Clamps, & All Fastening Bolts
53569	Replacement S-5-U Clamp w/Fasteners
D105-0019	Anti-Seize

Installation and Use

Prior to installation, plan your system:

Ensure make, model, and material of selected standing seam metal roof (SSMR) are compatible with the Permanent Adjustable Standing Seam Roof Anchor. Refer to compatible SSMR list (pgs. 9-11). If SSMR does not appear on this list, do not install Permanent Adjustable Standing Seam Roof Anchor.

⚠ WARNING! Prior to installation, a Qualified Person must determine Permanent Adjustable Standing Seam Roof Anchor is compatible with roof seam. NEVER attach to incompatible roof seams.

⚠ Ensure all PFAS equipment is selected and deemed compatible with Permanent Adjustable Standing Seam Roof Anchor by Competent Person.

⚠ Make considerations for eliminating or minimizing swing fall hazards.

⚠ Ensure installation location and work surface are free of all damage, including, but not limited to, corrosion, rot, rust, debris, and sharp or abrasive edges and surfaces.

⚠ Permanent Adjustable Standing Seam Roof Anchor is rated for loading in any direction provided it is installed as prescribed.

⚠ Permanent Adjustable Standing Seam Roof Anchor may be used in combination with a temporary horizontal lifeline (HLL) system. No intermediate anchorage connectors may be used in a temporary HLL system of which the Permanent Adjustable Standing Seam Roof Anchor is a part. For use with permanent HLL systems, please contact Guardian Fall Protection for additional assistance.

Assembly

Torque all fasteners to 25-30 ft-lbs and ensure that MINIMUM 1 complete bolt thread is visible.

■ Step 1

Install Tie-Off Tab to Tie-Off Bar:

Apply provided anti-seize (or equivalent) to 2 in x 5/8 in-18 Bolt.

Insert bolt through Tie-Off Tab bolt hole, through washer, through Tie-Off Bar, and secure with lock nut. Tighten lock nut against underside of Tie-Off Bar. Tie-Off Tab must swivel freely a full 360°.

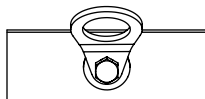

Top View

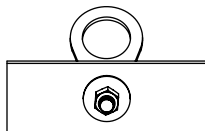

Bottom View

■ Step 2

Install all (8) S-5 Clamps (4 per Seam Bar) onto Seam Bars prior to installation of Seam Bars onto Tie-Off Bar. Insert bolt through washer, through Seam Bar, and through one of top two S-5 Clamp holes. One bolt and one washer per S-5 Clamp.

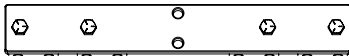

Installation

Step 1

3/16 in Allen wrench attachment tip (provided with S-5 Clamps) is required for installation of Permanent Adjustable Standing Seam Roof Anchor. To install, attach Allen wrench attachment to compatible 1/4 in drive screw gun.

Step 2

Adjust Permanent Adjustable Standing Seam Roof Anchor to match roof seam spacing. Compatible with roof seams from 12 in - 24 in apart. Tighten all (4) bolts on Tie-Off Bar to 25-30 ft-lbs.

Step 3

Place all S-5 Clamps over selected roof seams. Both sets of S-5 Clamps must be the same distance from roof edge.

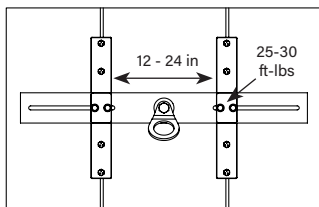

Step 4

Insert Set Screws in bottom two holes of all S-5 Clamps. All Set Screws must face same direction. Ensure all Set Screws will compress against roof seam when fully installed.

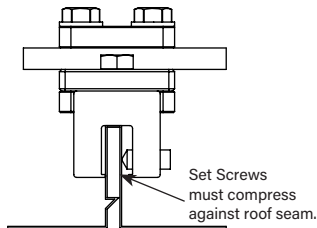
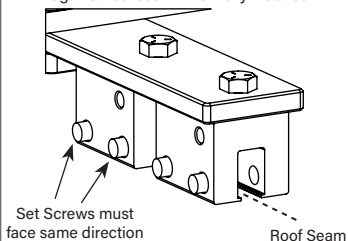

Step 5

Use 3/16 in Allen wrench attachment (provided with S-5 Clamps) with compatible 1/4 in drive screw gun to install Set Screws.

- If roof is 22 gauge or thicker, torque all S-5 Clamp Set Screws to between 13.33-15 ft-lbs.
- If roof is thinner than 22 gauge, torque all S-5 Clamp Set Screws to between 10.83-12.5 ft-lbs.

⚠ WARNING! NEVER over-torque set-screws; doing so could strip hardware or damage roof panels.

■ Step 6

As installation of Set Screws progresses, torque values of already installed Set Screws may change as tension on roof seam increases. As necessary, re-torque Set Screws until all Set Screws are within torque range specified by this instruction manual. Measure Set Screw torque with torque wrench.

▲ WARNING! When applying torque to Set Screws, ensure that selected drive screw gun (with 3/16 in Allen wrench attachment) is applying consistent and adequate torque. Prior to each use, ALWAYS use properly calibrated torque wrench to ensure all Set Screws are adequately torqued.

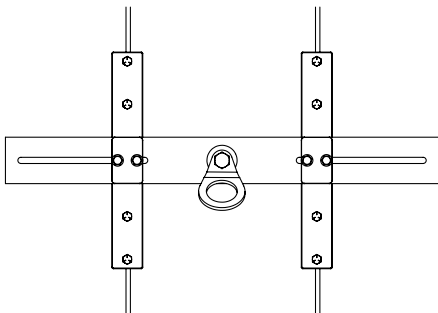
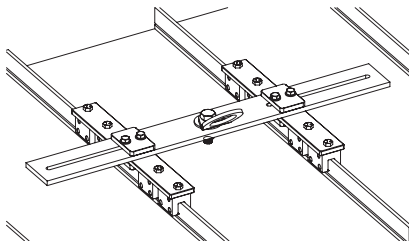



Compatible Standing Seam Metal Roofs (SSMR)

SSMR Manufacturer	SSMR Name	SSMR Thickness	SSMR Manufacturer	SSMR Name	SSMR Thickness
A&S	Double-Lok	22 gauge steel	Bryer Company	TBC-Ultra	22 gauge steel
A&S	DuraSeal Seam	22 gauge steel	Bryer Company	TBC-Ultra	24 gauge steel
A&S	DuraSeal Snap	22 gauge steel	Bryer Company	TBC-Superseam (Single Fold)	22 gauge steel
A&S	Ultra Dek	22 gauge steel	Bryer Company	TBC-Superseam (Double Fold)	22 gauge steel
A&S	DuraSeal Snap	24 gauge steel	Bryer Company	TBC-Superseam (Single Fold)	24 gauge steel
A&S	Ultra Dek	24 gauge steel	Butler	MR24	24 gauge steel
A&S	Double-Lok	24 gauge steel	Butler	VSR	24 gauge steel
A&S	DuraSeal Seam	24 gauge steel	Butler	MR24	22 gauge steel
AB Martin Roofing	AB Seam 19.5	24 gauge steel	Carlisle Engineered Metals, Inc.	Architectural Panel	22 gauge steel
AEP Span	Snap Seam	22 gauge steel	Carlisle Engineered Metals, Inc.	Architectural Panel	24 gauge steel
AEP Span	Snap Seam	24 gauge steel	Carlisle Engineered Metals, Inc.	VersaLok Panel	22 gauge steel
AEP Span	Span Seam (DBF)	22 gauge steel	Carlisle Engineered Metals, Inc.	VersaLok Panel	24 gauge steel
AEP Span	Multilok (Quad Lok)	24 gauge steel	CBC Steel Buildings	SS 24	24 gauge steel
AEP Span	Span Seam (DBF)	24 gauge steel	Ceco	CXP	22 gauge steel
AEP Span	Span Lok HP 2" SF	22 gauge steel	Ceco	CRP	24 gauge steel
AEP Span	Design Span hp	22 gauge steel	Ceco	CXP	22 gauge steel
All Weather Insulated Panels (AWIP)	SR Series (Single Fold)	24 gauge steel	Central States Manufacturing	Central Seam Plus	22 gauge steel
American Buildings Company	Loc Seam 360	22 gauge steel	Central States Manufacturing	Central Loc	22 gauge steel
American Buildings Company	Standing Seam 360	22 gauge steel	Central States Manufacturing	Central Loc	24 gauge steel
American Buildings Company	Loc Seam 360	24 gauge steel	Central States Manufacturing	Central Seam Plus	24 gauge steel
American Buildings Company	Standing Seam II Panel	22 gauge steel	Central Texas Metal Roofing Supply	ShurLoc 175	24 gauge steel
Architectural Building Components	Permaseam	22 gauge steel	Centria	SDP 175	22 gauge steel
Architectural Building Components	Permaseam	24 gauge steel	Centria	SDP 175	24 gauge steel
Architectural Building Components	Permaseam	22 gauge steel	Centria	SDP 200	24 gauge steel
Architectural Building Components	Permaseam	24 gauge steel	Centria	SDP 300	24 gauge steel
Architectural Metal Specialties, Inc.	AMSI75 1-3/4" Snap-Lock	24 gauge steel	Chief Industries	MSC Panel	22 gauge steel
Architectural Metal Specialties, Inc.	AMSI75 1-3/4" Snap-Lock	24 gauge steel	Chief Industries	STC Panel	22 gauge steel
Architectural Metal Specialties, Inc.	Ultraseam US175LS Snap-Lock	24 gauge steel	Chief Industries	STC Panel	24 gauge steel
ASC Building Products	Sterling Roof System	22 gauge steel	Chief Industries	MSC Panel	24 gauge steel
Associated Building Systems	KA-2000	22 gauge steel	Classic Roofing Systems	CR-S 36 (Single Fold)	22 gauge steel
Associated Building Systems	KA-2000	24 gauge steel	Classic Roofing Systems	CR-S 25 (Single Fold)	22 gauge steel
ATAS	2" Field-Lok	24 gauge steel	Construction Metals, Inc.	Sur-Lock	22 gauge steel
Bax Steel Buildings	Bax-Lock	22 gauge steel	Construction Metals, Inc.	Barrier Roof	22 gauge steel
Bax Steel Buildings	Bax-Lock	24 gauge steel	Construction Metals, Inc.	Barrier Roof	24 gauge steel
Bax-Steel Buildings, Inc.	Bax-Lock	22 gauge steel	Construction Metals, Inc.	Sur-Lock	24 gauge steel
Bax-Steel Buildings, Inc.	Bax-Lock	24 gauge steel	Copper Sales	UC4	24 gauge steel
BC Steel Buildings	BCL 24-MS	22 gauge steel	Corle Building Systems	Seam-Lok	22 gauge steel
BC Steel Buildings	BCL 24-SD	22 gauge steel	Corle Building Systems	Snap-Seal	22 gauge steel
BC Steel Buildings	BCL 24-SD	24 gauge steel	Corle Building Systems	Snap-Seal	24 gauge steel
BC Steel Buildings	BCL 24-MS	24 gauge steel	Corle Building Systems	Seam-Lok	24 gauge steel
Behlen Building Systems	ZL-24 Triple-Lock	24 gauge steel	Custom Built Metals	SL 1750 NT	24 gauge steel
Behlen Building Systems	ZL-16 Triple-Lock	22 gauge steel	Custom Built Metals	CB 150 (Double Fold) NT	22 gauge steel
Berridge	Cee-Lock	24 gauge steel	Dean Steel Buildings, Inc.	Pro Seam Panel	22 gauge steel



Compatible Standing Seam Metal Roofs (SSMR)

SSMR Manufacturer	SSMR Name	SSMR Thickness	SSMR Manufacturer	SSMR Name	SSMR Thickness
Dean Steel Buildings, Inc	Pro Seam Panel	24 gauge steel	Kirby Building Systems	Kirbylok 2000	24 gauge steel
Dimensional Metals	SL-25	22 gauge steel	Kirby Building Systems	Kirbylok 2000 MS	24 gauge steel
Dimensional Metals	IL-20	24 gauge steel	Knudson Building Systems	KR-20	24 gauge steel
Dimensional Metals	SL-25	24 gauge steel	Laura Star-Roof, BV	Spanlock 22 gauge steel	22 gauge steel
Dimensional Metals	DL-15	24 gauge steel	Laura Star-Roof, BV	Artlock 22 gauge steel	22 gauge steel
Drexel Metals	DMC 175S Snap Lock 1-3/4	24 gauge steel	Laura Star-Roof, BV	Artlock 24 gauge steel	24 gauge steel
Drexel Metals	DMC 210S (Armco Style)	22 gauge steel	MBCI	LokSeam	22 gauge steel
Drexel Metals	DMC 175S Snap Lock 1-3/4	22 gauge steel	MBCI	DoubleLok	22 gauge steel
Drexel Metals	DMC 200S 2" Double Fold	22 gauge steel	MBCI	LokSeam	24 gauge steel
Drexel Metals	DMC 210S (Armco Style)	24 gauge steel	MBCI	LokSeam	22 gauge steel
Drexel Metals	DMC 150SS (Double Fold)	22 gauge steel	MBCI	UltraDek	22 gauge steel
Drexel Metals	DMC 175S Snap Lock 1-3/4	24 gauge steel	MBCI UltraDek	UltraDek	24 gauge steel
Englert	Series 2000	22 gauge steel	MBCI	DoubleLok	24 gauge steel
Englert	Series 2500 (Double Fold)	22 gauge steel	MBCI	LokSeam	24 gauge steel
Englert	Series 2000	24 gauge steel	MBCI	SuperLok	22 gauge steel
Englert	Series 2400 (Double Fold)	22 gauge steel	MBCI	BattenLok	22 gauge steel
Englert	Series 2000	24 gauge steel	MBCI BattenLok	BattenLok	24 gauge steel
Englert	Series 1300	22 gauge steel	McElroy Metal	Maxima 1.5"	22 gauge steel
Fab Tech, Inc.	Seam-Lok	22 gauge steel	McElroy Metal	Medallion-Lok	22 gauge steel
Fab Tech, Inc.	Snap-Seal	22 gauge steel	McElroy Metal	Maxima 2" ADV	22 gauge steel
Fab Tech, Inc.	Snap-Seal	24 gauge steel	McElroy Metal	Medallion-Lok	24 gauge steel
Fab Tech, Inc.	Snap-Seal	24 gauge steel	McElroy Metal	Medallion-Lok	22 gauge steel
Fab Tech, Inc.	Seam-Lok	24 gauge steel	McElroy Metal	Master-Lok 90 (ML90)	22 gauge steel
Fabral	Thin Seam	24 gauge steel	McElroy Metal	Master-Lok 90 (ML90)	24 gauge steel
Fabral	Stand N Seam	24 gauge steel	McElroy Metal	Maxima 1.5"	24 gauge steel
Fabral	3" Snap Rib	24 gauge steel	McElroy Metal	Medallion-Lok	24 gauge steel
Firestone	UC14	24 gauge steel	McElroy Metal	Maxima 2" ADV	24 gauge steel
Firestone	UC4	24 gauge steel	McElroy Metal	ML-FS	22 gauge steel
Follansbee Steel	1in (25mm) DF (TCS)	.018 TCS II	Merchant & Evans	Interlock	24 gauge steel
Galvak, S.A. De C.V.	Galvalok II	22 gauge steel	Merchant & Evans	Interlock	.040 aluminum
Galvak, S.A. De C.V.	Galvalok I	22 gauge steel	Merchant & Evans	#305	24 gauge steel
Galvak, S.A. De C.V.	Galvalok I	24 gauge steel	Merchant & Evans	#305	.040 aluminum
Galvak, S.A. De C.V.	Galvalok II	24 gauge steel	Mesco	Double-Lok	22 gauge steel
Garco Building Systems	Garco Standing Seam	22 gauge steel	Mesco	Ultra Dek	22 gauge steel
Garco Building Systems	Garco Standing Seam	24 gauge steel	Mesco	Ultra Dek	24 gauge steel
Garland	R-Mer Loc	22 gauge steel	Mesco	Double-Lok	24 gauge steel
Imetco	Snap Lok 1-3/4"	22 gauge steel	Metal Sales	Vertical Seam	22 gauge steel
Inland Buildings	IN-LOC	24 gauge steel	Metal Sales	Vertical Seam	24 gauge steel
Interlock Roofing	Snap Lock 1"	.027 aluminum	Metal Sales	Magna Loc	22 gauge steel
Interlock Roofing	Future Roof 1.5" SF	26 gauge steel	Metal-Fab Manufacturing	MetFab Snap-On 675	24 gauge steel
Kingspan USA	KingZip 1020	22 gauge steel	Metal-Fab Manufacturing	MetFab III Panel	22 gauge steel
Kirby Building Systems	Kirbylok 2000 MS	22 gauge steel	Metal-Fab Manufacturing	MetFab III Panel	24 gauge steel
Kirby Building Systems	Kirbylok 2000	22 gauge steel	Metal-Fab Manufacturing	MetFab Historic Panel 1.5" DBF	22 gauge steel



Compatible Standing Seam Metal Roofs (SSMR)

SSMR Manufacturer	SSMR Name	SSMR Thickness	SSMR Manufacturer	SSMR Name	SSMR Thickness
Metal-Fab Manufacturing	MetFab Snap-on 550 Panel	24 gauge steel	Schulte Building Systems	TS-324 TripleLok	24 gauge steel
Morin	SLR	22 gauge steel	Star	Starshield	24 gauge steel
Morin	SWL	22 gauge steel	Steel Span, Inc.	Trapezoidal	22 gauge steel
Morin	SLR	24 gauge steel	Steel Span, Inc.	Trapezoidal	24 gauge steel
Morin	SWL	24 gauge steel	Steel Span, Inc.	Architectural	22 gauge steel
NCI/Midwest Metallic	Double-Lok	22 gauge steel	Steel Span, Inc.	Architectural	24 gauge steel
NCI/Midwest Metallic	Weather Roof III	22 gauge steel	Steelco	Sur-Lock	22 gauge steel
NCI/Midwest Metallic	Ultra Dek	22 gauge steel	Steelco	Barrier Roof Panels	22 gauge steel
NCI/Midwest Metallic	Weather Roof II	22 gauge steel	Steelco	Barrier Roof Panels	24 gauge steel
NCI/Midwest Metallic	Ultra Dek	24 gauge steel	Steelco	Sur-Lock	24 gauge steel
NCI/Midwest Metallic	Weather Roof II	24 gauge steel	Steelway Building Systems	RTL-24 Quad Loc	22 gauge steel
NCI/Midwest Metallic	Double-Lok	24 gauge steel	Steelway Building Systems	RTL-24 Quad Loc	24 gauge steel
NCI/Midwest Metallic	Weather Roof III	24 gauge steel	Taylor Metals	Versa-Span	24 gauge steel
NCI/Midwest Metallic	216	22 gauge steel	Taylor Metals	MS 200	22 gauge steel
NCI/Midwest Metallic	BattenLok	22 gauge steel	Taylor Metals	MS 200	24 gauge steel
NCI/Midwest Metallic	216	24 gauge steel	Tremco	TremLock LSP	22 gauge steel
NCI/Midwest Metallic	BattenLok	24 gauge steel	Triad Corrugated Metal, Inc.	Snap Lock 1-3/4	24 gauge steel
New Tech Machinery	SS 675 Snap Lock 1-3/4	24 gauge steel	U.S. Metals	US-175LS	22 gauge steel
New Tech Machinery	SS 210A (Armco Style) 2	22 gauge steel	U.S. Metals	US-175LS	24 gauge steel
New Tech Machinery	SS 210A (Armco Style) 2	24 gauge steel	U.S. Metals	US-150	22 gauge steel
New Tech Machinery	SS 150 (Double Fold)	22 gauge steel	Una-Clad	UC14	24 gauge steel
New Tech Machinery	SS 675 Snap Lock 1-3/4	24 gauge steel	Una-Clad	UC4	24 gauge steel
New Tech Machinery	SS 550 Snap Lock 1 1/2	24 gauge steel	Union Corrugating Company	ML150 (Double Fold)	22 gauge steel
Nu Ray Metals	Series 2000 Standing Seam	24 gauge steel	Union Corrugating Company	SL150	24 gauge steel
Nucor Building Systems	VR16-II Vise-Lock 360	24 gauge steel	United Structures of America	Guardian II	22 gauge steel
Nucor Building Systems	CFR Vise Lock 360 Seam	24 gauge steel	United Structures of America	Guardian I	22 gauge steel
OC Metals	OCM 175 SL	24 gauge steel	United Structures of America	Guardian I	24 gauge steel
OC Metals	OCM 175 SL	24 gauge steel	United Structures of America	Guardian II	24 gauge steel
Petersen Aluminum Corp	Snap Clad	22 gauge steel	Varco Pruden	SSR	24 gauge steel
Petersen Aluminum Corp	Snap Clad	24 gauge steel	Varco Pruden	SLR	22 gauge steel
Petersen Aluminum Corp	Snap Clad	22 gauge steel	Whirlwind Building Systems	Super Seam Plus	22 gauge steel
Petersen Aluminum Corp	Snap Clad	24 gauge steel	Whirlwind Building Systems	Super Seam II	22 gauge steel
Petersen Aluminum Corp	Tite-Loc Plus	22 gauge steel	Whirlwind Building Systems	Super Seam II	24 gauge steel
Petersen Aluminum Corp	Tite-Loc	22 gauge steel	Whirlwind Building Systems	Super Seam Plus	24 gauge steel
Petersen Aluminum Corp	Tite-Loc	24 gauge steel	Zamil Steel Industries	Max Seam	22 gauge steel
Rigid Global Buildings	Platinum Series Quad-Lok	24 gauge steel	Zamil Steel Industries	Max Seam	24 gauge steel
Rigid Global Buildings	Hi-Tech Series Quad-Lok	24 gauge steel	Zimmerman Metals, Inc.	SL1750	22 gauge steel
Robertson Building Systems	Starshield-SSR	24 gauge steel	Zimmerman Metals, Inc.	SL1750	24 gauge steel

Safety Information

⚠ WARNING! Failure to understand and comply with safety regulations may result in serious injury or death. Regulations included herein are not all-inclusive, are for reference only, and are not intended to replace a Competent Person's judgment or knowledge of federal or state standards.

⚠ CAUTION! Understand the definitions of those who work near, or who may be exposed to, fall hazards.

⚠ WARNING! Use of equipment in unintended applications may result in serious injury or death. Maximum 1 attachment per connection point.

Do not alter equipment.

Workplace conditions, including, but not limited to, corrosive chemicals, electrical shock, sharp objects or edges, machinery, flame/high heat, abrasive or uneven surfaces, UV exposure, and severe or prolonged weather conditions, must be assessed by a Competent Person (CP) before fall protection equipment is selected. The presence of any/all of these conditions may have negative effects on product performance or service lifetime.

The analysis of the workplace must anticipate where workers will be performing their duties, the routes they will take to reach their work, and the potential and existing fall hazards they may be exposed to. Fall protection equipment must be chosen by a CP. Selections must account for all potential hazardous workplace conditions. All fall protection equipment should be purchased new and in an unused condition.

Fall protection systems must be selected and installed under the supervision of a CP, and used in a compliant manner. The system must be designed in a manner compliant with all federal, state, and safety regulations. Forces applied to anchors must be calculated by a CP.

Harnesses and connectors selected must be compliant with manufacturer's instructions, and must be of compatible size and configuration. Snap hooks, carabiners, and other connectors must be selected and applied in a compatible fashion. All risk of disengagement must be eliminated. All snap hooks and carabiners must be self-locking and self-closing, and must never be connected to each other.

See Diagram A on page 13.

A pre-planned rescue procedure in the case of a fall is required. The rescue plan must be project-specific. The rescue plan must allow for employees to rescue themselves, or provide an alternative means for their prompt rescue to minimise post fall suspension time. Store rescue equipment in an easily accessible and clearly marked area.

Training of Authorized Persons (APs) to correctly erect, disassemble, inspect, maintain, store, and use equipment must be provided by a CP. Training must include the ability to recognise fall hazards, minimise the likelihood of fall hazards, and the correct use of personal fall arrest systems.

NEVER use fall protection equipment of any kind to hang, lift, support, or hoist tools or equipment, unless explicitly certified for such use.

Equipment subjected to forces of fall arrest must immediately be removed from use.

Age, fitness, and health conditions can seriously affect the worker should a fall occur. Consult a doctor if there is any reason to doubt a user's ability to safely withstand fall arrest forces or perform set-up of equipment. Pregnant women and minors MUST NOT use this equipment.

Physical harm may still occur even if fall safety equipment functions correctly. Sustained post-fall suspension may result in serious injury or death. Use trauma relief straps to reduce the effects of suspension trauma.

Labels

1



GUARDIAN
guardianfall.com

**PERMANENT ADJUSTABLE
STANDING SEAM ROOF ANCHOR**

Part #: 53221 DOM: Serial #:

OSHA 1926.502 & 1910.140
User Weight Capacity (incl. equipment): 130-420 lb.
Minimum Breaking Strength: 5,000 lb.
Maximum 1 connection per anchor.

⚠ WARNING Read instructions before using. Failure to follow instructions may result in serious injury or death. Avoid contact with sharp or abrasive edges and surfaces.

See Instructions for Compatible Seams

DO NOT REMOVE LABELS

Assembled in USA 90027 Rev. H-1



1

Permanent Adjustable Standing Seam Roof Anchor
 Part # 53221 DOM #
 Serial #

OSHA 1926.502 & 1910.140,
 User Weight Capacity: 130-420 lb.
 Minimum Breaking Strength: 5,000 lb.
 Maximum 1 connector per anchor.

Warning Read instructions before using. Failure to follow instructions may result in serious injury or death. Avoid contact with sharp or abrasive edges and surfaces.

See instructions for compatible seams
 Do not remove labels

Assembled in USA / 90027 Rev. H-1

2

User must inspect prior to EACH use. Competent Person must complete formal inspection every 12 months. Competent Person to inspect and initial.

Product lifetime is indefinite as long as equipment passes pre-use and Competent Person inspections.

If equipment fails inspection or is exposed to a fall IMMEDIATELY REMOVE FROM SERVICE.

Inspection Date	Initials

Date of First Use

DO NOT REMOVE LABELS

90060 Rev. H-2

2

User must inspect prior to EACH use. Competent Person must complete formal inspection every 12 months. Competent Person to inspect and initial.

Product lifetime is indefinite as long as equipment passes pre-use and Competent Person inspections.

If equipment fails inspection or is exposed to a fall IMMEDIATELY REMOVE FROM SERVICE.

Inspection Grid.

Date of First Use.

Do not Remove Label

90027 Rev. H-2

Diagram A - Connections

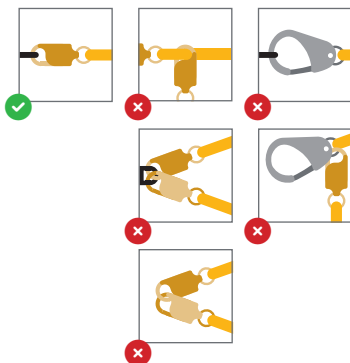

Inspection

Prior to EACH use, inspect Permanent Adjustable Standing Seam Roof Anchor for deficiencies, including, but not limited to, corrosion, deformation, pits, burrs, rough surfaces, sharp edges, cracking, rust, paint build-up, excessive heating, alteration, broken stitching, fraying, and missing or illegible labels. **IMMEDIATELY remove Permanent Adjustable Standing Seam Roof Anchor from service if defects or damage are found, or if exposed to forces of fall arrest.**

Ensure that applicable work area is free of all damage, including, but not limited to, debris, rot, rust, decay, cracking, and hazardous materials. Ensure that work area will support the application-specific minimum loads set forth in this manual. Work area **MUST** be stable.

At least every 12 months, a Competent Person (CP) other than the user must inspect anchor.

See Inspection Log on page 14.

Inspections *MUST* be recorded in inspection log in instruction manual and on equipment inspection grid label. The CP must sign their initials in the box corresponding to the month and year the inspection took place.

During inspection, consider all applications and hazards the harness has been subjected to.

Product lifetime is indefinite as long as it passes pre-use and CP inspections.

This inspection log must be specific to one Anchor. Separate inspection logs must be used for each Anchor. All inspection records must be made visible and available to all users at all times. If equipment fails inspection it must be discarded immediately.

[illegible]



Notes



USA

607 East Sam Houston Parkway South
Suite 800
Pasadena, TX 77503
800 466 6385
customer.service@guardianfall.com

CANADA

580 Notre Dame Avenue, Unit 16
Sudbury, ON
P3C 5L2
800 466 6385
customer.service@guardianfall.com

WARRANTY: Guardian warrants to Buyer that all products are free from defects in material, workmanship, and design (if a Supplier-responsible design), however this warranty does not cover conditions resulting from normal wear and tear, neglect, abuse, accident or otherwise. Guardian's obligations under this warranty apply for the lifetime of the products and are limited to the replacement of product only. This warranty is not transferable to any other Guardian service and does not apply to product that is resold after having been put into service. No other person, firm, entity, or the like is authorized to assume or assign for Guardian any other liability in connection with the sale or use of Guardian's products. Furthermore, this warranty is void if any product is changed or altered in any way, or if the product is used in a manner other than for which it is intended. There are no implied warranties of merchantability or fitness for a particular purpose, which are specifically disclaimed.