



TEST REPORT

Report No. 010224010194R1

DATED: 02 MAY 2025

Client : PLAN CREATIONS CO., LTD.
8 MOO 8, TRANG-PALIAN RD.,
YANTAKAO, TRANG 92140 THAILAND

Buyer : /

Sample Description : BBQ PLAYSET

Item No. : 3629

SKU No. : /

Model / Style : /

Client Specified Age Grade : 2Y+

Manufacturer : /

Country of Origin : THAILAND

Country of Destination : /

Test Sample Received : RECEIVED 30/04/2024

Test Period : FROM 30/04/2024 TO 07/05/2024

Report was revised as per client request and shall supersede Report # 010224010194, dated 07 May 2024

TEST REQUESTED	CONCLUSION	REMARK
EN 71-1:2014+A1:2018 – PHYSICAL AND MECHANICAL PROPERTIES	PASS	-
EN 71-2:2020 – FLAMMABILITY	PASS	-
EN 71-3:2019+A2:2024 – MIGRATION OF CERTAIN ELEMENTS	PASS	-

Remark:

1. The sample is tested “2Y+” as per client requested.
2. The Labeled Age Grade is 2Y+.

For technical enquiries or any other concerns,
please contact:

GIC TESTING & INSPECTION SERVICES PTE LTD

Tel: +65 6741 2260

Email: services.sg@gicgrp.com

PREPARED BY:

LUKMAN YUSOFF

TESTING ENGINEER

APPROVED BY:

ALEX LAU

TECHNICAL DIRECTOR

GIC Testing & Inspection Services Pte Ltd

158 Kallang Way #08-01
Singapore 349245

SAMPLE PHOTO

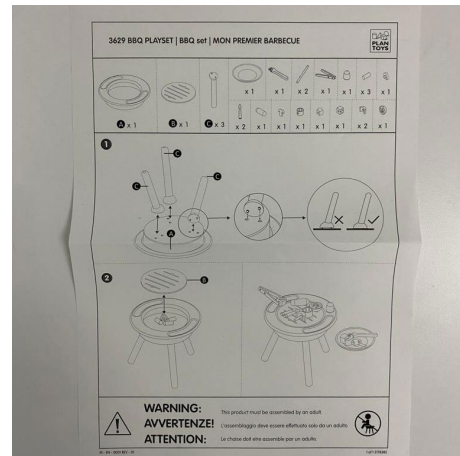

SAMPLE PHOTO



3629
BBQ Playset
2y+



Report No. 010224010194R1

DATED: 02 MAY 2025

REMARK:

As per customer request, results for chemical tests listed below were referenced from the corresponding reports, issued no more than 12 months prior to this report.

Item Description: 3629 BBQ PLAYSET

<u>Components</u>	<u>Report Number</u>	<u>Date of Issue</u>
<u>EN 71-3:2019+A2:2024 Migration of Certain Elements</u>		
1 SOLID WOOD	010223060067	20-Jun-23
2 PLYWOOD	010223060068	4509700%
3 BLACK SAWDUST	010224030206	28-Mar-24
4 5290099 ORANGE RUBBER	010223120089	17-Jan-24
5 WHITE ELASTIC	010224020099	5-Mar-24
6 5260142/5260143 WHITE PLASTIC JOINT	010223120092	8-Jan-24
7 5033776 LIGHT YELLOW PLASTIC	010224030082	28-Mar-24
8 YELLOW COATING ON WOOD (light)	010223120131	22-Jan-24
9 LIGHT GREEN COATING ON WOOD	010224010338	21-Feb-24
10 CLEAR COATING ON WOOD	010223060081	27-Jun-23
11 WHITE COATING ON WOOD	010223040051	26-Apr-23
12 DARK GREEN COATING ON WOOD	010223050026	16-May-23
13 RED COATING ON WOOD	010223120128	22-Jan-24
14 LIGHT BROWN COATING ON WOOD	010223120132	22-Jan-24
15 BLACK COATING ON WOOD	010223040051	26-Apr-23
16 YELLOW COATING ON WOOD (dark)	010223120160	22-Jan-24
17 ORANGE COATING ON WOOD	010223120127	22-Jan-24
18 BROWN COATING ON WOOD	010223120130	22-Jan-24
19 LIGHT YELLOW COATING ON WOOD	010224020035	6-Mar-24



Report No. 010224010194R1

DATED: 02 MAY 2025

TEST RESULT(S):

EN 71-1:2014+A1:2018 – Physical and Mechanical Properties

Test Method : Reference to EN 71-1:2014+A1:2018.

Clause	Requirement	Result
4.1	Material cleanliness	M
4.2	Assembly	M
4.3	Flexible plastic sheeting	NA
4.4	Toy bags	NA
4.5	Glass	NA
4.6	Expanding materials	NA
4.7	Edges	M
4.8	Points and metallic wires	M
4.9	Protruding parts	NA
4.10	Parts moving against each other	NA
4.11	Mouth actuated toys and other toys intended to be put in the mouth	NA
4.12	Balloons	NA
4.13	Cord of toy kites and other flying toys	NA
4.14	Toys which a child can enter	NA
4.15	Toys propelled by child	NA
4.16	Heavy immobile toys	NA
4.17	Projectiles	NA
4.18	Aquatic toys and inflatable toys	NA
4.19	Percussion caps	NA
4.20	Acoustics	NA
4.21	Toys containing a non-electrical heat source	NA
4.22	Small balls	NA
4.23	Magnets	NA
4.24	Yo-yo balls	NA
4.25	Toys attached to food	NA
5	Toys intended for children under 36 months	M
6	Packaging	NA
7	Warning, instructions for use	M

Note:

M = Meet

NM = Not Meet

NA = Not Applicable

R = Refer to Comment Section

NR = Not Requested

NT = Not Tested

NP = Not Present

EN 71-2:2020 - Flammability

Test Method : Reference to EN 71-2:2020.

Test Item(s)	Item / Component Description(s)
1	3629 BBQ PLAYSET

Subclause	Requirement	Result
4.1	General requirement	PASS
4.2	Toys to be worn on the head	NA
4.3	Toy disguise costumes and toys intended to be worn by a child in play	NA
4.4	Toys intended to be entered by a child	NA
4.5	Soft-filled toys	NA

Note:

M = Meet

NM = Not Meet

NA = Not Applicable

R = Refer to Comment Section

NR = Not Requested

NT = Not Tested

NP = Not Present

DNI = Did Not Ignite



Report No. 010224010194R1

DATED: 02 MAY 2025

TEST RESULT(S): (Continued)

EN 71-3:2019+A2:2024 – Migration of Certain Elements

Test Method : Reference to BS EN 71-3:2019+A2:2024 Analysis by ICP-MS.

See Soluble Element and its corresponding Maximum Allowable Limit in Result Table	Category I	Pliable modelling materials or other solid materials intended to leave a trace appearing in the toy
	Category II	Liquid paints/inks and other similar materials appearing as such in the toy (e.g. bubble solution), and glue sticks
	Category III	Coatings, polymeric materials (e.g. plastics), paper, textiles, glass, ceramic, metallic, wood and other solid materials

Test Item(s)	Item / Component Description(s)
1	SOLID WOOD
2	PLYWOOD
3	BLACK SAWDUST
4	5290099 ORANGE RUBBER
5	WHITE ELASTIC
6	5260142/5260143 WHITE PLASTIC JOINT
7	5033776 LIGHT YELLOW PLASTIC
8	YELLOW COATING ON WOOD (light)
9	LIGHT GREEN COATING ON WOOD
10	CLEAR COATING ON WOOD
11	WHITE COATING ON WOOD
12	DARK GREEN COATING ON WOOD
13	RED COATING ON WOOD
14	LIGHT BROWN COATING ON WOOD
15	BLACK COATING ON WOOD
16	YELLOW COATING ON WOOD (dark)
17	ORANGE COATING ON WOOD
18	BROWN COATING ON WOOD
19	LIGHT YELLOW COATING ON WOOD



Report No. 010224010194R1

DATED: 02 MAY 2025

TEST RESULT(S): (Continued)

Test Item(s)	Unit	Permissible Limit	Result			
			1	2	3	4
Category Type	-	III	III	III	III	III
Aluminium (Al)	mg/kg	28130	ND	ND	ND	ND
Antimony (Sb)	mg/kg	560	ND	ND	ND	ND
Arsenic (As)	mg/kg	47	ND	1.37	ND	ND
Barium (Ba)	mg/kg	18750	ND	ND	ND	ND
Boron (B)	mg/kg	15000	ND	ND	18.9	ND
Cadmium (Cd)	mg/kg	17	ND	ND	ND	ND
Chromium III (Cr III)	mg/kg	460	0.0200	0.0200	0.05	0.10
Chromium VI (Cr VI)	mg/kg	0.053	ND	ND	ND	ND
Cobalt (Co)	mg/kg	130	ND	ND	ND	ND
Copper (Cu)	mg/kg	7700	ND	ND	ND	ND
Lead (Pb)	mg/kg	23	ND	ND	ND	ND
Manganese (Mn)	mg/kg	15000	40.0	18.0	19.0	ND
Mercury (Hg)	mg/kg	94	ND	ND	ND	ND
Nickel (Ni)	mg/kg	930	ND	ND	ND	ND
Selenium (Se)	mg/kg	460	ND	ND	ND	ND
Strontium (Sr)	mg/kg	56000	ND	ND	ND	ND
Tin (Sn)	mg/kg	180000	ND	ND	1.1	ND
Organic tin	mg/kg	12	ND	ND	ND	ND
Zinc (Zn)	mg/kg	46000	ND	ND	ND	ND
Conclusion	-	-	PASS	PASS	PASS	PASS

Test Item(s)	Unit	Permissible Limit	Result				
			5	6	7	8	9
Category Type	-	III	III	III	III	III	III
Aluminium (Al)	mg/kg	28130	67.3	ND	ND	118	825
Antimony (Sb)	mg/kg	560	ND	ND	ND	ND	ND
Arsenic (As)	mg/kg	47	ND	ND	ND	ND	ND
Barium (Ba)	mg/kg	18750	ND	ND	ND	122	ND
Boron (B)	mg/kg	15000	ND	ND	ND	ND	ND
Cadmium (Cd)	mg/kg	17	ND	ND	ND	ND	ND
Chromium III (Cr III)	mg/kg	460	0.08	ND	ND	0.83	0.34
Chromium VI (Cr VI)	mg/kg	0.053	ND	ND	ND	ND	ND
Cobalt (Co)	mg/kg	130	ND	ND	ND	ND	ND
Copper (Cu)	mg/kg	7700	ND	ND	ND	ND	ND
Lead (Pb)	mg/kg	23	ND	ND	ND	ND	ND
Manganese (Mn)	mg/kg	15000	ND	ND	ND	ND	ND
Mercury (Hg)	mg/kg	94	ND	ND	ND	ND	ND
Nickel (Ni)	mg/kg	930	ND	ND	ND	ND	ND
Selenium (Se)	mg/kg	460	ND	ND	ND	ND	ND
Strontium (Sr)	mg/kg	56000	ND	ND	ND	38.1	ND
Tin (Sn)	mg/kg	180000	ND	ND	ND	2.1	ND
Organic tin	mg/kg	12	ND	ND	ND	ND	ND
Zinc (Zn)	mg/kg	46000	904	ND	ND	ND	ND
Conclusion	-	-	PASS	PASS	PASS	PASS	PASS



Report No. 010224010194R1

DATED: 02 MAY 2025

TEST RESULT(S): (Continued)

Test Item(s)	Unit	Permissible Limit	Result				
			10	11	12	13	14
Category Type	-	III	III	III	III	III	III
Aluminium (Al)	mg/kg	28130	ND	434	247	119	129
Antimony (Sb)	mg/kg	560	ND	ND	ND	ND	ND
Arsenic (As)	mg/kg	47	ND	ND	ND	ND	ND
Barium (Ba)	mg/kg	18750	ND	ND	ND	8.6	ND
Boron (B)	mg/kg	15000	ND	ND	ND	ND	ND
Cadmium (Cd)	mg/kg	17	ND	ND	ND	ND	ND
Chromium III (Cr III)	mg/kg	460	0.48	1.33	0.38	0.71	0.31
Chromium VI (Cr VI)	mg/kg	0.053	ND	ND	ND	ND	ND
Cobalt (Co)	mg/kg	130	ND	ND	ND	ND	ND
Copper (Cu)	mg/kg	7700	ND	ND	37	ND	ND
Lead (Pb)	mg/kg	23	ND	ND	ND	ND	ND
Manganese (Mn)	mg/kg	15000	ND	ND	ND	5.8	ND
Mercury (Hg)	mg/kg	94	ND	ND	ND	ND	ND
Nickel (Ni)	mg/kg	930	ND	ND	ND	ND	ND
Selenium (Se)	mg/kg	460	ND	ND	ND	ND	ND
Strontium (Sr)	mg/kg	56000	ND	ND	ND	ND	ND
Tin (Sn)	mg/kg	180000	ND	1.62	ND	ND	ND
Organic tin	mg/kg	12	ND	ND	ND	ND	ND
Zinc (Zn)	mg/kg	46000	ND	161	ND	6.6	ND
Conclusion	-	-	PASS	PASS	PASS	PASS	PASS

Test Item(s)	Unit	Permissible Limit	Result				
			15	16	17	18	19
Category Type	-	III	III	III	III	III	III
Aluminium (Al)	mg/kg	28130	ND	38.6	114	135	374
Antimony (Sb)	mg/kg	560	ND	ND	ND	ND	ND
Arsenic (As)	mg/kg	47	ND	ND	ND	ND	ND
Barium (Ba)	mg/kg	18750	ND	ND	ND	ND	ND
Boron (B)	mg/kg	15000	ND	ND	ND	ND	ND
Cadmium (Cd)	mg/kg	17	ND	ND	ND	ND	ND
Chromium III (Cr III)	mg/kg	460	0.03	0.30	0.18	0.73	0.38
Chromium VI (Cr VI)	mg/kg	0.053	ND	ND	ND	ND	ND
Cobalt (Co)	mg/kg	130	ND	ND	ND	ND	ND
Copper (Cu)	mg/kg	7700	ND	ND	ND	ND	ND
Lead (Pb)	mg/kg	23	ND	ND	ND	1.2	ND
Manganese (Mn)	mg/kg	15000	ND	ND	ND	ND	ND
Mercury (Hg)	mg/kg	94	ND	ND	ND	ND	ND
Nickel (Ni)	mg/kg	930	ND	ND	ND	ND	ND
Selenium (Se)	mg/kg	460	ND	ND	ND	ND	ND
Strontium (Sr)	mg/kg	56000	ND	ND	8.1	ND	ND
Tin (Sn)	mg/kg	180000	0.97	ND	ND	ND	ND
Organic tin	mg/kg	12	ND	ND	ND	ND	ND
Zinc (Zn)	mg/kg	46000	ND	28.7	ND	ND	ND
Conclusion	-	-	PASS	PASS	PASS	PASS	PASS

Note:

- mg/kg = milligram per kilogram
- Reporting limit for Cr (III), Cr (VI) = 0.02 mg/kg, and for Organic Tin = 0.9 mg/kg
- Reporting limit for Pb = 1.0 mg/kg, for As, Cd = 0.5 mg/kg
- Reporting limit for Al, Sb, Ba B, Co, Hg, Cu, Mn, Ni, Se, Sr, Zn, Sn = 5.0 mg/kg
- Confirmation test of chromium (III) is not required in case of chromium does not exceed their requirements as specified in EN 71-3:2019+ A2: 2024.



Report No. 010224010194R1

DATED: 02 MAY 2025

Remark:

- Test Item(s) was (were) tested according to European Standard EN 71-3:2019+ A2: 2024, Section 8.
- Results of Cr III and Cr VI were reported as sum of soluble chromium content unless further verified.
- Result(s) of organic tin was (were) calculated by assuming the soluble tin content was wholly contributed from tributyltin (TBT) cation unless further specified.
- The pH measured shall be reported after migration if it was outside the range of 1.1 to 1.3.

END OF REPORT

This report sets forth our findings solely with respect to the test samples identified herein. The results in this report are not representative of the quality or characteristics of the lot/batch from which a test sample was taken or any similar or identical product unless specifically and expressly noted. The sample/s mentioned in this report is/are submitted/supplied/manufactured by the Client, GIC Testing & Inspection Services Pte. Ltd. therefore assumes no responsibility for the accuracy of information on the brand name, model/ style number, consignment or any information supplied. Unless otherwise stated in this report, no tests were conducted to determine long term effects of using the specific product. Any copying or replication of this report to or for any other person or entity, or use of our name or trademark, is permitted only with our prior written permission.