



TEST REPORT

Report No. 010121030095R1

Dated NOV 29, 2021

Client : PLAN CREATIONS CO., LTD.
8 MOO 8, TRANG-PALIAN RD.,
YANTAKAO, TRANG 92140
ATTN: MS RATCHADA KONGTHON

Buyer : /

Test Sample Received : RECEIVED ON 11/03/2021

Test Period : FROM 11/03/2021 TO 17/03/2021

Sample Description : BABY WALKER

Product Code : 5123

Age Grade : 10M+

Manufacturer : /

Country of Destination : /

Country of Origin : THAILAND

**Report was revised as per client request and shall supersede Report# 010121030095, dated 17 Mar 2021.*

TEST REQUESTED	CONCLUSION	REMARK
EN 71-1:2014+A1:2018 – PHYSICAL AND MECHANICAL PROPERTIES	PASS	-
ISO 8124-8:2016 AGE DETERMINATION GUIDELINES	DATA	-
EN 71-2:2020 – FLAMMABILITY	PASS	-
EN 71-3:2019+A1:2021 – MIGRATION OF CERTAIN ELEMENTS	PASS	-

For technical enquiries or any other concerns, please contact:

GIC TESTING & INSPECTION SERVICES

Tel: +65 6741 2260

Email: services.sg@gicgrp.com

PREPARED BY:

EDMUND YAP
LABORATORY MANAGER

APPROVED BY:

SUZEN CHONG
SENIOR VICE PRESIDENT

TEST REPORT

Report No. 010121030095R1

Dated NOV 29, 2021

SAMPLE PHOTO

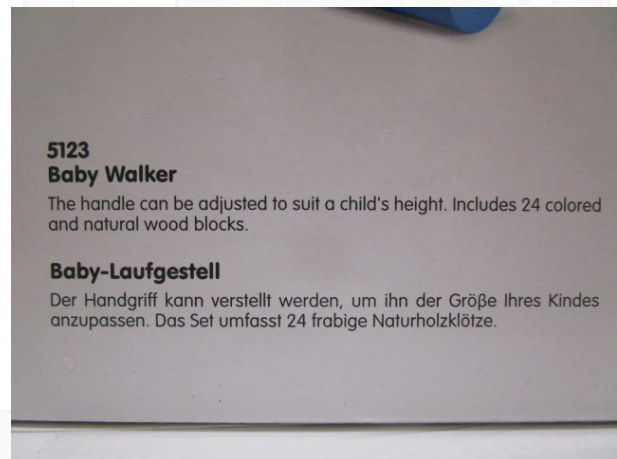

SAMPLE PHOTO

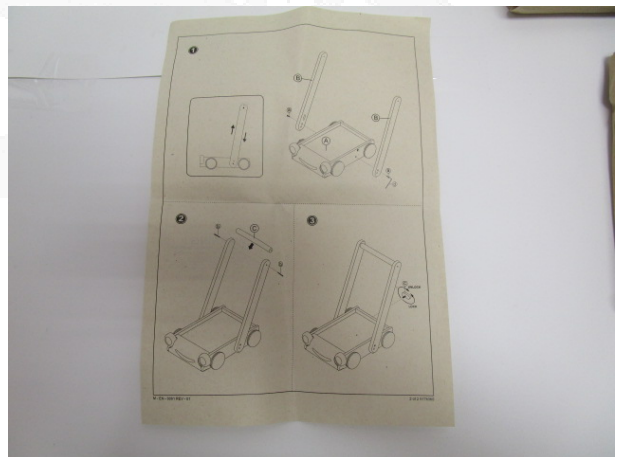
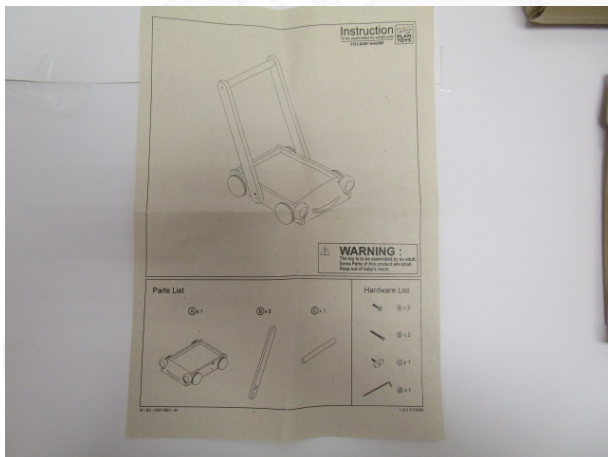

SAMPLE PHOTO

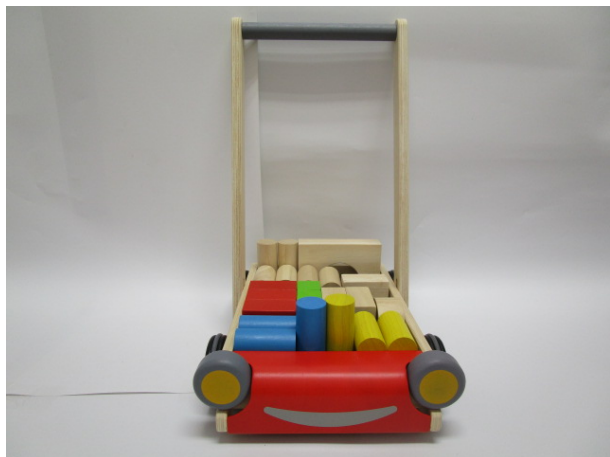

REMARK:

As per customer request, results for chemical tests listed below were referenced from the corresponding reports, issued no more than 24 months prior to this report.

Item Description: 5123 Baby Walker

Components

EN 71-3:2019+A1:2021 – Migration of Certain Elements

Solid wood
Plywood
Hard board
Light green coating on wood
Blue coating on wood
Yellow coating on wood
Lacquer coating on wood
Red coating on wood
Gray coating on wood
Black coating on wood
White elastic
Gray rubber ring
Dark brown coating on wood
Yellow coating on wood
Black plastic

Report Number

Date of Issue

120070114	23 JUL 2020
120070114	23 JUL 2020
010121020088	24 FEB 2021
120070130	24 JUL 2020
120120131	30 DEC 2020
120070125	24 JUL 2020
120070120	23 JUL 2020
120070116	23 JUL 2020
120120082	18 DEC 2020
120070123	23 JUL 2020
120070128	24 JUL 2020
010121020062	24 FEB 2021
120070131	24 JUL 2020
010121020067	24 FEB 2021
010121020054	24 FEB 2021



TEST REPORT

Report No. 010121030095R1

Dated NOV 29, 2021

TEST RESULT(S):

EN 71-1:2014+A1:2018 – Physical and Mechanical Properties

Test Method : Reference to EN 71-1:2014+A1:2018.

Clause	Requirement	Result
4.1	Material cleanliness	M
4.2	Assembly	M
4.3	Flexible plastic sheeting	NA
4.4	Toy bags	NA
4.5	Glass	NA
4.6	Expanding materials	NA
4.7	Edges	NA
4.8	Points and metallic wires	NA
4.8 e)	Splinters	M
4.9	Protruding parts	NA
4.10	Parts moving against each other	NA
4.11	Mouth actuated toys and other toys intended to be put in the mouth	NA
4.12	Balloons	NA
4.13	Cord of toy kites and other flying toys	NA
4.14	Toys which a child can enter	NA
4.15	Toys intended to bear the mass of a child	NA
4.16	Heavy immobile toys	NA
4.17	Projectiles	NA
4.18	Aquatic toys and inflatable toys	NA
4.19	Percussion caps	NA
4.20	Acoustics	NA
4.21	Toys containing a non-electrical heat source	NA
4.22	Small balls	NA
4.23	Magnets	NA
4.24	Yo-yo balls	NA
4.25	Toys attached to food	NA
5	Toys intended for children under 36 months	M
6	Packaging	NA
7	Warning, instructions for use	M

Note:

M = Meet

NR = Not Requested

NM = Not Meet

NT = Not Tested

NA = Not Applicable

NP = Not Present

R = Refer to Comment Section

ISO 8124-8:2016 Age Determination Guidelines

Test Method : Reference to ISO 8124-8.

Claimed Age Grade	Recommended Age Grade
10M+	10M+



TEST REPORT

Report No. 010121030095R1

Dated NOV 29, 2021

TEST RESULT(S): (Continued)

EN 71-2:2020 - Flammability

Test Method : Reference to EN 71-2:2020.

Test Item(s)	Item / Component Description(s)
1	5123 Baby Walker

Subclause	Requirement	Result
4.1	General requirement	PASS
	Celluloid (cellulose nitrate)	NP

Note:

M = Meet

NM = Not Meet

NA = Not Applicable

R = Refer to Comment Section

NR = Not Requested

NT = Not Tested

NP = Not Present

DNI = Did Not Ignite

EN 71-3:2019+A1:2021 – Migration of Certain Elements

Test Method : Reference to EN 71-3:2019+A1:2021 Analysis by ICP-MS.

Test Item(s)	Item / Component Description(s)
1	Solid wood
2	Plywood
3	Hard board
4	Light green coating on wood
5	Blue coating on wood
6	Yellow coating on wood
7	Lacquer coating on wood
8	Red coating on wood
9	Gray coating on wood
10	Black coating on wood
11	White elastic
12	Gray rubber ring
13	Dark brown coating on wood
14	Yellow coating on wood
15	Black plastic

See Soluble Element and its corresponding Maximum Allowable Limit in Result Table	Category I	Pliable modelling materials or other solid materials intended to leave a trace appearing in the toy
	Category II	Liquid paints/inks and other similar materials appearing as such in the toy (e.g. bubble solution), and glue sticks
	Category III	Coatings, polymeric materials (e.g. plastics), paper, textiles, glass, ceramic, metallic, wood and other solid materials



TEST REPORT

Report No. 010121030095R1

Dated NOV 29, 2021

TEST RESULT(S): (Continued)

-	Unit	Req.	Result				
Test Item(s)	-	-	1	2	3	4	5
Category Type	-	III	III	III	III	III	III
Aluminium (Al)	mg/kg	28130	ND	ND	ND	33	1392
Antimony (Sb)	mg/kg	560	ND	ND	ND	ND	ND
Arsenic (As)	mg/kg	47	ND	ND	ND	ND	ND
Barium (Ba)	mg/kg	18750	ND	ND	ND	58	ND
Boron (B)	mg/kg	15000	ND	ND	ND	ND	ND
Cadmium (Cd)	mg/kg	17	ND	ND	ND	ND	ND
Chromium III (Cr III)	mg/kg	460	0.22	0.25	0.05	1.01	1.29
Chromium VI (Cr VI)	mg/kg	0.053	ND	ND	ND	ND	ND
Cobalt (Co)	mg/kg	130	ND	ND	ND	ND	ND
Copper (Cu)	mg/kg	7700	ND	ND	ND	ND	ND
Lead (Pb)	mg/kg	23	ND	ND	ND	ND	1.89
Manganese (Mn)	mg/kg	15000	26	32	96	ND	ND
Mercury (Hg)	mg/kg	94	ND	ND	ND	ND	ND
Nickel (Ni)	mg/kg	930	ND	ND	ND	ND	ND
Selenium (Se)	mg/kg	460	ND	ND	ND	ND	ND
Strontium (Sr)	mg/kg	56000	ND	ND	ND	11	ND
Tin (Sn)	mg/kg	180000	3.75	0.96	ND	ND	ND
Organic tin	mg/kg	12	ND	ND	ND	ND	ND
Zinc (Zn)	mg/kg	46000	10	15	ND	ND	ND
Conclusion	-	-	PASS	PASS	PASS	PASS	PASS

-	Unit	Req.	Result				
Test Item(s)	-	-	6	7	8	9	10
Category Type	-	III	III	III	III	III	III
Aluminium (Al)	mg/kg	28130	119	ND	11	ND	44
Antimony (Sb)	mg/kg	560	ND	ND	ND	ND	ND
Arsenic (As)	mg/kg	47	ND	ND	ND	ND	ND
Barium (Ba)	mg/kg	18750	22	ND	ND	ND	ND
Boron (B)	mg/kg	15000	ND	ND	ND	ND	10
Cadmium (Cd)	mg/kg	17	ND	ND	ND	ND	ND
Chromium III (Cr III)	mg/kg	460	0.75	0.11	0.55	0.04	1.00
Chromium VI (Cr VI)	mg/kg	0.053	ND	ND	ND	ND	ND
Cobalt (Co)	mg/kg	130	ND	ND	ND	ND	ND
Copper (Cu)	mg/kg	7700	ND	ND	ND	ND	ND
Lead (Pb)	mg/kg	23	ND	ND	ND	ND	ND
Manganese (Mn)	mg/kg	15000	22	ND	19	ND	11
Mercury (Hg)	mg/kg	94	ND	ND	ND	ND	ND
Nickel (Ni)	mg/kg	930	ND	ND	ND	ND	ND
Selenium (Se)	mg/kg	460	ND	ND	ND	ND	ND
Strontium (Sr)	mg/kg	56000	ND	ND	ND	ND	ND
Tin (Sn)	mg/kg	180000	ND	ND	ND	ND	ND
Organic tin	mg/kg	12	ND	ND	ND	ND	ND
Zinc (Zn)	mg/kg	46000	ND	ND	ND	473	ND
Conclusion	-	-	PASS	PASS	PASS	PASS	PASS



TEST REPORT

Report No. 010121030095R1

Dated NOV 29, 2021

TEST RESULT(S): (Continued)

-	Unit	Req.	Result				
Test Item(s)	-	-	11	12	13	14	15
Category Type	-	III	III	III	III	III	III
Aluminium (Al)	mg/kg	28130	ND	ND	25	193	ND
Antimony (Sb)	mg/kg	560	ND	ND	ND	ND	ND
Arsenic (As)	mg/kg	47	ND	ND	ND	ND	ND
Barium (Ba)	mg/kg	18750	ND	ND	ND	109	ND
Boron (B)	mg/kg	15000	ND	ND	ND	ND	ND
Cadmium (Cd)	mg/kg	17	ND	ND	ND	ND	ND
Chromium III (Cr III)	mg/kg	460	0.02	0.21	0.20	0.58	ND
Chromium VI (Cr VI)	mg/kg	0.053	ND	ND	ND	ND	ND
Cobalt (Co)	mg/kg	130	ND	ND	ND	ND	ND
Copper (Cu)	mg/kg	7700	ND	ND	ND	ND	ND
Lead (Pb)	mg/kg	23	ND	ND	1.50	ND	ND
Manganese (Mn)	mg/kg	15000	ND	ND	30	ND	ND
Mercury (Hg)	mg/kg	94	ND	ND	ND	ND	ND
Nickel (Ni)	mg/kg	930	ND	ND	ND	ND	ND
Selenium (Se)	mg/kg	460	ND	ND	ND	ND	ND
Strontium (Sr)	mg/kg	56000	ND	ND	ND	ND	ND
Tin (Sn)	mg/kg	180000	ND	ND	ND	3.29	ND
Organic tin	mg/kg	12	ND	ND	ND	ND	ND
Zinc (Zn)	mg/kg	46000	23	246	ND	ND	ND
Conclusion	-	-	PASS	PASS	PASS	PASS	PASS

Note:

- mg/kg = milligram per kilogram
- ND = Not Detected
- Reporting limit for Cr (III), Cr (VI) = 0.02 mg/kg, and for Tin and Organic Tin = 0.9 mg/kg
- Reporting limit for Pb = 1.0 mg/kg, for As, Cd = 0.5 mg/kg
- Reporting limit for Al, Sb, Ba B, Co, Hg, Cu, Mn, Ni, Se, Sr, Zn = 10.0 mg/kg
- Confirmation test of chromium (III) is not required in case of chromium does not exceed their requirements as specified in EN 71-3:2019.

END OF REPORT

This report sets forth our findings solely with respect to the test samples identified herein. The results in this report are not representative of the quality or characteristics of the lot/batch from which a test sample was taken or any similar or identical product unless specifically and expressly noted. The sample/s mentioned in this report is/are submitted/supplied/manufactured by the Client, GIC Testing & Inspection Services Pte. Ltd. therefore assumes no responsibility for the accuracy of information on the brand name, model/ style number, consignment or any information supplied. Unless otherwise stated in this report, no tests were conducted to determine long term effects of using the specific product. Any copying or replication of this report to or for any other person or entity, or use of our name or trademark, is permitted only with our prior written permission.