



3137TDRI-XX

OFFSET TESTABLE WASTE & OVERFLOW ROUGH-IN 17GA BRASS W/ SOLDER TEE

SPECIFICATIONS

Features a Spin On Tie Plate, Removable Test Plugs, a Solder Tee and a Corrugated Overflow Tube. Trim Kit sold separately.

CERTIFICATION(S)



*The "cSAUS Meets UPC & IPC Code" mark means the product conforms to the requirements of the NPC, UPC, IPC and IRC.

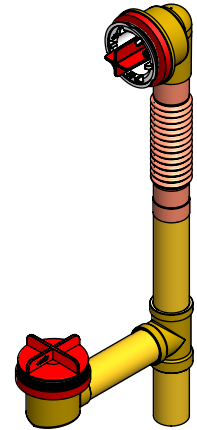
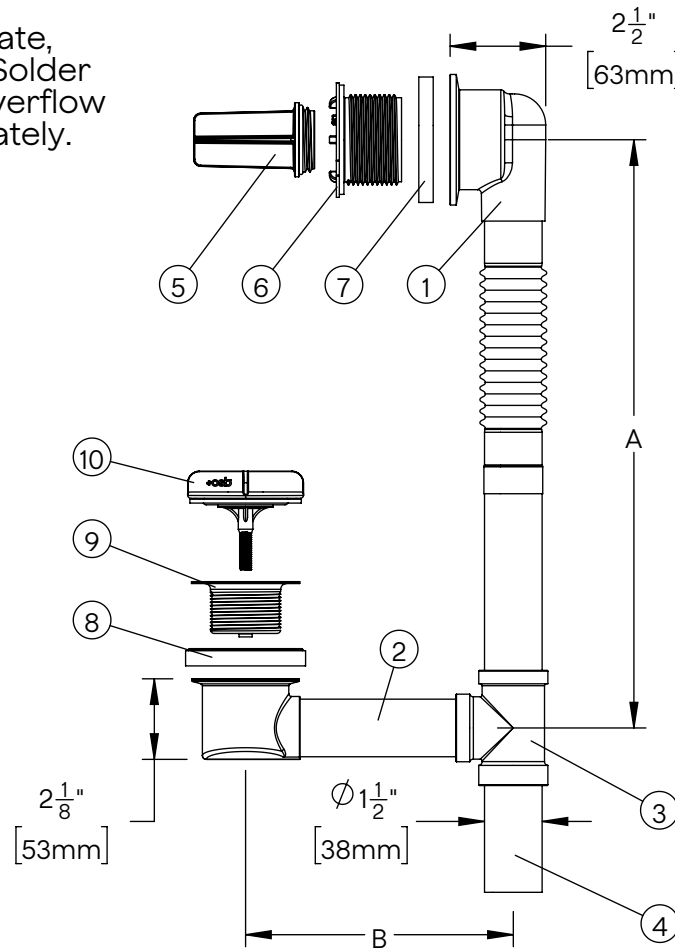

PRODUCT DIMENSIONS

XX	A	B
16 (STANDARD)	16" [406mm]	5" [127mm]
20 (EXTENDED)	20" [508mm]	7" [178mm]

ITEM NO.	PART NUMBER	DESCRIPTION	QTY.
1	340B2-17GA-(11, 18)C*	17GA BRASS WASTE ELBOW & TUBE - TESTABLE	1
2	316-L-17GA-(5, 7)**	BRASS WASTE ELBOW & TUBE	1
3	311-S	BRASS W/O TEE SWEAT	1
4	4835-3.5RB	1-1/2" 17GA T.O.E. TUBE	1
5	5642W-TP	TEST DRAIN CAP	1
6	5270WTIE	WABS PLASTIC TIE PLATE	1
7	425C	W/O GASKET 3/8"	1
8	425	WASTE & OVERFLOW GASKET	1
9	338SS-L	W/O COARSE THRD SS STRAINER	1
10	338TEST-5/16	TEST PLUG 5/16" - 18 UNC METAL POST	1

*11, Standard; 18, Extended

**5, Standard; 7, Extended

Oakville Stamping and Bending Ltd.

T. 905.827.0320 or toll free 1.877.314.6040 F. 905.827.6375 or toll free 1.877.827.6040.

All rights reserved. +osb™ reserves the right to change product specifications and material or discontinue models without notice.

www.osb.ca (Canada) www.osbplumbing.com (USA)

2025-06-16

