

SPECIFICATION

White PVC offset drain waste & overflow
with spin-on tie-plate and slide-on faceplate.
Features a Clicker® closure mechanism.

CERTIFICATION(S)



*The "cCSAus Meets UPC & IPC Code" mark means the product conforms to the requirements of the NPC, UPC, IPC and IRC.

FACEPLATES AVAILABLE

X =

0 - Bell

1 - Square

2 - Round

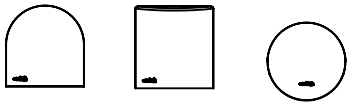

FINISHES AVAILABLE:

YY =

BCP - Chrome;

BMBL - Brass Matte Black;

BN - Brushed Nickel;

MBL - Matte Black;

POLN - Polished Nickel;

VB - Venetian Bronze;

W - White

Note: only overflow plate and Clicker® are finished

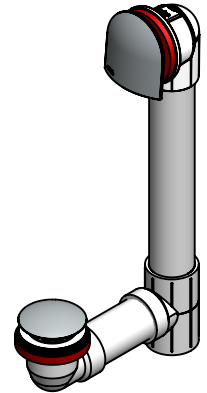
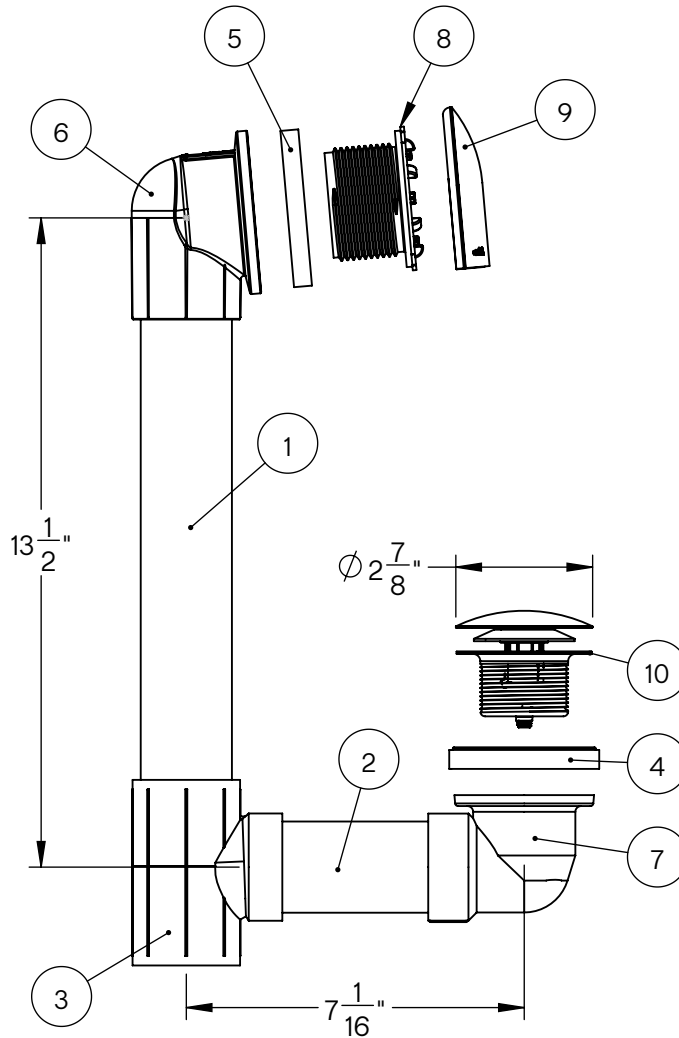

ITEM NO.	PART NUMBER	DESCRIPTION	QTY.
1	5342W-11	1-1/2" SCH. 40 WPVC PIPE 11"	1
2	5342W-4.5	1-1/2" SCH. 40 WPVC PIPE 4.5"	1
3	5311W	ABS SANITARY TEE 1-1/2"	1
4	425	WASTE & OVERFLOW GASKET	1
5	425C	W/O GASKET 3/8"	1
6	5642W	W PVC OVERFLOW ELBOW	1
7	5316-LW	LARGE WASTE ELBOW WPVC	1
8	5270WTIE	WABS PLASTIC TIE PLATE	1
9	3270	SLIDE-ON BELL CP FACEPLATE CSA	1
10	CIS	CLICKER IN STRAINER	1

Oakville Stamping and Bending Ltd.

T. 905.827.0320 or toll free 1.877.314.6040 F. 905.827.6375 or toll free 1.877.827.6040.

All rights reserved. +osb™ reserves the right to change product specifications and material or discontinue models without notice.

www.osb.ca (Canada) www.osbplumbing.com (USA)