

SPECIFICATION SUBMITTAL

TUBULAR P-TRAP LESS CLEANOUT

JOB: _____
 CONTRACTOR: _____
 ARCHITECT/ENGINEER: _____

DATE: _____
 QTY: _____
 PO#: _____
 TAG: _____

SPECIFICATION

P-trap less cleanout.
 Rough brass finish comes
 less flange.

CERTIFICATION



ASME A112.18.2/CSA-B125.2
 The "cCSAus" Meets UPC & IPC
 Code" mark means the product
 conforms to the requirements of
 the NPC, UPC, IPC, and IRC.



FINISHES AVAILABLE

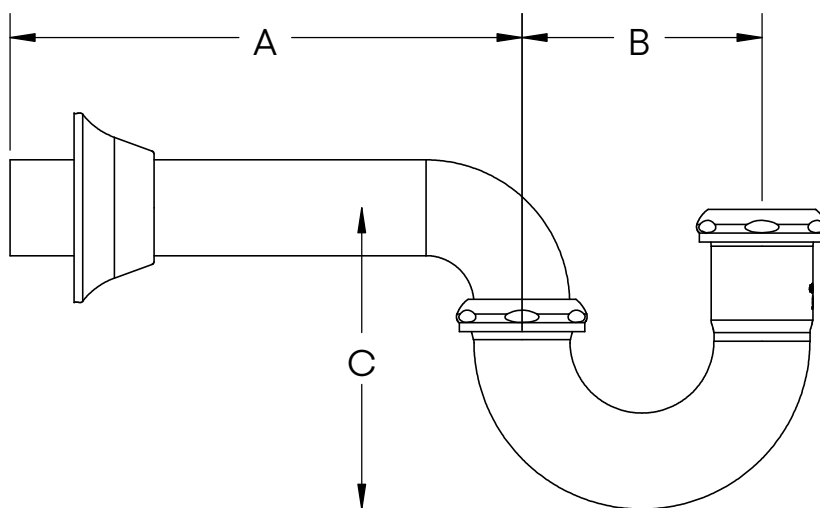
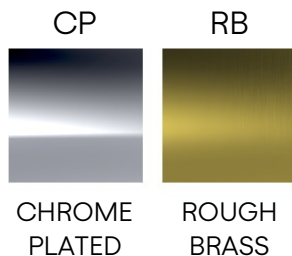

<u>X</u>	JOINT	FINISH	FLANGE	GAUGE	TUBE	A	B	C
2424	GROUND	CP	DEEP	20	1-1/4"	7" [178mm]	3-1/2" [89mm]	4-1/2" [114mm]
2524		RB	NONE		1-1/2"	7" [178mm]	3" [76mm]	4-1/4" [108mm]
2724		RB	NONE		1-1/2"	7" [178mm]	3" [76mm]	5-1/8" [130mm]

Oakville Stamping and Bending Ltd.

T. 905.827.0320 or toll free 1.877.314.6040 F. 905.827.6375 or toll free 1.877.827.6040

All rights reserved. +osbTM reserves the right to change product specifications and material or
 discontinue models without notice.

www.osb.ca (Canada) www.osbplumbing.com (USA)

November 05, 2025