

JOB: _____
CONTRACTOR: _____
ARCHITECT/ENGINEER: _____

DATE: _____
QTY: _____
PO#: _____
TAG: _____

SPECIFICATION

1-1/4" 20GA S-trap with cleanout, brass nuts, and shallow flange. Washer joint connection.

FINISHES AVAILABLE

CP



CHROME
PLATED

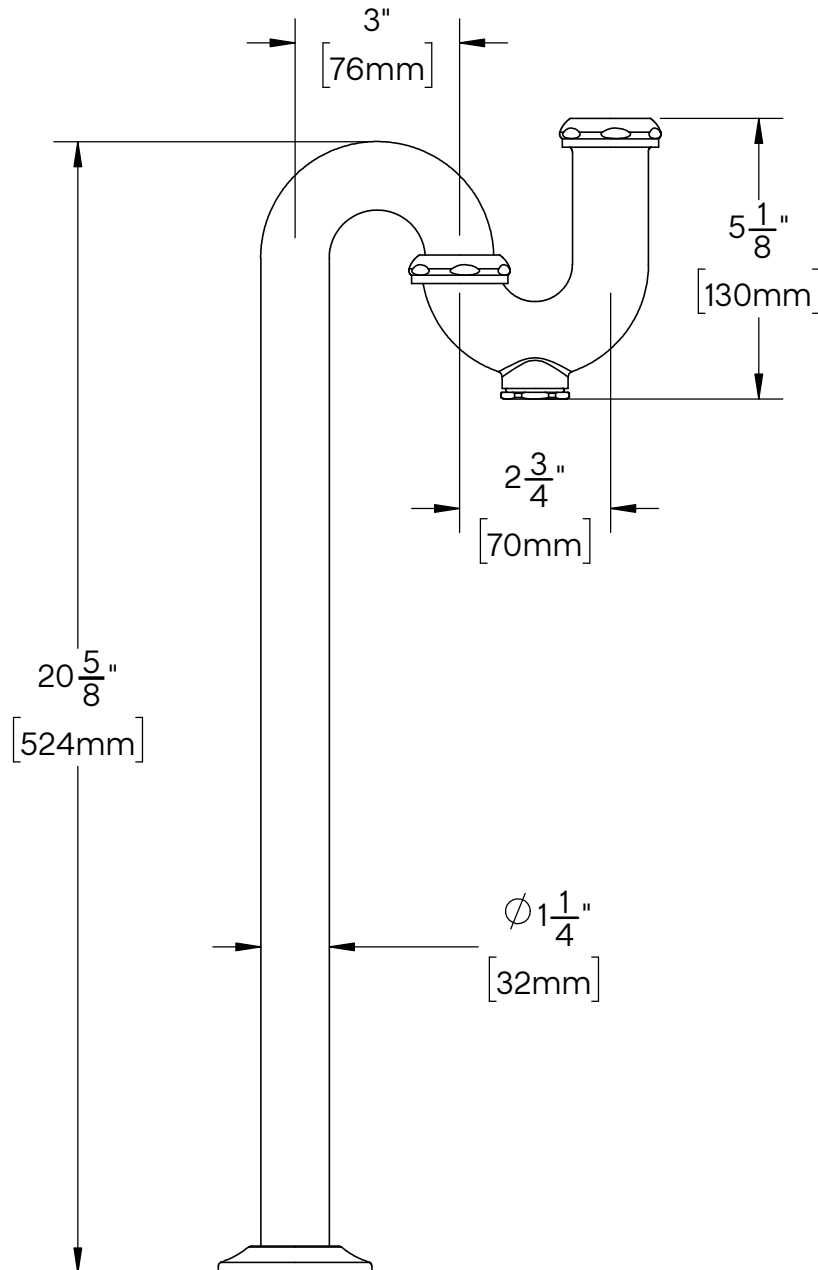

Oakville Stamping and Bending Ltd.

T. 905.827.0320 or toll free 1.877.314.6040 F. 905.827.6375 or toll free 1.877.827.6040

All rights reserved. +osb™ reserves the right to change product specifications and material or discontinue models without notice.

www.osb.ca (Canada) www.osbplumbing.com (USA)

11/17/25