



# 3600WCQ-BCP

17GA 1-1/4" OFFSET LAV DRAIN

Project: \_\_\_\_\_

Contractor: \_\_\_\_\_

SCHEDULE #

## Description:

OFFSET LAVATORY DRAIN SHALL BE SUPPLIED WITH BRASS CLICKER® DRAIN PLUG, BRASS CHROME FINISH TRIM, CAST BRASS, 17 GAUGE 1-1/4" X 8-3/8" BRASS TAILPIECE, LOCKNUT AND HEAVY RUBBER GASKET

Certification

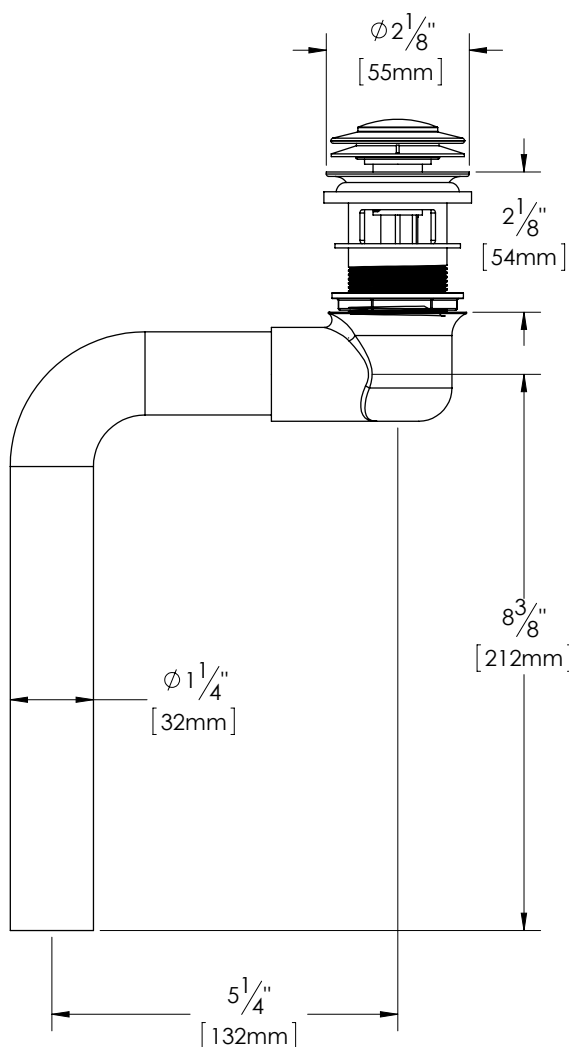

**Oakville Stamping and Bending Ltd.**

2200 Speers Road, Oakville, ON, Canada. L6L 2X8.

T. 905.827.0320 or toll free 1.877.314.6040 F. 905.827.6375 or toll free 1.877.827.6040.

All rights reserved. OS&B™ reserves the right to change product specifications and material or discontinue models without notice.

[www.osb.ca](http://www.osb.ca)

[www.osbplumbing.com](http://www.osbplumbing.com)