

Ceiling LED Chandelier

CH24755
INSTALLATION SHEET

START FROM HERE

- Make sure **POWER** is **COMPLETELY OFF** at the fuse box
- Have your fixture installed by a qualified licensed electrician
- Prepare everything in a clear area
- Wear gloves at all times during this installation
- Read instructions carefully before you start assembly
- Keep this installation sheet for future reference

Technical Support: 1-855-855-8926

Please Note:

- This Kuzco LED fixture comes with pre-wired LED module(s)
- Unless instructed, Do Not touch any part of the LED module(s) as any unnecessary contact with the module could cause permanent damage
- For dimming, an ELV (Electronic Low Voltage) or TRIAC type of dimmer is required
- 120V input

1. Remove fixture from its original package
2. Separate mounting plate (1c) from canopy (2a) by removing canopy screws (2b)
3. Attach mounting plate (1c) to electrical junction box (1a) using junction box screws provided (1e) in hardware package
4. Pull wires through fixture and rods and connect quick connectors (6a) together (See Illustration 1). Attach center rod (2d) to fixture (2e) by threading clockwise and put wires inside center rod (2d) (See Illustration 2). Next, bring down top fixture rod (2f) and attach it to center rod (2d). Turn top rod (2f) until fixture and center rod assembly is secure (See Illustration 3)
5. To change fixture height, shorten or lengthen wire by removing screw (2c) from canopy (2a) and push or pull wire to your desired length. Secure screw (2c) in canopy (2a) to lock wire in place. Next, push and hold wire gripper (2g), slide wire to desired length and then release wire gripper (2g) to secure
6. Pull wire through aircraft barrel (5b) and stopper (5d). Secure barrel mount (5f), followed by aircraft barrel (5b) to mounting surface with anchor (5c) and screw (5a). Adjust wire to desired length and secure with set screw (5e). Insert wire gripper (2g) into aircraft barrel (5b) to close
7. Make proper electrical connections (black to hot "L", white to neutral "N", ground to "GND") with wire nuts (1b) provided in hardware package and place driver (4a) inside canopy (2a)
8. Attach canopy (2a) to mounting plate (1c) with canopy screws (2b)

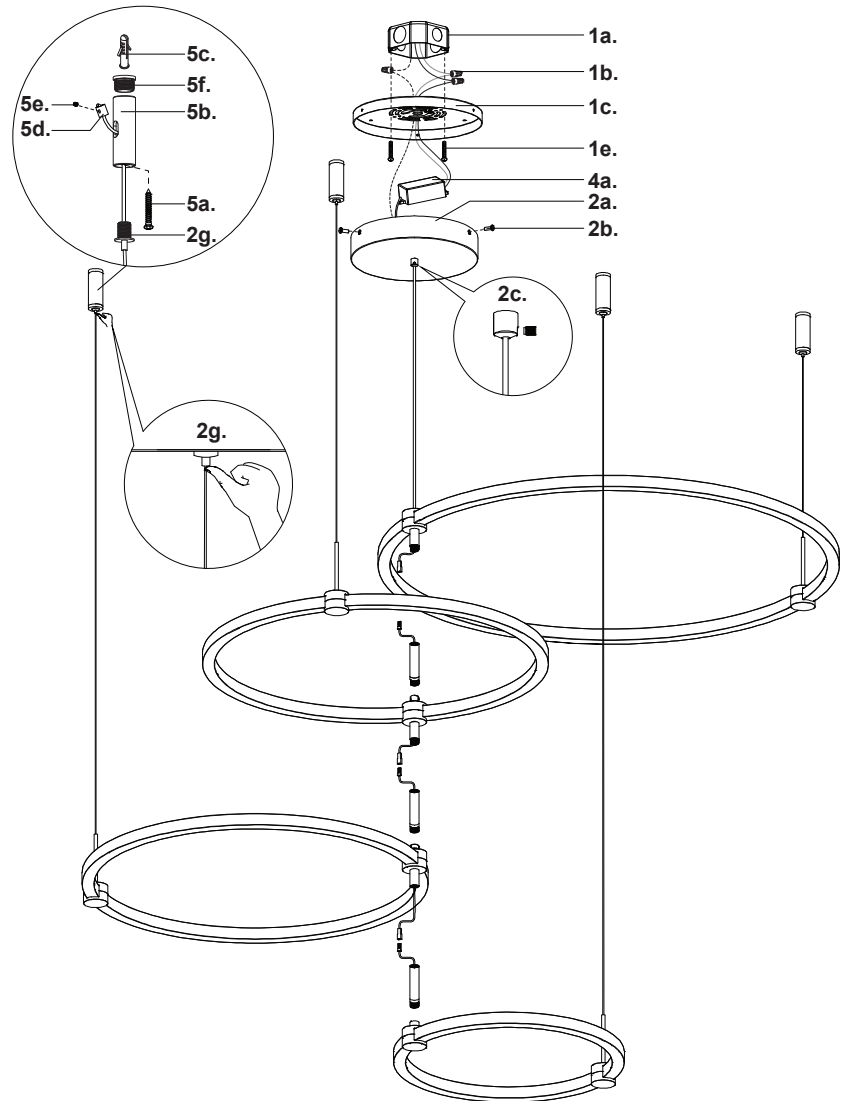

Illustration 1

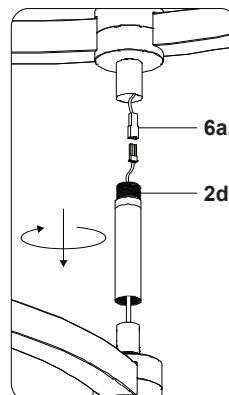

Illustration 2

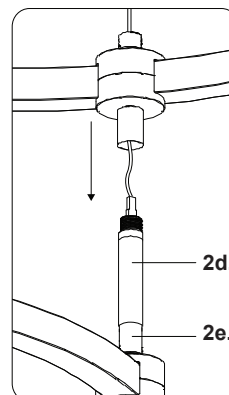
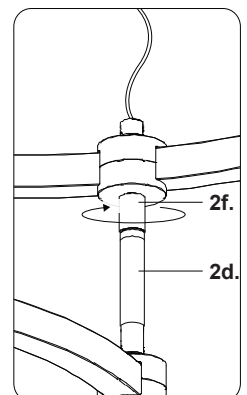

Illustration 3



KUZCO

19054 28th Avenue Surrey, BC Canada V3Z 6M3
T: 604 538 7162 TF: 1-855 85 KUZCO F: 604 538 7196
W: kuzcolighting.com
20241107