

LED Linear Pendant

LP38148

INSTALLATION SHEET

START FROM HERE

- Make sure **POWER** is **COMPLETELY OFF** at the fuse box
- Have your fixture installed by a qualified licensed electrician
- Prepare everything in a clear area
- Wear gloves at all time during this installation
- Read instructions carefully before you start assembly
- Keep this installation sheet for future reference

Technical Support: 1-855-855-8926

Please Note:

- This Kuzco LED fixture comes with pre-wired LED module(s)
- Unless instructed, Do Not touch any part of the LED module(s) as any unnecessary contact with the module could cause permanent damage
- Use ELV (Electronic Low Voltage) or TRIAC type of dimmer for dimming application
- 120-277V input

1. Remove fixture from its original package
2. Separate mounting plate (1c) from canopy (2a) by removing canopy screws (2b)
3. Attach mounting plate (1c) to electrical junction box (1a) using junction box screws provided (1e) in hardware package
4. Secure mounting plate (1c) to mounting surface with anchors (1f) and screws (1g)
5. Connect all rods together (2d) by threading clockwise up to the canopy (2a). Make sure to run the wires (LED+ and LED-) through the rods up to the canopy.
6. Make proper electrical connections between LED and CCT switch, V+, CW (cold white), WW (warm white), using connectors provided (See **Illustration 1** and refer to diagram on driver).
7. Make proper electrical connections (black to hot "L", white to neutral "N", ground to "GND") with wire nuts (1b) provided in hardware package and place driver (4a) and CCT switch (5a) in canopy (2a).
8. Secure shades (3b) to fixture (3a) by threading clockwise
9. Choose color temperature by using slider (5a)
10. Attach canopy (2a) to mounting plate (1c) with canopy screws (2b)

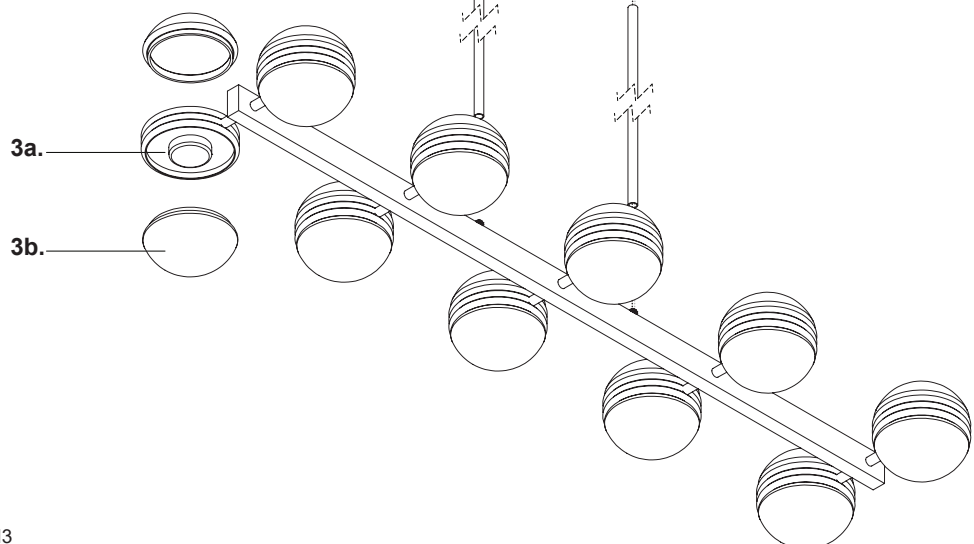
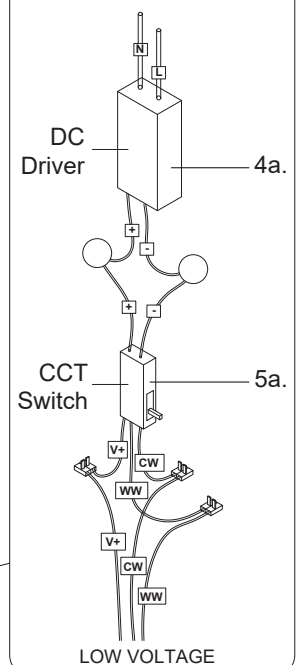

Illustration 1



KUZCO

19054 28th Avenue Surrey, BC Canada V3Z 6M3
 T: 604 538 7162 TF: 1-855 85 KUZCO F: 604 538 7196
 W: kuzcolighting.com
 20260107