

LED Pendant

PD70610-UNV

INSTALLATION SHEET

START FROM HERE

- Make sure **POWER** is **COMPLETELY OFF** at the fuse box
- Have your fixture installed by a qualified licensed electrician
- Prepare everything in a clear area
- Wear gloves at all time during this installation
- Read instructions carefully before you start assembly
- Keep this installation sheet for future reference

Technical Support: 1-855-855-8926

Please Note:

- This Kuzco LED fixture comes with pre-wired LED module(s).
- Unless instructed to do so, please do not touch any part of the LED module(s) as any unnecessary contact with the module could cause permanent damage.
- For dimming, an ELV (Electronic Low Voltage) or TRIAC type of dimmer is required.
- 120-277V input

1. Remove fixture from its original package
2. Remove the mounting plate (1b) from within the canopy (2a) by unthreading the decorative nuts (2b)
3. Secure the mounting plate (1b) to the junction box (1a) with screws (1c) provided in the hardware package
4. Connect the diffuser (3h) to the LED engine (3f) by using the three set screws and Allen key (3g) provided
5. Run the wires (2e) through the cover washer (3d), washer (3c), gasket (3b), glass shade (3a) and let the shade (3a) rest on diffuser (3h). Place the top cap (2f), followed by the connector (2d) to the LED connector (3e) by threading clockwise. Run wires (2e) through all the components
6. Connect all rods together (2c) by threading clockwise into the LED connector (3e) up to the canopy (2a). Make sure to run the wires (2e) through the rods up to the canopy
7. Connect the DC driver wires to the LED engine wires and by matching black driver to the black LED wire, red driver to red LED wire. Make proper electrical connections (black to hot "L", white to neutral "N", ground to "GND" with wire nuts (1d) provided in hardware package (Illustration 1)
8. Align and insert mounting plate screws (1e) through holes on canopy (2a), secure with decorative nuts (2b)

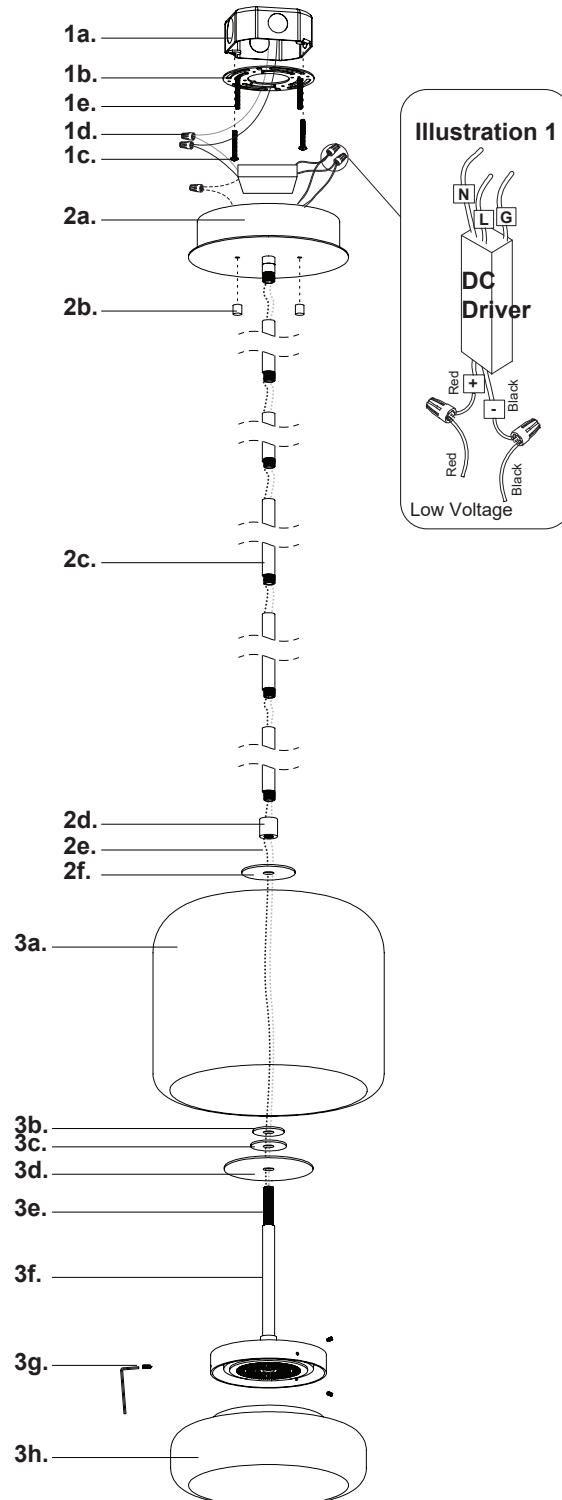

KUZCO

19054 28th Avenue Surrey, BC Canada V3Z 6M3
T: 604 538 7162 TF: 1-855 85 KUZCO F: 604 538 7196
W: kuzcolighting.com
20240807