

LED Wall Sconce

WS90102-UNV

INSTALLATION SHEET

START FROM HERE

- Make sure **POWER** is **COMPLETELY OFF** at the fuse box
- Have your fixture installed by a qualified licensed electrician
- Prepare everything in a clear area
- Wear gloves at all time during this installation
- Read instructions carefully before you start assembly
- Keep this installation sheet for future reference

Technical Support: 1-855-855-8926

Please Note:

- This Kuzco LED fixture comes with pre-wired LED module(s)
- Unless instructed, Do Not touch any part of the LED module(s) as any unnecessary contact with the module could cause permanent damage
- Use ELV (Electronic Low Voltage) or TRIAC type of dimmer for dimming application
- 120-277V input

1. Remove fixture from its original package
2. Separate mounting plate (1c) from canopy (2a), and non-power mounting plate (4a) from non-power canopy (4b) by removing canopy screws (2b)
3. Attach mounting plate (1c) to electrical junction box (1a) using screws provided (1e) in hardware package
4. Connect quick connectors (2c) together
5. Use the mounting guide plate provided in box to measure and drill holes for the non-power canopy (4b)
6. Secure fixture rods (2d) together with set screws (2f) and allen key
7. Make proper electrical connections (**black to hot "L"**, **white to neutral "N"**, **ground to "GND"**) with wire nuts (1b) provided in hardware package and place driver (5a) inside canopy (2a)
8. Measure, mark location of non-power mounting plate (4a) location, mount to wall with screws (1g) (See **Illustration 1** for ideal distance measurement)
9. Position canopy (2a) and non-power canopy (4b) over respective mounting plate, fine tune location of non-power mounting plate (4a), and then tighten screw (1g)
10. Secure canopy (2a) to mounting plate (1c), non-power canopy (4b) to non-power mounting plate (4a) with canopy screws (2b)
11. Tilt heads (5b) to desired position

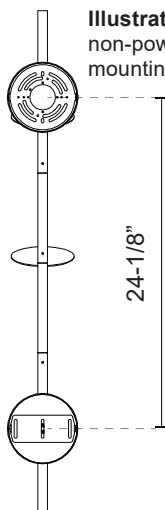
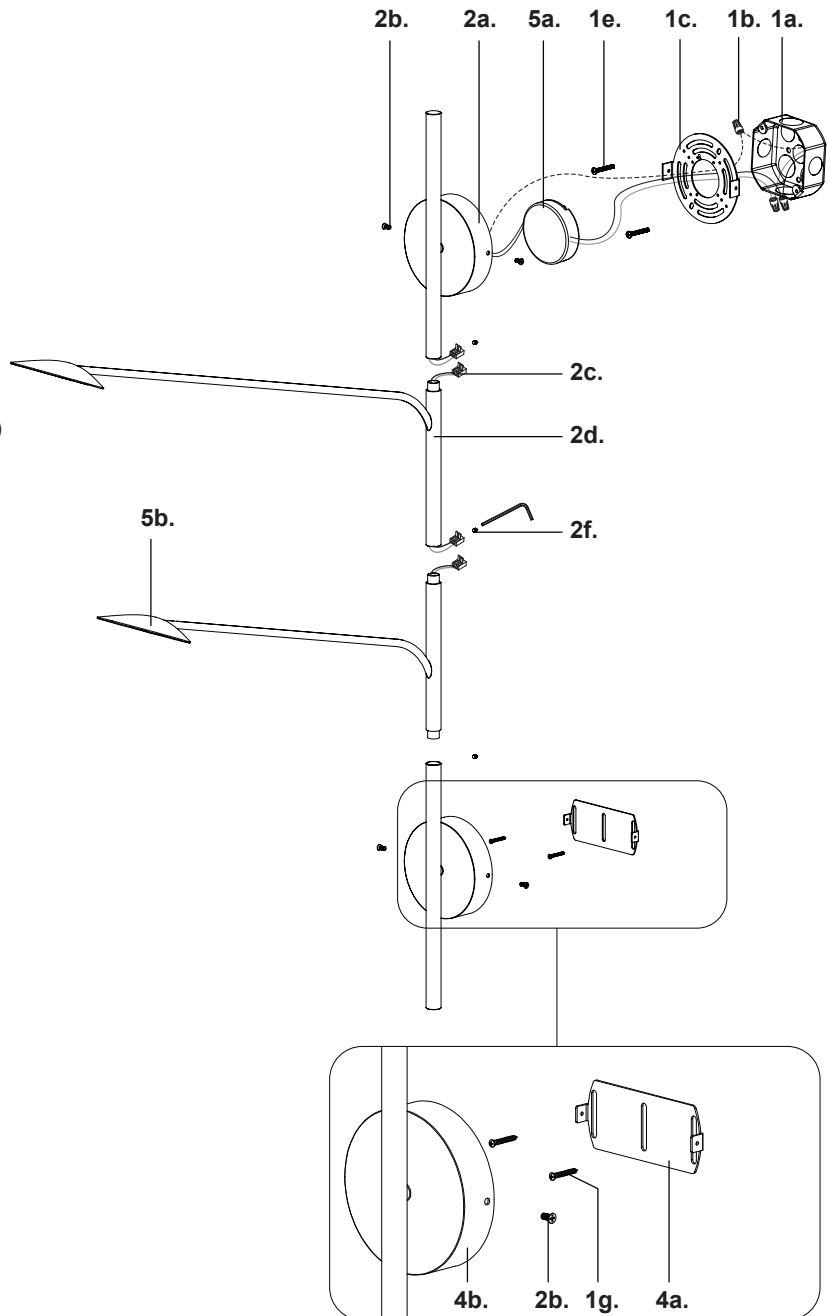

Illustration 1: Ideal distance of center of non-power mounting plate to center of mounting plate is 24-1/8".



KUZCO

19054 28th Avenue Surrey, BC Canada V3Z 6M3
T: 604 538 7162 TF: 1-855 85 KUZCO F: 604 538 7196
W: kuzcolighting.com
20240724