

BULBRITE® LED

SECURITY LIGHT WITH SENSOR

2 HEADS- 120W REPLACEMENT

Item# 773702

Ordering Code: LED24SEC/2RHWH/MO/40K

Item# 773703

Ordering Code: LED24SEC/2RHBL/MO/40K

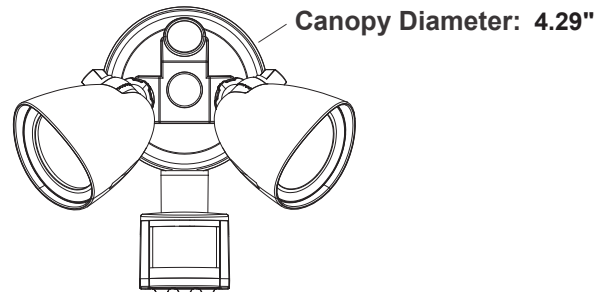

Before installation, confirm all parts are in good condition. If any parts are damaged, do not attempt to install. Contact an American Lighting Association (ALA) Certified Relationship Specialist at Bulbrite for help with installation or questions about your kit at 800-528-5555 or info@bulbrite.com.

These instructions are provided for your safety. It is important that the instructions are read carefully and completely before assembling. Please save these instructions, as you may need them at a later date.

WARNING: RISK OF FIRE OR ELECTRIC SHOCK. TO AVOID ELECTRICAL SHOCK DO NOT DISASSEMBLE PRODUCT AS THERE ARE NO SERVICEABLE PARTS INSIDE. LED SECURITY LIGHT INSTALLATION REQUIRES KNOWLEDGE OF LUMINAIRE ELECTRICAL SYSTEMS. IF NOT QUALIFIED, DO NOT ATTEMPT INSTALLATION. CONTACT A QUALIFIED ELECTRICIAN. BE SURE THE ELECTRICITY TO THE FIXTURE YOU ARE WORKING ON IS SHUT OFF BEFORE INSTALLING OR SERVICING: EITHER THE FUSE IS REMOVED OR THE CIRCUIT BREAKER IS TURNED OFF. TO PREVENT WIRING DAMAGE OR ABRASION, DO NOT EXPOSE WIRING TO THE EDGE OF SHEET METAL OR OTHER SHARP OBJECTS. DO NOT MAKE OR ALTER ANY OPEN HOLES IN AN ENCLOSURE OF WIRING OF ELECTRICAL COMPONENTS DURING INSTALLATION. THIS LED SECURITY LIGHT MUST BE INSTALLED IN ACCORDANCE WITH THE NATIONAL ELECTRICAL CODE (NEC) AND RELEVANT LOCAL CODE. SUITABLE FOR WET LOCATIONS THIS DEVICE IS NOT INTENDED FOR USE WITH EMERGENCY EXITS. TO PREVENT EARLY LAMP FAILURE, LAMP SHOULD ONLY BE INSTALLED IN OPERATING ENVIRONMENTS RANGING BETWEEN -20°C and +40°C (-4°F and +104°F). THIS DEVICE COMPLIES WITH PART 15 OF THE FCC RULES. OPERATION IS SUBJECT TO THE FOLLOWING TWO CONDITIONS: (1) THIS DEVICE MAY NOT CAUSE HARMFUL INTERFERENCE, AND (2) THIS DEVICE MUST ACCEPT ANY INTERFERENCE RECEIVED, INCLUDING INTERFERENCE THAT MAY CAUSE UNDESIRABLE OPERATION.

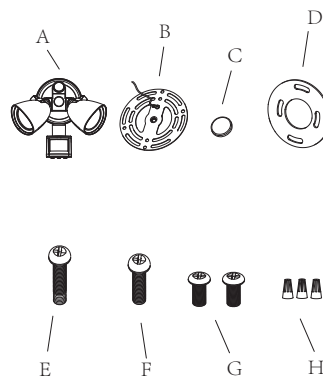

LED Security Light		
Fig.	Item Description	QTY
A	LED Security Light	1
B	Mounting plate	1
C	Rubber Plug	2
D	Gasket	1
E	Center Mounting Screw (M8*60)	1
F	Center Mounting Screw (M8*45)	1
G	Mounting Plate Screws	2
H	Wire Nuts	3

This LED Security Light mounts to a variety of standard ceiling or wall mounted junction boxes. Installer must ensure proper fit and mounting as jbox vary by site.



OCTAGON

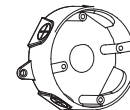

ROUND

OVERVIEW OF LED Security Light INSTALLATION

GENERAL INSTRUCTIONS:

- This fixture operates on line voltage (standard household power) of 120 Volts, 60 Hertz.
- Can be used in wet locations.
- Suitable for Type IC or NON-IC installations.
- Operation temperature ranging between -20°C to +40°C (-4°F to +113°F). Lamp life may be affected outside these temperatures.

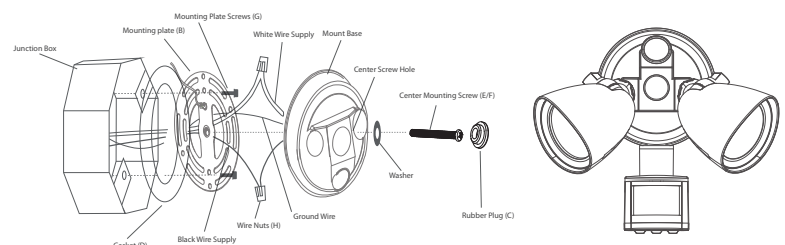

BULBRITE®LED

SECURITY LIGHT WITH SENSOR

2 HEADS- 120W REPLACEMENT

Item# 773702

Ordering Code: LED24SEC/2RHWH/MO/40K

Item# 773703

Ordering Code: LED24SEC/2RHBL/MO/40K

STEP 1: Ensure all electricity is turned off.



STEP 2: Align the Gasket (D) with the holes in the Mounting Plate (B) and attach the Mounting Plate (B) with Gasket (D) to the junction box (not included) using the two screws (G). Screws should pass through the holes in the Mounting Plate, then the Gasket, then threaded into the junction box.

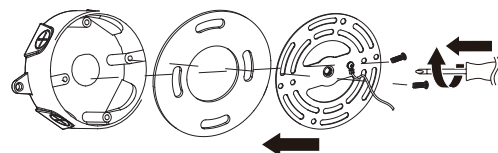

STEP 3: Connect the supply wires to the junction box using the provided wire nuts (black to black, white to white and green/ground to ground).

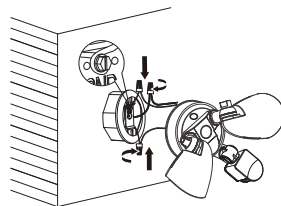

STEP 4: Attach the LED Security Light (A) to the Mounting Plate (B) using the Mounting Plate Screw (D).

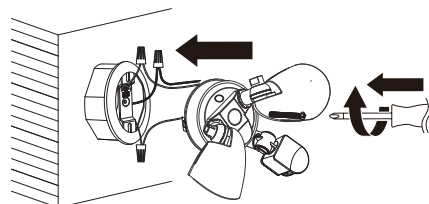

STEP 5: Cover the now secured center screw with the rubber plug. Insert the Rubber Plug (C) into the Center Screw Hole to conceal the Mounting Plate Screw (D).

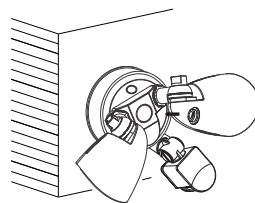

STEP 6: Seal the gap between the LED Security Light and the structure using outdoor sealant. Refer to local building codes to determine the proper sealant as building codes vary by location.

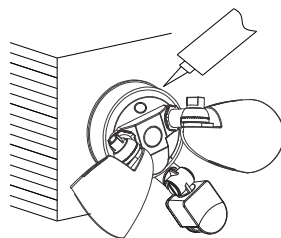



SECURITY LIGHT WITH SENSOR

2 HEADS- 120W REPLACEMENT

Item# 773702

Ordering Code: LED24SEC/2RHWH/MO/40K

Item# 773703

Ordering Code: LED24SEC/2RHBL/MO/40K

OPERATING INSTRUCTIONS:

LUX: The LUX dial may be adjusted to change the Dusk-to-Dawn settings of the installed photocell. When the LUX dial is fully counter-clockwise (LOW SETTING), the LED Security Light will operate only in dark conditions. The motion sensor will be active and will come on when motion is sensed. As the LUX dial is rotated clockwise, the LED Security Light will operate under higher ambient lighting conditions, up to 24 hours (fully clockwise – HIGH SETTING). The motion sensor will be active in increasingly brighter conditions, and will come on when motion is sensed.

TIME: The TIME dial may be adjusted to change the length of time the light will come on when the motion sensor is triggered. When the TIME dial is fully counter-clockwise (LOW SETTING), the light will turn on and stay on for approximately 5 seconds when motion is detected. As the TIME dial is rotated clockwise, the duration of time the light stays on will increase, up to approximately 6 minutes (fully clockwise – HIGH SETTING).

SENS: The SENS dial may be adjusted to change the alert distance for the motion sensing function. When the SENS dial is fully counter-clockwise (LOW SETTING), the motion sensing distance is limited to motion detected approximately 18 feet from the sensor. As the SENS dial is rotated clockwise, the motion sensing distance will increase, up to approximately 60 feet from the sensor (fully clockwise – HIGH SETTING).

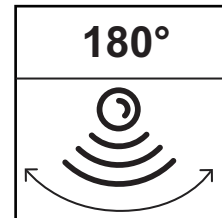
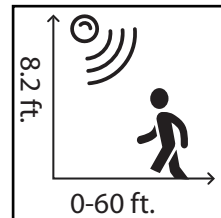
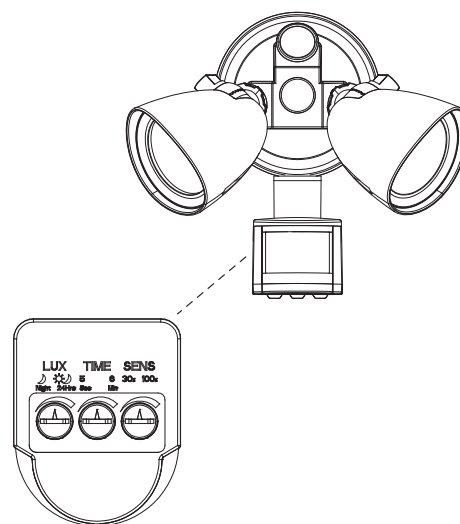

5-YEAR LIMITED WARRANTY

Bulbrite offers 5-year limited warranty on this item (based on an average household use of 3 hours per day according to federal estimation standards issued by the Department of Energy and Federal Trade Commission). If a covered product fails within the specified warranty period, please contact Bulbrite Industries, Inc., 840 Drop Off Drive Suite A Summerville, SC 29486, 800.528.5555, info@bulbrite.com. Bulbrite reserves the right to examine all failed lamps, components and/or ballasts and reserves the right to be the sole judge as to whether any lamps and/or Bulbrite lighting products are defective and covered under our warranty. Products are credited, repaired or replaced at Bulbrite's option and associated labor costs may not be covered. These warranties do not apply in the event of conditions demonstrating abnormal use or stress, improper storage, improper installation or extended daily use that is beyond reasonable operating hours for the intended application. Warranties are void if the product is not used for the intention which it was manufactured.

LIMITATION OF LIABILITY

THE FOREGOING WARRANTY CONSTITUTES BULBRITE'S EXCLUSIVE LIABILITY AND THE EXCLUSIVE REMEDY TO A CUSTOMER FOR ANY BREACH OF OR ANY OTHER NONCONFORMITY OF THE PRODUCTS COVERED BY THIS WARRANTY. THIS WARRANTY IS EXCLUSIVE AND IN LIEU OF ALL OTHER WARRANTIES. BULBRITE MAKES NO WARRANTY, EXPRESSED OR IMPLIED OR STATUTORY, INCLUDING, WITHOUT LIMITATION, ANY WARRANTY OF MERCHANTABILITY OR FITNESS FOR A PARTICULAR PURPOSE. NO REPRESENTATIVE, EMPLOYEE, DISTRIBUTOR OR DEALER OF BULBRITE HAS THE AUTHORITY TO MAKE OR IMPLY ANY WARRANTY, REPRESENTATION, PROMISE OR AGREEMENT, WHICH IN ANY WAY VARIES THE TERMS OF THE WARRANTY SET FORTH ABOVE. THE BULBRITE PRODUCTS SOLD TO CUSTOMERS ARE INTENDED TO BE USED ONLY IN THE APPLICATION(S) SPECIFIED BY BULBRITE. ANY OTHER USE RENDERS THE WARRANTY EXPRESSED HEREIN, AND ALL IMPLIED WARRANTIES NULL AND VOID AND SAME ARE HEREBY EXCLUDED. UNDER NO CIRCUMSTANCES SHALL BULBRITE BE LIABLE TO CUSTOMER OR ANY THIRD PARTY FOR CONSEQUENTIAL, INCIDENTAL, INDIRECT, EXEMPLARY, SPECIAL OR OTHER DAMAGES WHETHER IN AN ACTION BASED ON CONTRACT, TORT (INCLUDING NEGLIGENCE) OR ANY OTHER LEGAL THEORY, ARISING OUT OF OR RELATED TO THE PRODUCTS SOLD TO CUSTOMER, INCLUDING BUT NOT LIMITED TO LOST PROFITS OR LOSS OF BUSINESS, EVEN IF BULBRITE IS APPRISED OF THE LIKELIHOOD OF SUCH DAMAGES OCCURRING.