

Recommended P.C.B Layout  
General Tolerance±0.05

NOTES:

1. HOUSING:  
MATERIAL: -SEE PART NO. SCHEME,UL94V0,HALOGEN FREE.  
COLOUR: -SEE PART NO. SCHEME.
2. CONTACT:  
MATERIAL: COPPER ALLOY.  
PLATING: 50u" SEMI BRIGHT Ni OVERALL UNDER PLATED.  
OPTIONAL PLATING ON CONTACT AREA.
3. MATE WITH AMPHENOL HOUSING 10147577
4. PRODUCT SPECIFICATION: GS-12-1533.
5. PACKAGE SPECIFICATION: GS-14-2661.
6. APPLICATION SPECIFICATION: GS-20-0401
7. THE HOUSING WILL WITHSTAND EXPOSURE TO 260°C PEAK TEMPERATURE FOR 10 SECONDS IN A REFLOW OVEN.
8. THIS LF PRODUCT MEETS EUROPEAN UNION DIRECTIVES AND OTHER COUNTRY REGULATIONS AS DESCRIBED IN GS-47-0004.
9. NOT YET TOOLEDUP
10. DIMENSION TABLE

PART NUMBER SCHEME:  
10147579 - XX X X X X X LF

POS. CODE: \_\_\_\_\_ LEAD FREE  
 06: 6 POS. \_\_\_\_\_ HSG MATERIAL: 2:LCP UL94V-0  
 08: 8 POS. \_\_\_\_\_  
 S1: 8 POS (CUSTOMER SPECIAL) \_\_\_\_\_ TAIL LENGTH:  
 S2: 6 POS (CUSTOMER SPECIAL) \_\_\_\_\_ 1: 3.4mm  
 COLOR: \_\_\_\_\_ 2: 2.8mm  
 1: NATURAL \_\_\_\_\_ 3: 1.27mm  
 2: BLACK \_\_\_\_\_ 4: 1.20mm (ONLY FOR S1)  
 PIN MATERIAL: \_\_\_\_\_ PLATING:  
 1: BRASS \_\_\_\_\_ 1: MATTE TIN

mat'l. code		surface ISO 1302 ✓		tolerance ISO 406 ISO 1101		projection 1101		product family MINITEK PWR 4.2	
ltr ecn no dr date		tolerances unless otherwise specified		angles linear		mm		title DUAL ROW VERTICAL HEADER PCIe ATX	
A	-	TONY	2018-11-05	0°±x'	.0±.30	scale 1:1		dwg no sheet 1 of 3 size	
B	ELX-I-47601	SONY	2022-12-12		.00±.20	Amphenol FCI		10147579 A3	
				dr	.000±.10			type Product Customer Drawing	
				engr					
				chr					
				appd					
sheet index	revision sheet	B 1	B 2	B 3	B 4				

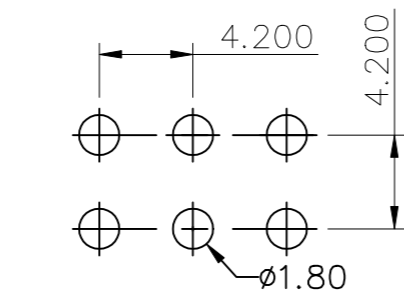
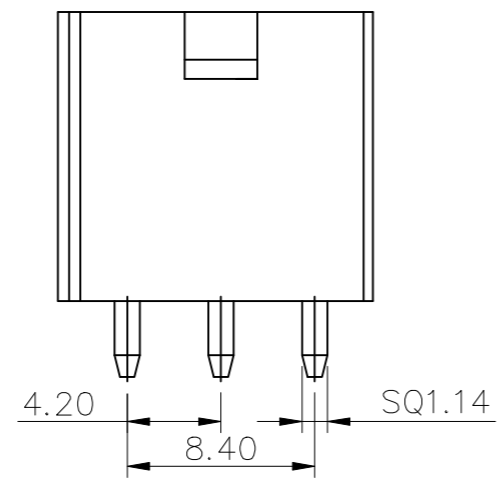
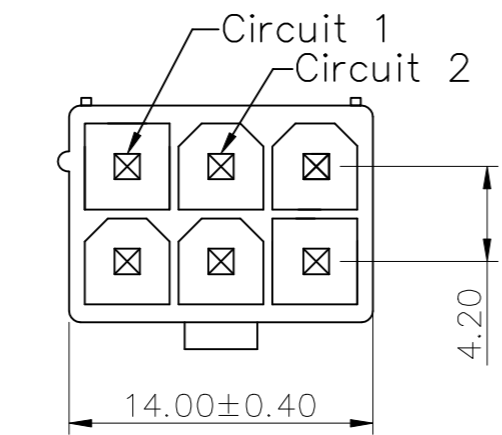

Recommended P.C.B. Layout  
General Tolerance ±0.05

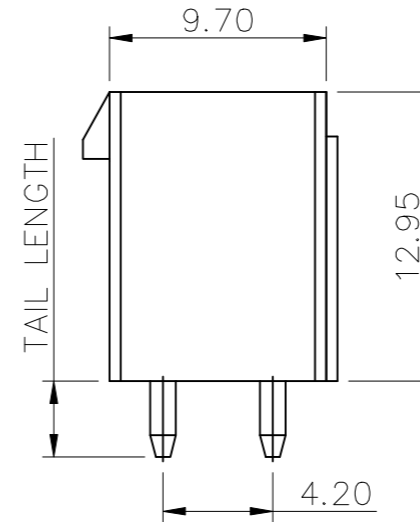
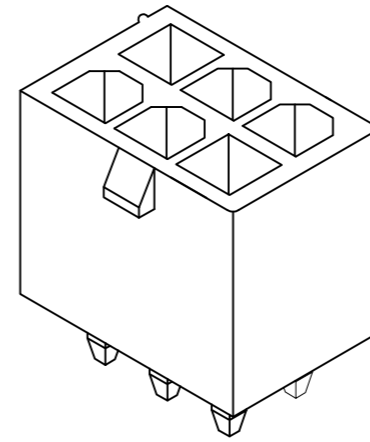

mat'l. code		surface		tolerance		projection		product family	
		ISO 1302		ISO 406		ISO 1101		MINITEK PWR 4.2	
ltr		ecn no		dr		date		title	
								DUAL ROW VERTICAL HEADER PCIe ATX	
				angles		linear		mm	
				0°±x'		.0±.30		scale 1:1	
						.00±.20		dwg no	
						.000±.10		sheet 2 of 3	
				dr		TONY LENG		2018-11-05	
				engr		SONY		2022-12-12	
				chr		SONY		2022-12-12	
				appd		MITHUN		2022-12-12	
sheet		revision		B		B		B	
index		sheet		1		2		3	

PART NUMBER : 10147579-S121142LF

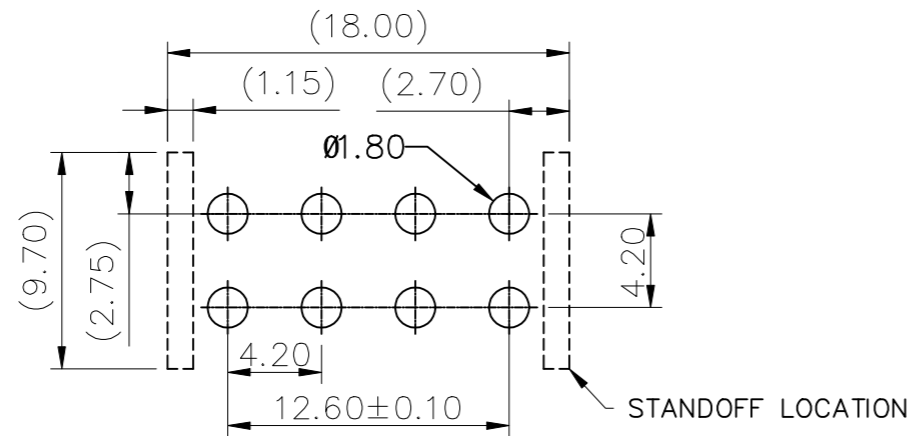
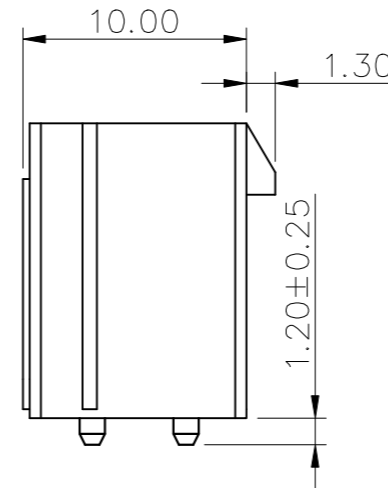
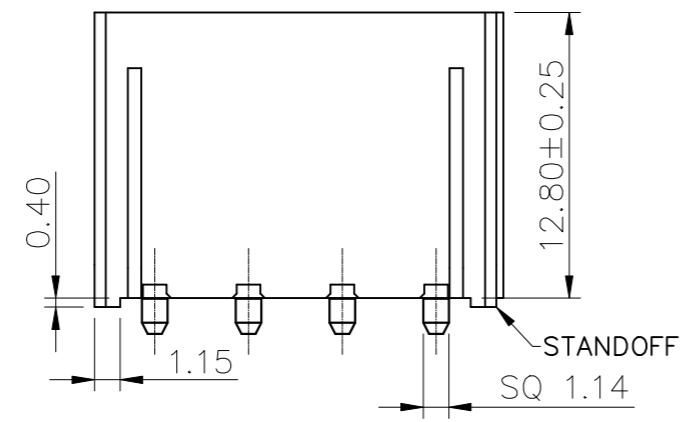
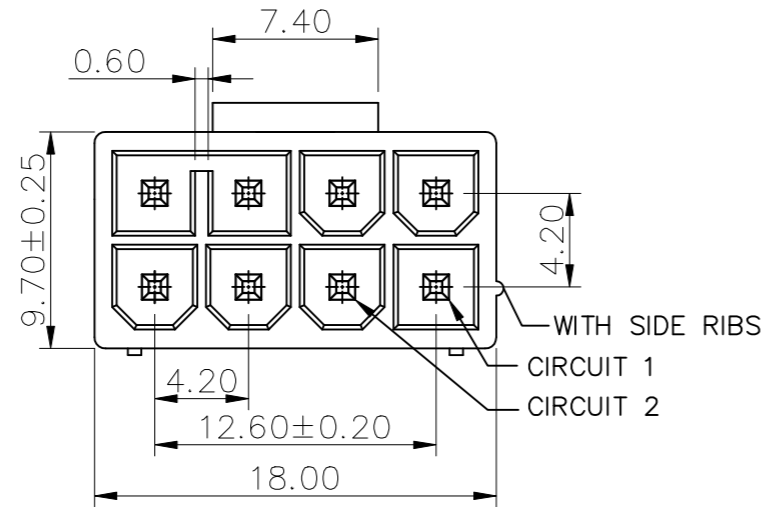

Recommended P.C.B Layout  
General Tolerance±0.05

mat'l. code		surface ISO 1302 ✓		tolerance ISO 406 ISO 1101		projection mm		product family MINITEK PWR 4.2	
ltr		ecn no		dr		date		title DUAL ROW VERTICAL HEADER PCIe ATX	
								dwg no 10147579	
								sheet 3 of 3 A3	
								type Product Customer Drawing	
sheet index		revision sheet		B 1		B 2		B 3	

PDS: Rev :B

STATUS:Released

Printed: Mar 08, 2023

PART NUMBER : 10147579-S221142LF

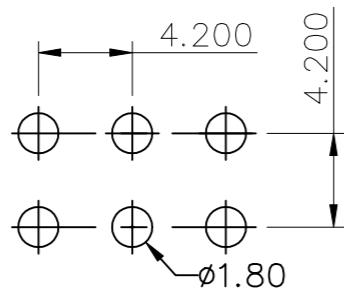
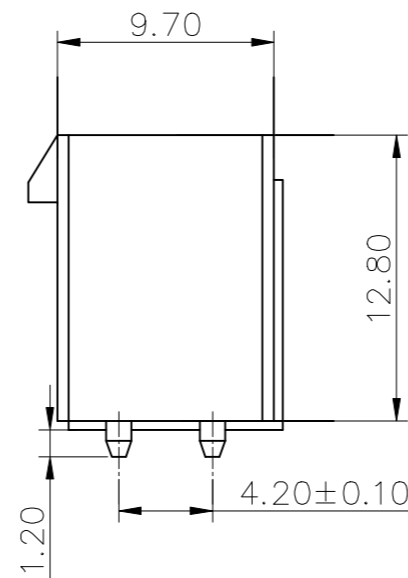
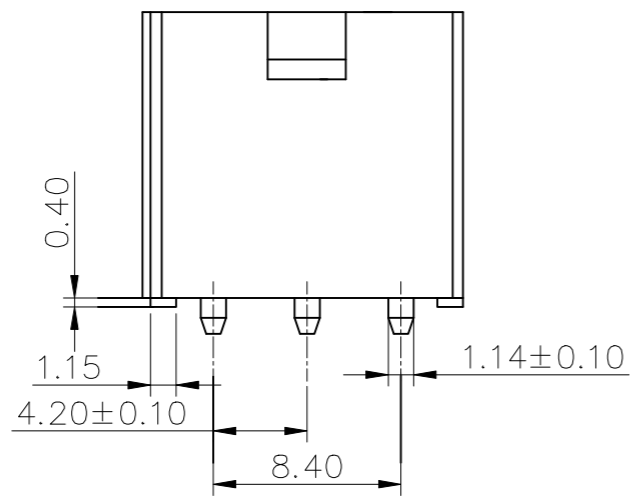
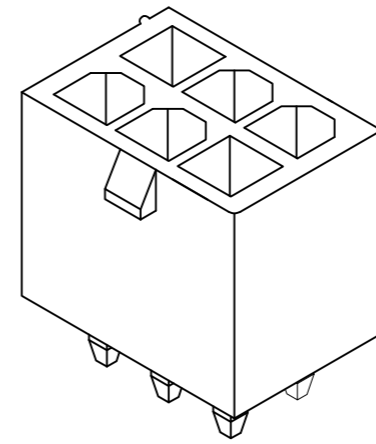
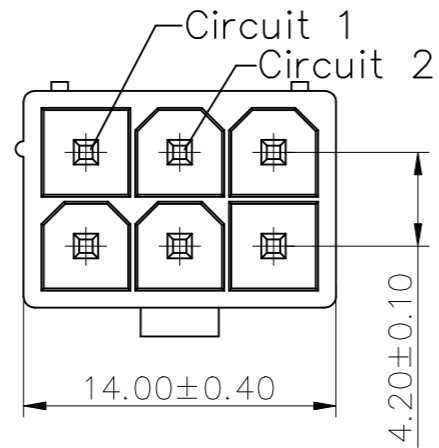

Recommended P.C.B Layout  
General Tolerance ±0.05

mat'l. code		surface		tolerance		projection		product family	
		ISO 1302		ISO 406 ISO 1101		mm		MINITEK PWR 4.2	
ltr		ecn no		dr		date		title	
								DUAL ROW VERTICAL HEADER PCIe ATX	
				angles		linear		dwg no	
				0°±x'		.0±.30 .00±.20 .000±.10		sheet 3 of 3	
				dr		TONY LENG 2018-11-05		size	
				enr		SONY 2022-12-12		A3	
				chr		SONY 2022-12-12		10147579	
				appd		MITHUN 2022-12-12		type Product Customer Drawing	
sheet index		revision sheet		B 1		B 2		B 3	

Amphenol  
FCi

© 2016 AFCI