

FIRST CIRCUIT

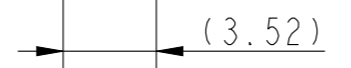
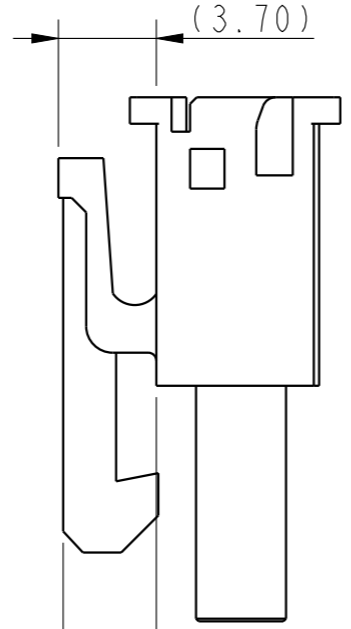
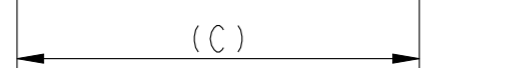
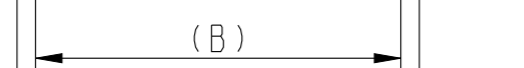
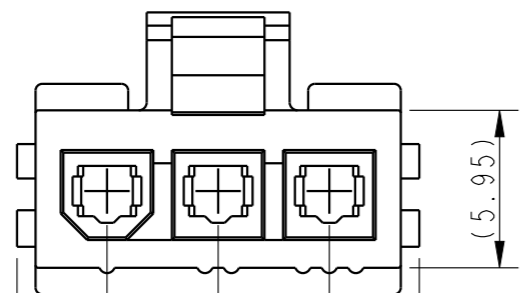
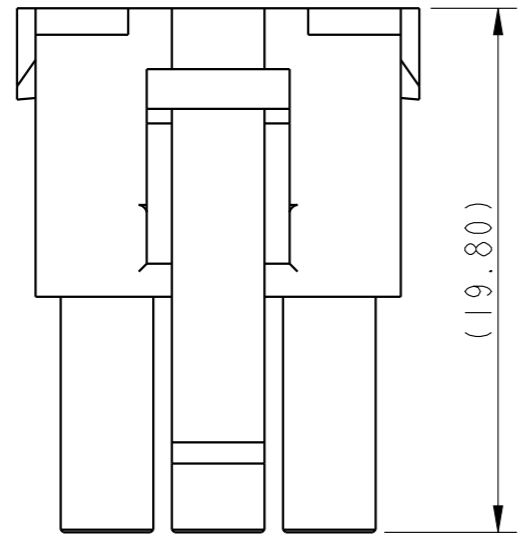
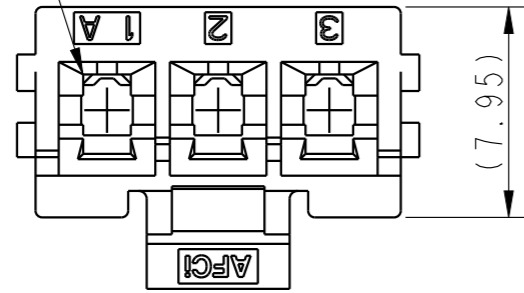

NOTE:

- 1) MATERIAL : NYLON66, UL94-V0, GLOW WIRE COMPATIBLE.
- 2) MATES WITH AFCI PARTS 10136645, 10136646, 10136647, 10137784 & 10137785.
- 3) FOR USE WITH AFCI TERMINAL 10134170.
- 4) FOR USE WITH AFCI TPA ALIGNER 10153465.
- 5) USE ONE TPA ALIGNER FOR SINGLE ROW HOUSING

PART NUMBER SCHEME:

10153467-XX X LF

POSITION CODE COLOUR:
 02 → 2 POSITION Blank → Natural
 03 → 3 POSITION
 04 → 4 POSITION

DIMENSIONAL AND PART NUMBER TABLE

PART NO.	A	B	C
10153467-02XLF	4.2	9.6	11.0
10153467-03XLF	8.4	13.8	15.2
10153467-04XLF	12.6	18.0	19.4

spec ref	dr	Akhil Rajan	2020/06/29	projection	MM	size	A3	scale	2:1
tolerance std	eng	Paul Mithun	2020/06/29			ecn no		-	
ISO 406 ISO 1101	chr	-	-			rel level		Released	
surface	linear	0.X	±0.30		TPA SINGLE ROW RECEPTACLE HSG Minitek Power 4.20	dwg no 10153467	rev		A
		0.XX	±0.25				Product - Customer Drw		sheet 1 of 2
ISO 1302	angular	0°	±2°	cat. no.	Product - Customer Drw				

Amphenol FCI

© 2016 AFCI

Front Side View

Rear Side View

02 Pos

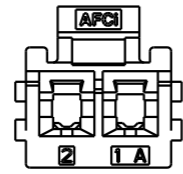
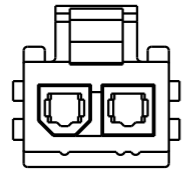

03 Pos

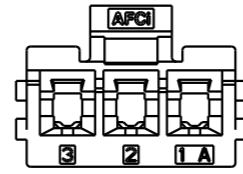
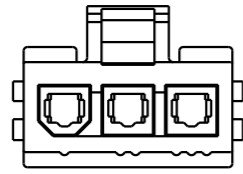

04 Pos

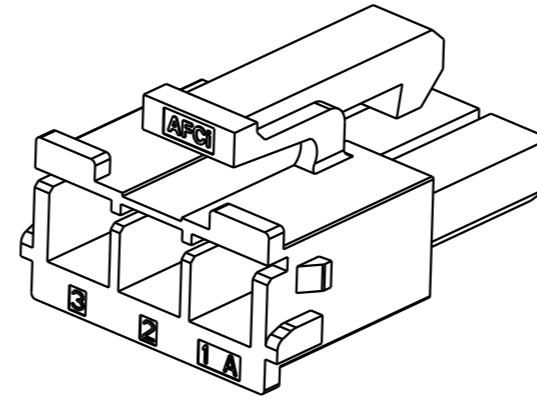
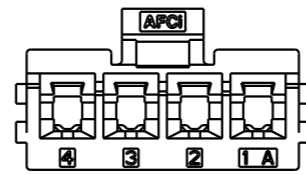
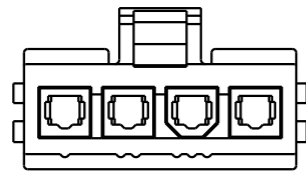

BEFORE TPA ASSEMBLY

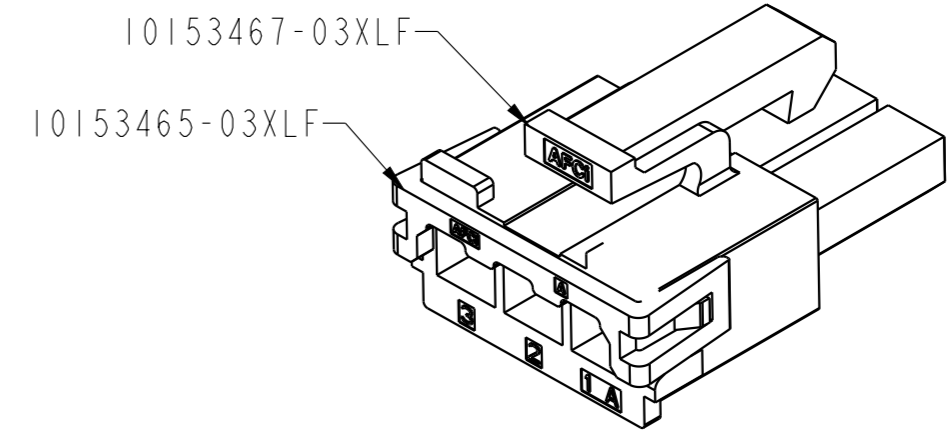

AFTER TPA ASSEMBLY

Amphenol
FCi

© 2016 AFCI

spec ref		dr	Akhil Rajan	2020/06/29	projection	MM	size	A3	scale	5:1		
tolerance std		eng	Paul Mithun	2020/06/29			ecn no		-			
ISO 406 ISO 1101		TOLERANCES UNLESS OTHERWISE SPECIFIED		chr			-	rel level		Released		
surface		appr	Kuriakose, San	2020/06/29	product family		MTK PWR 4.2		-			
ISO 1302	linear	0.X		±0.30		TPA SINGLE ROW RECEPTACLE HSG		dwg no	10153467		rev	A
		0.XX		±0.25		Minitek Power 4.20						
	angular	0°		±2°		cat. no.		Product - Customer Drw		sheet 2 of 2		