

PRODUCT NO.  
10171124-X4373XXLF

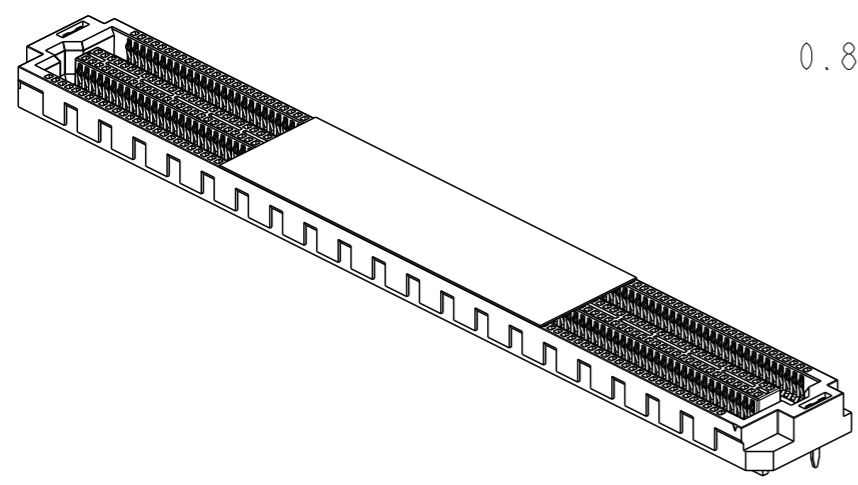
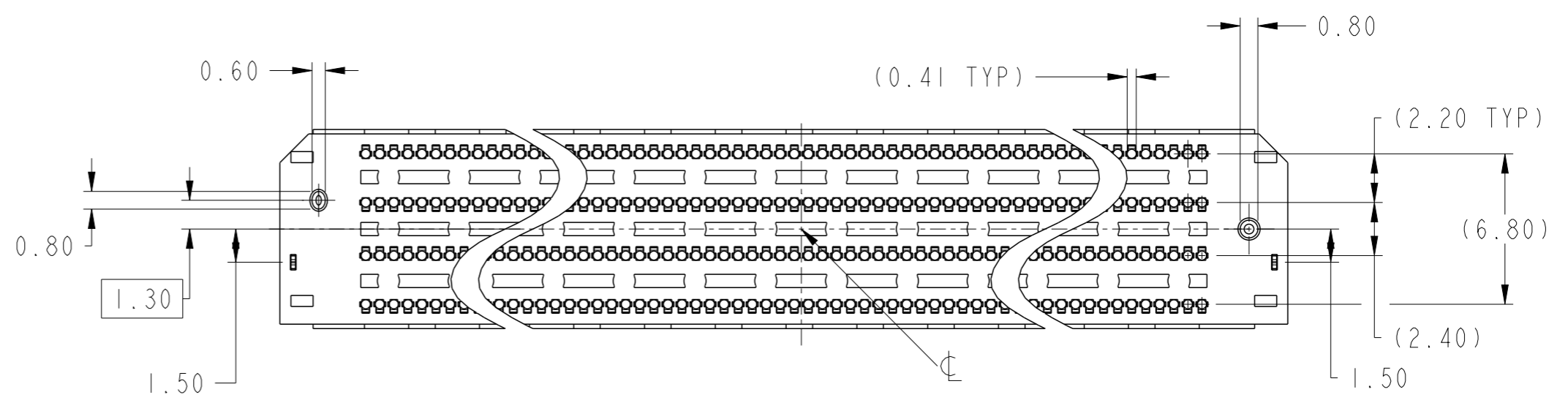
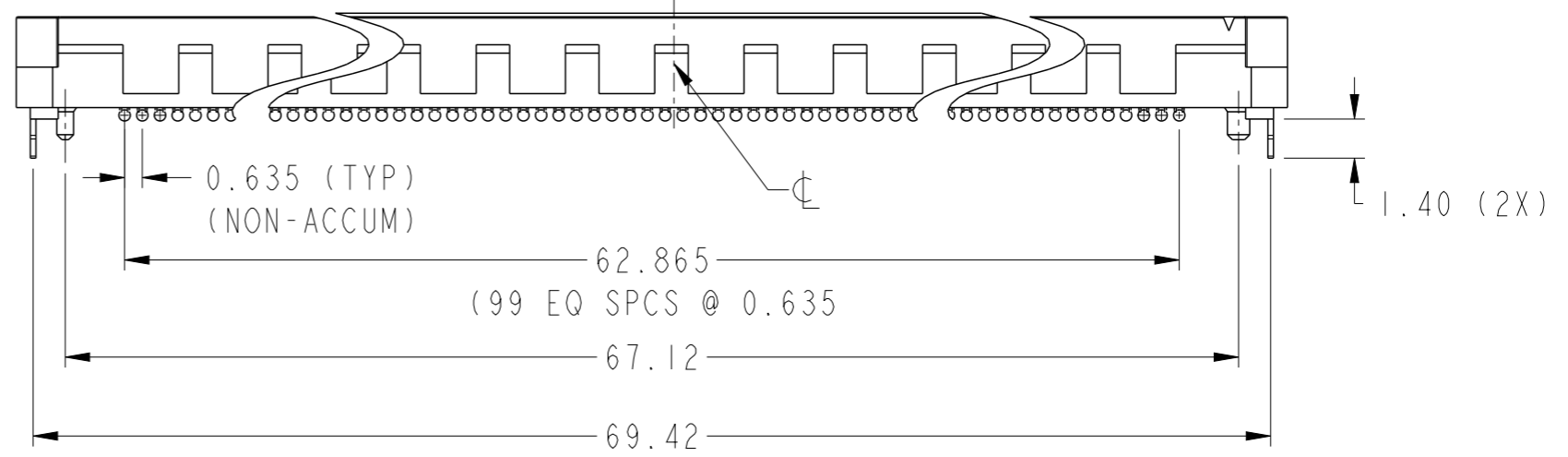
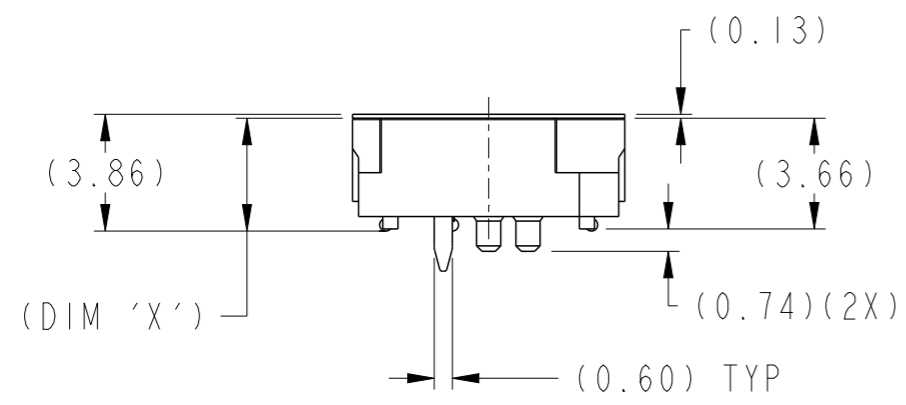
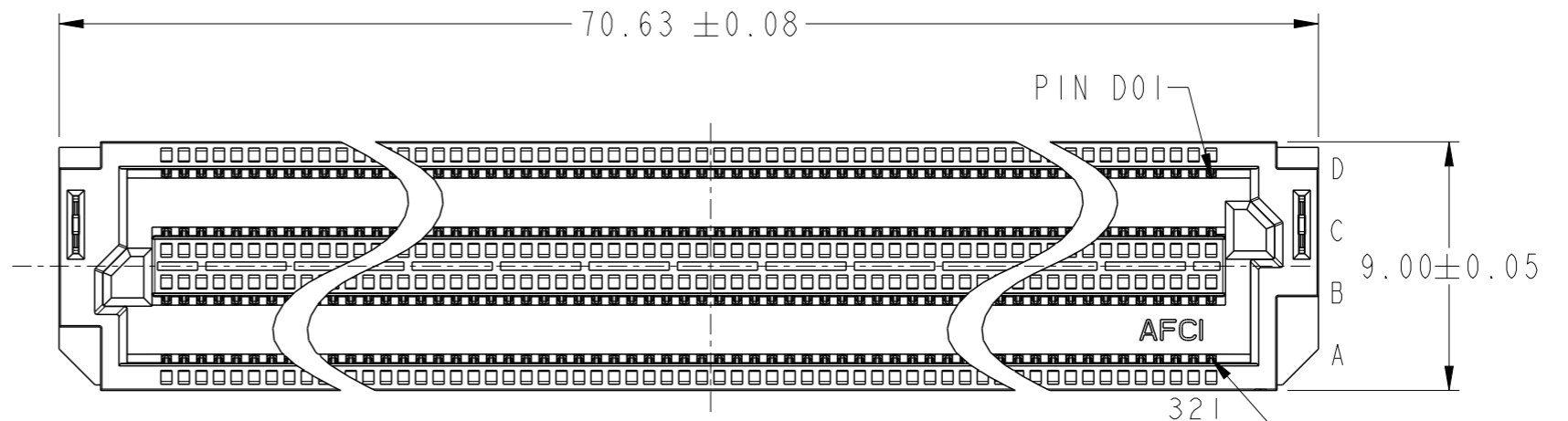

spec ref	dr	Sandar Soe	2024/01/09	projection	mm	size	A3	scale	4:1
tolerance std	eng	Sandar Soe	2025/08/08			ecn no	ELX-S-56820-1	rel level	Released
ASME Y14.5	chr	-	-						
	appr	Chen-Hong Tan	2025/08/21	product family	-				
surface	linear	0.X	$\pm 0.3$		COM-HPC RECEPTACLE ASSY	dwg no	10171124	rev	C
		0.XX	$\pm 0.15$						
		0.XXX	$\pm 0.10$						
ASME Y14.5	angular	$0^\circ$	$\pm 2^\circ$	amphenol-icc.com	cat. no.	-	Product - Customer Drw	sheet 1 of 3	

Creo File:ELX-WC-A3C.REV F.2020-12-21

© 2020 Amphenol Corporation  
Amphenol FCI

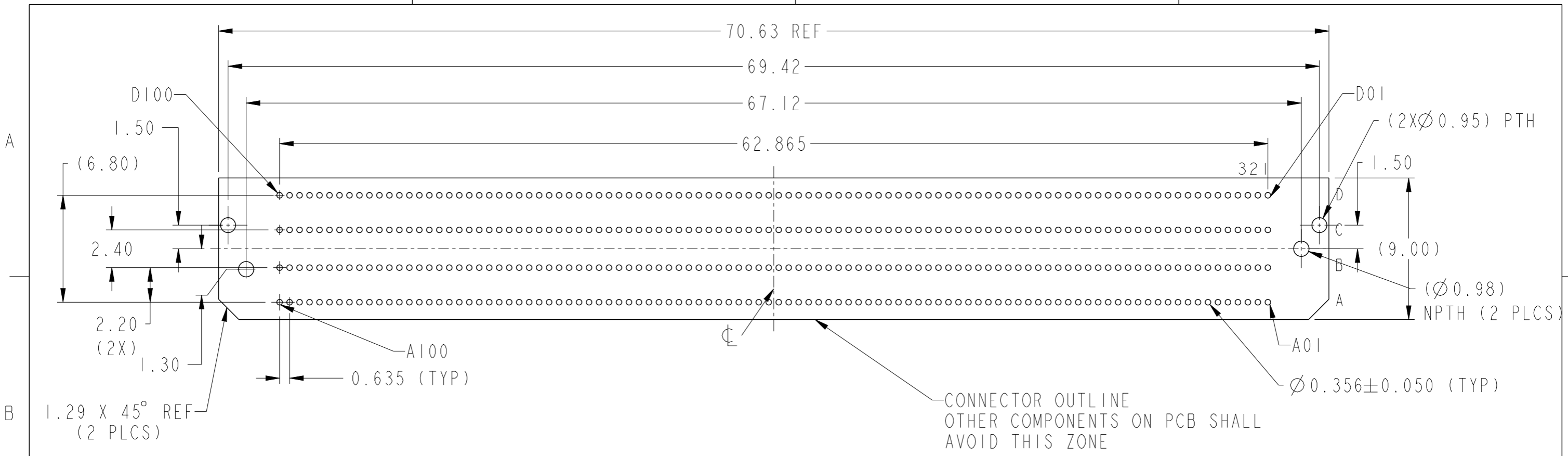

**RECOMMENDED PCB LAYOUT**  
ALL DIMENSIONS SYMMETRIC ABOUT CENTERLINE

Amphenol FCI  
 © 2020 Amphenol Corporation



**RECOMMENDED STENCIL LAYOUT**  
ALL DIMENSIONS SYMMETRIC ABOUT CENTERLINE  
(STENCIL TO BE 0.125[.0050]THICK)

spec ref		dr	Sandar Soe	2024/01/09	projection	mm	size	A3	scale	4:1			
tolerance std		eng	Sandar Soe	2025/08/08			ecn no	ELX-S-56820-1					
ASME Y14.5		TOLERANCES UNLESS OTHERWISE SPECIFIED			chr	-	rel level	Released					
surface		linear	0.X	±0.3	Amphenol FCI	product family		COM-HPC RECEPTACLE ASSY		dwg no	10171124	rev	C
ASME Y14.5			0.XX	±0.15		400POS, HOLD-DOWN PIN, BOARD TO BOARD							
		angular	0°	±2°	amphenol-icc.com	cat. no.	-	Product - Customer Drw		sheet 2 of 3			

Creo File:ELX-WC-A3C.REV F.2020-12-21

10171124-□□□□□□LF

PLATING TYPE

- 1: 10u" AU
- 2: 30u" AU

PICK-UP OPTIONS

- 0 : WITHOUT MYLAR TAPE  $\triangle C$
- 1 : MYLAR TAPE 30x9.00MM

PACKAGING OPTIONS

- T: TAPE & REEL

HEIGHT (DIM "X")

- 373: 3.73MM

NO. OF POSITION

- 4: 400 POSITIONS

NOTES:

1. MATERIAL:  
HOUSING: HIGH PERFORMANCE THERMOPLASTIC  
CONTACT: COPPER ALLOY.  
HOLD-DOWN BLADE: COPPER ALLOY.
2. PLATING:  
CONTACT AREA: REFER PLATING TYPE,  
OVER 50 $\mu$ " MIN NICKEL
3. PRODUCT SPECIFICATION: GS-12-1822
4. PRODUCT MEETS EUROPEAN UNION DIRECTIVES AND  
OTHER COUNTRY REGULATIONS AS DESCRIBED IN GS-47-0004.
5. DATE CODE "MMDDYYL", MMDDYY IS ASSEMBLY DATE.  
L IS AFCI PRODUCTION SITE.
6. A  $\triangle$  SYMBOL BE NEXT TO ANY DIMEENSION, VIEW OR  
NOTE WHICH HAD BEEN MODIFIED WITH THE CURRENT  
DRAWING REVISION.

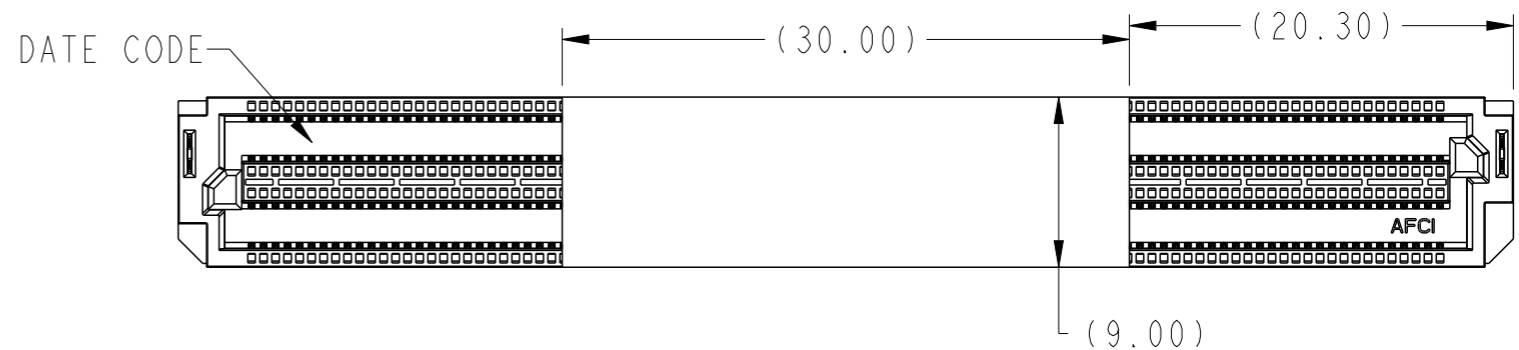

RECEPTACLE ASSY WITH MYLAR TAPE

spec ref		dr	Sandar Soe	2024/01/09	projection	mm	size	A3	scale	1:1	
tolerance std		eng	Sandar Soe	2025/08/08		mm	ecn no		ELX-S-56820-1		
ASME Y14.5		chr	-	-			rel level		Released		
TOLERANCES UNLESS OTHERWISE SPECIFIED		appr	Chen-Hong Tan	2025/08/21	product family		-		-		
surface	linear	0.X	±0.3		<b>Amphenol FCI</b>	COM-HPC RECEPTACLE ASSY		dwg no	10171124		
		0.XX	±0.15			400POS, HOLD-DOWN PIN, BOARD TO BOARD			rev	C	
		0.XXX	±0.10			-				-	
ASME Y14.5	angular	0°	±2°		amphenol-icc.com	cat. no.	-		Product - Customer Drw	sheet 3 of 3	