

This document is the property of Amphenol Corporation and is delivered on the express condition that it is not to be disclosed, reproduced or used, in whole or in part, for manufacture or sale by anyone other than Amphenol Corporation without its prior consent, & that no right is granted to disclose or to use any information in this document.

# CUSTOMER DRAWING

REVISIONS				
SYM	ECN	DESCRIPTION	DATE	APPROVED
1	HK114.06	FIRST RELEASE	11/23/22	Xiang
2	HK----	MODIFY THE TAB LENGTH FROM 2.45 TO 1.85	03/29/23	Xiang

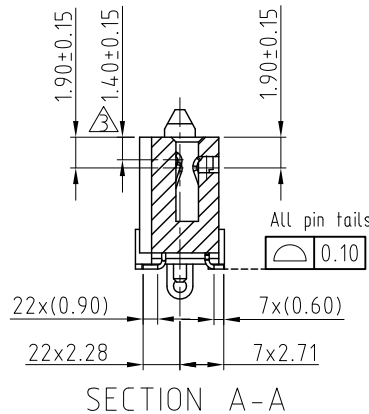
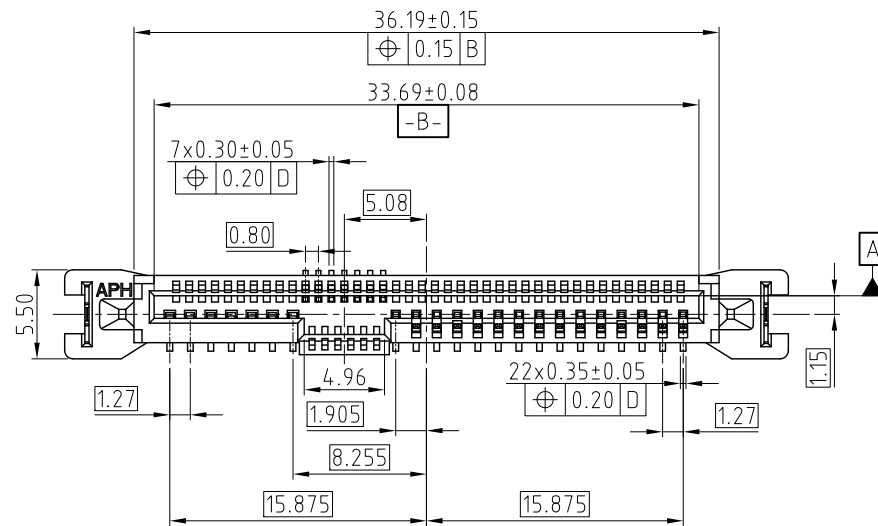
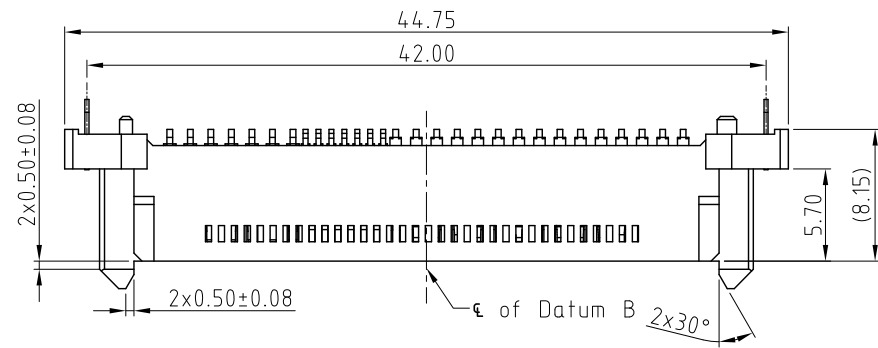

- NOTES**
- MATERIAL**
    - HOUSING: HIGH TEMPERATURE THERMOPLASTIC, UL94V-0, COLOR:BLACK.
    - CONTACTS : PHOSPHOR BRONZE  
PLATING: REFER TO P/N SYSTEM ON MATING AREA.  
1.27um MIN NICKEL UNDER PLATED OVERALL.  
2.54um MIN PURE MATTE TIN ON SOLDER TAILS.
    - SOLDER CLIPS: COPPER ALLOY  
2.54um MIN PURE MATTE TIN OVER 1.27um MIN NICKEL.
  - GENERAL SPECIFICATION**
    - CURRENT RATING: 1.5A/PER PIN (POWER SECTION).
    - CONTACT RESISTANCE: 30mΩ MAX (INITIAL).
    - INSULATOR RESISTANCE: 1000MΩ MIN.
    - DIELECTRIC WITHSTANDING VOLTAGE: 500 VAC
    - OPERATION TEMPERATURE: -55°C~+105°C
  - PREMATING AT P4 & P12
  - SUPPORT SAS4.0
  - DIMENSIONING SHALL BE INTERPRETED PER ASME Y14.5M 1994.
  - MATERIAL SHOULD BE FULFILLED AMPHENOL SPEC.S-SN-002 AND S-SN-004.
  - ORDER P/N SYSTEM: SAS4F313018XXX

**MATING AREA PLATING**

- 0.76um MIN Au.
- 0.38um MIN Au.
- Gold FLASH

**PACKING STYLE**

- NIL- TRAY WITHOUT PICK-UP CAP
- C- TRAY WITH PICK-UP CAP
- TR- TAPE AND REEL WITH PICK-UP CAP
- NT- TAPE AND REEL WITHOUT PICK-UP CAP

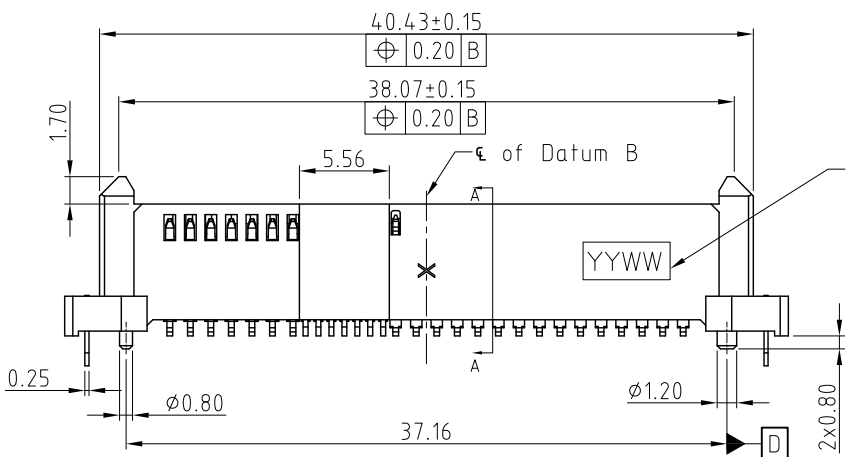

PRINTED D/C AREA  
RULE: YYWW  
YEAR  
WEEK

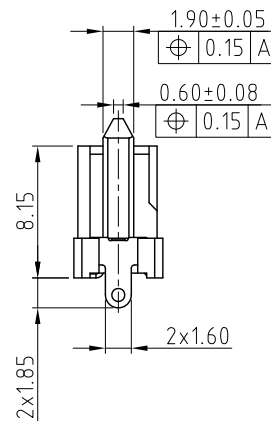

HF(无卤)	√
Non-HF(有卤)	



UNLESS OTHERWISE SPECIFIED TOLERANCES	
	METRIC
.X	±0.50
.XX	±0.25
.XXX	±0.15
FRACTIONS	±0.15
ANGLES	±3°

FOR MATERIALS AND FINISHES SEE NOTES

REMOVE SHARP EDGES

DIMENSIONS

U.S.	INCHES
(METRIC)	(MM)

APPROVAL		DATE
DRAWN	Jimmy.zhou	03/29/23
CHECKED	Xiang.Wang	03/29/23
CHECKED		
DRAWING FILE :		
ANGLE OF PROJECTION		

Amphenol		Amphenol East Asia Limited	
TITLE			
SAS V/T SMT 29PIN SOCKET			
SIZE	DRAWING NO.	REV.	
A3	SAS4F313018XXX	2	
SCALE	NONE	SHEET 1 OF 3	

This document is the property of Amphenol Corporation and is delivered on the express condition that it is not to be disclosed, reproduced or used, in whole or in part, for manufacture or sale by anyone other than Amphenol Corporation without its prior consent, & that no right is granted to disclose or to use any information in this document.

CUSTOMER DRAWING

REVISIONS				
SYM	ECN	DESCRIPTION	DATE	APPROVED
		REFER TO SHEET 1		

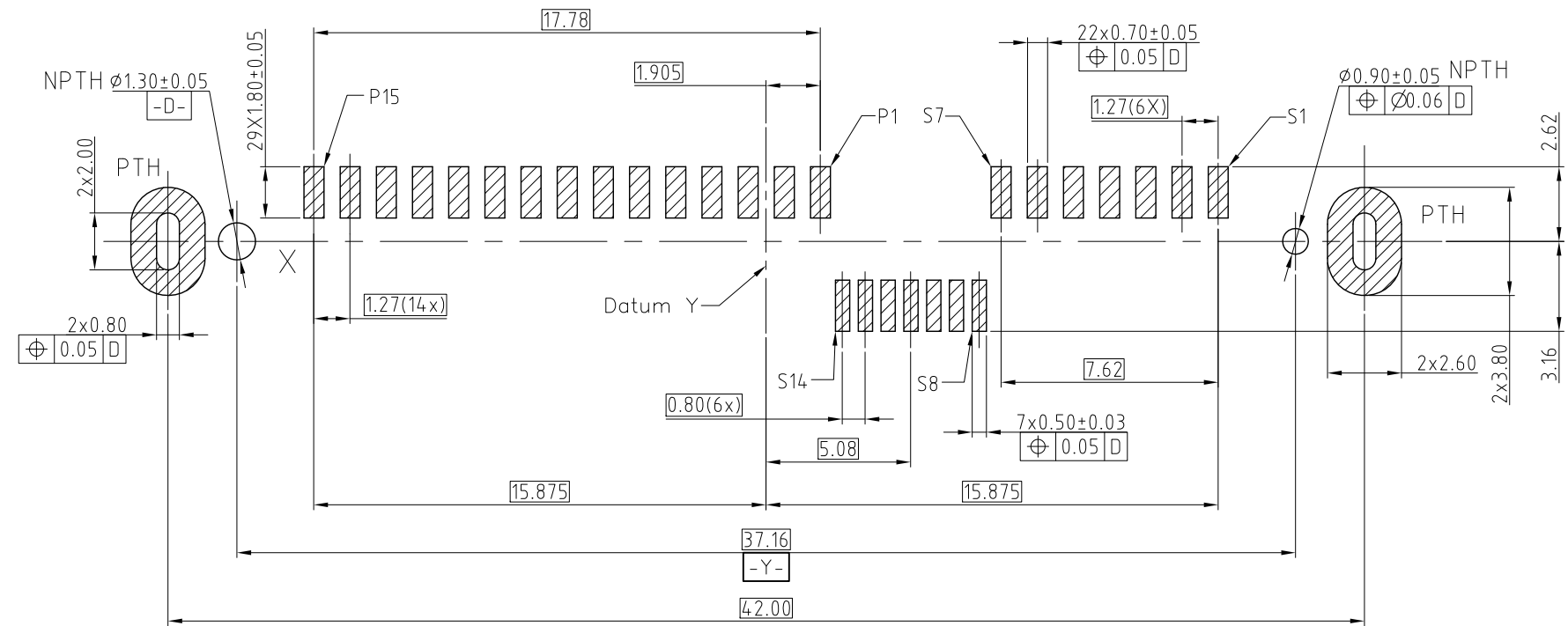

RECOMMENDED PCB LAYOUT(TOP VIEW)  
 GENERAL TOLERANCE ±0.05(PCB THICKNESS:1.0~2.0)

With Pick-up Cover

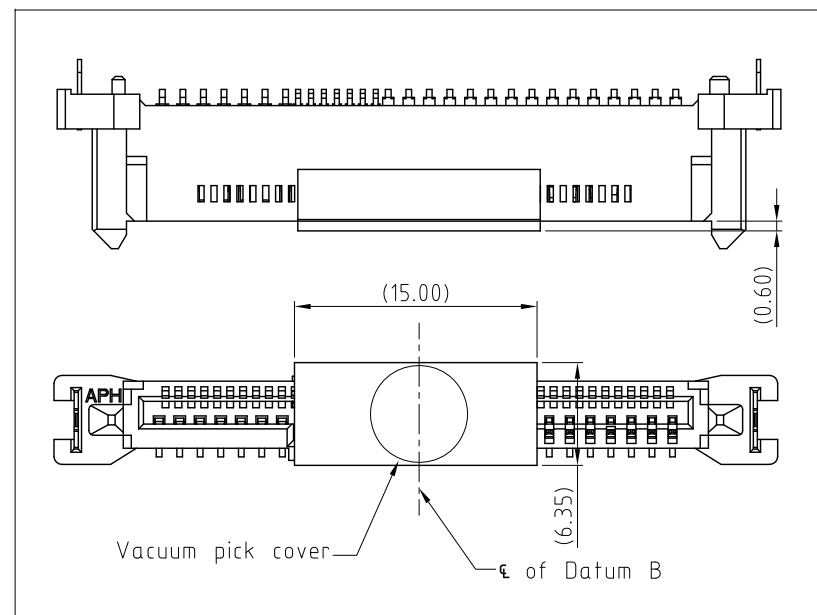

HF(无卤)	√
Non-HF(有卤)	

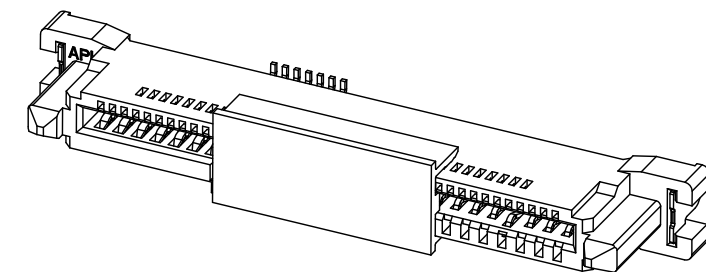

UNLESS OTHERWISE SPECIFIED TOLERANCES	U.S.	METRIC	APPROVAL	DATE	Amphenol
	.X	+/- 0.50			
	.XX	+/- 0.25	CHECKED	Xiang.Wang	03/29'23
	.XXX	+/- 0.15	CHECKED		
FOR MATERIALS AND FINISHES SEE NOTES	FRACTIONS	+/-	DRAWING FILE :		
REMOVE SHARP EDGES	ANGLES	+/- 3°	ANGLE OF PROJECTION		
DIMENSIONS	U.S. INCHES				
	(METRIC) (MM)				
TITLE		SAS V/T SMT 29PIN SOCKET			
SIZE	DRAWING NO.	REV.			
A3	SAS4F313018XXX	2			
SCALE	NONE	SHEET	2 OF 3		

This document is the property of Amphenol Corporation and is delivered on the express condition that it is not to be disclosed, reproduced or used, in whole or in part, for manufacture or sale by anyone other than Amphenol Corporation without its prior consent, & that no right is granted to disclose or to use any information in this document.

CUSTOMER DRAWING

REVISIONS				
SYM	ECN	DESCRIPTION	DATE	APPROVED
REFER TO SHEET 1				

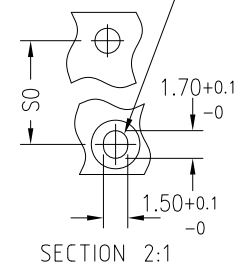
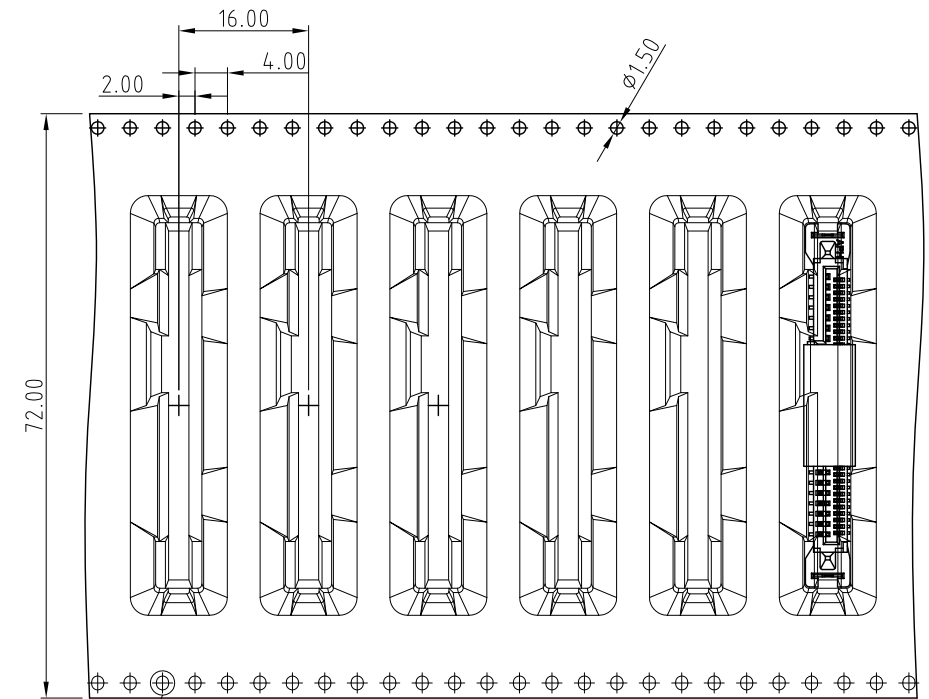
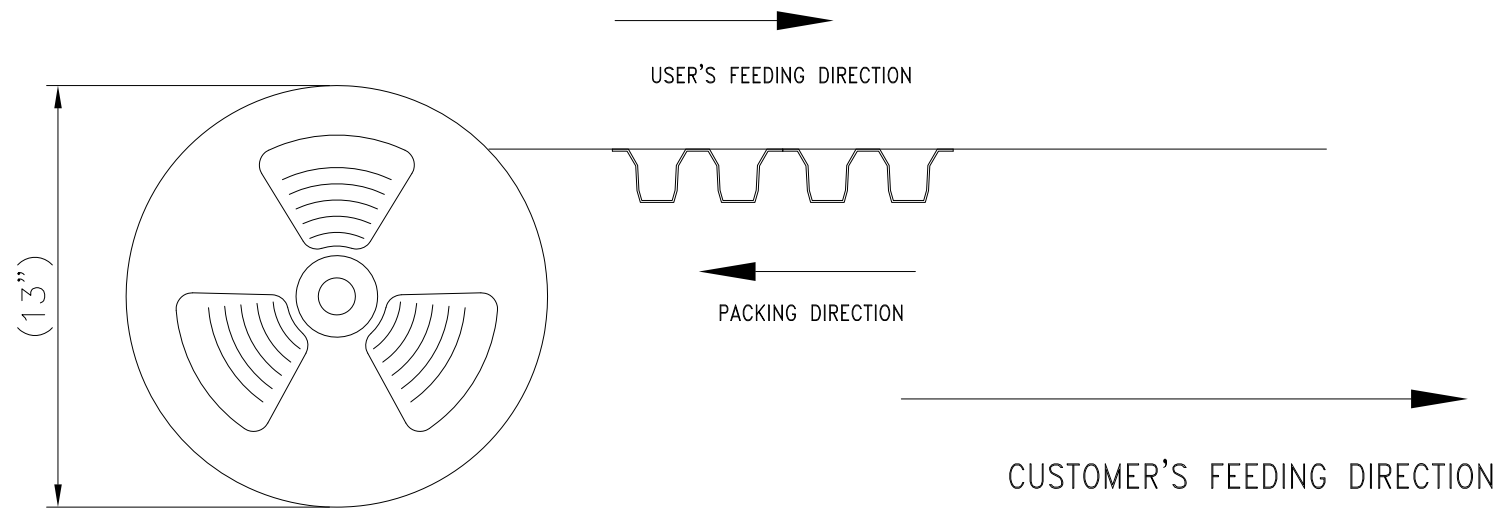
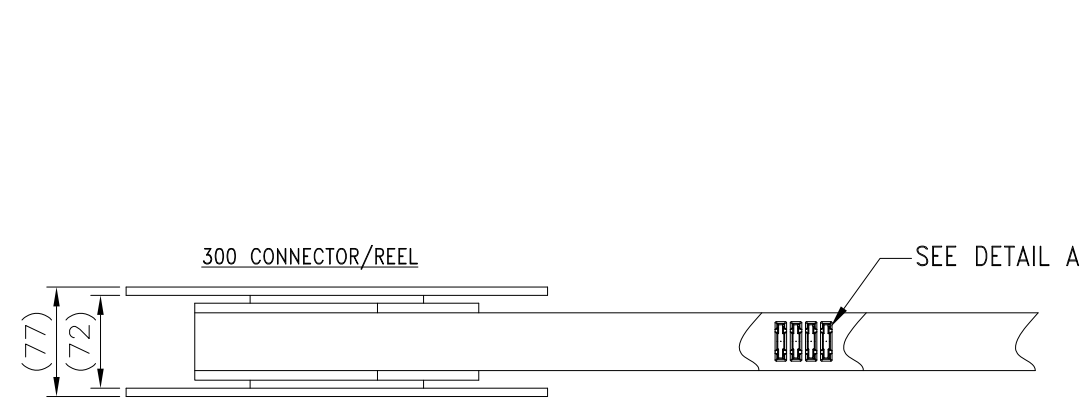

DETAIL A  
SCALE 2:1

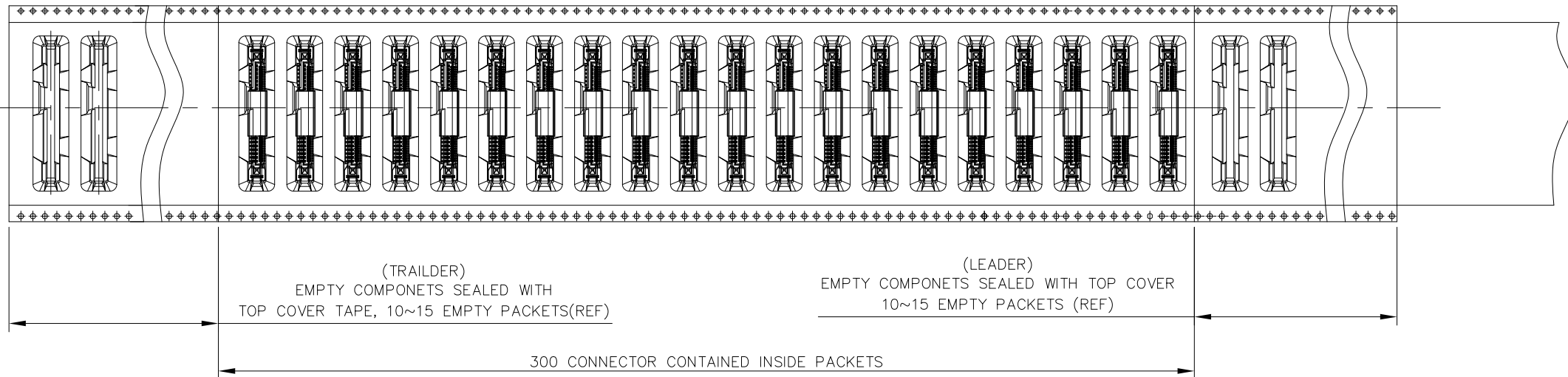

HF(无卤)	√
Non-HF(有卤)	



UNLESS OTHERWISE SPECIFIED TOLERANCES		APPROVAL		DATE	<p style="text-align: center; font-size: 24pt;"><b>Amphenol</b></p> <p style="text-align: center;">Amphenol East Asia Limited</p> <p style="text-align: center;">TITLE</p> <p style="text-align: center;">SAS V/T SMT 29PIN SOCKET</p>
U.S. METRIC		DRAWN	Jimmy Zhou	03/29/23	
.X +/- 0.50		CHECKED	Xiang Wang	03/29/23	
.XX +/- 0.25		CHECKED			
.XXX +/- 0.15		DRAWING FILE :			
FRACTIONS +/- 3°		ANGLE OF PROJECTION			
ANGLES +/-		REMOVE SHARP EDGES			
FOR MATERIALS AND FINISHES SEE NOTES		DIMENSIONS			
U.S. INCHES		U.S. INCHES		SIZE	DRAWING NO.
(METRIC) (MM)		(METRIC) (MM)		A3	SAS4F313018XXX
				SCALE	NONE
				SHEET 3 OF 3	