

MG1E “A” Cabinet Gas Furnace - A2L Retrofit Kit

INSTALLATION INSTRUCTIONS

Downflow, Direct Vent (Sealed Combustion) Forced Air Gas Furnaces

Note: These instructions are to be followed along with the proper removal/installation of a compatible coil. Consult the coil installation instructions for more details.

WARNING / AVERTISSEMENT

FIRE OR EXPLOSION HAZARD

- Failure to follow safety warnings exactly could result in serious injury, death or property damage.
- Installation and service must be performed by a qualified installer, service agency or the gas supplier.
- Do not store or use gasoline or other flammable vapors and liquids in the vicinity of this or any other appliance.

RISQUE D'INCENDIE OU D'EXPLOSION

- Le non-respect des avertissements de sécurité pourrait entraîner des blessures graves ou des dommages matériels importants.
- L'installation et l'entretien doivent être effectués par un installateur qualifié, un organisme de service ou le fournisseur de gaz.
- N'entreposez pas ni n'utilisez de l'essence ni d'autres vapeurs ou liquides inflammables dans le voisinage de cet appareil, ni de tout autre appareil.

WHAT TO DO IF YOU SMELL GAS

- Do not try to light any appliance.
- Do not touch any electrical switch; do not use any phone in your building.
- Leave the building immediately.
- Immediately call your gas supplier from a neighbors phone. Follow the gas suppliers instructions.
- If you cannot reach your gas supplier, call the fire department.

QUE FAIRE S'IL Y A UNE ODEUR DE GAZ

- N'essayez d'allumer aucun appareil.
- Ne touchez à aucun interrupteur électrique; n'utilisez aucun téléphone dans le bâtiment.
- Évacuez l'immeuble immédiatement.
- Appelez immédiatement le fournisseur de gaz en employant le téléphone d'un voisin. Respectez les instructions du fournisseur de gaz.

DO NOT DESTROY. PLEASE READ CAREFULLY & KEEP IN A SAFE PLACE FOR FUTURE REFERENCE.

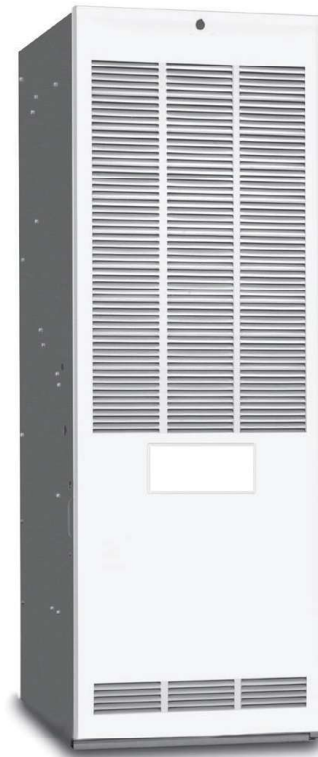

MG1E “A” CABINET

ATTENTION INSTALLERS:

It is your responsibility to know this product better than your customer. This includes being able to install the product according to strict safety guidelines and instructing the customer on how to operate and maintain the equipment for the life of the product. Safety should always be the deciding factor when installing this product and using common sense plays an important role as well. Pay attention to all safety warnings and any other special notes highlighted in the manual. Improper installation of the Appliance or failure to follow safety warnings could result in serious injury, death, or property damage.

These instructions are primarily intended to assist qualified individuals experienced in the proper installation of this appliance. Some local codes require licensed installation/service personnel for this type of equipment. Please read all instructions carefully before starting the installation. Return these instructions to the customer's package for future reference.

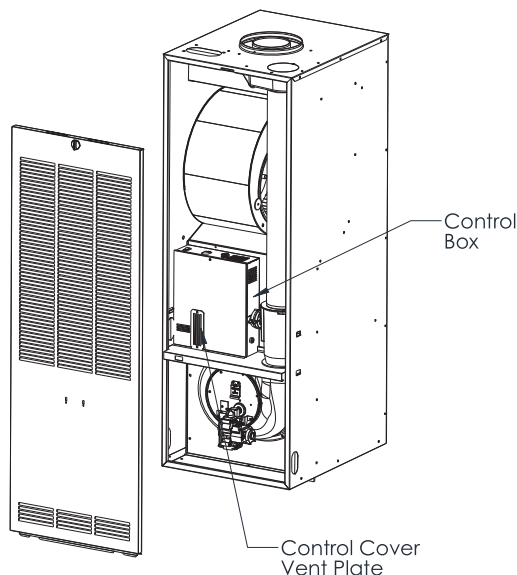

Figure 1. MG1E "A" Cabinet Part List

To make MG1E models built before August 2024 compatible with A2L refrigerant and to be able to use a C85 R454B indoor coil with them, this retrofit kit is provided. Before installing a C85 A2L indoor coil please read the C85 installation instructions carefully.

Please check with NGH service team to ensure the coil box you are using is the right box for C85 A2L indoor coils. If you are using an old coil box, you need to replace it with the new A2L compatible design.

In this kit you have the following parts (Figure 1):

1. Control Box
2. Cutout Templates
3. Control Cover Vent Plate
4. Prop 65 Label
5. Retrofitted Label

Follow these steps to make the furnace A2L compatible:

1. Disconnect all power to the unit.
2. Remove the door.

Replace Control Box (see Figure 2)

1. Remove the control box cover.
2. Disconnect all wiring that is routed through the control box.
3. The black wire (inducer motor to the control board) will need to be cut to pass through to hole on the control box.
4. Remove the switch, plug, and grommets from the existing control box to install into the replacement box.
5. Unscrew the control box to remove it from the unit.
6. Use the fasteners provided to install the new control box.
7. Re-assemble the switch, plug, and grommets.
8. Re-route and connect the wiring according to the

wiring diagram. Re-connect the black wire inside the control box using the supplied wire nut.

9. Leave the control cover off to complete the next step.

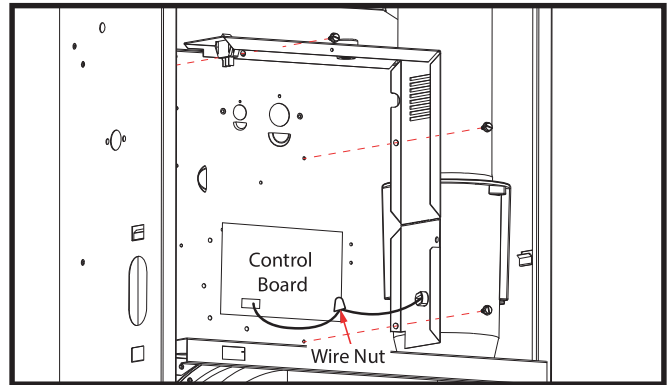

Figure 2. Control Box Installation

Install Vent Plate on Control Cover (see Figure 3)

1. Use template 1049081 to create a cutout on the control cover.
2. Verify labels are clear of the cut zone (Excluding the Prop 65 label. It will be replaced).
3. Use two self-tapping screws to secure the vent plate to the control panel over the cutout.
4. Verify the plate is secure.
5. Verify the cutout is fully covered by the vent plate with the slots on the vent plate over the cutout to allow for ventilation.
6. Verify vent plate is not covering the rating plate label.
7. Re-install the control cover.
8. Reapply Prop 65 Label to any open area on the front of the control cover.

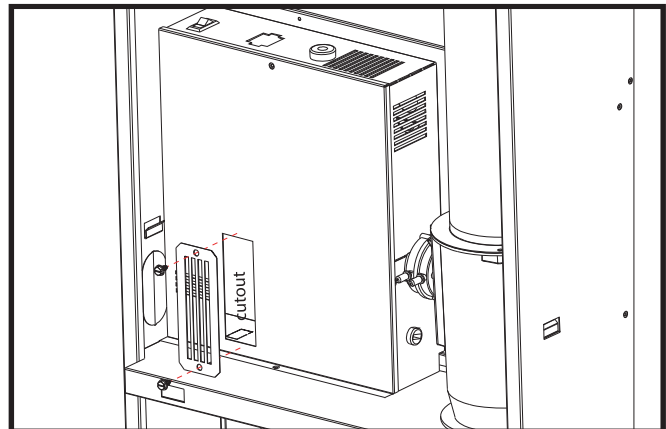

Figure 3. Vent Plate for Control Cover

Apply Retrofitted Label

1. Verify all modifications are complete.
2. Apply "retrofitted label" 1049101 to the outside of the door.

NOTE: After all modifications are complete and verified, reconnect power.

