



608 E. University Ave, Champaign, IL 61820

CLASS A

RETAIL

BUILDING SIZE

21,108 SF

AVAILABLE SF

3,370 SF

PARKING

Approx. 65

YEAR BUILT

2016

ZONING

CB1 – Central Business
Urban Fringe

TAX PIN

46-21-07-334-015, 016
46-21-07-338-019, 020,
021

PROPERTY DESCRIPTION

Latitude is a Class A, two building, six story mixed-use development consisting of 21,100 SF of first floor retail/restaurant/office space spanning two city blocks and 324 units/519 beds luxury apartments on the 2nd-6th floors. The west building is fully leased. The east building currently has space ranging in size from 1,441-3,370 SF and can be demised per tenant needs. Tenant space will be delivered in 'Grey Shell' with \$50/USF in tenant improvement allowance. Additional outdoor patio area is available for retail/restaurant use and the building features high speed fiber internet. Parking is located on the north side of the building along with metered spots along the street.

AREA DESCRIPTION

Located along East University Ave. (21,800 VPD) in Champaign between Fifth and Wright Street and just North of the University of Illinois Engineering Campus. Property is located with close proximity to OSF Hospital, Carle Hospital, and Downtown Champaign.



ZACH WETHERELL, CCIM
217-403-3374
zw@cbcdr.com



AJ THOMA III, CCIM
217-403-3425
ajt@cbcdr.com



**COLDWELL
BANKER
COMMERCIAL**
DEVONSHIRE REALTY

LATITUDE SPACE FOR LEASE

\$14.00-\$16.00 / SF / NNN



RETAIL

FOR LEASE

FLOOR PLAN

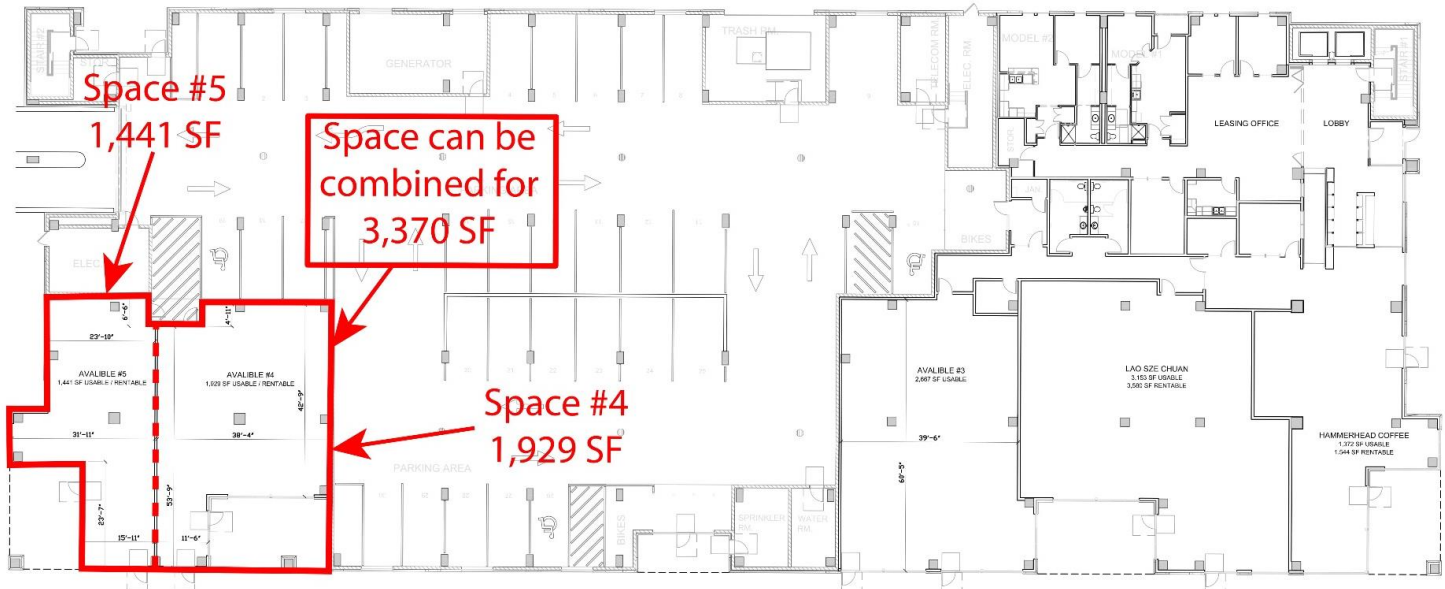

ZACH WETHERELL, CCIM
217-403-3374
zw@cbcdr.com



AJ THOMA III, CCIM
217-403-3425
ajt@cbcdr.com

CBCDR.COM

**COLDWELL BANKER COMMERCIAL
DEVONSHIRE REALTY**

201 W Springfield Ave. 11th Floor
Champaign, IL 61820
217-352-7712

© 2020 Coldwell Banker Real Estate LLC, Coldwell Banker Commercial Affiliates. All Rights Reserved. Coldwell Banker Real Estate LLC, Coldwell Banker Commercial Affiliates fully supports the principles of the Equal Opportunity Act. Each Office is Independently Owned and Operated. Coldwell Banker Commercial and the Coldwell Banker Commercial Logo are registered service marks owned by Coldwell Banker Real Estate LLC, dba Coldwell Banker Commercial Affiliates.



**COLDWELL
BANKER
COMMERCIAL**
DEVONSHIRE REALTY

LATITUDE SPACE FOR LEASE

\$14.00-\$16.00 / SF / NNN



RETAIL

FOR LEASE

AERIAL



ZACH WETHERELL, CCIM

217-403-3374
zw@cbcdr.com



AJ THOMA III, CCIM

217-403-3425
ajt@cbcdr.com



CBCDR.COM

**COLDWELL BANKER COMMERCIAL
DEVONSHIRE REALTY**

201 W Springfield Ave. 11th Floor
Champaign, IL 61820
217-352-7712

© 2020 Coldwell Banker Real Estate LLC, Coldwell Banker Commercial Affiliates. All Rights Reserved. Coldwell Banker Real Estate LLC, Coldwell Banker Commercial Affiliates fully supports the principles of the Equal Opportunity Act. Each Office is Independently Owned and Operated. Coldwell Banker Commercial and the Coldwell Banker Commercial Logo are registered service marks owned by Coldwell Banker Real Estate LLC, dba Coldwell Banker Commercial Affiliates.