

CROSSING COURT

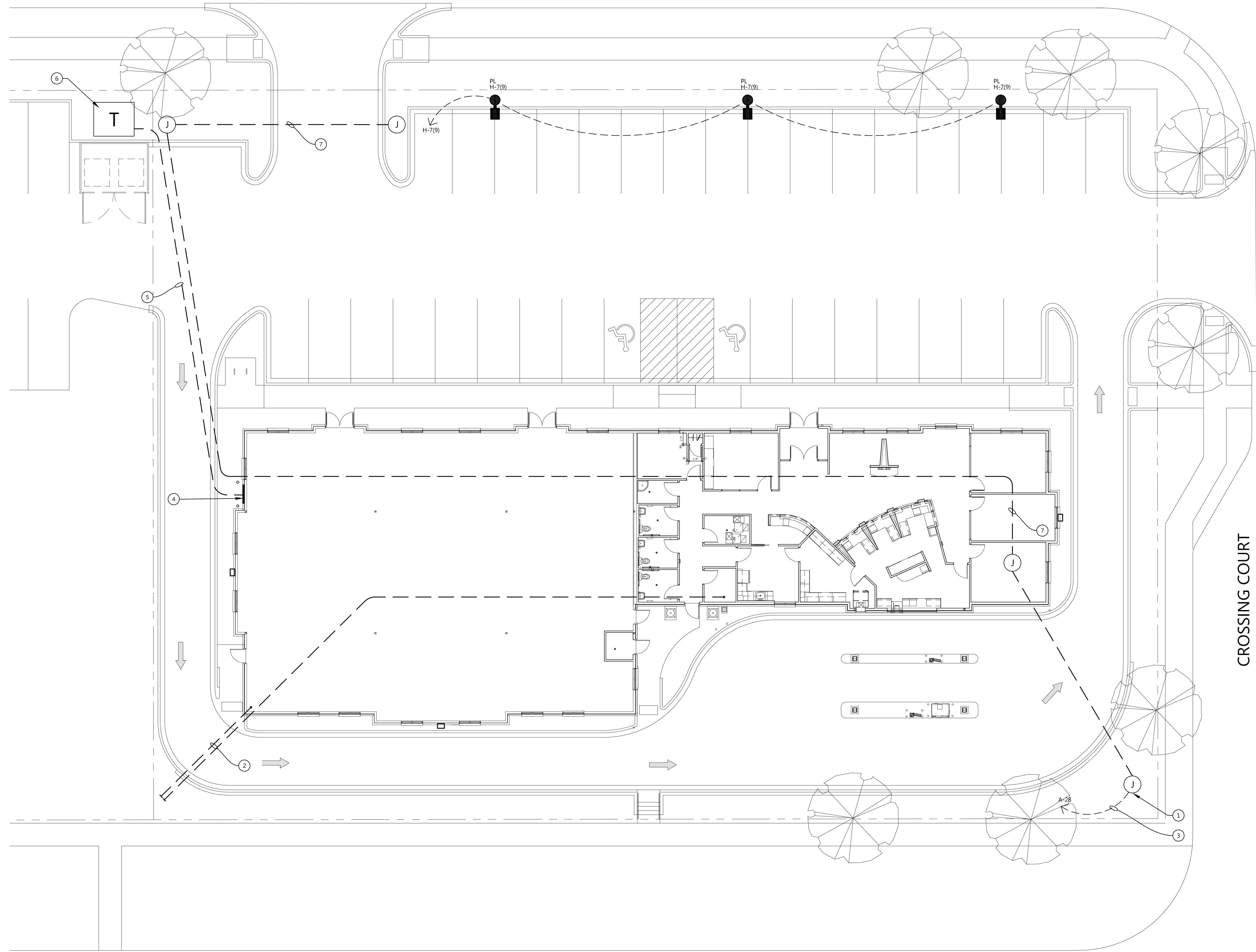

WINDSOR ROAD

A
E1.0 ELECTRICAL SITEPLAN
SCALE: 1" = 10'-0"

ELECTRICAL SITE PLAN GENERAL NOTES:

- A. COORDINATE ALL UTILITY ROUTINGS WITH CIVIL SITE PLAN AND LOCAL UTILITIES.
- B. ALL UNDERGROUND ELECTRICAL, TELEPHONE, DATA AND CABLE CONDUITS SHALL BE LOCATED AS NECESSARY TO NOT INTERFERE WITH SITE UTILITY (STORM, WATER, SANITARY, ETC.) WORK. COORDINATE WITH SITE UTILITY CONTRACTORS.
- C. REFER TO CIVIL DRAWINGS FOR LOCATIONS OF UNDERGROUND SITEWORK. CONTRACTOR(S) FOR WORK SHOWN ON THIS DRAWING SHALL COORDINATE THIS WORK AS NECESSARY TO ELIMINATE ANY CONFLICTS (I.E. CROSSINGS OF UNDERGROUND WORK SHALL MAINTAIN ADEQUATE CLEARANCES, ENCASMENT PROTECTION WHEN REQUIRED BY UTILITY COMPANIES AND MAINTAIN REQUIRED DEPTHS BELOW FINISH GRADE AND PAVEMENTS).

ELECTRICAL SITE PLAN KEYED NOTES:

- 1. J-BOX AT BRICK WALL FOR SIGN LIGHTING. COORDINATE EXACT LOCATION WITH SIGNAGE CONTRACTOR.
- 2. TWO - EMPTY 4" CONDUIT WITH PULLWIRE FOR TELEPHONE ROUTED 2'-0" UNDERGROUND (MIN.) STUB ONE (1) UP INTO 1/2" ROOM 100 AND ONE (1) INTO SHELL 200. COORDINATE EXACT LOCATION STUB UPS WITH TELEPHONE COMPANY IN FIELD.
- 3. ONE - 3/4" SCHEDULE 40 PVC FROM HOUSE PANEL TO SIGN LIGHT (J-BOX). ROUTED MINIMUM 2'-0" DEEP UNDERGROUND. PROVIDE PULLWIRE IN ALL EMPTY CONDUIT.
- 4. UTILITY SERVICE ENTRANCE. SEE ELECTRICAL FLOOR PLAN SHEETS FOR DETAILS. PROVIDE 2 CONCRETE FILLED STEEL PIPE BOLLARDS FOR METER EQUIPMENT PROTECTIVE BARRIER.
- 5. SECONDARY FROM UTILITY TRANSFORMER TO SERVICE ENTRANCE. SEE ELECTRICAL FLOOR PLAN SHEETS FOR DETAILS.
- 6. EXISTING TRANSFORMER LOCATION.
- 7. 3/2" CONDUIT TO HOUSE PANEL.

ELECTRICAL LEGEND - SITEWORK	
FIXTURE SYMBOL	DESCRIPTION
	WALL SCONCE
	RECESSED CAN LIGHT
	DUPLEX RECEPTACLE - WEATHER PROOF
	QUAD RECEPTACLE - WEATHER PROOF
	BATTERY BACK UP EMERGENCY LIGHT
	SURFACE MOUNTED ELECTRICAL PANEL
	HOME RUN
	DISCONNECT
	SITE LIGHTING - PARKING AREA LIGHT WITH POLE
	JUNCTION BOX

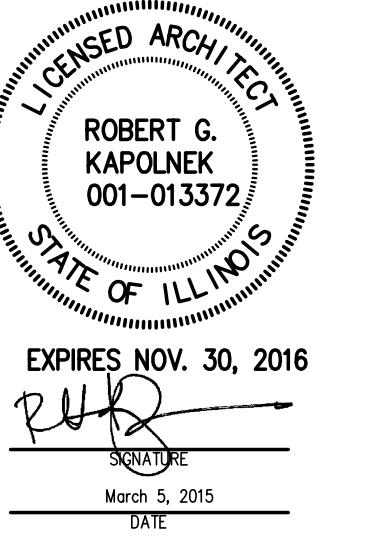

COPYRIGHT © 2015 KAP ARCHITECTURE LLC
THE DRAWING, DESIGN AND GRAPHIC REPRESENTATION SHOWN ARE THE PROPERTY OF KAP ARCHITECTURE LLC. THE REPRODUCTION, COPYING, OR OTHER USE OF THIS DRAWING WITHOUT THE WRITTEN CONSENT OF KAP ARCHITECTURE LLC IS PROHIBITED AND INFRINGEMENT WILL BE SUBJECT TO LEGAL ACTION.

FOR:
ROBESON'S, INC.
201 South State Street
Champaign, IL 61820

ROBESON OFFICE BUILDING
2911 Crossing Court
Champaign, IL 61822

No.	Revision Description	Date
RECORD DRAWING		

ARCHITECT OF RECORD:
KAP Architecture LLC
3019 Village Office Place
Champaign, Illinois 61822
217.351.6005 P
217.351.6005 F
www.kaparchitecture.com

SITE PLAN - ELECTRICAL

Project: 13-111	Sheet #: E1.0
Date: March 5, 2015	
Scale: AS NOTED	