



**COLDWELL BANKER
COMMERCIAL**
DEVONSHIRE
REALTY

Highly Visible Retail Space, Champaign

\$14.00 / SF / NNN = \$5.00



FOR LEASE

1401 S. State Street, Suite B

Champaign, IL 61820

2,000 SF

OFFICE

RETAIL

PROPERTY DESCRIPTION

This inline unit offers flexible floor plan, great street visibility and on site parking. One suite is currently available.

Suite B: +/- 2,000 SF

AREA DESCRIPTION

Across from Parkland College. Area businesses include Kraft Foods and several office, retail, and light industrial business in at Mattis Commercial Park. Easy access with interstates nearby.

LEASE PRICE

\$14.00 SF

LEASE TYPE

NNN = \$5.00

LOT SIZE

14,338 SF

CONSTRUCTION TYPE

BLOCK

BUILDING SIZE

3,384 SF

ZONING

CG

AVAILABLE SPACE

SUITE B: +/- 2,000 SF

YEAR BUILT

2001



JAY SIKORSKI

217-352-7712

jas@cbcdr.com

cbcdr.com



**COLDWELL BANKER COMMERCIAL
DEVONSHIRE REALTY**

201 W Springfield Ave. 11th Floor
Champaign, IL 61820
217-352-7712

© 2020 Coldwell Banker Real Estate LLC, Coldwell Banker Commercial Affiliates. All Rights Reserved. Coldwell Banker Real Estate LLC, Coldwell Banker Commercial Affiliates fully supports the principles of the Equal Opportunity Act. Each Office is Independently Owned and Operated. Coldwell Banker Commercial and the Coldwell Banker Commercial Logo are registered service marks owned by Coldwell Banker Real Estate LLC, dba Coldwell Banker Commercial Affiliates.



Highly Visible Retail Space, Champaign

\$14.00 / SF / NNN = \$5.00

FOR
LEASE

FLOOR PLAN

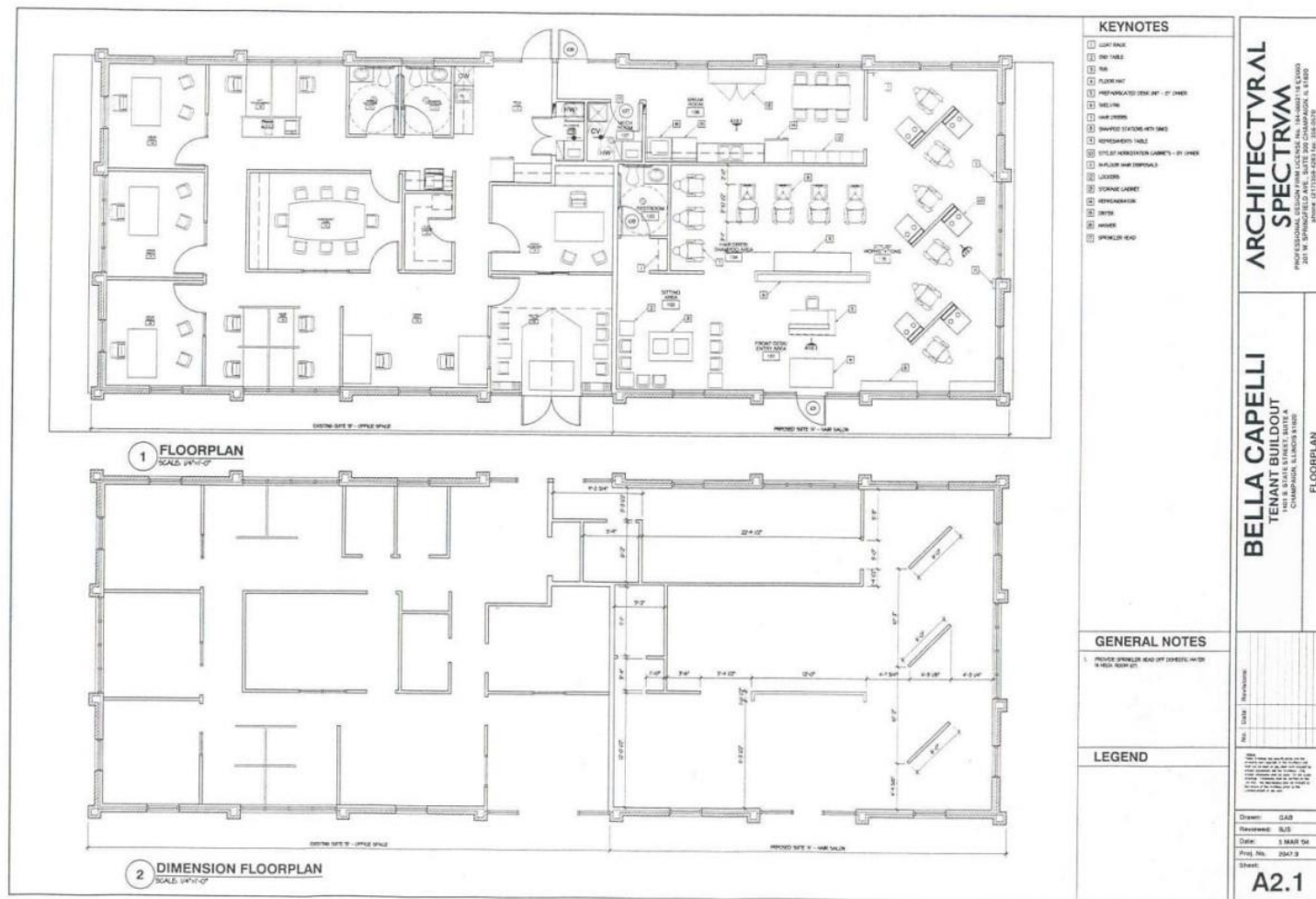

JAY SIKORSKI
217-352-7712
jas@cbcdr.com
cbcdr.com



**COLDWELL BANKER COMMERCIAL
DEVONSHIRE REALTY**

201 W Springfield Ave. 11th Floor
Champaign, IL 61820
217-352-7712

© 2020 Coldwell Banker Real Estate LLC, Coldwell Banker Commercial Affiliates. All Rights Reserved. Coldwell Banker Real Estate LLC, Coldwell Banker Commercial Affiliates fully supports the principles of the Equal Opportunity Act. Each Office is Independently Owned and Operated. Coldwell Banker Commercial and the Coldwell Banker Commercial Logo are registered service marks owned by Coldwell Banker Real Estate LLC, dba Coldwell Banker Commercial Affiliates.