

# 5 Points Commerce Centre



**COLDWELL  
BANKER  
COMMERCIAL**

DEVONSHIRE REALTY

510 Cunningham Dr.  
Urbana, IL 61802



AJ Thoma III, CCIM, SIOR  
217-403-3425  
ajt@cbcdr.com



# 5 Points Commerce Centre

## Property Description

Coldwell Banker Commercial Devonshire Realty (CBCDR) is proud to offer for lease 5 Points Commerce Centre is a 22,250 SF retail center that was constructed in 2007 and currently has two 1,500 SF suites available for lease (can be combined for a total of 3,000 SF). Suites 9 & 10 are available for immediate occupancy and have open floor plans with a restroom in the rear of the space.

5 Points Commerce Centre is located on the northeast corner of University Ave (21,300 VPD) & Vine St. (south)/Cunningham Ave (north) (19,900 VPD) behind Walgreen's. The immediate area has redeveloped within the last 20 years with retailers such as; Walgreens, McDonalds, Wendys, Domino's, Panda Express, and Jimmy John's to name a few. The property is just blocks from Carle Hospital and downtown Urbana.

## OVERVIEW

Address	510 N. Cunningham Ave Suite 9 & Suite 10 Urbana, IL
Lease Price	\$12.00/SF NNN
Available Space	1,500 SF – 3,000 SF
Building Size	22,250 SF
Zoning	B3 – General Business
Estimated NNN:	\$5.00/SF-2022



# 5 Points Commerce Centre



DEVONSHIRE REALTY

## SAMPLE FLOOR PLAN

### 5 Points Commerce Centre 510 N. Cunningham Sample Floor Plan Urbana, IL



DEVONSHIRE REALTY

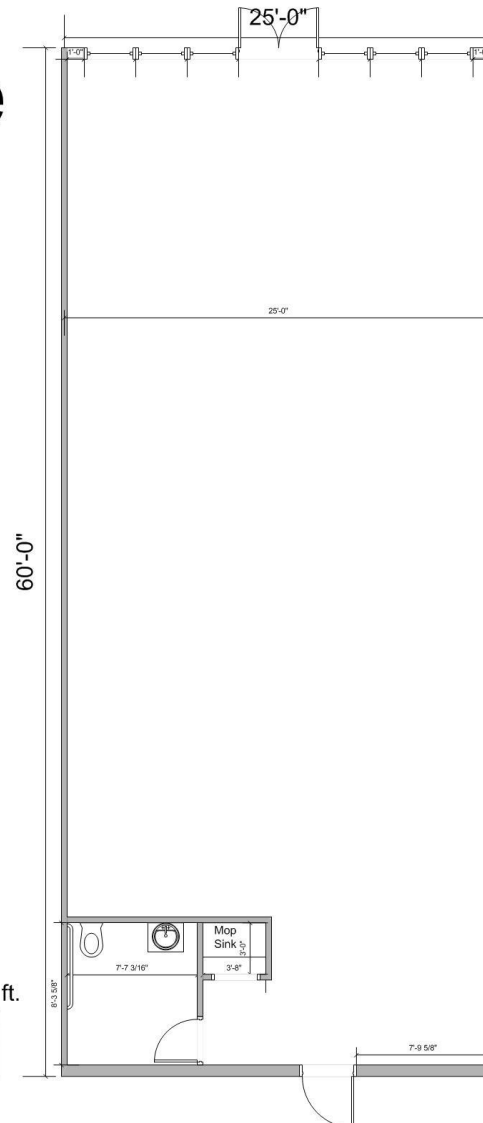
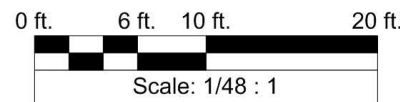

# 5 Points Commerce Centre



**COLDWELL  
BANKER  
COMMERCIAL**

DEVONSHIRE REALTY

## SITE PLAN

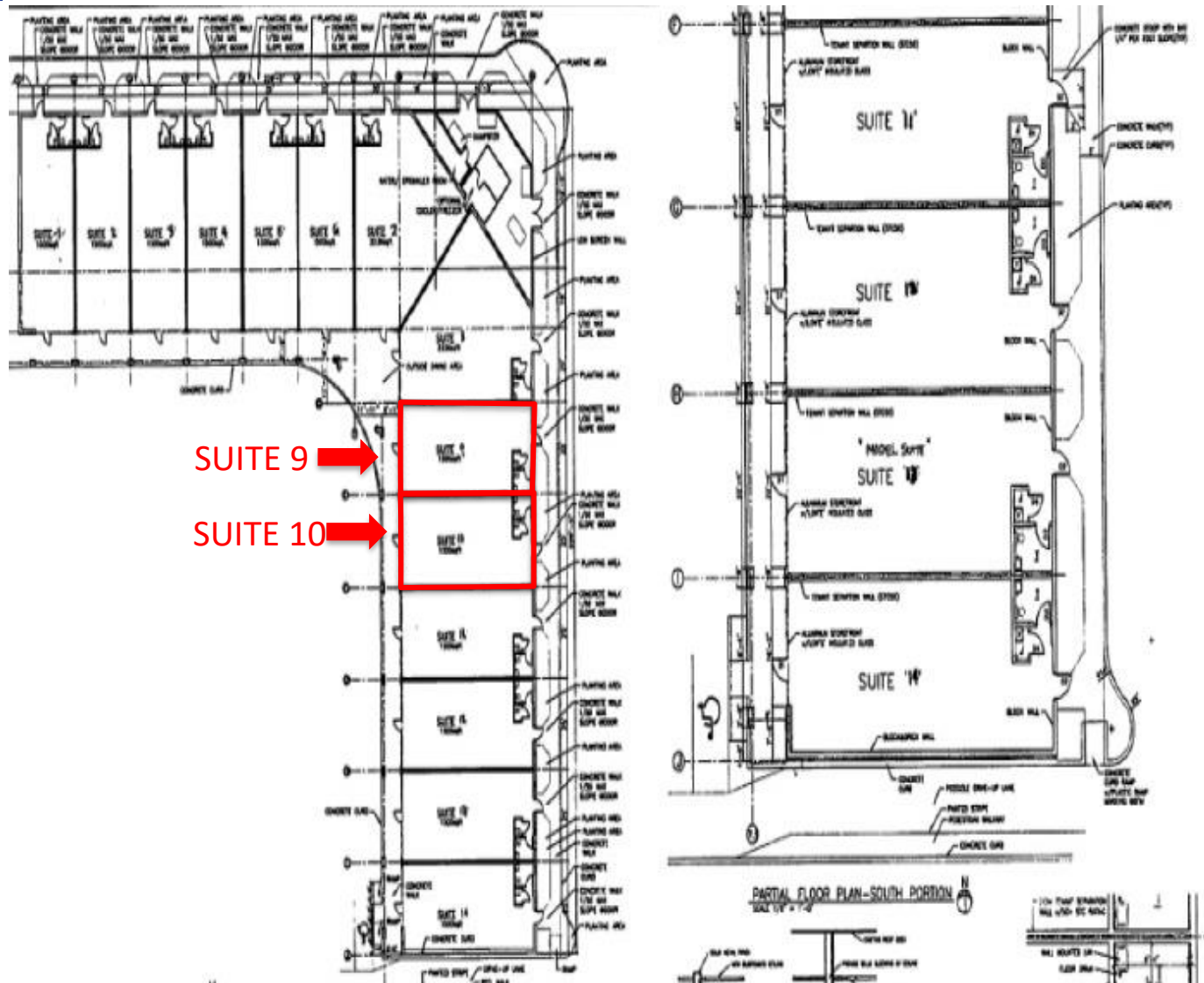

SUITE 9

SUITE 10

PARTIAL FLOOR PLAN-SOUTH PORTION  
SCALE 1/4" = 1'-0"



# 5 Points Commerce Centre



COLDWELL  
BANKER  
COMMERCIAL

DEVONSHIRE REALTY





# 5 Points Commerce Centre



## CONTACT INFORMATION



DEVONSHIRE REALTY

AJ Thoma III, CCIM, SIOR  
Vice President,  
Commercial Brokerage  
217-403-3425  
[ajt@cbcdr.com](mailto:ajt@cbcdr.com)



Coldwell Banker Commercial  
Devonshire Realty  
201 W. Springfield Ave. | 11<sup>th</sup> Floor  
Champaign, IL 61820  
217.352.7712