



**COLDWELL BANKER
COMMERCIAL**
DEVONSHIRE
REALTY

NEW CONSTRUCTION – MAHOMET OFFICE/RETAIL SPACE

\$20.00 / SF / GROSS

FOR LEASE



203 E. Oak Street

Mahomet, IL 61853

2,954 SF

OFFICE

RETAIL

LEASE PRICE

\$20.00 SF

LEASE TYPE

Gross

AVAILABLE SPACE

2,954 SF

YEAR BUILT

2023

TAX PIN

15-13-15-306-002

ZONING

C2 – General Commercial

PROPERTY DESCRIPTION

The project features 2,954 (divisible) square feet of first floor space fronting Oak Street. Tenants will benefit from the highly visible and accessible location and will have dedicated parking onsite. Target delivery date currently March 2023.

AREA DESCRIPTION

Mahomet is recognized as one of the fastest growing communities in Central Illinois. 203 Oak Street is conveniently located on a high access road and draws from a mix of nearby residents, retailers and businesses.



RICHARD HARRINGTON

217-403-0335

Richard.Harrington@cbcdr.com
cbcdr.com



**COLDWELL BANKER COMMERCIAL
DEVONSHIRE REALTY**

201 W Springfield Ave. 11th Floor
Champaign, IL 61820
217-352-7712

© 2022 Coldwell Banker. All Rights Reserved. Coldwell Banker and the Coldwell Banker logos are trademarks of Coldwell Banker Real Estate LLC. The Coldwell Banker® System is comprised of company owned offices which are owned by a subsidiary of Realogy Brokerage Group LLC and franchised offices which are independently owned and operated. The Coldwell Banker System fully supports the principles of the Fair Housing Act and the Equal Opportunity Act. Each sales representative and broker is responsible for complying with any consumer disclosure laws or regulations. Any services or products provided by independently owned and operated franchisees are not provided by, affiliated with or related to Coldwell Banker Real Estate LLC nor any of its affiliated companies. 2288K5_NAT_2/22



**COLDWELL BANKER
COMMERCIAL**
DEVONSHIRE
REALTY

NEW CONSTRUCTION – MAHOMET OFFICE/RETAIL SPACE

\$20.00 / SF / GROSS

**FOR
LEASE**

SITE PLAN

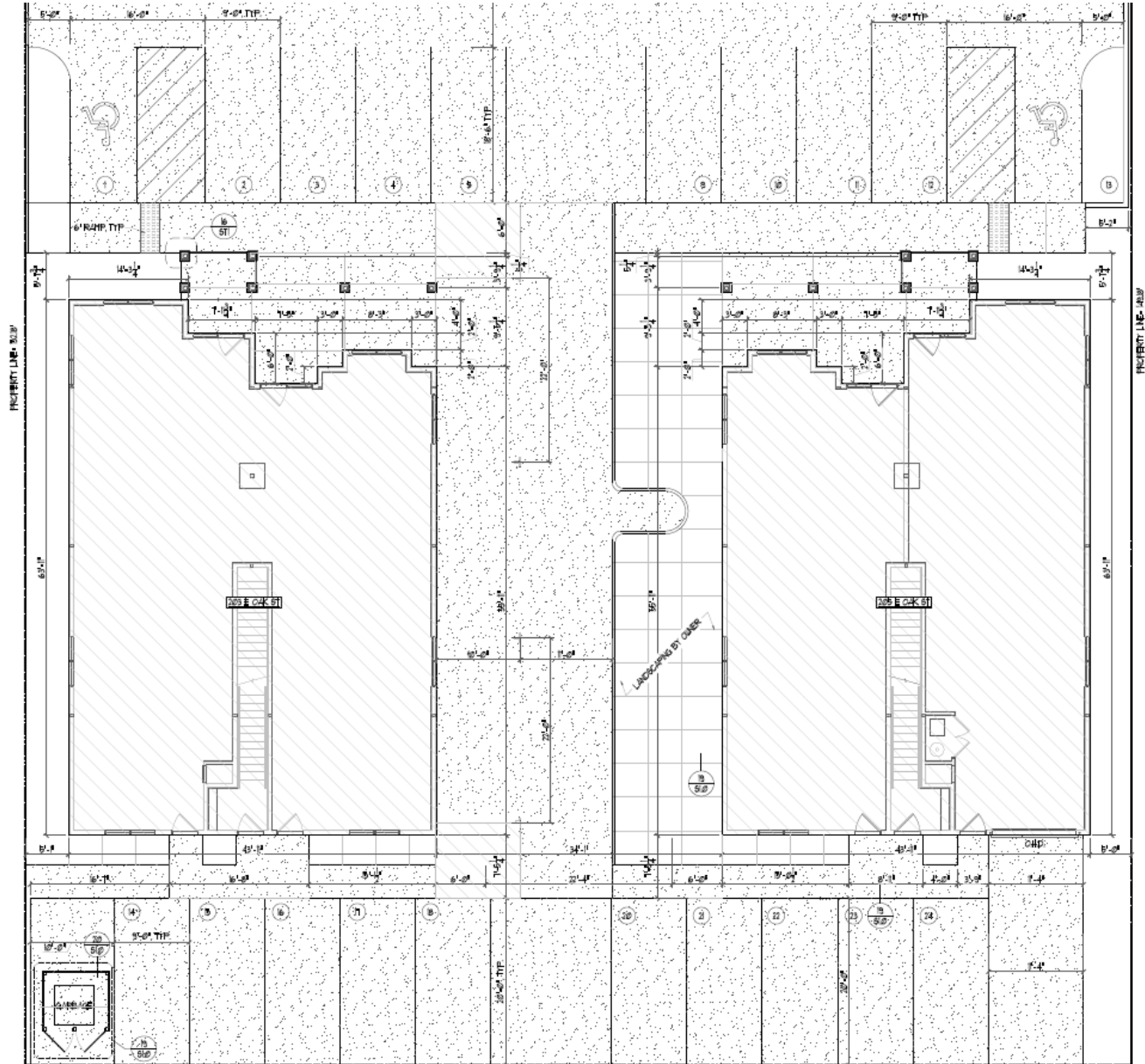

RICHARD HARRINGTON

217-403-0335

Richard.Harrington@cbcdr.com
cbcdr.com



**COLDWELL BANKER COMMERCIAL
DEVONSHIRE REALTY**

201 W Springfield Ave. 11th Floor
Champaign, IL 61820
217-352-7712

© 2022 Coldwell Banker. All Rights Reserved. Coldwell Banker and the Coldwell Banker logos are trademarks of Coldwell Banker Real Estate LLC. The Coldwell Banker® System is comprised of company owned offices which are owned by a subsidiary of Realogy Brokerage Group LLC and franchised offices which are independently owned and operated. The Coldwell Banker System fully supports the principles of the Fair Housing Act and the Equal Opportunity Act. Each sales representative and broker is responsible for complying with any consumer disclosure laws or regulations. Any services or products provided by independently owned and operated franchisees are not provided by, affiliated with or related to Coldwell Banker Real Estate LLC nor any of its affiliated companies. 2288K5_NAT_2/22



COLDWELL BANKER
COMMERCIAL
DEVONSHIRE
REALTY

NEW CONSTRUCTION – MAHOMET OFFICE/RETAIL SPACE

\$20.00 / SF / GROSS

FOR
LEASE

SITE AERIAL

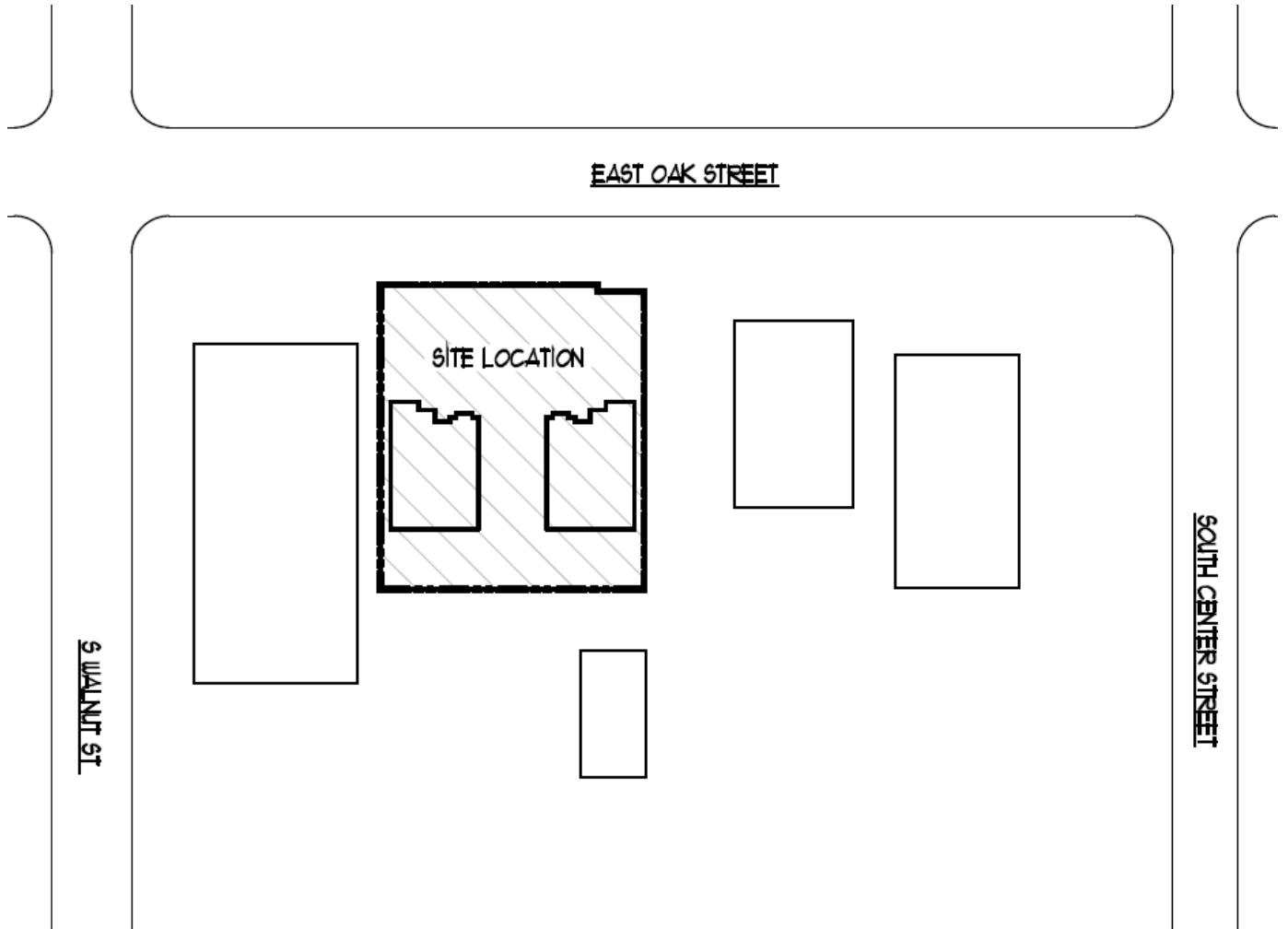

RICHARD HARRINGTON

217-403-0335

Richard.Harrington@cbcdr.com
cbcdr.com



**COLDWELL BANKER COMMERCIAL
DEVONSHIRE REALTY**

201 W Springfield Ave. 11th Floor
Champaign, IL 61820
217-352-7712

© 2022 Coldwell Banker. All Rights Reserved. Coldwell Banker and the Coldwell Banker logos are trademarks of Coldwell Banker Real Estate LLC. The Coldwell Banker® System is comprised of company owned offices which are owned by a subsidiary of Realogy Brokerage Group LLC and franchised offices which are independently owned and operated. The Coldwell Banker System fully supports the principles of the Fair Housing Act and the Equal Opportunity Act. Each sales representative and broker is responsible for complying with any consumer disclosure laws or regulations. Any services or products provided by independently owned and operated franchisees are not provided by, affiliated with or related to Coldwell Banker Real Estate LLC nor any of its affiliated companies. 2288K5_NAT_2/22