

7,500 SF RETAIL OPPORTUNITY ADJACENT TO TARGET | PERU, IL



**COLDWELL BANKER
COMMERCIAL**
DEVONSHIRE
REALTY



4361 Venture Dr.
Peru, IL 61354



**COLDWELL BANKER
COMMERCIAL**

DEVONSHIRE
REALTY

COLDWELL BANKER COMMERCIAL DEVONSHIRE REALTY | CHAMPAIGN, IL | 217.352.7712

This information has been secured from sources we believe to be reliable, but we make no representations or warranties, expressed or implied, as to the accuracy of the information. References to square footage or age are approximate. Buyer must verify the information and bears all risk for any inaccuracies.

CONFIDENTIAL INVESTMENT SUMMARY



**COLDWELL BANKER
COMMERCIAL**
DEVONSHIRE
REALTY

This Confidential Investment Summary ("CIS") is provided by Coldwell Banker Commercial Devonshire Realty ("CBCDR"), solely for your consideration of the opportunity to acquire the commercial property described herein (the "Property"). This CIS may be used only as stated herein and shall not be used for any other purpose, or in any other manner, without prior written authorization and consent of CBCDR.

This CIS does not constitute or pertain to an offer of a security or an offer of any investment contract. This CIS contains descriptive materials, financial information and other data compiled by CBCDR for the convenience of parties who may be interested in the Property. Such information is not all inclusive and is not represented to include all information that may be material to an evaluation of the acquisition opportunity presented. CBCDR has not independently verified any of the information contained herein and makes no representations or warranties of any kind concerning the accuracy or completeness thereof. All summaries and discussions of documentation and/or financial information contained herein are qualified in their entirety by reference to the actual documents and/or financial statements, which upon request may be made available. An interested party must conduct its own independent investigation and verification of any information the party deems material to consideration of the opportunity, or otherwise appropriate, without reliance upon CBCDR.

The Property may be financed or withdrawn from the market without notice, and its owner(s) reserve(s) the right to negotiate with any number of interested parties at any time. The Property is offered and sold by its owner(s) as is, where is, and with all faults, without representation or warranty of any kind except for any customary warranties of title.

BY ACCEPTING THIS CIS, YOU AGREE THAT: (1) all information contained herein, and all other information you have received or may hereafter receive from CBCDR relating to the Property, whether oral, written or in any other form (collectively, the "Information"), is strictly confidential; (2) you will not copy or reproduce, and claim as your own without attribution to CBCDR, all or any part of this CIS or the Information; (3) upon request by CBCDR at any time, you will return and/or certify your complete destruction of all copies of this CIS and the Information; (4) for yourself and all your affiliates, officers, employees, representatives, agents and principals, you hereby release and agree to indemnify and hold harmless CBCDR all of its affiliates, officers, employees, representatives, agents and principals, from and with respect to any and all claims and liabilities arising from or related to the receipt or use of this CIS and/or any other Information concerning the Property; (5) you will not provide this CIS or any of the Information to any other party unless you first obtain such party's acceptance and approval of all terms, conditions, limitations and agreements set forth herein, as being applicable to such party as well as to you; and (6) monetary damages alone will not be an adequate remedy for a violation of these terms and that CBCDR shall be entitled to equitable relief, including, but not limited to, injunctive relief and specific performance, in connection with such a violation and shall not be required to post a bond when obtaining such relief.

THE OFFERING



**COLDWELL BANKER
COMMERCIAL**
DEVONSHIRE
REALTY

Lease Price	\$15.00/ SF
Lease Type	NNN
Available Space	7,521 SF
Zoning	B-2 Community Shopping District
Parking Spaces	56 Spaces
Tenancy	Multiple
Traffic Counts	Venture Dr - 3,050 AADT IL RT 251 - 14,200 AADT

Strategically positioned directly opposite of Target and Home Depot, the property consists of a 15,166 square foot multi-tenant retail building situated on over 2 acres, prominently located along Venture Drive. The asset features modern construction, strong frontage, and high visibility within one of the most trafficked retail corridors in the market. Existing tenancy includes established national retailers, providing proven performance and consumer draw to the site.

The available 7,500 square foot space offers flexible configuration suitable for a range of retail, service, or medical users. The suite benefits from ample parking, convenient ingress/egress, and strong signage opportunities. Its positioning within a dominant power center environment makes it ideal for tenants seeking regional exposure, co-tenancy with national brands, and access to a stable consumer base.

OFFERING HIGHLIGHTS

- Prime location in Peru's main retail corridor
- Adjacent to national anchor tenants
- Excellent visibility and easy access
- Flexible 7,500 SF leasable space
- Strong and stable regional customer base



INTERIOR IMAGES



**COLDWELL BANKER
COMMERCIAL**
DEVONSHIRE
REALTY



This information has been secured from sources we believe to be reliable, but we make no representations or warranties, expressed or implied, as to the accuracy of the information. References to square footage or age are approximate. Buyer must verify the information and bears all risk for any inaccuracies.

COLDWELL BANKER COMMERCIAL DEVONSHIRE REALTY | CHAMPAIGN, IL | 217.352.7712

AREA PROFILE



**COLDWELL BANKER
COMMERCIAL**
DEVONSHIRE
REALTY

4361 Venture Drive is strategically positioned within the primary retail corridor of Peru, Illinois, serving as the dominant commercial hub for the greater Illinois Valley region. The property benefits from immediate proximity to national anchors including Target and The Home Depot, as well as its location near the Peru Mall, historically the area's central retail destination. This corridor draws consumers from a broad trade area including La Salle, Oglesby, Spring Valley, and Ottawa, supported by convenient access to Interstate 80 and strong regional traffic patterns.



This information has been secured from sources we believe to be reliable, but we make no representations or warranties, expressed or implied, as to the accuracy of the information. References to square footage or age are approximate. Buyer must verify the information and bears all risk for any inaccuracies.

COLDWELL BANKER COMMERCIAL DEVONSHIRE REALTY | CHAMPAIGN, IL | 217.352.7712

AERIAL



**COLDWELL BANKER
COMMERCIAL**
DEVONSHIRE
REALTY



IL RT 251 - 14,200
AADT



Interstate 80



SITE



HOBBY LOBBY

This information has been secured from sources we believe to be reliable, but we make no representations or warranties, expressed or implied, as to the accuracy of the information. References to square footage or age are approximate. Buyer must verify the information and bears all risk for any inaccuracies.

REGIONAL MAP



**COLDWELL BANKER
COMMERCIAL**
DEVONSHIRE
REALTY

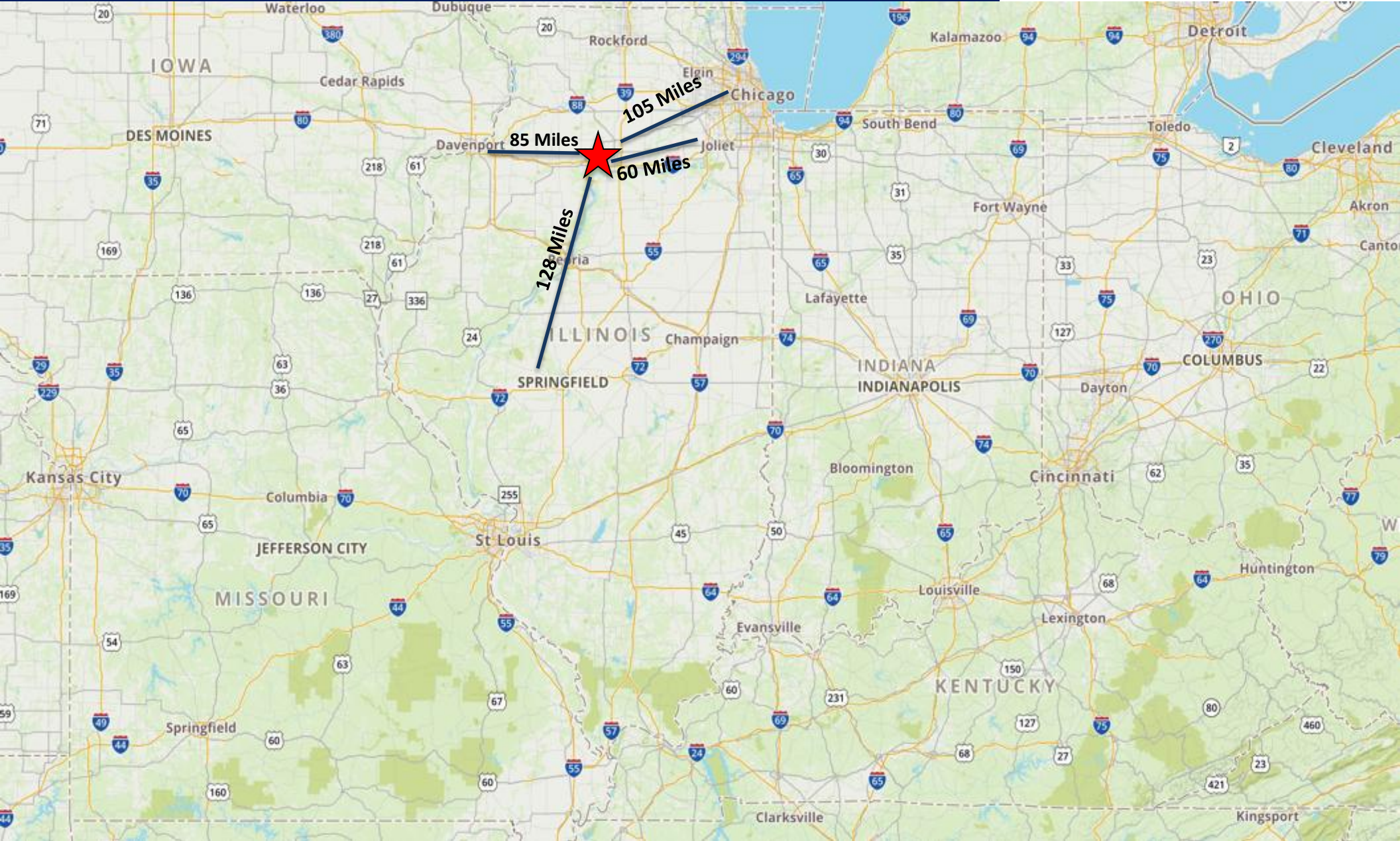

This information has been secured from sources we believe to be reliable, but we make no representations or warranties, expressed or implied, as to the accuracy of the information. References to square footage or age are approximate. Buyer must verify the information and bears all risk for any inaccuracies.

COLDWELL BANKER COMMERCIAL DEVONSHIRE REALTY | CHAMPAIGN, IL | 217.352.7712

REGIONAL MAP



**COLDWELL BANKER
COMMERCIAL**
DEVONSHIRE
REALTY

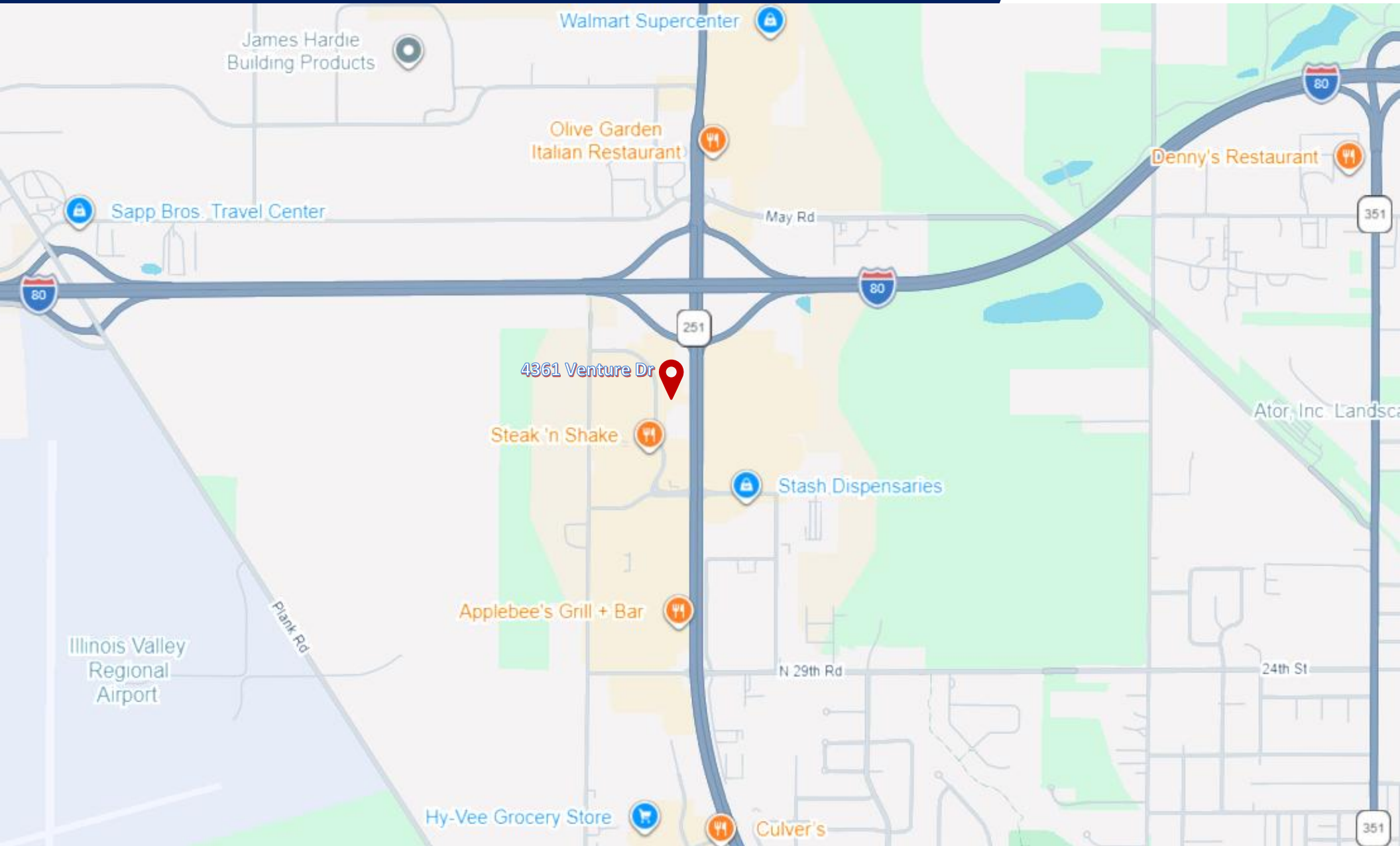

This information has been secured from sources we believe to be reliable, but we make no representations or warranties, expressed or implied, as to the accuracy of the information. References to square footage or age are approximate. Buyer must verify the information and bears all risk for any inaccuracies.

COLDWELL BANKER COMMERCIAL DEVONSHIRE REALTY | CHAMPAIGN, IL | 217.352.7712

FLOOR PLAN



**COLDWELL BANKER
COMMERCIAL**
DEVONSHIRE
REALTY

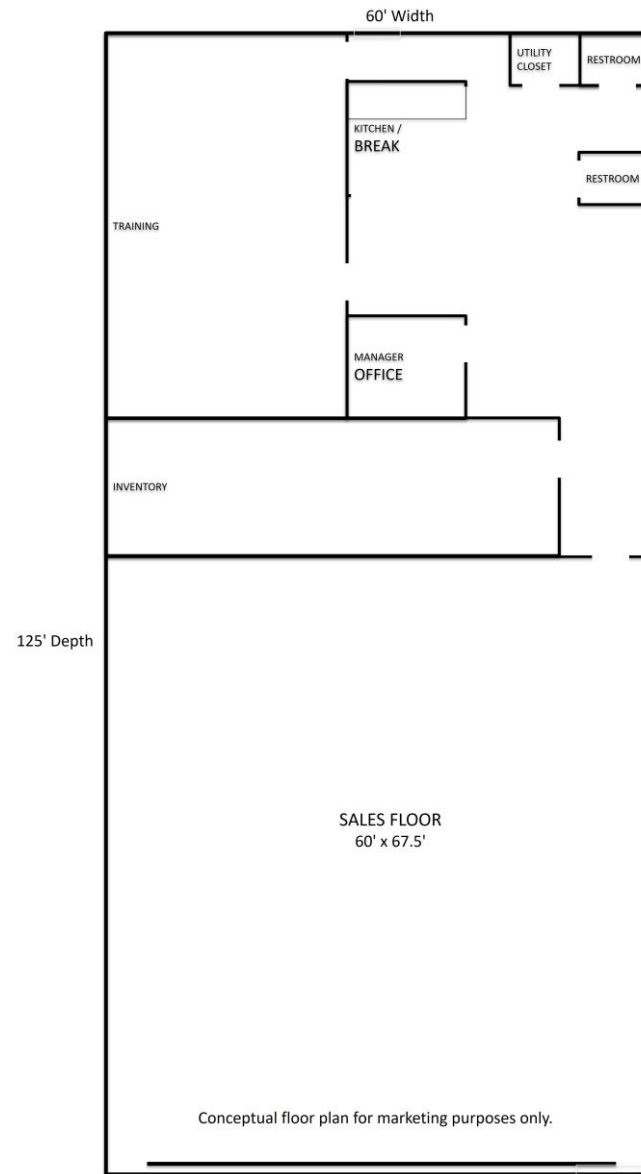

This information has been secured from sources we believe to be reliable, but we make no representations or warranties, expressed or implied, as to the accuracy of the information. References to square footage or age are approximate. Buyer must verify the information and bears all risk for any inaccuracies.

DEMOGRAPHIC DATA



**COLDWELL BANKER
COMMERCIAL**
DEVONSHIRE
REALTY

POPULATION

	1-MILES	2-MILES	3-MILES
2020 Population (Census)	394	8,192	20,099
2025 Population	387	7,807	19,534
2030 Population (Projected)	385	7,761	19,374

HOUSEHOLDS

	1-MILES	2-MILES	3-MILES
2020 Housing Units	175	3,563	8,758
2025 Households	172	3,400	8,518
2030 Households (Projected)	171	3,380	8,449

INCOME

	1-MILES	2-MILES	3-MILES
2025 Per Capita Income	\$49,406	\$42,232	\$37,024
2025 Avg. HH Income	\$111,347	\$96,988	\$84,903
2025 Median HH Income	\$75,215	\$76,360	\$70,492

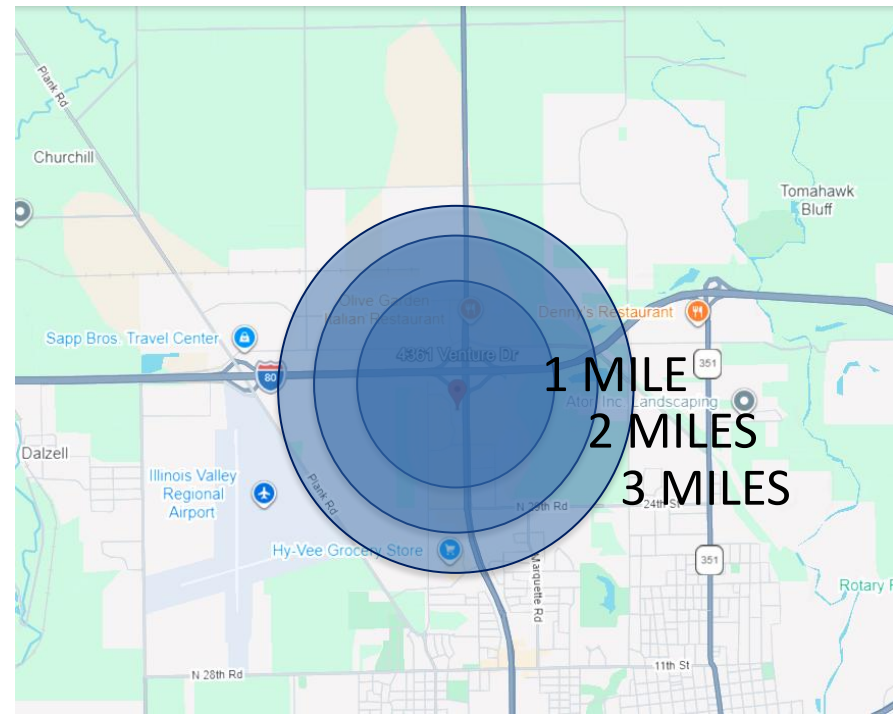

This information has been secured from sources we believe to be reliable, but we make no representations or warranties, expressed or implied, as to the accuracy of the information. References to square footage or age are approximate. Buyer must verify the information and bears all risk for any inaccuracies.

CONTACT INFORMATION



**COLDWELL BANKER
COMMERCIAL**
DEVONSHIRE
REALTY



Nick Ragle
217.403.3379
Nick.ragle@cbcdr.com



Coldwell Banker Commercial
Devonshire Realty
201 W. Springfield Ave. | 11th Floor
Champaign, IL 61820
217.352.7712

COLDWELL BANKER COMMERCIAL DEVONSHIRE REALTY | CHAMPAIGN, IL | 217.352.7712

This information has been secured from sources we believe to be reliable, but we make no representations or warranties, expressed or implied, as to the accuracy of the information. References to square footage or age are approximate. Buyer must verify the information and bears all risk for any inaccuracies.