

**APPENDIX**

**NATIONWIDE 404 PERMIT**

**Georgia Department of Natural Resources  
Requirements and Notification Procedures  
Nationwide Permit Projects**

State of Georgia Buffer Requirements. Nationwide Permit (NWP) authorized projects may require a variance from the Georgia Environmental Protection Division (EPD) prior to conducting land disturbing activities or placement of materials within the State-mandated buffer (O.C.G.A. 12-7-6(b)(15) of “The Erosion and Sedimentation Act of 1975”). Please visit Georgia EPD’s website (<http://www.gaepd.org/>), or contact Georgia EPD at (404) 675-6240 or (912) 264-7284 (Coastal District), for further guidance on buffer determinations and variances. If Georgia EPD or the appropriate Local Issuing Authority (LIA) has determined that a buffer variance is required for the NWP project, provide the Georgia EPD assigned buffer variance application file number with your notification to Georgia EPD. If Georgia EPD or the appropriate LIA has determined that a buffer variance is not required for the NWP project, submit the determination letter or record of correspondence received from the Georgia EPD or LIA with your notification to Georgia EPD.

Notification Requirements. For uses of NWPs requiring submission of a Pre-Construction Notification (PCN) to the Savannah District prior to commencing work in waters of the United States (US), a copy of the PCN with project plans must also be submitted to the Georgia Department of Natural Resources (DNR), Environmental Protection Division (EPD) and, where applicable, to the Georgia DNR, Coastal Resources Division (CRD). For NWP authorized projects that do not require submission of a PCN to the Savannah District, a completed copy of the attached “Georgia Department of Natural Resources Notification Form” must be submitted to Georgia EPD and, where applicable, to Georgia CRD, prior to commencing work.

Georgia DNR, Environmental Protection Division. For projects located in Georgia EPD’s 24-County Coastal District (Appling, Atkinson, Bacon, Brantley, Bryan, Bulloch, Camden, Candler, Charlton, Chatham, Clinch, Coffee, Effingham, Evans, Glynn, Jeff Davis, Liberty, Long, McIntosh, Pierce, Tattnall, Toombs, Ware and Wayne County), send PCNs and project plans or Notification Forms to: Georgia DNR Environmental Protection Division, Coastal District, Attention: Wetland Management Unit, 400 Commerce Center Drive, Brunswick, GA 31523-8251, Phone: (912) 261-3924, Fax: (912) 262-3160.

For projects in all other counties, send PCNs and project plans or Notification Forms to: Georgia DNR Environmental Protection Division, Attention: Wetland Management Unit 4220 International Parkway, Suite 101, Atlanta, GA 30354-3902, Phone: (404) 675-1752 Fax: (404) 675-6244.

Georgia DNR, Coastal Resources Division. For projects located in the 11-County Coastal Area (Bryan, Brantley, Camden, Charlton, Chatham, Effingham, Glynn, Liberty, Long, McIntosh and Wayne Counties), send PCNs and project plans or Notification Forms to: Georgia DNR Coastal Resources Division, Attention: Habitat Management Program Manager, One Conservation Way, Brunswick, Georgia 31520-8686, Phone: (912) 264-7218, Fax: (912) 262-3131.

**GEORGIA DEPARTMENT OF NATURAL RESOURCES NOTIFICATION FORM**  
**FOR USE OF NATIONWIDE PERMIT(S) IN GEORGIA THAT DO NOT REQUIRE**  
**PRE-CONSTRUCTION NOTIFICATION TO THE US ARMY CORPS OF ENGINEERS**

This form must be completed and mailed, faxed or hand-delivered to the Georgia Department of Natural Resources ("GADNR") Environmental Protection Division prior to starting construction under a Nationwide Permit. For projects occurring in Bryan, Brantley, Camden, Charlton, Chatham, Effingham, Glynn, Liberty, Long, McIntosh or Wayne counties, this form must also be mailed, faxed or hand-delivered to the GADNR Coastal Resources Division prior to starting construction under a Nationwide Permit. The Coastal Resources Division will contact you within 10 business days to inform you whether coastal permits or permissions are required. Issuance of any required coastal permits for work in tidally-influenced marshes or water bottoms will take longer, so you are urged to submit this form early in the planning stages of your project. Do not begin work until you receive confirmation that no coastal permit is required or you are issued a coastal permit.

USE OF NATIONWIDE PERMIT NUMBER(s) NWP 3(a)

APPLICANT/OWNER Karyn Matthews for Cobb County DOT Date 10/25/18

Phone (hm/bus) (770) 528-3685 FAX \_\_\_\_\_ E-Mail karyn.matthews@cobbcounty.org

Address 1890 County Services Pkwy City Marietta State GA Zip Code 30008

AGENT/CONSULTANT Karsen Schottleutner for Moreland Altobelli Associates LLC

Phone (hm/bus) (770) 263-5945 FAX \_\_\_\_\_ E-Mail kschottleutner@maai.net

Address 2450 Commerce Avenue City Duluth State GA Zip Code 30096

PROJECT LOCATION/ADDRESS: Near 2306 Powers Ferry Drive SE

City Marietta County Cobb Subdivision \_\_\_\_\_ Lot \_\_\_\_\_

Latitude/Longitude (if known): 33.930070/-84.486118 Project Impacts (ft<sup>2</sup>) 566.28 (acres) 0.013

Stream Impacts (LF) 42.4 Wetland Impacts (acres) N/A

Type of Wetland: [ ] freshwater [ ] tidal marsh or saltwater [ ] unknown

Nearest Named Stream, River or Other Waterbody: Powers Creek (Upper Chattahoochee River Watershed)

This activity may require a variance from Georgia EPD prior to conducting land disturbance activities or placing materials within the State-mandated buffer [see O.C.G.A. § 12-7-6(b)(15-16) of "The Erosion and Sedimentation Act of 1975," and visit [www.gaepd.org](http://www.gaepd.org) for more information]. Has Georgia EPD or the appropriate Local Issuing Authority (LIA) determined whether or not a buffer variance is required? Yes \_\_\_\_\_ No X

If Georgia EPD or the appropriate LIA has determined that a buffer variance is NOT required for this project, please attach a determination letter or record of correspondence from Georgia EPD or the LIA to this form. If a buffer variance is required, please provide the buffer variance application number: \_\_\_\_\_

PROJECT DESCRIPTION The proposed project would replace existing 37' long X 33' wide bridge structure along Powers Ferry Drive SE over Powers Creek with a triple 8' X 8' concrete box culvert and add rip-rap along both banks at the outfall. The proposed project would also provide stormwater drainage improvements.

CONTROL POINTS						
POINT NAME	NORTHING	EASTING	ELEVATION	DESCRIPTION	STA	OFFSET
CD2	1429772.9800	2199468.2575	937.508	242S2*NAIL	11+14.29	15.97' RT
CD3	1429771.9227	2199728.9070	933.977	242S3*MAGNAIL	13+71.06	11.55' LT
CD4	1429738.9835	2199920.8045	935.712	242S4*NAIL	15+63.51	17.98' RT

 50' X 50' Exemption Area

■ 25' State Buffer

## Water Impacts

Replacement of bridge with culvert:  
42.4 linear feet (0.013 acre)

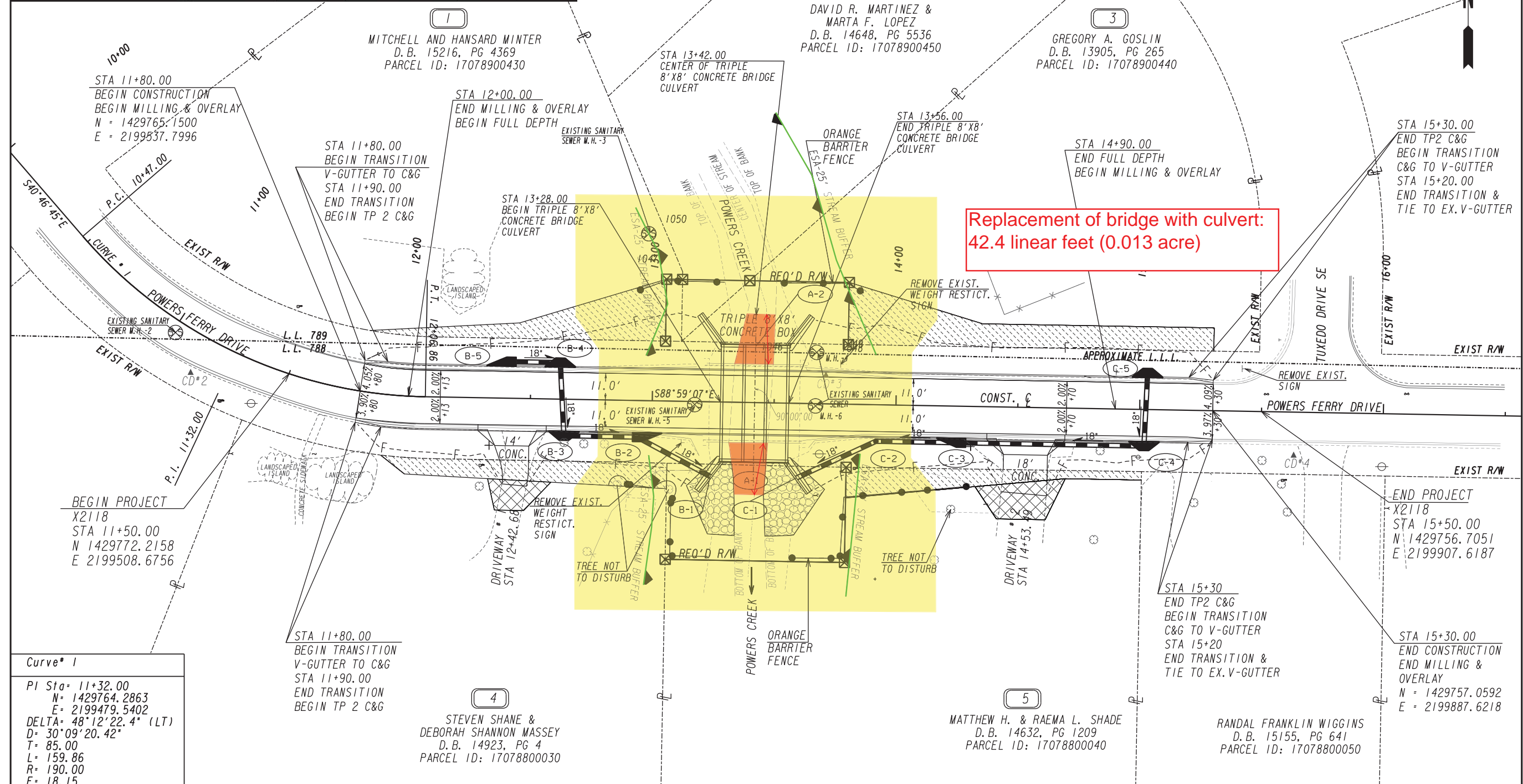

---

*Curve\* 1*

*PI* *Sta* = 11+32.00  
*N* = 1429764.2863  
*E* = 2199479.5402  
*DELTA* = 48°12'22.4" (LT)  
*D* = 30°09'20.42"  
*T* = 85.00  
*L* = 159.86  
*R* = 190.00  
*E* = 18.15

PROPERTY AND EXISTING R/W LINE  
REQUIRED R/W LINE  
CONSTRUCTION LIMITS  
EASEMENT FOR CONSTR  
& MAINTENANCE OF SLOPES  
EASEMENT FOR CONSTR OF SLOPES  
EASEMENT FOR CONSTR OF DRIVES

BEGIN LIMIT OF ACCESS.....  
END LIMIT OF ACCESS.....  
LIMIT OF ACCESS  
REQ'D R/W & LIMIT OF ACCESS  
ORANGE BARRIER FENCE  
ESA - ENV. SENSITIVE AREA  
(SEE ERIT TABLE)

STEVEN SHANE &  
DEBORAH SHANNON MASSEY  
D.B. 14923, PG 4  
PARCEL ID: 17078800030



SCALE IN FEET



REVISION DATES

**CONSTRUCTION PLAN**  
POWERS FERRY DRIVE OVER POWERS CREEK  
BRIDGE REPLACEMENT

CHECKED:		DATE:	
BACKCHECKED:		DATE:	
CORRECTED:		DATE:	
VERIFIED:		DATE:	

DRAWING No.  
3-0001



Powers Ferry Drive Southeast;  
facing east (taken 10/19/18)



Powers Ferry Drive Southeast;  
facing west (taken 10/19/18)



Powers Creek (PS 1) looking  
downstream; facing south (taken  
10/19/18)



Powers Creek (PS 1) looking  
upstream; facing north (taken  
10/19/18)

PS 1

# NC DWQ Stream Identification Form Version 4.11

Date: 10-19-18	Project/Site: Powers Ferry	Latitude: 33.930102
Evaluator: KS & MA	County: Cobb	Longitude: -84.486065
Total Points: Stream is at least intermittent if $\geq 19$ or perennial if $\geq 30^*$	Stream Determination (circle one) Ephemeral Intermittent <u>Perennial</u>	Other Powers Creek e.g. Quad Name:

## A. Geomorphology (Subtotal = 18)

	Absent	Weak	Moderate	Strong
1 <sup>a</sup> . Continuity of channel bed and bank	0	1	2	3
2. Sinuosity of channel along thalweg	0	1	2	3
3. In-channel structure: ex. riffle-pool, step-pool, ripple-pool sequence	0	1	2	3
4. Particle size of stream substrate	0	1	2	3
5. Active/relict floodplain	0	1	2	3
6. Depositional bars or benches	0	1	2	3
7. Recent alluvial deposits	0	1	2	3
8. Headcuts	0	1	2	3
9. Grade control	0	0.5	1	1.5
10. Natural valley	0	0.5	1	1.5
11. Second or greater order channel	No = 0		Yes = 3	

<sup>a</sup> artificial ditches are not rated; see discussions in manual

## B. Hydrology (Subtotal = 10)

12. Presence of Baseflow	0	1	2	3
13. Iron oxidizing bacteria	0	1	2	3
14. Leaf litter	1.5	1	0.5	0
15. Sediment on plants or debris	0	0.5	1	1.5
16. Organic debris lines or piles	0	0.5	1	1.5
17. Soil-based evidence of high water table?	No = 0		Yes = 3	

## C. Biology (Subtotal = 6)

18. Fibrous roots in streambed	3	2	1	0
19. Rooted upland plants in streambed	3	2	1	0
20. Macroinvertebrates (note diversity and abundance)	0	1	2	3
21. Aquatic Mollusks	0	1	2	3
22. Fish	0	0.5	1	1.5
23. Crayfish	0	0.5	1	1.5
24. Amphibians	0	0.5	1	1.5
25. Algae	0	0.5	1	1.5
26. Wetland plants in streambed	FACW = 0.75; OBL = 1.5 Other = 0			

\*perennial streams may also be identified using other methods. See p. 35 of manual.

Notes:

Sketch:

W 3-7 / 6-10  
D 6" / 4-6

bamboo  
chinese privet