

# SEWELL MILL LIBRARY & CULTURAL CENTER

## **RENTAL FACILITY FOR**

**CONCERTS**

**PLAYS**

**DANCE RECITALS**

**MUSIC RECITALS**

**MUSICALS**

**ART RELATED PROGRAMS**



[www.cobbparks.org](http://www.cobbparks.org)

2051 Lower Roswell Road  
Marietta, GA 30068

770-509-2711





## SEWELL MILL CULTURAL CENTER

### BLACK BOX

Stage Dimensions: Length 29'  
Width 17'  
Wall to Traveling Curtain 2'

Black Box Theater: 80-120 seats

Large projector screen available

Roll up door for easy loading in

A full complement of audio visual equipment in upper sound booth.

### PARKING

Free on-site parking with overflow top lot parking available.

### LOBBY

Concession kitchen available for rent

TV monitors for advertising

Merchandise area available

### OUTDOOR AMPHITHEATER

Stage Dimensions:

Width 29' 11" Length 47' 11"

Seating: 150 approximately

Singular row of fixed stage lights

Additional lights and sound equipment must be provided by renter.

## EXCELLENCE GROWS HERE

Sewell Mill Library & Cultural Center (SML & CC) is a Cobb County tax-supported Library & Arts facility. This unique hybrid facility falls under the Cobb County PARKS as well as the Cobb Library system. While these 2 entities are separate, the partnership between PARKS and the Cobb Library System unifies community resources to maximize the accessibility of individual amenities.

- We provide educational services in visual and performing arts in Cobb County.
- The Sewell Mill Cultural Center has both a Black Box Theater and an outdoor Amphitheater, each with access to 2 dressing rooms.
- You'll also find two multipurpose art classrooms; a pottery studio, an art gallery, and a café area.



# SEWELL MILL CULTURAL CENTER



## BLACK BOX & OUTDOOR AMPHITHEATER RENTAL RATE:

Refundable Damage Rental Deposit:	\$150 per rental
Cobb Resident Hourly:	\$50 per hour (4 hour minimum)
Non-Resident Hourly:	\$75 per hour (4 hour minimum)
Daily Rehearsal Rental Cobb Resident:	\$250 (10am-10pm)
Daily Rehearsal Rental Non-Resident:	\$375 (10am-10pm)
Daily Performance Rental Cobb Resident:	\$300 (10am-10:30pm)
Daily Performance Rental Non-Resident:	\$450 (10am-10:30pm)
AV Tech Fees Cobb Resident:	\$30 per hour (4 hour minimum)
AV Tech Fees Non-Resident:	\$30 per hour (4 hour minimum)



2051 Lower Roswell Road  
Marietta, GA 30068  
770-509-2711  
[Cobbcounty.org/sewellmill](http://Cobbcounty.org/sewellmill)



# SEWELL MILL CULTURAL CENTER

## ADDITIONAL RENTAL RATES:

Refundable Damage Deposit	\$150 per rental
Arts Classroom Cobb Resident	\$50 per hour (4 hour minimum)
Arts Classroom Non-Resident	\$75 per hour (4 hour minimum)
Concession Stand Cobb Resident	\$25 per hour (4 hour minimum)
Concession Stand Non-Resident	\$37.50 per hour (4 hour minimum)

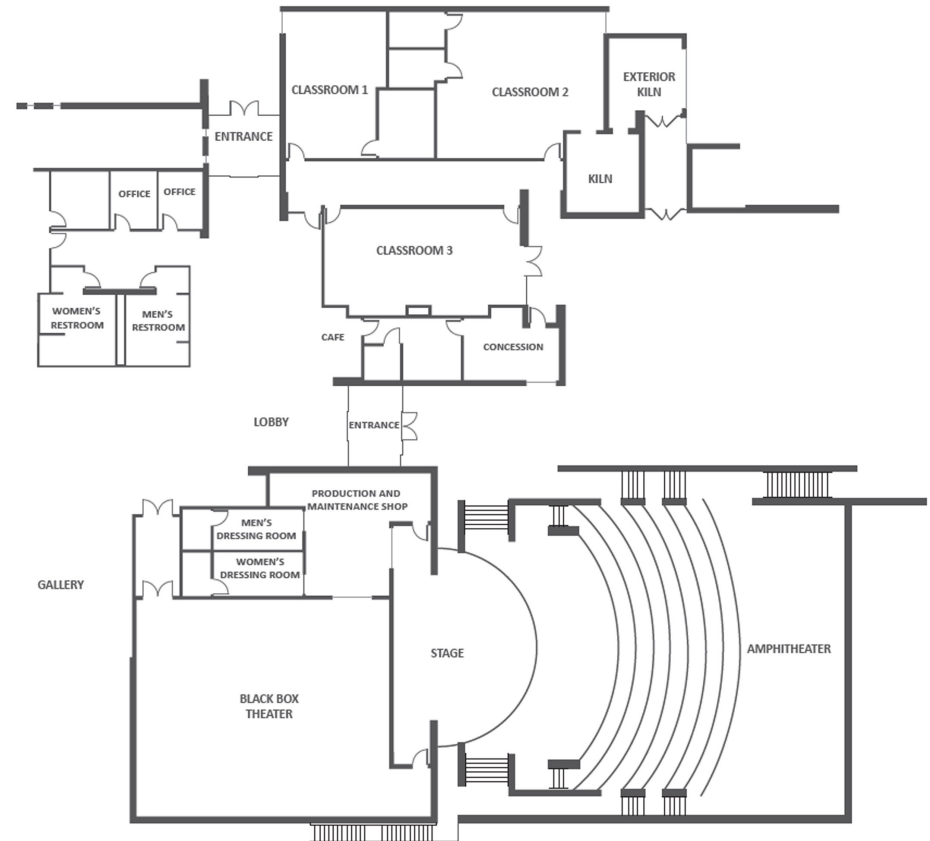
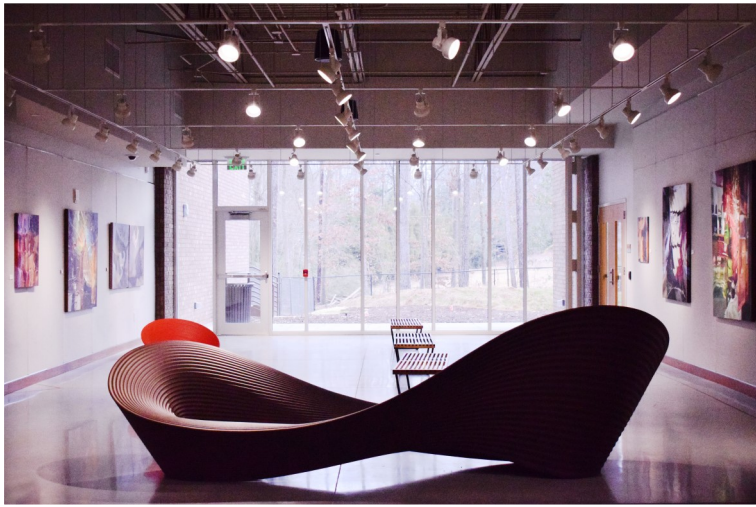

## Cancellation and Refund Policy:

The \$150 refundable deposit is due at the time of booking. Non-Consecutive days require new permit and new deposit. The \$150 is refundable if cancellation is made prior to 30 days of rental. If cancellation is made under the 30 days, deposit is forfeit. All rental fees, including AV Tech, must be paid in full 30 days before move in date of rental. Failure to pay in full will result in cancellation of rental and forfeit of deposit. If facility is not found in a clean and damage free state, deposit is forfeit.



2051 Lower Roswell Road  
Marietta, GA 30068  
770-509-2711  
[Cobbcounty.org/sewellmill](http://Cobbcounty.org/sewellmill)