

C-IFMC-LX-1SC2

2 10/100Base-TX(RJ-45) to 1 100Base-LX(SC) SMF 1310nm 20km Industrial Media Converter Switch

Features

- All-aluminum Case, Compact and Fanless Design
- Full/Half-duplex self-adaptation
- MDI/MDIX automatic recognition
- Optionally support IEEE 802.3af/at/bt PoE Standard, without damaging not-PoE devices.
- Operating Temperature from -40 to 75°C
- Dual Redundant DC9~56V power input
- Support power input polarity protection; no worries about the reverse connection
- Aluminum shell, fanless design
- Free fall, shock-proof and vibration-proof for industries
- Plug and play; no software configuration is needed
- Either DIN rail or Wall Mount installation

Product Description

This is an industrial media converter that converts 2 10/100Base-TX(RJ-45) to 1 100Base-LX(SC) via 1310nm single-mode fiber (SMF) SC, with a maximum distance reach of 20km. This provides a cost effective conversion from 10/100Base-TX(RJ-45) to 100Base-LX fiber, while extending the network reach beyond the 100m reach limitation of copper. This industrial grade product includes a terminal block and does not come with a power plug. Our media converters and network interface cards are 100% compliant for all of our networking needs. Now you have a cost effective solution to your network upgrade needs.

Ethernet Interface Specifications

Parameter	Specifications
Ports	4x10/100Base-TX Port (RJ-45) 1x100Base-X (SFP/1x9)
Port Mode (Tx)	Auto Negotiation Speed Full/Half Duplex Mode Auto MDI/MDI-X Connection
Standards	IEEE 802.3 for Ethernet IEEE 802.3u for Fast Ethernet IEEE 802.3x for Flow Control and Back Pressure IEEE802.3az for Energy Efficient Ethernet (EEE)
Packet Buffer Size	512K
Maximum Packet Length	9K
MAC Address Table	4K
Transmission Mode	Store and Forward (Full/Half Duplex Mode)
Exchange Property	Delay time: < 7μs Backplane bandwidth: 1.25G

PoE & Power Supply Specifications

Parameter	Specifications
PoE Ports	Port 1 to 4 IEEE802.3af/at @PoE+
Power Supply Pin	Default: 1/2(+), 3/6(-)
Maximum Power Per Port	30W
Total PWR/Input Voltage	120W(DC48-56V) (Model-Dependent)
Power Consumption	3 Watts Maximum (Without PoE Load)
Power Inputs	2
Operating Voltage	Non-PoE Mode: 9-56VDC 30W PoE Mode: 48-56VDC 90W PoE Mode: 52-56VDC (IEEE802.3bt Model)
Connector	1 Removable 6-Contact Terminal Blocks Pin 1/2 for Power 1, Pin 3/4 for Power 2, Pin 5/6 for Fault Alarm
Protection	Overload Current Protection, Reverse Polarity Protection

LED Specifications

LED	State	Description
PWR (P1&P2)	On	Power is being supplied.
	Off	Power is not being supplied.
Link/ACT (1-5)	On	Port connection is active.
	Blinking	Data transmitted.
	Off	Port connection is not active.

Physical Characteristics

Parameter	Specifications
Housing	Aluminum Case
IP Rating	IP40
ESD Protection	6KV
EFT Protection	6KV
Dimensions	120mm x 90mm x 35mm (L x W x H)
Installation Mode	DIN Rail/Wall Mount
Weight	400g (Without PoE)
Operating Temperature	-40℃~75℃ (-40 to 167 °F)
Storage Temperature	-40℃~85℃ (-40 to 185 °F)
Operating Humidity	5-95% (Non-Condensing)
Heat Dissipation	10 BTU/h (Non-PoE) 420 BTU/h (30W PoE) 1260 BTU/h (90W PoE)
Cooling	Passive Cooling
Noise Level	0dBA

Mechanical Specifications

Unit: mm

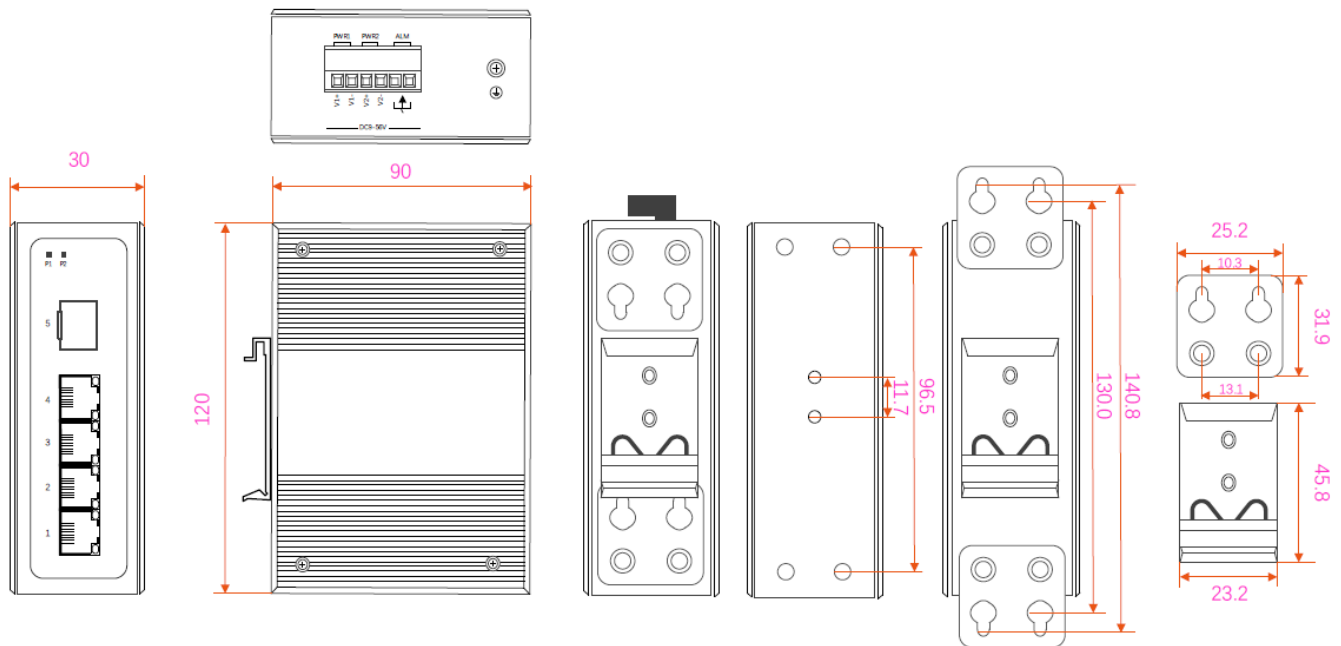

About ProLabs

Our experience comes as standard; for over 15 years ProLabs has delivered optical connectivity solutions that give our customers freedom and choice through our ability to provide seamless interoperability. At the heart of our company is the ability to provide state-of-the-art optical transport and connectivity solutions that are compatible with over 90 optical switching and transport platforms.

Complete Portfolio of Network Solutions

ProLabs is focused on innovations in optical transport and connectivity. The combination of our knowledge of optics and networking equipment enables ProLabs to be your single source for optical transport and connectivity solutions from 100Mb to 400G while providing innovative solutions that increase network efficiency. We provide the optical connectivity expertise that is compatible with and enhances your switching and transport equipment.

Trusted Partner

Customer service is our number one value. ProLabs has invested in people, labs and manufacturing capacity to ensure that you get immediate answers to your questions and compatible product when needed. With Engineering and Manufacturing offices in the U.K. and U.S. augmented by field offices throughout the U.S., U.K. and Asia, ProLabs is able to be our customers best advocate 24 hours a day.



Contact Information

ProLabs US

Email: sales@prolabs.com

Telephone: 952-852-0252

ProLabs UK

Email: salesupport@prolabs.com

Telephone: +44 1285 719 600