



# HOPE + FLOWER

## PLAN D4

2 BEDROOM + 2 BATH | UNITS: 925 - 2925

FLOWER

TOTAL AREA 1,057-1,153 SQ FT

961 SQ FT  
INDOOR AREA

96-192 SQ FT  
OUTDOOR AREA



### FEATURES LIST:

- |                             |  |
|-----------------------------|--|
| 1. 24" Integrated Fridge    | 6. Integrated Dishwasher                             |
| 2. 5 Burner Gas Cooktop     | 7. Push Button Sink Disposal                         |
| 3. Ducted Hood Fan          | 8. High-Efficiency Full Size Ducted Washer and Dryer |
| 4. Convection Built in Oven | 9. Hidden Medicine Cabinet                           |
| 5. Microwave                | 10. Pantry   |

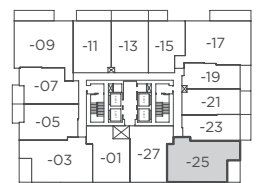

9th - 29th Floor



The floorplans, square footage, dimensions, design and configuration of the strata lots and project are approximate and/or artist's interpretation only and may differ from what is shown. Final dimensions, square footage, and configuration shall be determined by the final strata plans. Final floorplans may be the mirror image of the floorplans shown above. Refer to architectural drawings. The developer reserves the right to make changes without notice to the floorplans, ceiling heights, project design, landscaping plans, appliances, specifications, and features. E.&O.E.