



# HOPE + FLOWER

## PLAN SKYHOME G7

**3 BEDROOM + 3 BATHROOM** | UNITS: 3007 - 3107

**FLOWER**

**TOTAL AREA 1,881 SQ FT**

**1,611 SQ FT**  
INDOOR AREA

**270 SQ FT**  
OUTDOOR AREA



### FEATURES LIST:

1. 30" Integrated Fridge
2. 5 Burner Gas Cooktop
3. Ducted Hood Fan
4. Convection Built in Oven
5. Microwave
6. Integrated Dishwasher
7. Push Button Sink Disposal
8. Undercounter Wine Fridge
9. High-Efficiency Full Size Ducted Washer and Dryer
10. Hidden Medicine Cabinet

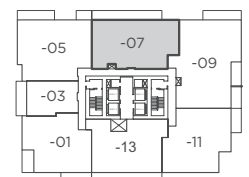

30th - 31st Floor



The floorplans, square footage, dimensions, design and configuration of the strata lots and project are approximate and/or artist's interpretation only and may differ from what is shown. Final dimensions, square footage, and configuration shall be determined by the final strata plans. Final floorplans may be the mirror image of the floorplans shown above. Refer to architectural drawings. The developer reserves the right to make changes without notice to the floorplans, ceiling heights, project design, landscaping plans, appliances, specifications, and features. E.&O.E.