

Ray Fixture w/ Power Cord

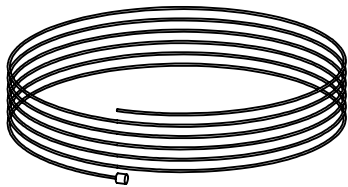

Stainless Steel Cable
Qty: 2

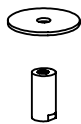

1/4-20 Ceiling Coupler w/
Escutcheon Plate
Qty: 2

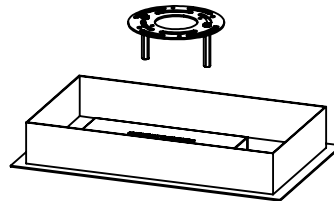

Small Ray Canopy
w/ (1) LED Driver

or

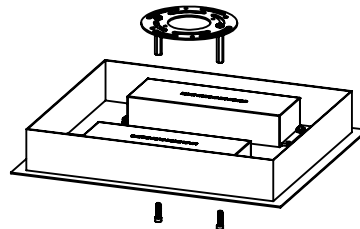

Medium/Large/XLarge Ray Canopy
w/ (2) LED Drivers

PLEASE NOTE:

- This product must be installed in accordance with the applicable installation code by a person familiar with the construction and operation of the product and the hazards involved.
- WARNING: Risk of shock from energized equipment.
- Always turn power OFF and lock out during fixture installation.
- Installer is responsible for adequately reinforcing walls and/or ceilings to support fixture weight.

Install 1/4-20 all thread in ceiling near a junction box.
 Note: All-thread should be installed to extend 1/2" below the line of the finished ceiling and able to support 60lb. minimum load.
 See diagram below for proper cable spacing.

Feed stainless cable through ceiling coupler. Slide escutcheon plate over all-thread in ceiling and twist ceiling coupler into place as shown. Continue twisting until firmly secured against escutcheon plate at ceiling.

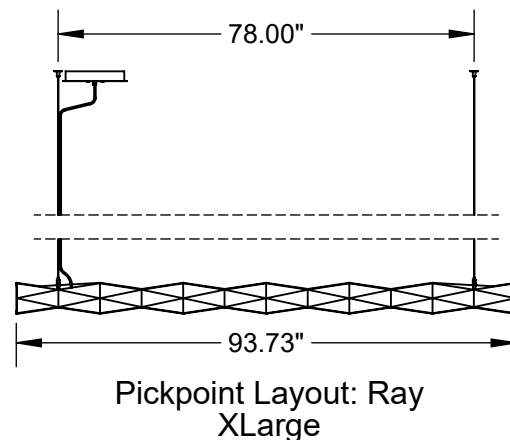
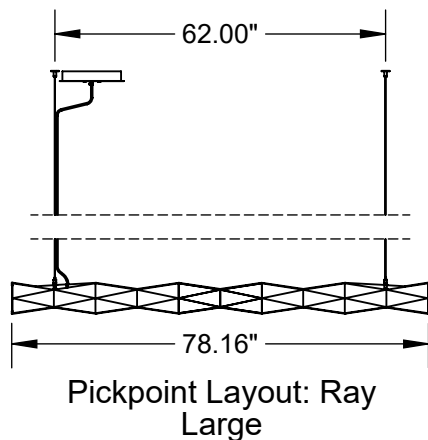
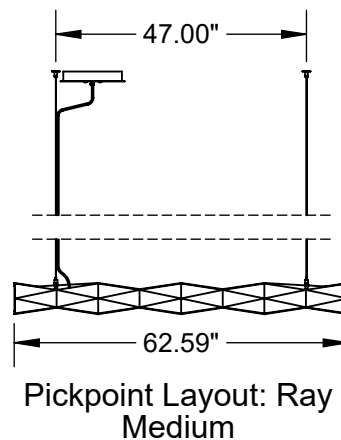
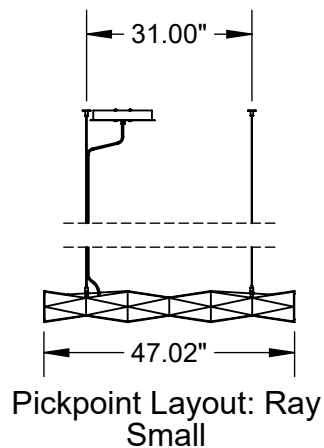
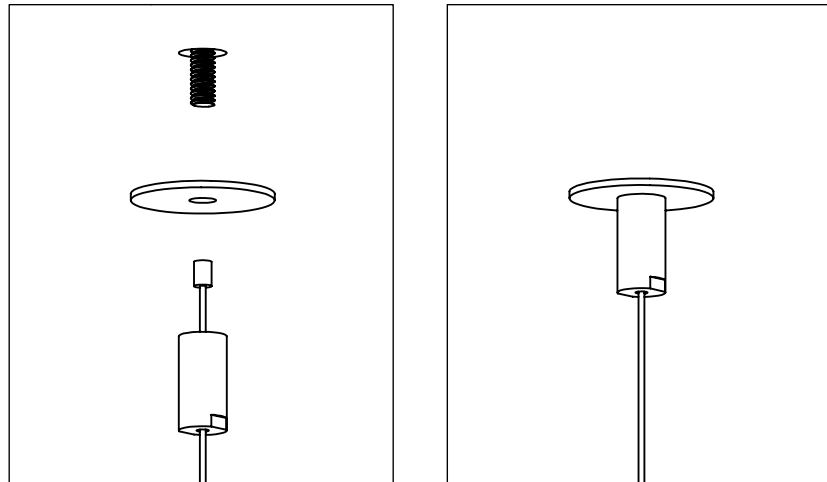

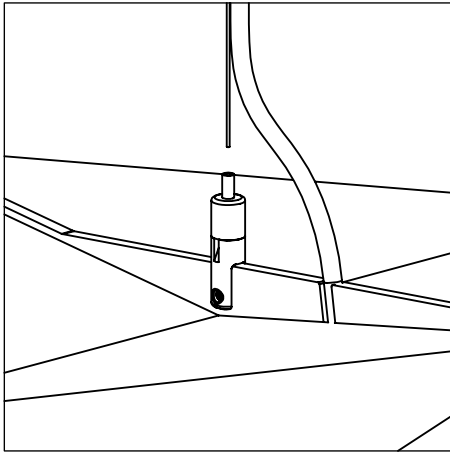

1. Feed stainless cables into grippers at fixture.

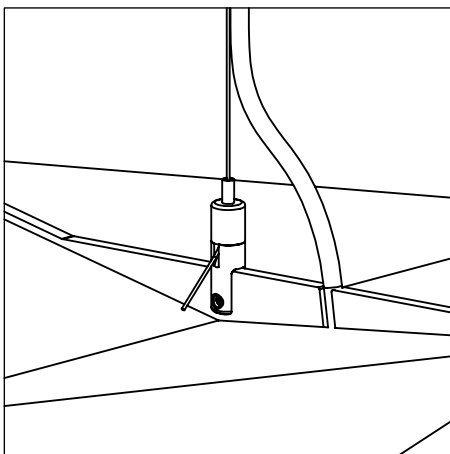

2. Depress plunger at top to adjust desired hanging height and level as necessary.

3. Trim excess cable.

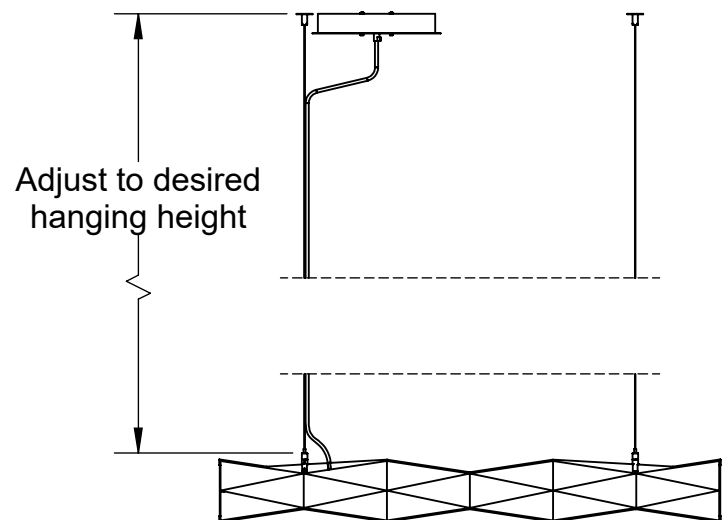

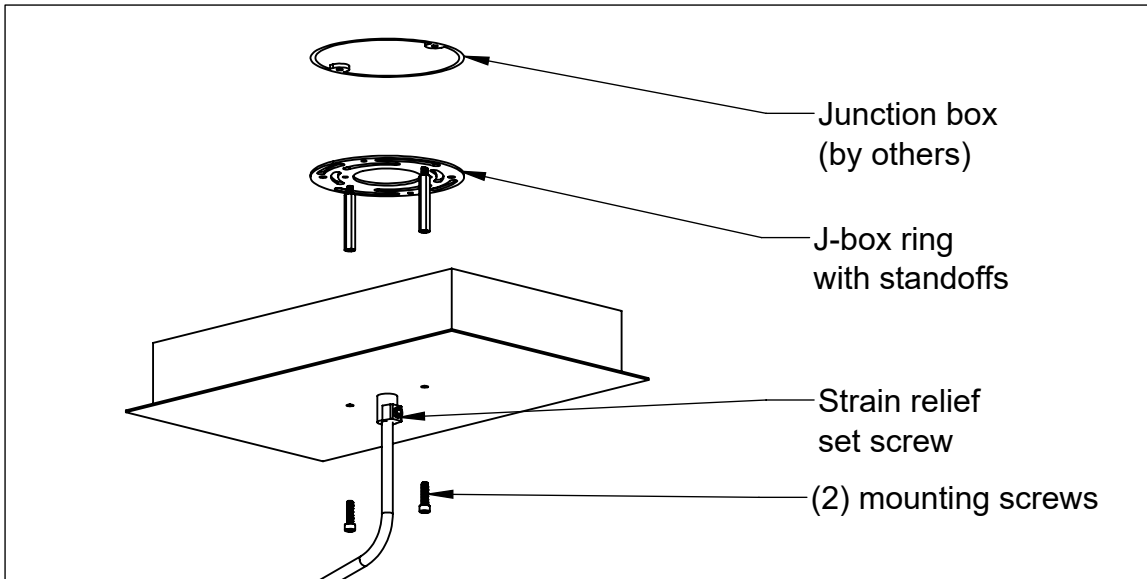

CANOPY AND WIRING:

- Attach the j-box ring to the junction box with (2) mounting screws (not included).
- Determine cord length between canopy and fixture. Trim and strip electrical cord to the appropriate length.
- Feed power cord through strain relief in canopy and make appropriate electrical connections (see wiring diagram). Note the Ray Small has only one LED driver whereas the Medium, Large, and X-Large have two drivers.
- Attach canopy to ceiling with the two included screws.
- Tighten set screw on the strain relief to secure cord.

WIRING DIAGRAM

For illustration purposes only. Consult control manufacturer's spec. sheets for specific wiring requirements and fixture capacity.

NOTICE:

- Wire according to appropriate manufacturers wiring diagrams
- Suitable for damp locations
- Contact manufacturer for LED replacement

WARNING:

LIGHTART IS NOT LIABLE FOR DAMAGE DUE TO MISWIRING 0-10 VOLT CONTROL WIRES, OR LOW VOLTAGE LED WIRES TO LINE VOLTAGE.

