

PMF Real Estate Services is pleased to present:

**FOR LEASE**

# PHILLIPS CENTER SOUTH RETAIL

10026-10036 Main Street, Bothell, WA 98011



## High-Exposure Downtown Bothell Retail

- 3,696 SF recently renovated space.
- Building and monument signage and exposure to busy Main Street.
- 1,055 NEW University of Washington Student Housing units under construction, over 700 MF units being delivered in the downtown and over 900 new MF units near the 405 interchange.
- 500ft from SR-522 (45,000 Traffic Count), 3,000ft from University of Washington Bothell and Cascadia College joint campuses with approx. 10,000 students enrolled and approx. 1,000 staff/faculty.



PMF REAL ESTATE SERVICES

**Brian Franklin**

**President**

P: 425-746-6066

brian@pmfinvestments.com

**Tim Jackson**

**Executive Vice President**

P: 425-746-6066

tim@pmfinvestments.com

The information contained herein has been obtained from sources deemed to be reliable, however PMF Investments makes no warranties or representations to its accuracy. All information should be independently verified by prospective tenants and/or their representatives.



# PHILLIPS CENTER SOUTH RETAIL

# SPACE PLAN

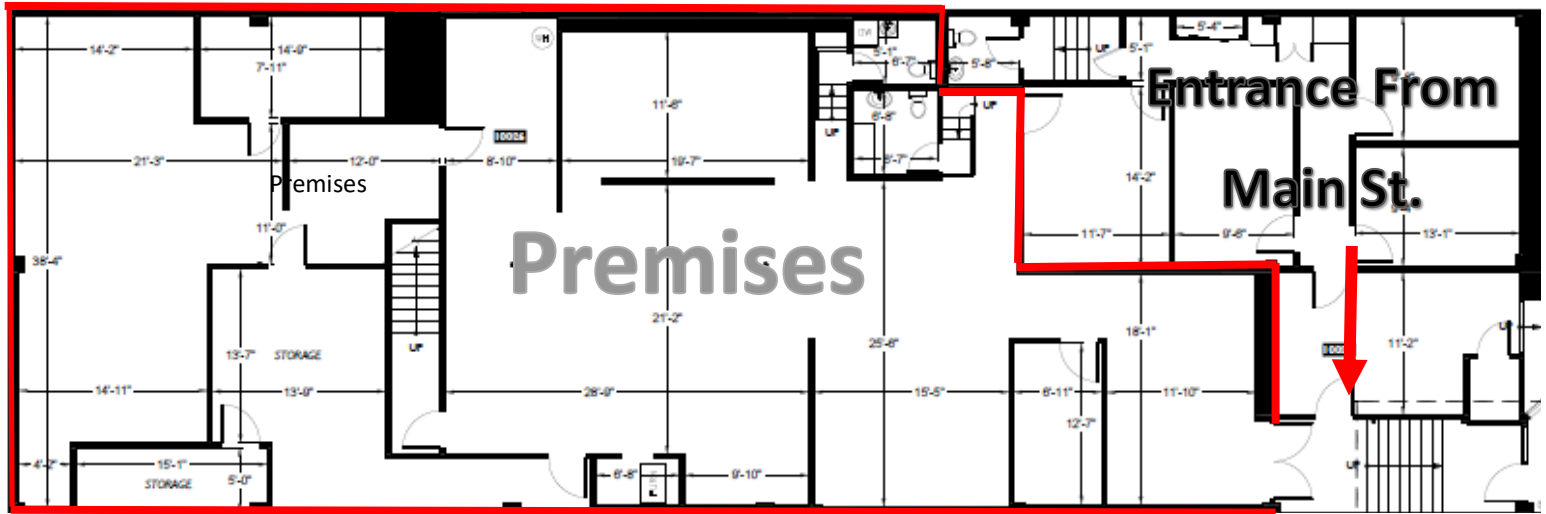

3,696 SF

\$15.00/rsf + \$6.00/rsf NNN

Monument signage available



PMF REAL ESTATE SERVICES

Brian Franklin P: 425-746-6066 brian@pmfinvestments.com

Tim Jackson P: 425-746-6066 tim@pmfinvestments.com

The information contained herein has been obtained from sources deemed to be reliable, however PMF Investments makes no warranties or representations to its accuracy. All information should be independently verified by prospective tenants and/or their representatives.