



WAREHOUSE FOR LEASE

1132 Thorne Road
Tacoma, WA 98421

AVAILABLE NOW!

- 1,176 SF Office/Showroom
- 5,950 SF warehouse
- Bonus 3,780 SF 2nd floor storage
- 6 grade level doors
- Leveled/fenced yard
- 120/240 single phase power
- \$1.20 PSF blended rate includes yard/parking & 2nd floor storage



KRISTINA BAILEY
PORT OF TACOMA REAL ESTATE

(253) 888-4749
kbailey@portoftacoma.com



FLOOR PLANS 1132 Thorne Road, Tacoma, WA

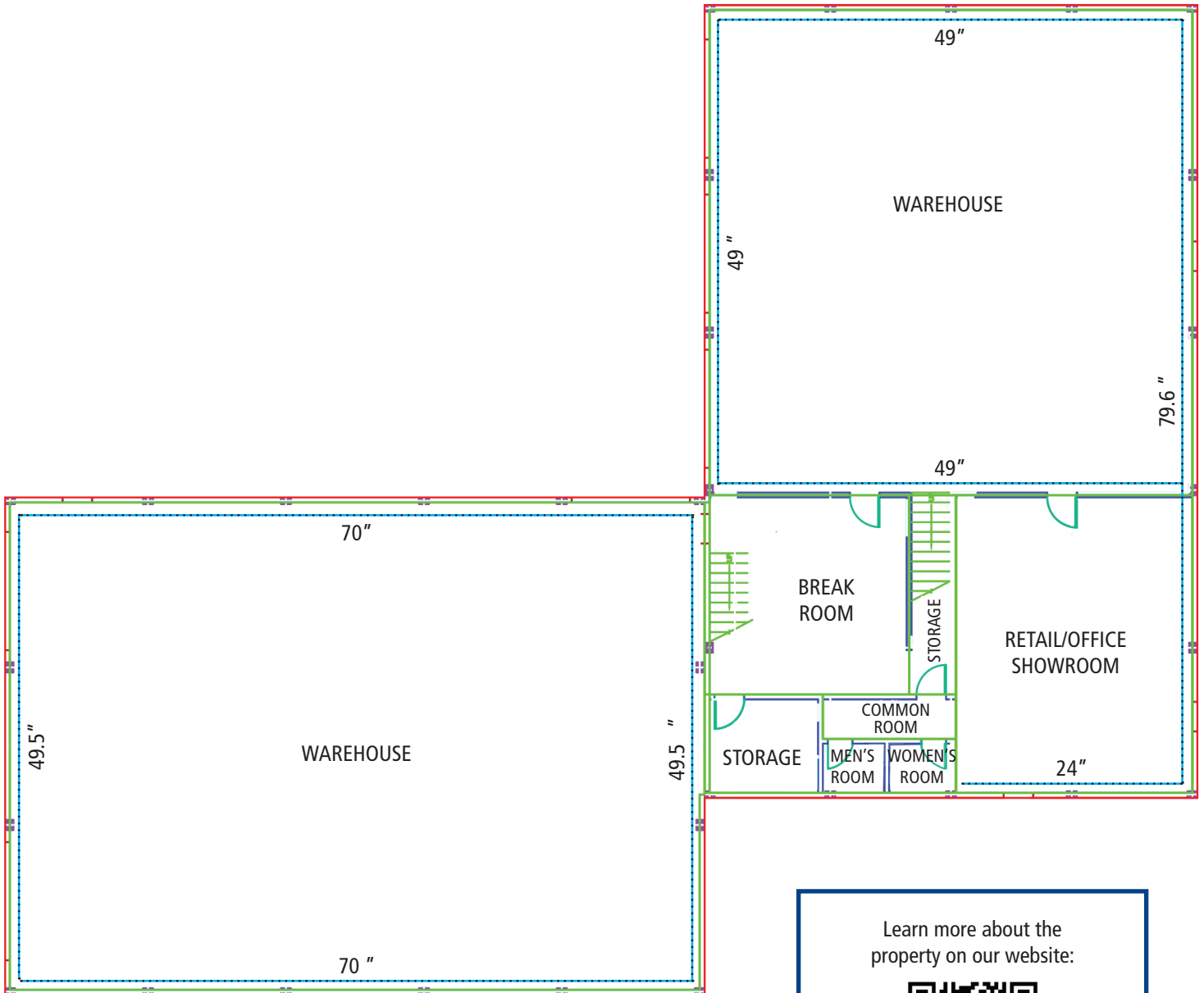

Learn more about the property on our website:



portoftacoma.com/real-estate

KRISTINA BAILEY
PORT OF TACOMA REAL ESTATE

(253) 888-4749
kbailey@portoftacoma.com

