

File: Q:\SEA\10284-02\CADD\Active\JARPA\1028402_F2-F3

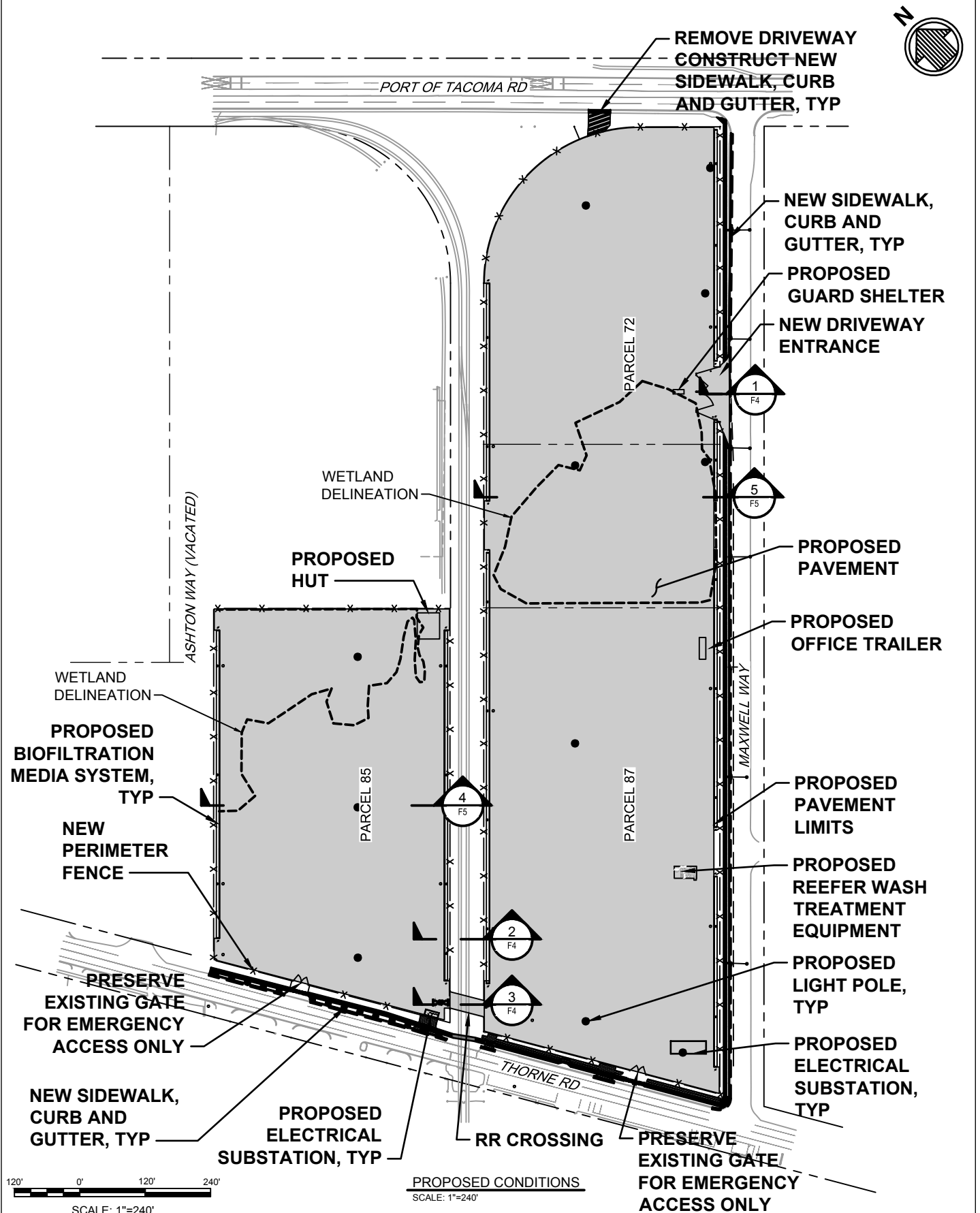

USACE REFERENCE: NWS-2020-557-WRD

APPLICANT: PORT OF TACOMA

ADJACENT PROPERTY OWNERS:
SEE THE JOINT AQUATIC RESOURCES
PERMIT APPLICATION (JARPA)

LOCATION: 1451 & 1721 THORNE ROAD AND
1702 PORT OF TACOMA ROAD
TACOMA, WA

LAT/LONG: 47.264 N
-122.401 W

DATUM: MLLW=19.39' TIDE 22 1935 BENCHMARK
SHEET: 3 OF 7 DATE: OCTOBER 22, 2022

PROPOSED PROJECT: OFF-DOCK CONTAINER
SUPPORT FACILITY

IN: NOT LOCATED IN A WATERBODY
NEAR/AT: CITY OF TACOMA
COUNTY: PIERCE STATE: WA
SEC: 34 T: 21 N R: 3 E