

## RESTROOM BUILDING NOTES

1. THE RESTROOM BUILDINGS ARE PREMANUFACTURED CONCRETE STRUCTURES THAT WILL BE PROCURED SEPARATELY BY THE PORT. PROCUREMENT AND PLACEMENT OF THE BUILDINGS ARE NOT INCLUDED IN THE CONTRACT. THE DRAWINGS INCLUDED ON SHEET C2.0 ARE FOR REFERENCE ONLY AND ARE ONLY INTENDED TO PROVIDE INFORMATION REGARDING THE BUILDING THAT WILL BE INSTALLED.
2. CONTRACTOR IS RESPONSIBLE FOR ALL SUB-BASE PREPARATION AND UTILITY WORK REQUIRED TO SET RESTROOM BUILDING. THE CONTRACTOR IS NOT RESPONSIBLE FOR SETTING THE BUILDING. SEE DRAWING C1.3 AND C2.0 FOR REQUIRED UTILITY WORK.
3. THIS FACTORY ASSEMBLED BUILDING AS CONSTRUCTED PROVIDES A RIGID BOX TYPE STRUCTURAL SYSTEM. VERTICAL LOADS ARE TRANSFERRED PRIMARILY THROUGH BEARING WALLS TO A PREPARED GRANULAR SUB-BASE WHICH DISSIPATES VERTICAL LOADS UNIFORMLY TO THE NATIVE SUBGRADE AND ALSO ACTS AS A FROST BARRIER.
4. A FULL DEPTH FOUNDATION WALL AT THE BUILDING PERIMETER, TYPICAL FOR OTHER TYPES OF BUILDING CONSTRUCTION, IS NOT REQUIRED FOR THIS BUILDING.

## 1 RESTROOM BUILDING ENLARGED PLAN

SCALE: 1"=5'

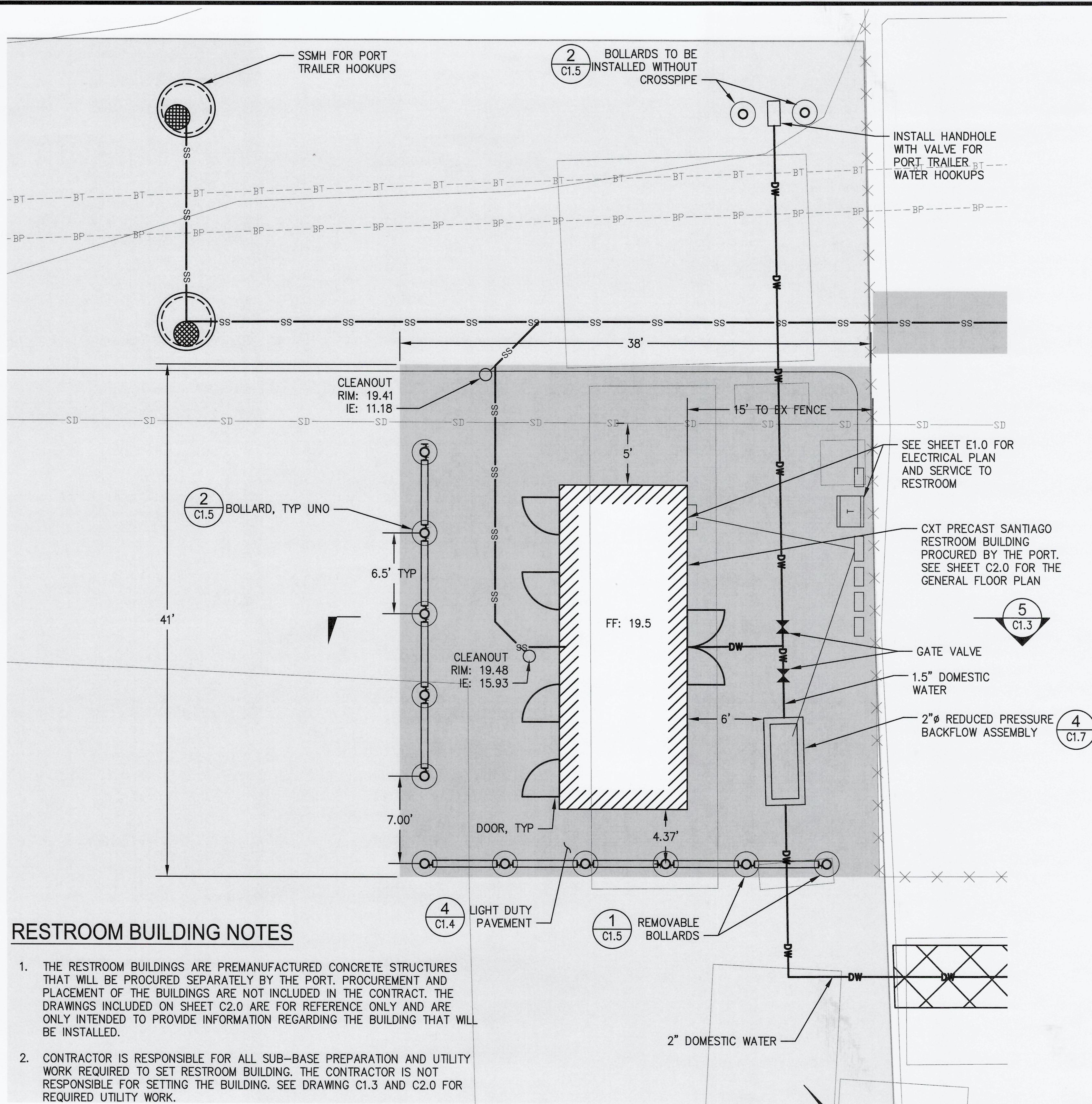

0 5 10 15  
SCALE: 1"=10'

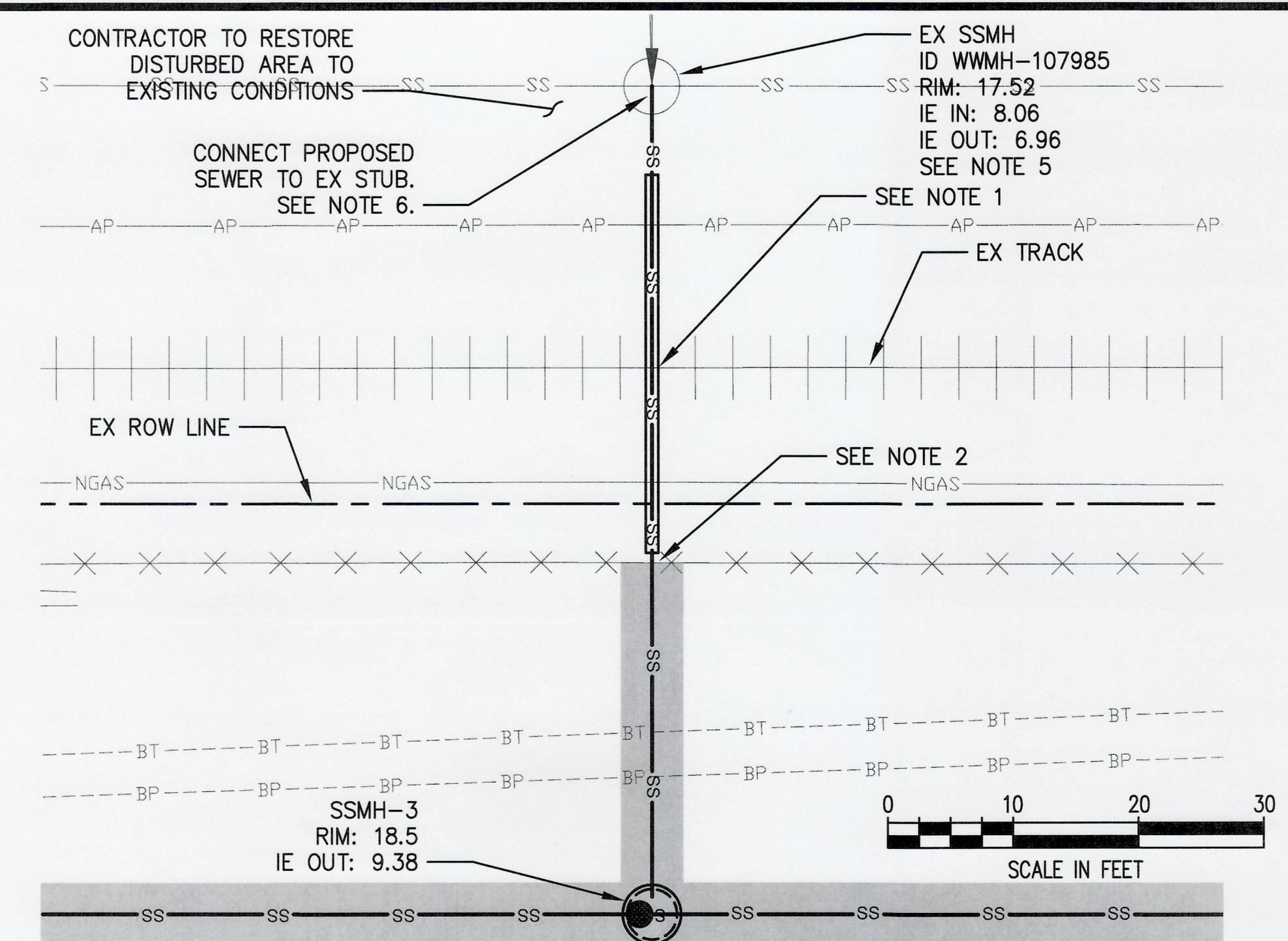

## 2 SOUTH SEWER ROW WORK PLAN

SCALE: 1"=10'

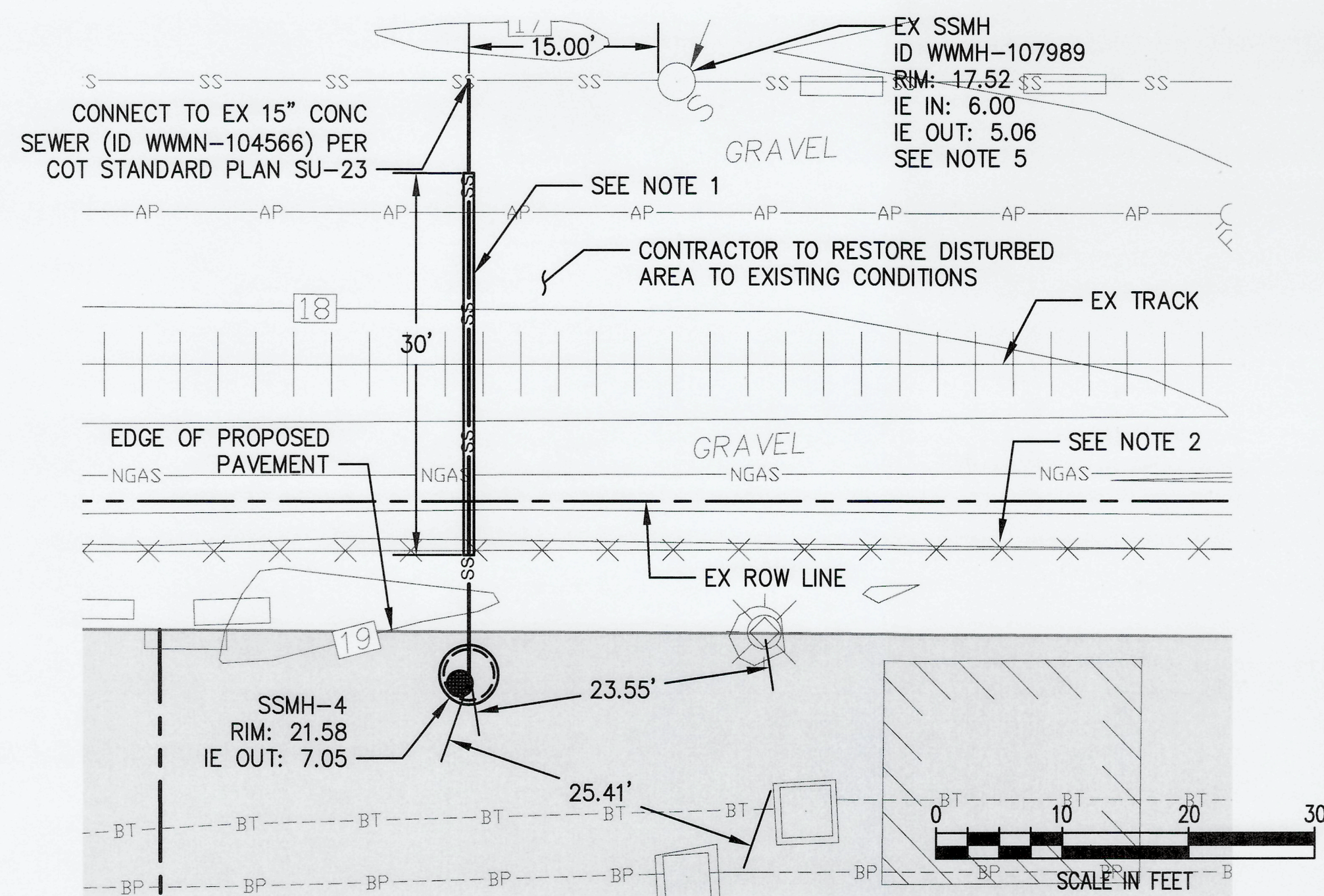

## 3 NORTH SEWER ROW WORK PLAN

SCALE: 1"=10'

## SEWER ROW WORK NOTES

1. CONTRACTOR TO JACK AND BORE UNDERNEATH EXISTING TRACK TO INSTALL 6 INCH SEWER LINE WITH 10" CASING PER DETAIL 3 ON SHEET C1.8.
2. CONTRACTOR TO REMOVE AND REPLACE EXISTING CHAIN LINK FENCE AS NECESSARY TO INSTALL SEWER PIPE.
3. CONTRACTOR TO SUBMIT A BORING AND JACKING PLAN TO BE APPROVED BY THE ENGINEER AND TACOMA RAIL PRIOR TO BEGINNING WORK.
4. CONTRACTOR SHALL COORDINATE ALL SCHEDULING AND SEQUENCING OF WORK WITHIN THE CITY ROW WITH TACOMA RAIL AND THE CITY OF TACOMA.
5. CONTRACTOR SHALL PROVIDE DEWATERING SYSTEMS AS REQUIRED DURING PIPE INSTALLATIONS.
6. CONNECTION OF PROPOSED 6" SEWER TO EXISTING 8" STUB SHALL BE CONSTRUCTED USING A FERNCO, ROMAC, OR APPROVED EQUAL WATERTIGHT ADAPTER COUPLING.

|  |             |                                    |                     |                     |                     |
|--|-------------|------------------------------------|---------------------|---------------------|---------------------|
|  |             |                                    |                     |                     |                     |
| 2407 North 31st Street, Suite 100<br>Tacoma, Washington 98407<br>(253) 396-0150 Fax (253) 396-0162 |             | 11/21/2023<br>12/13/23<br>12/14/23 |                     | 12/4/23             |                     |
| APPROVED:  | CHECKED BY: | DATE:                              | DATE:               | DATE:               | DATE:               |
| TJH  | SEK         | 11/21/2023                         | 11/21/2023          | 11/21/2023          | 11/21/2023          |
| DIRECTOR   |             | DATE                               | DATE                | DATE                | DATE                |
| PRINTED BY:  |             | thebig Nov 21, 2023                | thebig Nov 21, 2023 | thebig Nov 21, 2023 | thebig Nov 21, 2023 |
| PORT ADDRESS:  |             | ONE SITCUM PLAZA                   | ONE SITCUM PLAZA    | ONE SITCUM PLAZA    | ONE SITCUM PLAZA    |
| TACOMA WA, 98401-1837  |             |                                    |                     |                     |                     |
| DRAWING SCALE:   |             | AS SHOWN                           |                     |                     |                     |
| PARCEL:  |             | 0321354035                         |                     |                     |                     |
| BID SET  |             | 201105.01                          |                     |                     |                     |
| PHASE:   |             | 14                                 |                     |                     |                     |
| CONT./CONS:  |             | 071907                             |                     |                     |                     |
| TOWNSHIP:  |             | 21N                                |                     |                     |                     |
| RANGE:   |             | 3E                                 |                     |                     |                     |
| SECTION:   |             | 36                                 |                     |                     |                     |
| PORT OF TACOMA BM#   |             |                                    |                     |                     |                     |
| VERT:  |             |                                    |                     |                     |                     |
| DRAWING SCALE:   |             | AS SHOWN                           |                     |                     |                     |
| BID SET  |             | 201105.01                          |                     |                     |                     |
| PHASE:   |             | 14                                 |                     |                     |                     |
| CONT./CONS:  |             | 071907                             |                     |                     |                     |
| TOWNSHIP:  |             | 21N                                |                     |                     |                     |
| RANGE:   |             | 3E                                 |                     |                     |                     |
| SECTION:   |             | 36                                 |                     |                     |                     |
| PORT OF TACOMA BM#   |             |                                    |                     |                     |                     |
| VERT:  |             |                                    |                     |                     |                     |
| DRAWING SCALE:   |             | AS SHOWN                           |                     |                     |                     |
| BID SET  |             | 201105.01                          |                     |                     |                     |
| PHASE:   |             | 14                                 |                     |                     |                     |
| CONT./CONS:  |             | 071907                             |                     |                     |                     |
| TOWNSHIP:  |             | 21N                                |                     |                     |                     |
| RANGE:   |             | 3E                                 |                     |                     |                     |
| SECTION:   |             | 36                                 |                     |                     |                     |
| PORT OF TACOMA BM#   |             |                                    |                     |                     |                     |
| VERT:  |             |                                    |                     |                     |                     |
| DRAWING SCALE:   |             | AS SHOWN                           |                     |                     |                     |
| BID SET  |             | 201105.01                          |                     |                     |                     |
| PHASE:   |             | 14                                 |                     |                     |                     |
| CONT./CONS:  |             | 071907                             |                     |                     |                     |
| TOWNSHIP:  |             | 21N                                |                     |                     |                     |
| RANGE:   |             | 3E                                 |                     |                     |                     |
| SECTION:   |             | 36                                 |                     |                     |                     |
| PORT OF TACOMA BM#   |             |                                    |                     |                     |                     |
| VERT:  |             |                                    |                     |                     |                     |
| DRAWING SCALE:   |             | AS SHOWN                           |                     |                     |                     |
| BID SET  |             | 201105.01                          |                     |                     |                     |
| PHASE:   |             | 14                                 |                     |                     |                     |
| CONT./CONS:  |             | 071907                             |                     |                     |                     |
| TOWNSHIP:  |             | 21N                                |                     |                     |                     |
| RANGE:   |             | 3E                                 |                     |                     |                     |
| SECTION:   |             | 36                                 |                     |                     |                     |
| PORT OF TACOMA BM#   |             |                                    |                     |                     |                     |
| VERT:  |             |                                    |                     |                     |                     |
| DRAWING SCALE:   |             | AS SHOWN                           |                     |                     |                     |
| BID SET  |             | 201105.01                          |                     |                     |                     |
| PHASE:   |             | 14                                 |                     |                     |                     |
| CONT./CONS:  |             | 071907                             |                     |                     |                     |
| TOWNSHIP:  |             | 21N                                |                     |                     |                     |
| RANGE:   |             | 3E                                 |                     |                     |                     |
| SECTION:   |             | 36                                 |                     |                     |                     |
| PORT OF TACOMA BM#   |             |                                    |                     |                     |                     |
| VERT:  |             |                                    |                     |                     |                     |
| DRAWING SCALE:   |             | AS SHOWN                           |                     |                     |                     |
| BID SET  |             | 201105.01                          |                     |                     |                     |
| PHASE:   |             | 14                                 |                     |                     |                     |
| CONT./CONS:  |             | 071907                             |                     |                     |                     |
| TOWNSHIP:  |             | 21N                                |                     |                     |                     |
| RANGE:   |             | 3E                                 |                     |                     |                     |
| SECTION:   |             | 36                                 |                     |                     |                     |
| PORT OF TACOMA BM#   |             |                                    |                     |                     |                     |
| VERT:  |             |                                    |                     |                     |                     |
| DRAWING SCALE:   |             | AS SHOWN                           |                     |                     |                     |
| BID SET  |             | 201105.01                          |                     |                     |                     |
| PHASE:   |             | 14                                 |                     |                     |                     |
| CONT./CONS:  |             | 071907                             |                     |                     |                     |
| TOWNSHIP:  |             | 21N                                |                     |                     |                     |
| RANGE:   |             | 3E                                 |                     |                     |                     |
| SECTION:   |             | 36                                 |                     |                     |                     |
| PORT OF TACOMA BM#   |             |                                    |                     |                     |                     |
| VERT:  |             |                                    |                     |                     |                     |
| DRAWING SCALE:   |             | AS SHOWN                           |                     |                     |                     |
| BID SET  |             | 201105.01                          |                     |                     |                     |
| PHASE:   |             | 14                                 |                     |                     |                     |
| CONT./CONS:  |             | 071907                             |                     |                     |                     |
| TOWNSHIP:  |             | 21N                                |                     |                     |                     |
| RANGE:   |             | 3E                                 |                     |                     |                     |
| SECTION:   |             | 36                                 |                     |                     |                     |
| PORT OF TACOMA BM#   |             |                                    |                     |                     |                     |
| VERT:  |             |                                    |                     |                     |                     |
| DRAWING SCALE:   |             | AS SHOWN                           |                     |                     |                     |
| BID SET  |             | 201105.01                          |                     |                     |                     |
| PHASE:   |             | 14                                 |                     |                     |                     |
| CONT./CONS:  |             | 071907                             |                     |                     |                     |
| TOWNSHIP:  |             | 21N                                |                     |                     |                     |
| RANGE:   |             | 3E                                 |                     |                     |                     |
| SECTION:   |             | 36                                 |                     |                     |                     |
| PORT OF TACOMA BM#   |             |                                    |                     |                     |                     |
| VERT:  |             |                                    |                     |                     |                     |
| DRAWING SCALE:   |             | AS SHOWN                           |                     |                     |                     |
| BID SET  |             | 201105.01                          |                     |                     |                     |
| PHASE:   |             | 14                                 |                     |                     |                     |
| CONT./CONS:  |             | 071907                             |                     |                     |                     |
| TOWNSHIP:  |             | 21N                                |                     |                     |                     |
| RANGE:   |             | 3E                                 |                     |                     |                     |
| SECTION:   |             | 36                                 |                     |                     |                     |
| PORT OF TACOMA BM#   |             |                                    |                     |                     |                     |
| VERT:  |             |                                    |                     |                     |                     |
| DRAWING SCALE:   |             | AS SHOWN                           |                     |                     |                     |
| BID SET  |             | 201105.01                          |                     |                     |                     |
| PHASE:   |             | 14                                 |                     |                     |                     |
| CONT./CONS:  |             | 071907                             |                     |                     |                     |
| TOWNSHIP:  |             | 21N                                |                     |                     |                     |
| RANGE:   |             | 3E                                 |                     |                     |                     |
| SECTION:   |             | 36                                 |                     |                     |                     |
| PORT OF TACOMA BM#   |             |                                    |                     |                     |                     |
| VERT:  |             |                                    |                     |                     |                     |
| DRAWING SCALE:   |             | AS SHOWN                           |                     |                     |                     |
| BID SET  |             | 201105.01                          |                     |                     |                     |
| PHASE:   |             | 14                                 |                     |                     |                     |
| CONT./CONS:  |             | 071907                             |                     |                     |                     |
| TOWNSHIP:  |             | 21N                                |                     |                     |                     |
| RANGE:   |             | 3E                                 |                     |                     |                     |
| SECTION:   |             | 36                                 |                     |                     |                     |
| PORT OF TACOMA BM#   |             |                                    |                     |                     |                     |
| VERT:  |             |                                    |                     |                     |                     |
| DRAWING SCALE:   |             | AS SHOWN                           |                     |                     |                     |
| BID SET  |             | 201105.01                          |                     |                     |                     |
| PHASE:   |             | 14                                 |                     |                     |                     |
| CONT./CONS:  |             | 071907                             |                     |                     |                     |
| TOWNSHIP:  |             | 21N                                |                     |                     |                     |
| RANGE:   |             | 3E                                 |                     |                     |                     |
| SECTION:   |             | 36                                 |                     |                     |                     |
| PORT OF TACOMA BM#   |             |                                    |                     |                     |                     |
| VERT:  |             |                                    |                     |                     |                     |
| DRAWING SCALE:   |             | AS SHOWN                           |                     |                     |                     |
| BID SET  |             | 201105.01                          |                     |                     |                     |
| PHASE:   |             | 14                                 |                     |                     |                     |
| CONT./CONS:  |             | 071907                             |                     |                     |                     |
| TOWNSHIP:  |             | 21N                                |                     |                     |                     |
| RANGE:   |             | 3E                                 |                     |                     |                     |
| SECTION:   |             | 36                                 |                     |                     |                     |
| PORT OF TACOMA BM#   |             |                                    |                     |                     |                     |
| VERT:  |             |                                    |                     |                     |                     |
| DRAWING SCALE:   |             | AS SHOWN                           |                     |                     |                     |
| BID SET  |             | 201105.01                          |                     |                     |                     |
| PHASE:   |             | 14                                 |                     |                     |                     |
| CONT./CONS:  |             | 071907                             |                     |                     |                     |
| TOWNSHIP:  |             | 21N                                |                     |                     |                     |
| RANGE:   |             | 3E                                 |                     |                     |                     |
| SECTION:   |             | 36                                 |                     |                     |                     |
| PORT OF TACOMA BM#   |             |                                    |                     |                     |                     |
| VERT:  |             |                                    |                     |                     |                     |
| DRAWING SCALE:   |             | AS SHOWN                           |                     |                     |                     |
| BID SET  |             | 201105.01                          |                     |                     |                     |
| PHASE:   |             | 14                                 |                     |                     |                     |
| CONT./CONS:  |             | 071907                             |                     |                     |                     |
| TOWNSHIP:  |             | 21N                                |                     |                     |                     |
| RANGE:   |             | 3E                                 |                     |                     |                     |
| SECTION:   |             | 36                                 |                     |                     |                     |
| PORT OF TACOMA BM#   |             |                                    |                     |                     |                     |
| VERT:  |             |                                    |                     |                     |                     |
| DRAWING SCALE:   |             | AS SHOWN                           |                     |                     |                     |
| BID SET  |             | 201105.01                          |                     |                     |                     |
| PHASE:   |             | 14                                 |                     |                     |                     |
| CONT./CONS:  |             | 071907                             |                     |                     |                     |
| TOWNSHIP:  |             | 21N                                |                     |                     |                     |
| RANGE:   |             | 3E                                 |                     |                     |                     |
| SECTION:   |             | 36                                 |                     |                     |                     |
| PORT OF TACOMA BM#   |             |                                    |                     |                     |                     |
| VERT:  |             |                                    |                     |                     |                     |
| DRAWING SCALE:   |             | AS SHOWN                           |                     |                     |                     |
| BID SET  |             | 201105.01                          |                     |                     |                     |
| PHASE:   |             | 14                                 |                     |                     |                     |
| CONT./CONS:  |             | 071907                             |                     |                     |                     |
| TOWNSHIP:  |             | 21N                                |                     |                     |                     |
| RANGE:   |             | 3E                                 |                     |                     |                     |
| SECTION:   |             | 36                                 |                     |                     |                     |
| PORT OF TACOMA BM#   |             |                                    |                     |                     |                     |
| VERT:  |             |                                    |                     |                     |                     |
| DRAWING SCALE:   |             | AS SHOWN                           |                     |                     |                     |
| BID SET  |             | 201105.01                          |                     |                     |                     |
| PHASE:   |             | 14                                 |                     |                     |                     |
| CONT./CONS:  |             | 071907                             |                     |                     |                     |
| TOWNSHIP:  |             | 21N                                |                     |                     |                     |
| RANGE:   |             | 3E                                 |                     |                     |                     |
| SECTION:   |             | 36                                 |                     |                     |                     |
| PORT OF TACOMA BM#   |             |                                    |                     |                     |                     |
| VERT:  |             |                                    |                     |                     |                     |
| DRAWING SCALE:   |             | AS SHOWN                           |                     |                     |                     |
| BID SET  |             | 201105.01                          |                     |                     |                     |
| PHASE:   |             | 14                                 |                     |                     |                     |
| CONT./CONS:  |             | 071907                             |                     |                     |                     |
| TOWNSHIP:  |             | 21N                                |                     |                     |                     |
| RANGE:   |             | 3E                                 |                     |                     |                     |
| SECTION:   |             | 36                                 |                     |                     |                     |
| PORT OF TACOMA BM#   |             |                                    |                     |                     |                     |
| VERT:  |             |                                    |                     |                     |                     |
| DRAWING SCALE:   |             | AS SHOWN                           |                     |                     |                     |
| BID SET  |             | 201105.01                          |                     |                     |                     |
| PHASE:   |             | 14                                 |                     |                     |                     |
| CONT./CONS:  |             | 071907                             |                     |                     |                     |
| TOWNSHIP:  |             | 21N                                |                     |                     |                     |
| RANGE:   |             | 3E                                 |                     |                     |                     |
| SECTION:   |             | 36                                 |                     |                     |                     |
| PORT OF TACOMA BM#   |             |                                    |                     |                     |                     |
| VERT:  |             |                                    |                     |                     |                     |
| DRAWING SCALE:   |             | AS SHOWN                           |                     |                     |                     |
| BID SET  |             | 201105.01                          |                     |                     |                     |
| PHASE:   |             | 14                                 |                     |                     |                     |
| CONT./CONS:  |             | 071907                             |                     |                     |                     |
| TOWNSHIP:  |             | 21N                                |                     |                     |                     |
| RANGE:   |             | 3E                                 |                     |                     |                     |
| SECTION:   |             | 36                                 |                     |                     |                     |
| PORT OF TACOMA BM#   |             |                                    |                     |                     |                     |
| VERT:  |             |                                    |                     |                     |                     |
| DRAWING SCALE:   |             | AS SHOWN                           |                     |                     |                     |
| BID SET  |             | 201105.01                          |                     |                     |                     |
| PHASE:   |             | 14                                 |                     |                     |                     |
| CONT./CONS:  |             | 071907                             |                     |                     |                     |
| TOWNSHIP:  |             | 21N                                |                     |                     |                     |
| RANGE:   |             | 3E                                 |                     |                     |                     |
| SECTION:   |             | 36                                 |                     |                     |                     |
| PORT OF TACOMA BM#   |             |                                    |                     |                     |                     |
| VERT:  |             |                                    |                     |                     |                     |
| DRAWING SCALE:   |             | AS SHOWN                           |                     |                     |                     |
| BID SET  |             | 201105.01                          |                     |                     |                     |
| PHASE:   |             | 14                                 |                     |                     |                     |
| CONT./CONS:  |             | 071907                             |                     |                     |                     |
| TOWNSHIP:  |             | 21N                                |                     |                     |                     |
| RANGE:   |             | 3E                                 |                     |                     |                     |
| SECTION:   |             | 36                                 |                     |                     |                     |
| PORT OF TACOMA BM#   |             |                                    |                     |                     |                     |
| VERT:  |             |                                    |                     |                     |                     |
| DRAWING SCALE:   |             | AS SHOWN                           |                     |                     |                     |
| BID SET  |             | 201105.01                          |                     |                     |                     |
| PHASE:   |             | 14                                 |                     |                     |                     |
| CONT./CONS:  |             | 071907                             |                     |                     |                     |
| TOWNSHIP:  |             | 21N                                |                     |                     |                     |
| RANGE:   |             | 3E                                 |                     |                     |                     |
| SECTION:   |             | 36                                 |                     |                     |                     |
| PORT OF TACOMA BM#   |             |                                    |                     |                     |                     |
| VERT:  |             |                                    |                     |                     |                     |
| DRAWING SCALE:   |             | AS SHOWN                           |                     |                     |                     |
| BID SET  |             | 201105.01                          |                     |                     |                     |
| PHASE:   |             | 14                                 |                     |                     |                     |
| CONT./CONS:  |             | 071907                             |                     |                     |                     |
| TOWNSHIP:  |             | 21N                                |                     |                     |                     |
| RANGE:   |             | 3E                                 |                     |                     |                     |
| SECTION:   |             | 36                                 |                     |                     |                     |
| PORT OF TACOMA BM#   |             |                                    |                     |                     |                     |
| VERT:  |             |                                    |                     |                     |                     |
| DRAWING SCALE:   |             | AS SHOWN                           |                     |                     |                     |
| BID SET  |             | 201105.01                          |                     |                     |                     |
| PHASE:   |             | 14                                 |                     |                     |                     |
| CONT./CONS:  |             | 071907                             |                     |                     |                     |
| TOWNSHIP:  |             | 21N                                |                     |                     |                     |
| RANGE:   |             | 3E                                 |                     |                     |                     |
| SECTION:   |             | 36                                 |                     |                     |                     |
| PORT OF TACOMA BM#   |             |                                    |                     |                     |                     |
| VERT:  |             |                                    |                     |                     |                     |
| DRAWING SCALE:   |             | AS SHOWN                           |                     |                     |                     |
| BID SET  |             | 201105.01                          |                     |                     |                     |
| PHASE:   |             | 14                                 |                     |                     |                     |
| CONT./CONS:  |             | 071907                             |                     |                     |                     |
| TOWNSHIP:  |             | 21N                                |                     |                     |                     |
| RANGE:   |             | 3E                                 |                     |                     |                     |
| SECTION:   |             | 36                                 |                     |                     |                     |
| PORT OF TACOMA BM#   |             |                                    |                     |                     |                     |
| VERT:  |             |                                    |                     |                     |                     |
| DRAWING SCALE:   |             | AS SHOWN                           |                     |                     |                     |
| BID SET  |             | 201105.01                          |                     |                     |                     |
| PHASE:   |             | 14                                 |                     |                     |                     |
| CONT./CONS:  |             | 071907                             |                     |                     |                     |
| TOWNSHIP:  |             | 21N                                |                     |                     |                     |
| RANGE:   |             | 3E                                 |                     |                     |                     |
| SECTION:   |             | 36                                 |                     |                     |                     |
| PORT OF TACOMA BM#   |             |                                    |                     |                     |                     |
| VERT:  |             |                                    |                     |                     |                     |
| DRAWING SCALE:   |             | AS SHOWN                           |                     |                     |                     |
| BID SET  |             | 201105.01                          |                     |                     |                     |
| PHASE:   |             | 14                                 |                     |                     |                     |
| CONT./CONS:  |             | 071907                             |                     |                     |                     |
| TOWNSHIP:  |             | 21N                                |                     |                     |                     |
| RANGE:   |             | 3E                                 |                     |                     |                     |
| SECTION:   |             | 36                                 |                     |                     |                     |
| PORT OF TACOMA BM#   |             |                                    |                     |                     |                     |
| VERT:  |             |                                    |                     |                     |                     |
| DRAWING SCALE:   |             | AS SHOWN                           |                     |                     |                     |
| BID SET  |             | 201105.01                          |                     |                     |                     |
| PHASE:   |             | 14                                 |                     |                     |                     |
| CONT./CONS:  |             | 071907                             |                     |                     |                     |
| TOWNSHIP:  |             | 21N                                |                     |                     |                     |
| RANGE:   |             | 3E                                 |                     |                     |                     |
| SECTION:   |             | 36                                 |                     |                     |                     |
| PORT OF TACOMA BM#   |             |                                    |                     |                     |                     |
| VERT:  |             |                                    |                     |                     |                     |
| DRAWING SCALE:   |             | AS SHOWN                           |                     |                     |                     |
| BID SET  |             | 201105.01                          |                     |                     |                     |
| PHASE:   |             | 14                                 |                     |                     |                     |
| CONT./CONS:  |             | 071907                             |                     |                     |                     |
| TOWNSHIP:  |             | 21N                                |                     |                     |                     |
| RANGE:   |             | 3E                                 |                     |                     |                     |
| SECTION:   |             | 36                                 |                     |                     |                     |
| PORT OF TACOMA BM#   |             |                                    |                     |                     |                     |
| VERT:  |             |                                    |                     |                     |                     |
| DRAWING SCALE:   |             | AS SHOWN                           |                     |                     |                     |
| BID SET  |             | 201105.01                          |                     |                     |                     |
| PHASE:   |             | 14                                 |                     |                     |                     |
| CONT./CONS:  |             | 071907                             |                     |                     |                     |
| TOWNSHIP:  |             | 21N                                |                     |                     |                     |
| RANGE:   |             | 3E                                 |                     |                     |                     |
| SECTION:   |             | 36                                 |                     |                     |                     |
| PORT OF TACOMA BM#   |             |                                    |                     |                     |                     |
| VERT:  |             |                                    |                     |                     |                     |
| DRAWING SCALE:   |             | AS SHOWN                           |                     |                     |                     |
| BID SET  |             | 201105.01                          |                     |                     |                     |
| PHASE:   |             | 14                                 |                     |                     |                     |
| CONT./CONS:  |             | 071907                             |                     |                     |                     |
|  |             |                                    |                     |                     |                     |