

[06/22/2026]

TO: PLAN HOLDERS LIST

SUBJECT: PROCUREMENT NO. 022026-1023  
MAAF PAVEMENT MAINTENANCE 2026

### **ADDENDUM NUMBER 01**

This addendum is issued to amend the following:

#### **Plan Sheet C1.0**

- Added phasing areas

#### **00 01 15 – List of Drawing Sheets**

- Renamed Sheet C1.0 to Overall Site and Phasing Plan

#### **00 11 13 – Advertisement for Bids**

- Sealed Bid Date/Time/Location revised from ~~2:00 PM June 25<sup>th</sup>, 2026~~ to **2:00 PM July 1<sup>st</sup>, 2026**

#### **00 41 00 – Bid Form**

- Deleted Bid Item #7 Tack Coat
  - o Bid Item #8 revised Bid Item #7, Bid Item #9 revised to Bid Item #8

#### **00 73 46 – Washington State Prevailing Wage Rates**

1. Revised Bid Date 1.01.B.1 - Based on the Bid Date, the applicable effective date for prevailing wages for this Project is July 1<sup>st</sup>, 2026.

#### **01 14 00 – Work Restrictions**

- Revised Section 1.02 – Contractor Access and Use of Premises

#### **01 20 00 – Price and Payment Procedures**

- Deleted Bid Item #7 Tack Coat
  - o Bid Item #8 revised Bid Item #7, Bid Item #9 revised to Bid Item #8

**PART 1 - GENERAL**

1.01 SUMMARY

A. Contract Drawings: The following drawings are a part of the Contract Documents:

[1]

Sheet No.	Drawing Title
G1.0	COVER SHEET
G1.1	GENERAL CIVIL NOTES
C1.0	OVERALL SITE <b>AND PHASING</b> PLAN
D1.0	OVERALL DEMOLITION AND TESC PLAN
D1.1	ENLARGED DEMOLITION AND TESC PLAN
D1.2	ENLARGED DEMOLITION AND TESC PLAN
D1.3	ENLARGED DEMOLITION AND TESC PLAN
D1.4	ENLARGED DEMOLITION AND TESC PLAN
D1.5	ENLARGED DEMOLITION AND TESC PLAN
D1.6	ENLARGED DEMOLITION AND TESC PLAN
C2.0	OVERALL SURFACING, GRADING AND DRAINAGE PLAN
C2.1	ENLARGED SURFACING, GRADING AND DRAINAGE PLAN
C2.2	ENLARGED SURFACING, GRADING AND DRAINAGE PLAN
C2.3	ENLARGED SURFACING, GRADING AND DRAINAGE PLAN
C2.4	ENLARGED SURFACING, GRADING AND DRAINAGE PLAN
C2.5	ENLARGED SURFACING, GRADING AND DRAINAGE PLAN
C2.6	ENLARGED SURFACING, GRADING AND DRAINAGE PLAN
C3.0	MISC. SECTIONS AND DETAILS

**PART 2 - PRODUCTS - NOT USED**

**PART 3 - EXECUTION - NOT USED**

**END OF SECTION**

This page intentionally left blank

## MARSHALL AVENUE AUTO FACILITY PAVEMENT MAINTENANCE 2026

### PROJECT NO. 201243.01 | CONTRACT NO. PA000000170

Scope of Work: The Work required for this Project includes:  
sawcutting, milling, paving and joint sealing.  
Per the work restrictions, the Work shall be completed in (7) seven consecutive days.

Bid Estimate: Estimated cost range is \$750,000 to \$850,000,  
plus Washington State Sales Tax (WSST).  
In accordance with RCW 39.04.320, fifteen (15) percent apprenticeship participation is required for certain projects estimated to cost one million (\$1,000,000) dollars or more. Bidders may contact the Department of Labor and Industries, Specialty Compliance Services Division, Apprenticeship Section, P.O. Box 44530, Olympia, WA 98504-4530, by phone (360) 902-5320, or e-mail at [Apprentice@lni.wa.gov](mailto:Apprentice@lni.wa.gov), to obtain information on available apprenticeship programs.  
In accordance with new legislation HB 1050 all port districts are required to add the requirement that **apprentices must perform** 15% or more of the total labor hours in public works contracts estimated at \$1 million or more. If the 15% apprenticeship labor hours is met the contractor will receive an incentive fee of \$1,000. If less than 15% apprenticeship labor hours is used a \$500 decrease in the total amount of the contract will be taken for not meeting the required apprenticeship labor hours. L&I will monitor apprenticeship labor hours.

Sealed Bid Date/ Time/Location: Bids will be received at the Front Reception Desk, Port Administration Office, One Sitcum Plaza, Tacoma, Washington 98421 until **2:00 P.M. on ~~June 25th~~ July 1st**, 2026, at which time they will be publicly opened and read aloud and the apparent low bid will be determined.

Pre-Bid A pre-Bid conference and site visit have been set for June 10th, 2026 at 1:00 PM.

Conference and Site Tour: The site visit will convene at the project site.  
The following Personal Protective Equipment is required for the site visit: sturdy shoes and reflective vest.  
Attendees will be required to sign a Release and Acceptance of Responsibility and Acknowledgement of Risks Form prior to entering the site and shall provide their own Personal Protection Equipment (PPE) as required above.

- Bid Security:** Each Bid must be accompanied by a Bid security in an amount equal to five (5) percent of the Base Bid in a form allowed by the Instructions to Bidders.
- Contact Information:** Any questions to the Port may be submitted to the Procurement Department through the Procurement and Question Submission Portal (Portal link is accessible via this specific procurements website. See left side of page.). A direct link is also available here: [Procurement and Question Portal Link](#). No oral responses will be binding by the Port. Instructions for utilizing the portal can be found here: [Procurement and Question Submission Portal Instructions](#). Questions will not be accepted after seven (7) days prior to the Bid Date.
- Bidding Documents:** Plans, Specifications, Addenda, and Plan Holders List for this Project are available on-line through The Port of Tacoma's Website portoftacoma.com. Click on "Contracts," "Procurement," and then the Procurement Number PA000000170. Bidders must subscribe to the Holder's List on the right hand side of the screen in order to receive automatic email notification of future addenda and to be placed on the Holder's List. Holder's Lists will be updated regularly and posted to the specific procurements page. Additional Instructions available in Section 00 21 00 - Instructions to Bidders.
- Public Works Training Requirements:** Effective July 1, 2019, all businesses are required to have training before bidding on public works projects and prevailing wage under RCW 39.04.359 and RCW 39.12, or is on the list of exempt businesses maintained by the Department of Labor and Industries. The bidder must designate a person or persons to be trained on these requirements. The training will be provided by the Department of Labor and Industries or by a training provider whose curriculum is approved by the Department of Labor and Industries. Please refer to Labor and Industries' web site ([https://www.lni.wa.gov/TradesLicensing/PrevWage/Contractors/Training.asp?utm\\_medium=email&utm\\_source=govdelivery](https://www.lni.wa.gov/TradesLicensing/PrevWage/Contractors/Training.asp?utm_medium=email&utm_source=govdelivery)) for more information and training dates, requirements, and exemptions. Failure to attend this training could result in a determination of "not responsible" and the bidder not being awarded a public works contract.

**END OF SECTION**

**BIDDER'S NAME:** \_\_\_\_\_

**PROJECT TITLE: MARSHALL AVENUE AUTO FACILITY PAVEMENT MAINTENANCE 2026**

The undersigned Bidder declares that it has read the Contract Documents (including documents provided by reference), understands the conditions under which the Work will be performed, has examined the Project site, and has determined for itself all situations affecting the Work herein Bid upon. Bidder proposes and agrees, if this Bid is accepted, to provide at Bidder's own expense, all labor, machinery, tools, materials, etc., including all Work incidental to, or described or implied as incidental to such items, according to the Contract Documents, and that the Bidder will complete the Work within the time stated, and that Bidder will accept in full the lump sum or unit price(s) set forth below:

ITEM NO.	DESCRIPTION OF ITEM	QTY	UOM	UNIT PRICE	EXTENDED PRICE (QTY. x UNIT PRICE)
1	Mobilization and Demobilization	1	LS		
2	Project Administration	1	LS		
3	TESC	1	LS		
4	Milling	22,800	SY		
5	Saw Cutting	3,150	LF		
6	Earthworks	1	LS		
<del>7</del>	<del>Tack Coat</del>	<del>22,800</del>	<del>SY</del>		
<del>87</del>	Hot Mix Asphalt Pavement	2,530	Tons		
<del>98</del>	Asphalt Joint	13,250	LF		

[1]

TOTAL BID AMOUNT	
10.3% WASHINGTON STATE SALES TAX (WSST) ON BASE BID SUBTOTAL	
BID TOTAL (WITH WSST)	

Note: Show prices in figures only.

Evaluation of Bids. In accordance with the provisions of the Contract Documents, Bids will be evaluated to determine the lowest Base Bid Subtotal offered by a responsible Bidder submitting a responsive Bid.

Principal Subcontractors/Suppliers. For Bids greater than one million (\$1,000,000) dollars, the Bidder shall list below the name of each subcontractor or supplier to whom the Bidder proposes to subcontract the portions of the work listed below, or name itself for the work, in accordance with RCW 39.30.060.

Work to be performed	License Number	Name of Firm
HVAC (Heating, Ventilation, and Air Conditioning) Work		

Plumbing Work		
Electrical Work		
Structural Steel Installation		
Rebar Installation		

Non-Collusion Representation. The Bidder declares under penalty of perjury that the Bid submitted is genuine and not a sham or collusive bid, or made in the interest or on behalf of any person or firm not therein named; and further represents that the Bidder has not directly or indirectly induced or solicited any other bidder to submit a sham bid, or encouraged any other person or corporation to refrain from bidding; and that the Bidder has not in any manner sought by collusion to secure to the Bidder an advantage over any other bidder or bidders.

RCW 39.04.350 Certification. The Bidder represents and certifies, under penalty of perjury, that within the three- (3-) year period immediately preceding the Bid Date, the Bidder has not been determined by a final and binding citation and notice of assessment issued by the Department of Labor and Industries, nor through a civil judgment entered by a court of limited or general jurisdiction, to have willfully violated, as defined in RCW 49.48.082, any provision of Chapters 49.46, 49.48, nor 49.52 RCW.

Addenda. Bidder acknowledges receipt and acceptance of all Addenda through No. \_\_\_\_ (Identify Last Addenda By Number)

Bid Security. A certified check, cashier's check, or other obligation of a bank, or a bid bond in substantially the form set forth in Section 00 43 13, Bid Security Form for at least five (5) percent of the Base Bid Subtotal, shall be submitted with this Bid.

Apprenticeship Requirements. For Bids greater than one million (\$1,000,000) dollars, the apprentice labor hours required for this project are fifteen (15) percent of the total labor hours. The Bidder agrees to utilize this level of apprentice participation.

\_\_\_\_\_  
 Name of Firm

\_\_\_\_\_  
 Date

\_\_\_\_\_  
 Signature

\_\_\_\_\_  
 By Title

\_\_\_\_\_  
 Mailing Address

\_\_\_\_\_  
 City, State Zip Code

\_\_\_\_\_  
 Telephone Number

\_\_\_\_\_  
 Email Address

\_\_\_\_\_  
 WA State Contractor's License No.

\_\_\_\_\_  
 Employment Security Department No.

---

Identification of Bidder as a sole proprietor, a partnership, a joint venture, a corporation, or another described form of legal entity

**END OF SECTION**

This page intentionally left blank

## PART 1 - GENERAL

### 1.01 PREVAILING AND OTHER REQUIRED WAGES

- A. The Contractor shall pay (and shall ensure that all Subcontractors of any tier pay) all prevailing wages and other wages (such as Davis-Bacon Act wages) applicable to the Project.
- B. Pursuant to RCW 39.12, "Prevailing Wages on Public Works," no worker, laborer, or mechanic employed in the performance of any part of the Work shall be paid less than the "prevailing rate of wage" in effect as of the date that bids are due.

[1] 1. Based on the Bid Date, the applicable effective date for prevailing wages for this Project is ~~June 25th, 2026~~ July 1st, 2026.

- C. The State of Washington prevailing wage rates applicable for this public works Project, which is located in Pierce County, may be found at the following website address of the Department of Labor and Industries:

<https://www.lni.wa.gov/licensing-permits/public-works-projects/prevailing-wage-rates/>

- D. The schedule of the prevailing wage rates is made a part of the Contract Documents by reference as though fully set forth herein, and a printed copy of the applicable prevailing wage rates are also available for viewing at the Port Administration Building, located at 1 Sitcum Plaza, Tacoma, WA 98421 (253-383-5841). Upon request to the Procurement Department at [procurement@portoftacoma.com](mailto:procurement@portoftacoma.com), the Port will email or mail a hard copy of the applicable Journey Level prevailing wages for this Project.

- E. Questions relating to prevailing wage data should be addressed to the Industrial Statistician.

Mailing Address: Washington State Department of Labor and Industries  
Prevailing Wage Office  
P.O. Box 44540  
Olympia, WA 98504

Telephone: (360) 902-5335

Facsimile: (360) 902-5300

- 1. If there is any discrepancy between the provided schedule of prevailing wage rates and the published rates applicable under WAC 296-127-011, the applicable published rates shall apply with no increase in the Contract Sum. It is the Contractor's responsibility to ensure that the correct prevailing wage rates are paid.

- F. Statement to Pay Prevailing Wages

- 1. Prior to any payment being made by the Port under this Contract, the Contractor, and each Subcontractor of any tier, shall file a Statement of Intent to Pay Prevailing Wages with the Department of Labor and Industries for approval.
- 2. The statement shall include the hourly wage rate to be paid to each classification of workers entitled to prevailing wages, which shall not be less than the prevailing rate of wage, and the estimated number of workers in each classification employed on the Project by the Contractor or a Subcontractor of any tier, as well as the Contractor's contractor registration number and other information required by the Department of Labor and Industries.

3. The statement, and any supplemental statements, shall be filed in accordance with the requirements of the Department of Labor and Industries. No progress payment shall be made until the Port receives such certified statement.
- G. The Contractor shall post, in a location readily visible to workers, at the Project site: (i) a copy of the Statement of Intent to Pay Prevailing Wages approved by the Industrial Statistician of the Department of Labor and Industries and (ii) the address and telephone number of the Industrial Statistician of the Department of Labor and Industries to whom a complaint or inquiry concerning prevailing wages may be directed.
- H. If a State of Washington prevailing wage rate conflicts with another applicable wage rate (such as Davis-Bacon Act wage rate) for the same labor classification, the higher of the two shall govern.
- I. Pursuant to RCW 39.12.060, if any dispute arises concerning the appropriate prevailing wage rate for work of a similar nature, and the dispute cannot be adjusted by the parties in interest, including labor and management representatives, the matter shall be referred for arbitration to the Director of the Department of Labor and Industries, and his or her decision shall be final and conclusive and binding on all parties involved in the dispute.
- J. Immediately following the end of all Work completed under this Contract, the Contractor and each Subcontractor of any tier, shall file an approved Affidavit of Wages Paid with the Department of Labor and Industries.
- K. The Contractor shall defend (at the Contractor's sole cost, with legal counsel approved by Port), indemnify, and hold the Port harmless from all liabilities, obligations, claims, demands, damages, disbursements, lawsuits, losses, fines, penalties, costs, and expenses, whether direct, indirect, including, but not limited to, attorneys' fees and consultants' fees and other costs and expenses, from any violation or alleged violation by the Contractor or any Subcontractor of any tier of RCW 39.12 ("Prevailing Wages on Public Works") or RCW Title 51 ("Industrial Insurance"), including, but not limited to, RCW 51.12.050.

**PART 2 - PRODUCTS - NOT USED**

**PART 3 - EXECUTION - NOT USED**

**END OF SECTION**

## PART 1 - GENERAL

### 1.01 SUMMARY

- A. This Section specifies work sequence and constraints.
  - 1. See Section 1.02 for restrictions regarding work duration.
  - 2. See Section 01 41 00 Regulatory Requirements for permit restrictions.
- B. The purpose of the milestones, sequence and limitations of construction are to ensure that the Contractor understands the requirements and limitations on its work by the specific characteristics of the Contract, schedules and conducts work in a manner consistent with achieving these purposes, and complies with the construction schedule, the specific sequence, constraints, milestones and limitations of work specified.
- C. Sequence of construction. Plan the sequence of construction to accommodate all the requirements of the specifications. The Contract Price shall include all specified requirements as described in this Section.

### 1.02 CONTRACTOR ACCESS AND USE OF PREMISES

#### A. Activity Regulations

- 1. The continuous pavement work area adjacent to the Auto Processing Building shall be milled, paved, and joint sealed over one weekend with work beginning at 4:00 P.M. Friday and finishing by Monday at 6:00 A.M. Monday. See Drawing C1.0 for the noted area.
- 2. All project work shall be scheduled to be complete in (7) seven consecutive days beginning Friday at 4:00 P.M. and ending the following Friday at 4:00 P.M. or over (3) weekends with Contractor work beginning Fridays at 4:00 P.M. and ending Mondays at 6:00 A.M.
  - 4.a. The (7) consecutive days includes the weekend paving required under 1.02.A.1.
- ~~2.3. Ensure Contractor personnel deployed to the project become familiar with and follow all regulations or restrictions established by the Engineer.~~
- ~~3. Cars enter and exit from the warehouse shown on Drawing C1.0. Paving shall be scheduled so that traffic from the building is not blocked concurrently to the south and the west. Facility vehicles must have access to one side of the building during normal business hours Monday through Friday, 7 a.m. to 5 p.m..~~
- 4. The Tenant must maintain unimpeded access to either Truck Lot Entrance #1 or #2. Only one of the Truck Lot Entrance Paving Area Approaches may be out of service at a given time. Contractor must fully complete each access before commencing any work on the other access. See Drawing C1.0 for the noted area.
- 5. Goose Neck Paving Area to be scheduled to not coincide with a ship discharge operation. If the Goose Neck Paving Area cannot be reasonably incorporated into the paving schedule, this work area may be removed from the Contract. See Drawing C1.0 for the noted area.

#### B. Working Facility

- 1. The Facility will remain in operation for the duration of construction. The Contractor shall conduct all items of the Work in such a manner as to prevent interference with the normal operations of the Facility.

2. The Contractor shall limit their operations and traffic routes to the areas and paths provided by the Engineer.

C. Work Site Regulations

1. Keep within the limits of work and assigned avenues of ingress and egress. Do not enter any areas outside the designated work location unless previously approved by the Engineer. The Contractor must comply with the following conditions:
  - a. Restore all common areas to a clean and useable condition that permits the resumption of Tenant operations after the Contractor ceases daily work.
  - b. Be responsible for control and security of Contractor-owned equipment and materials at the work site. Report to Port Security (phone (253) 383-9472) any missing/lost/stolen property.
  - c. Ensure all materials, tools and equipment will be removed from the site or secured within the designated laydown area at the end of each shift.
2. Haul routes and gate access shall be coordinated through the Engineer. The Contractor shall expect gate access may change at the discretion of the Engineer.

**PART 2 - PRODUCTS**

**PART 3 - EXECUTION**

**END OF SECTION**

## **PART 1 - GENERAL**

### 1.01 SUMMARY

- A. Procedures for preparation and submittal of applications for progress payments.

### 1.02 PAYMENT PROCEDURES

- A. Monthly pay estimates shall clearly identify the work performed for the given time period based on the approved Schedule of Values.
  - 1. At the Pre-construction meeting, the Engineer and the Contractor shall agree upon a date each month when payment applications shall be submitted.
- B. For each pay estimate the Contractor shall submit the following:
  - 1. Completed Contractor invoice and updated Schedule of Values tracking sheet as required by Division 01 or as established by the Engineer.
  - 2. Baseline Project Schedule and narrative updated as required by Section 01 32 16 of the Project Manual.
  - 3. Completed "Amounts Paid to Subcontracts and Suppliers" showing total contract amount, amount paid this estimate, total paid to date, and balance owing.
  - 4. Completed "Conditional Release and Waiver of Liens and Claims."
  - 5. An estimated cashflow statement projecting the Contractor's monthly billings on the project shall be submitted with each payment application.
- C. Prior to submitting a payment application, the Contractor and Engineer shall meet each month to review the work accomplished to determine the actual quantities including labor, materials and equipment charges to be billed.
  - 1. Prior to the payment application meeting, the Contractor shall submit to the Engineer all measurement documentation as referenced in these contract documents; to include all measurement by weight, volume or field.
  - 2. For all change work being done on a force account basis, the Contractor shall submit prior to meeting with Engineer all Force Account back-up documentation as required to process the payment application where Force Account work is being billed. The Engineer and the Contractor shall review the documentation at the payment application meeting to verify quantities and review the work accomplished.
  - 3. The Contractor shall bring a copy of all documentation to the pay application meeting with the Engineer.
  - 4. The Contractor shall submit the updated baseline project schedule for review prior to submitting the payment application to ensure the payment processing is not held up due to necessary schedule revisions.
- D. Following the Engineers' review, the Contractor shall submit the agreed upon pay estimate electronically, with complete supporting documentation attached, using Adobe PDF file format to [cpinvoices@portoftacoma.com](mailto:cpinvoices@portoftacoma.com).

### 1.03 PAYMENT PRICING

- A. Pricing for the various lump sum or unit prices in the Bid Form, as further specified herein, shall include all compensation to be received by the Contractor for furnishing all tools, equipment, supplies, and manufactured articles, and for all labor, operations, and incidentals appurtenant to the items of work being described, as necessary to complete the various items of the work in accordance with the requirements of the Contract Documents.
- B. Pricing also includes all costs of compliance with the regulations of public agencies having jurisdiction, including safety and health requirements of the Occupational Safety and Health Administration of the U.S. Department of Labor (OSHA).
- C. No separate payment will be made for any item that is not specifically set forth in the Bid Form, and all costs therefore shall be included in the prices named in the Bid Form for the various appurtenant items of work.
- D. All other work not specifically mentioned in the measurement and payment sections identified below shall be considered incidental to the work performed and merged into the various unit and lump sum prices bid. Payment for work under one item will not be paid for under any other item.
- E. The Port of Tacoma reserves the right to make changes should unforeseen conditions necessitate such changes. Where work is on a unit price basis, the actual quantities occasioned by such changes shall govern the compensation.

### 1.04 LUMP SUM MEASUREMENT

- A. Lump sum measurement will be for the entire item, unit of Work, structure, or combination thereof, as specified and as indicated in the Contractor's submitted bid.
  - 1. If the Contractor requests progress payments for lump sum items, such progress payments will be made in accordance with an approved Schedule of Values. The quantity for payment for completed work shall be an estimated percentage of the lump sum amount, agreed to between the Engineer and Contractor, payable in monthly progress payments in increments proportional to the work performed in amounts as agreed between the Engineer and the Contractor.

### 1.05 MEASUREMENT OF QUANTITIES FOR UNIT PRICES

- A. Measurement Standards:
  - 1. All Work to be paid for at a contract price per unit measurement, as indicated in the Contractor's submitted bid, will be measured by the Engineer in accordance with United States Standard Measures.
- B. Measurement by Weight:
  - 1. Unless shipped by rail, material to be measured and paid for by weight shall be weighed on sealed scales regularly inspected by the Washington State Department of Agriculture's Weights and Measures Section or its designated representative. Measurement shall be furnished by and at the expense of the Contractor. All weighing, measuring, and metering devices shall be suitable for the purpose intended and shall conform to the tolerances and specifications as outlined in Washington State Department of Transportation Standard Specifications, Division 1, General Requirements, Article 1-09.2, Weighing Equipment.

2. Provide or utilize platform scales of sufficient size and capacity to permit the entire vehicle or combination of vehicles to rest on the scale platform while being weighed. Combination vehicles may be weighed as separate units provided they are disconnected while being weighed. Scales shall be inspected and certified as often as the Engineer may deem necessary to ascertain accuracy. Costs incurred as a result of regulating, adjusting, testing, inspecting, and certifying scales shall be borne by the Contractor.
  3. A licensed weighmaster shall weigh all Contractor-furnished materials. The Engineer may be present to witness the weighing and to check and compile the daily record of such scale weights. However, in any case, the Engineer will require that the Contractor furnish weight slips and daily summary weigh sheets. In such cases, furnish a duplicate weight slip or a load slip for each vehicle weighed, and deliver the slip to the Engineer at the point of delivery of the material.
  4. Trucks used to haul material being paid for by weight shall be weighed empty daily and at such additional times as the Engineer may require. Each truck shall bear a plainly legible identification mark. The Engineer may require the weight of the material be verified by weighing empty and loaded trucks on such other scales as the Engineer may designate.
- C. Measurement by Area: Measurement by area will be by the square dimension shown on the Contract Drawings or as specified. Method of square measurement will be as specified.
- D. Linear Measurement: Linear measurement will be by the linear dimension listed or indicated in the Contractor's submitted bid. Unless otherwise indicated, items, components, or Work to be measured on a linear basis will be measured at the centerline of the item in place.
- E. Field Measurement for Payment:
1. The Contractor shall take all measurements by providing equipment, workers, and survey crews as required to measure quantities in accordance with the provisions for measurement specified herein. No allowance will be made for specified tolerances.
  2. The Engineer will verify all quantities of Work performed by the Contractor on a unit-price basis, for progress payment purposes.

#### 1.06 REJECTED, EXCESS, OR WASTED MATERIALS

- A. Quantities of material wasted or disposed of in a manner not called for under the Contract; rejected loads of material, including material rejected after it has been placed by reasons of the failure of the Contractor to conform to the provisions of the Contract; material not unloaded from the transporting vehicle; material placed outside the lines indicated on the Contract Drawings or established by the Engineer; or material remaining on hand after completion of the Work, will not be paid for, and such quantities shall not be included in the final total quantities. No additional compensation will be permitted for loading, hauling, and disposing of rejected material.

#### 1.07 MEASUREMENT AND PAYMENT

- A. Item #1: Mobilization and Demobilization

1. Payment for Mobilization and Demobilization shall be for preparatory work and operations performed by the Contractor including, but not limited to, those necessary for the movement of its personnel, equipment, supplies and incidentals to and from the project site; temporary facilities and controls; for other work and operations which it must perform or costs it must incur before beginning production work on the various items on the project site, and for removal of personnel, equipment, supplies, offices, traffic control, fencing, and other incidentals from the site. This bid item shall include transport of Contractor employees in branded company vehicles from the employee parking area through the secured facility perimeter to the Work areas.
2. Mobilization and Demobilization shall be paid at the lump sum price listed in the Contractor's submitted bid. Incremental payment shall be made for each location as follows:
  - a. 40% after completion of 5% of the total contract amount of other bid items have been earned.
  - b. 40% after completion of 20% of the total contract amount of other bid items have been earned.
  - c. 20% after completion of all work on the project has been completed, including cleanup and acceptance of the project by the Port.

B. Item #2: Project Administration

1. Item Description: The Work of this item includes all administrative costs associated with administering and supervising the project including, but not limited to required pre-construction meetings, supervision of personnel, coordination of all work activities, coordination of subcontractors and/or suppliers, preparation and transmittal of submittals, for premiums on bonds and insurance for the project, and project overhead.  
  
This item shall include an on-site pre-construction meeting with the City of Tacoma for issuance of SDEV26-0039.
2. Measurement: This item will be measured based on a percentage complete for the overall lump sum amount.
3. Payment: This item will be paid for at the Contract lump sum price as specified in the Contractor's submitted bid, in accordance with the approved Schedule of Values.

C. Item #3: TESC

1. Item Description: The Work of this item includes adopting and taking ownership to the Engineer-provided refence SWPPP or developing and implementing a new SWPPP that meets or exceeds all the TESC requirements contained in the Specifications and Drawings. This item includes all tools, labor and materials as required to implement and maintain the CSWPPP and construction stormwater permit.
2. Measurement: This item will be measured based on a percentage complete for the overall lump sum amount.
3. Payment: This item will be paid for at the Contract lump sum price as specified in the Contractor's submitted bid, in accordance with the approved Schedule of Values.

D. Item #4: Asphalt Removal

1. Item Description: The Work of this item shall include all work, labor, and equipment associated with the profiling, grinding, hauling, and disposal of the existing asphalt pavement. Final quantities shall be used to determine measurement for payment quantities.
2. Measurement: This item will be measured by square yard.
3. Payment: This item will be paid for based on actual quantities for the period being billed based on field measurements.

E. Item #5: Asphalt Saw Cutting

1. Item Description: The unit price paid per linear foot for this item shall include all work, labor, and equipment associated with the cutting of existing asphalt.
2. Measurement: This item will be measured by linear foot.
3. Payment: This item will be paid for based on actual quantities for the period being billed based on field measurements.

F. Item #6: Earthworks

1. Item Description: The Work of this item includes all work, labor, and equipment associated with the profiling and compaction of existing pavement base material as necessary to provide a pavement base.
2. Measurement: This item will be measured by Lump Sum.
3. Payment: This item will be paid for based on actual quantities for the period being billed based on field measurements.

[1] ~~G. Item #7: Asphalt Tack Coat~~

- ~~1. Item Description: The unit price paid per square yard for this item shall include all material, labor, and equipment associated with the preparation, furnishing, hauling, placing, and spreading of the material~~
- ~~2. Measurement: This item will be measured by square yard.~~
- ~~3. Payment: This item will be paid for based on actual quantities for the period being billed based on field measurements.~~

[1] ~~H.G.~~ Item #87: Hot Mix Asphalt Pavement

1. Item Description: The unit price paid per ton for this item shall include all labor and equipment associated with the preparation, furnishing, hauling, placing, spreading, and compacting the material.
2. Measurement: This item will be measured by TON.
3. Payment: This item will be paid for based on actual quantities for the period being billed based on truck tickets.

[1] ~~H.~~ Item #98: Asphalt Joint

1. Item Description: The unit price per linear foot for this item shall include all material, labor, and equipment associated with furnishing and placing asphalt joint sealant.
2. Measurement: This item will be measured by Linear Foot (LF).
3. Payment: This item will be paid for based on actual quantities for the period being billed.

**PART 2 - PRODUCTS - NOT USED**

**PART 3 - EXECUTION - NOT USED**

**END OF SECTION**

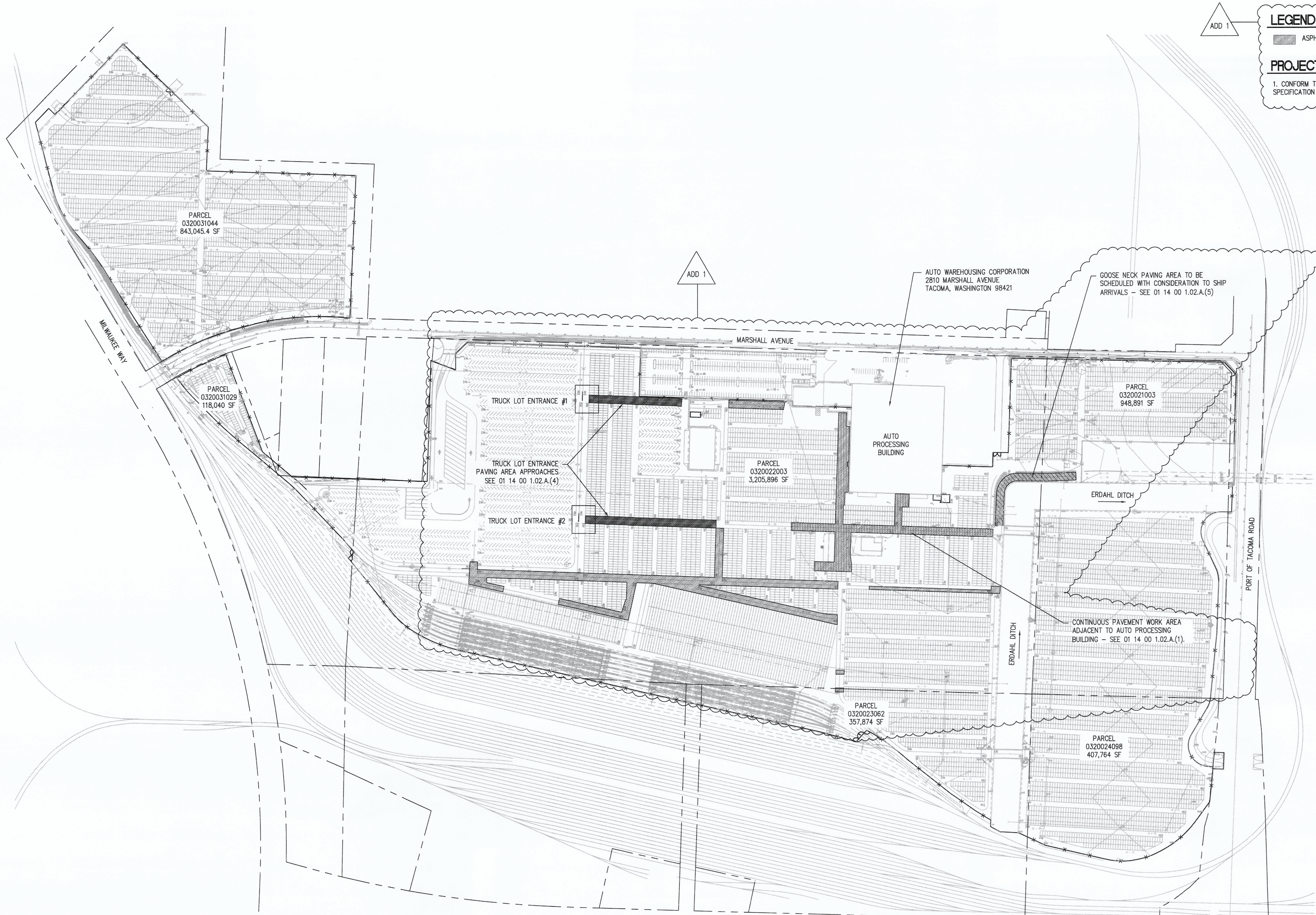

ADD 1

**LEGEND**

ASPHALT REPLACEMENT AREAS

**PROJECT PHASING**

1. CONFORM TO PROJECT PHASING REQUIREMENTS IN SPECIFICATION SECTION 01 14 00 WORK RESTRICTIONS.

ADD 1

**OVERALL SITE AND PHASING PLAN**

SCALE: 1"=200'



HORIZONTAL SCALE: 1"=200'

200 0 200 400

**sh** **sitts & hill**

CIVIL | STRUCTURAL | ARCHITECTURAL | SURVEY

4816 CENTER STREET | TACOMA, WA 98409

PHONE: (253) 474-9449 | www.sittshill.com

Project No.: 21,035 Project Mgr.: RCH

Proj. Engineer: RCH Proj. Drafter: KLK

6743

**C1.0**

SH #3 OF 18

**MARSHALL AVE AUTO FACILITY PAVEMENT MAINTENANCE 2026**

OVERALL SITE AND PHASING PLAN

APPROVED: *[Signature]*

DIRECTOR ENG. DATE: korimim Jun 18, 2026

PRINTED BY: korimim Jun 18, 2026

PROJ. ENGR DATE: RCH 02.11.2026

CHECKED BY DATE: RCH 02.11.2026

PORT ADDRESS: ONE SITCUM PLAZA TACOMA, WA 98421

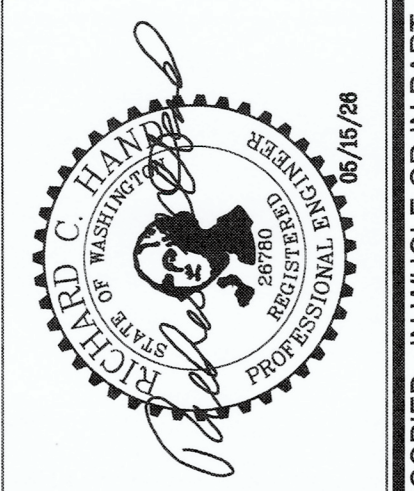

MARK:	REVISION:	BY:	DATE:
	ADDENDUM 1	RCH	06-18-2026

THIS DRAWING IS THE PROPERTY OF THE PORT OF TACOMA AND SHALL NOT BE USED ON OTHER WORK, DISCLOSED, COPIED, IN WHOLE OR IN PART, WITHOUT WRITTEN PERMISSION