

TEMPORARY ESCP - BASIN A

SCALE: 1" = 30'

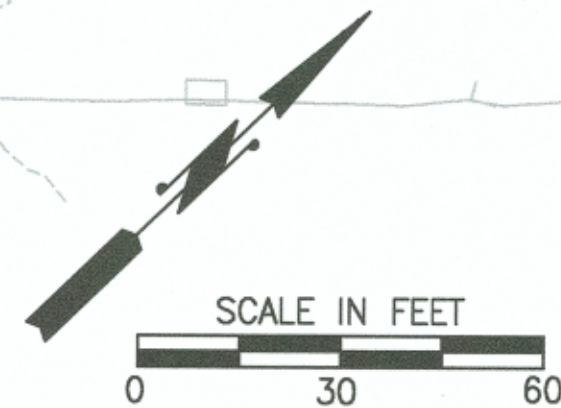

ESCP LEGEND:

- INLET PROTECTION
- TEMPORARY CONSTRUCTION FENCE
- CONSTRUCTION ACCESS GATE
- BARREL WITH FLASHING BARRICADE LIGHTS
- TEMPORARY CURB, SEE SPECIFICATIONS
- TEMPORARY TREATMENT SYSTEM
- TEMPORARY PUMP SYSTEM

NOTES:

1. PROVIDE AND INSTALL TEMPORARY CONSTRUCTION FENCING AND GATES AROUND WORK LIMITS; ADJUST AND RELOCATE FENCING ACCORDING TO PHASING, SECURITY, AND PORT AND TENANT REQUIREMENTS.
2. PROVIDE AND INSTALL BARREL WITH FLASHING BARRICADE LIGHTS.
3. PROVIDE AND INSTALL INLET PROTECTION PER 1/C05.
4. AT EACH CONSTRUCTION ENTRANCE/GATE CONTRACTOR SHALL ESTABLISH AND MAINTAIN A TEMPORARY ASPHALT BARRIER TO CONTROL RUNOFF.
5. CONTRACTOR SHALL PROVIDE VACUUM SWEEPING AROUND THE WORK LIMITS. NO AGGREGATE, PAVEMENT, SOIL, OR OTHER MATERIALS SHALL BE ALLOWED TO "TRACK" ACROSS THE TERMINAL. SEE SPECIFICATIONS FOR FURTHER REQUIREMENTS.
6. CONTRACTOR SHALL INSTALL TEMPORARY CURB AROUND WORK ZONES.
7. AC PAVEMENT REMOVAL AND LIMITS OF EXCAVATION. THE SITE IS FULLY PAVED AND THE CONTRACTOR SHALL MARK ALL SAWCUT LIMITS AND/OR EXCAVATION ZONES WITH SPRAY PAINT PRIOR TO REMOVAL.
8. CONTRACTOR SHALL PROVIDE PLASTIC COVERING FOR SOIL STOCKPILES AND AGGREGATE STOCKPILE MATERIALS WITH RUNOFF COLLECTED AND TREATED PER NOTE 9.
9. CONTRACTOR SHALL PROVIDE A TEMPORARY TREATMENT SYSTEM CAPABLE OF TREATING ALL WATER DISCHARGED ACCORDING TO THE APPLICABLE PERMIT REQUIREMENTS. SEE SPECIFICATIONS.
10. INSTALL GROUNDWATER DEWATERING SYSTEM AS NEEDED.
11. INSTALL TEMPORARY STORMWATER BYPASS PUMPING SYSTEM. CONTRACTOR SHALL SECURE THE EXISTING MANHOLE LID/OPENING DURING REROUTE. SEE SPECIFICATIONS.
12. WATER MANAGEMENT: CONTRACTOR SHALL BE RESPONSIBLE FOR MANAGING ALL SURFACE RUNOFF, GROUNDWATER, AND TEMPORARY STORMWATER REROUTE FLOWS FOR THE DURATION OF THE WORK. SEE SPECIFICATIONS.

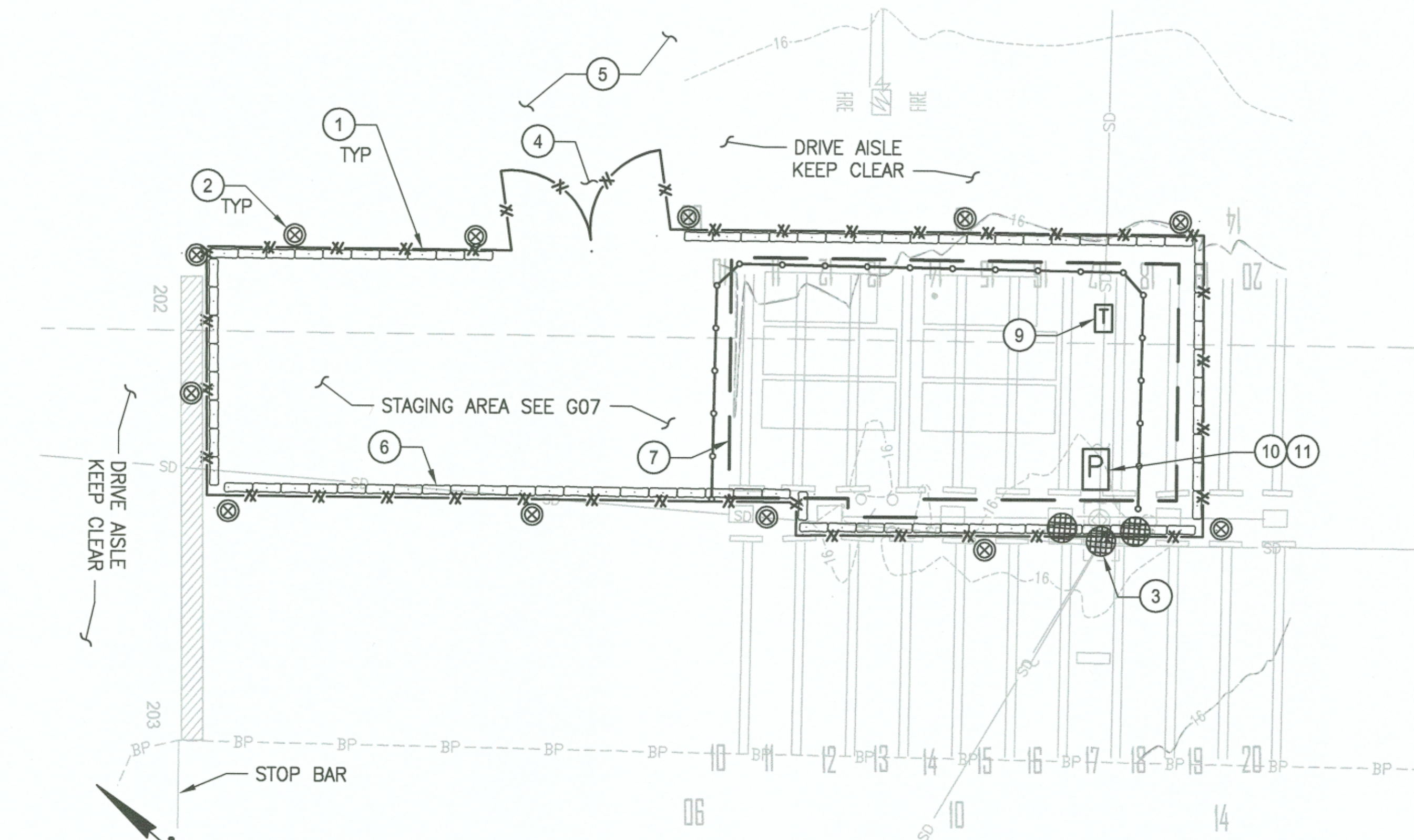

TEMPORARY ESCP - BASIN B

SCALE: 1" = 20'

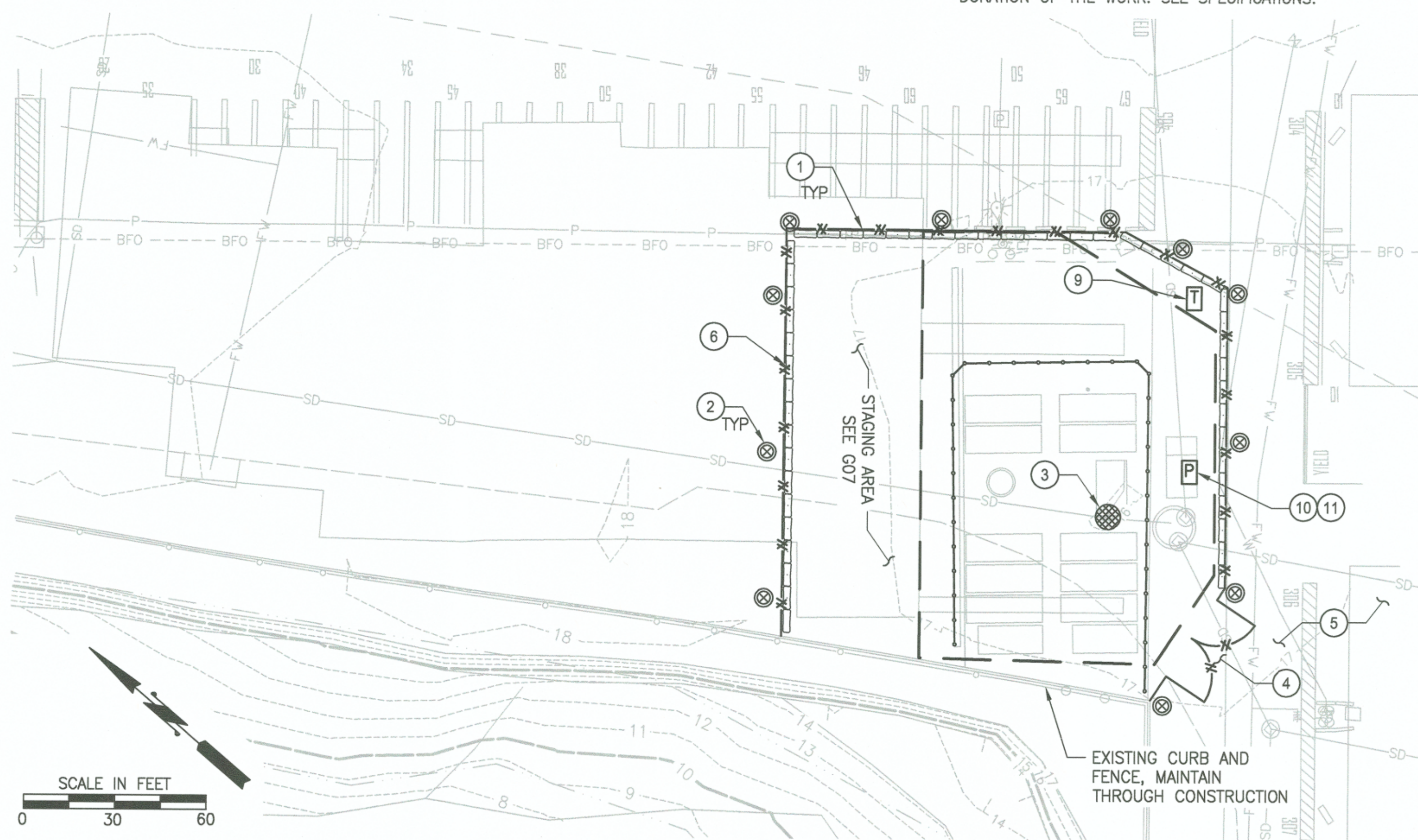

TEMPORARY ESCP - BASIN C

SCALE: 1" = 30'



6583 SH 14 OF 47	WEST SITCUM STORMWATER TREATMENT TEMPORARY ESCP - BASINS A, B, & C				APPROVED: <i>Steve Wierzbicki</i> 5/16/18		DLD JAN 2018	CHECKED BY CIS	DATE APR 2018
	CONTRACTOR: 070664	TOWNSHIP: 21N	RANGE: 3E	SECTIONS: 33 & 34	DIRECTOR ENG. DATE 5/16/18	PRINTED BY: anderbru May 16, 2018	PROJ. ENGR DATE	CIS	APR 2018
	M. ID: 201024.01	DAT-HRZ: WA83-S	VERT: MLW	PARCEL: SEE G02	PORT ADDRESS: ONE SITCUM PLAZA	TACOMA, WA 98401-1837	DATE 5/16/18	BY: CIS	APPR: SW
	PHASE: BID SET	DRAWING SCALE: AS NOTED	THIS DRAWING IS THE PROPERTY OF THE PORT OF TACOMA AND SHALL NOT BE USED ON OTHER WORK, DISCLOSED, COPIED, IN WHOLE OR IN PART, WITHOUT WRITTEN PERMISSION						

Parametrix
ENGINEERING PLANNING ENVIRONMENTAL SCIENCES
800 WASHINGTON AVENUE, SUITE 590
BREMERTON, WA 98537
P 360.377.0014
WWW.PARAMETRIX.COM

STEVE WIERZBICKI
PROFESSIONAL ENGINEER
STATE OF WASHINGTON
LICENSE NO. 65838