

CORN MEAL PRODUCTION:

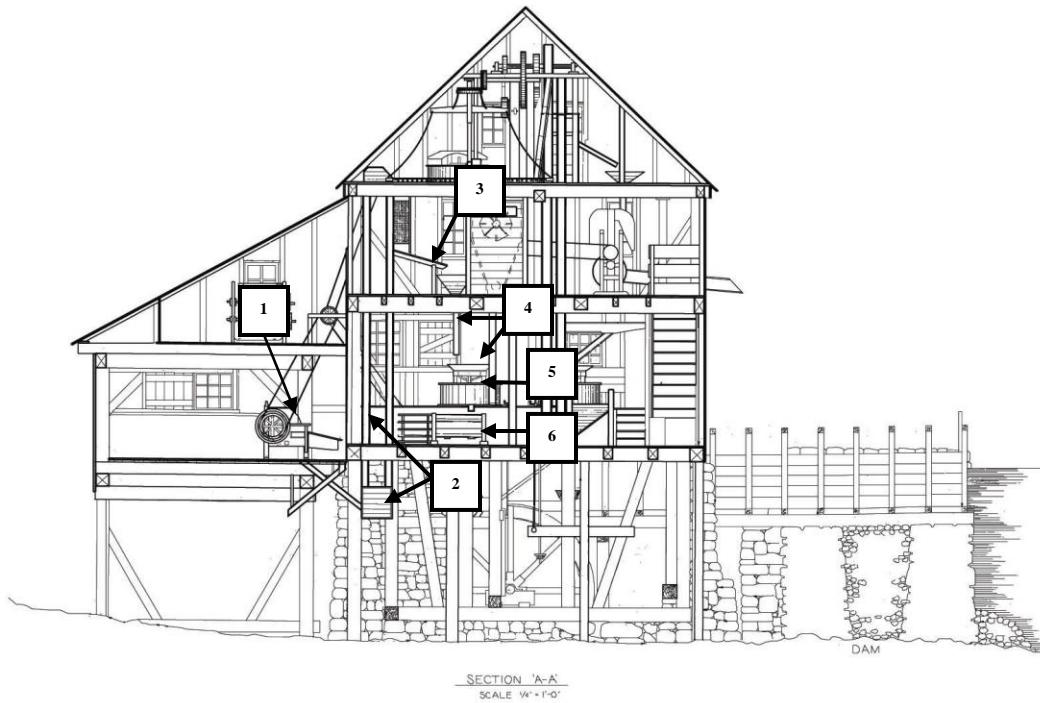

- 1 = Corn is shelled from the cob
(Corn kernels are fed into an elevator box)
(Corn cobs drop through a chute to the ground below sawmill)
- 2 = Kernels are carried through a grain elevator to grain cleaner
- 3 = Cleaner on the second floor cleans the corn kernels
- 4 = Cleaned kernels are fed through a chute into the millstone hopper
- 5 = Kernels are ground into corn meal on a set of quartzite millstones
- 6 = Corn meal is conveyed through a spout to the corn meal bin
(Corn is bagged using a miller's scoop or paddle)

FLOUR PRODUCTION:

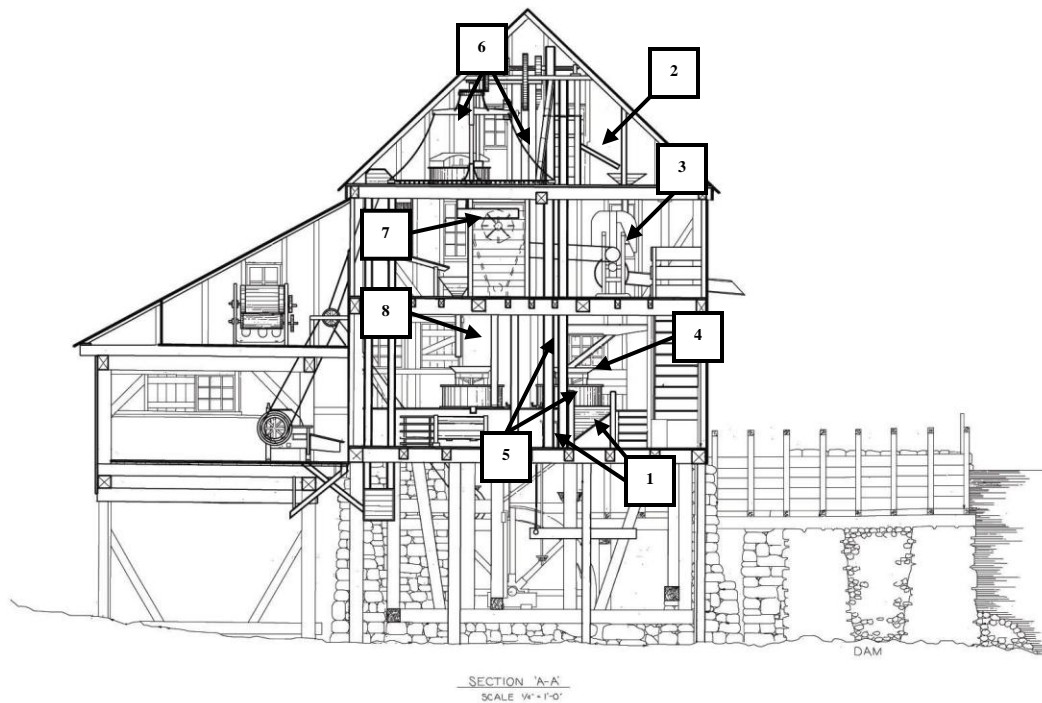

- 1 = Wheat is put into a receiving bin (or “garner”)
(Grain is fed into an elevator box through the bottom of the bin)
(Grain is carried through a grain elevator to a cleaner)
- 2 = A rolling screen cleaner on the third floor cleans the wheat grain
- 3 = The “Invincible Grain Cleaner” on the second floor further cleans the grain
(Waste, or “chaff”, is exhausted out the side of the building)
- 4 = Cleaned grain is fed through a chute into the millstone hopper
- 5 = Grain is ground into wheat meal on a set of French burr millstones
(Flour is conveyed through a spout into the flour elevator)
- 6 = Elevator and chute convey the meal into the “hopper boy” to be cooled
- 7 = Cooled meal is conveyed through an auger and chute to the “bolter” (sifter)
- 8 = Silk-covered reel in the bolter separates the meal into different flour grades
(Chutes at the bolter bottom then conveys the wheat flour to the 1st floor)
(Flour is bagged or placed in barrels on the 1st floor using a barrel packer)